



The Connection at 8600

8600 Harry Hines Blvd, Dallas, TX 75235

Sublease highlights + floorplan



Premises
95,000 RSF



Parking Ratio
6.0/1,000 SF
(ability to expand)



Lease Expiration
January 31, 2031



Availability
Immediately



Rate
\$14.00/RSF NNN



Furniture
800 New Steelcase
Workstations



Scan or Click for
Virtual Tour

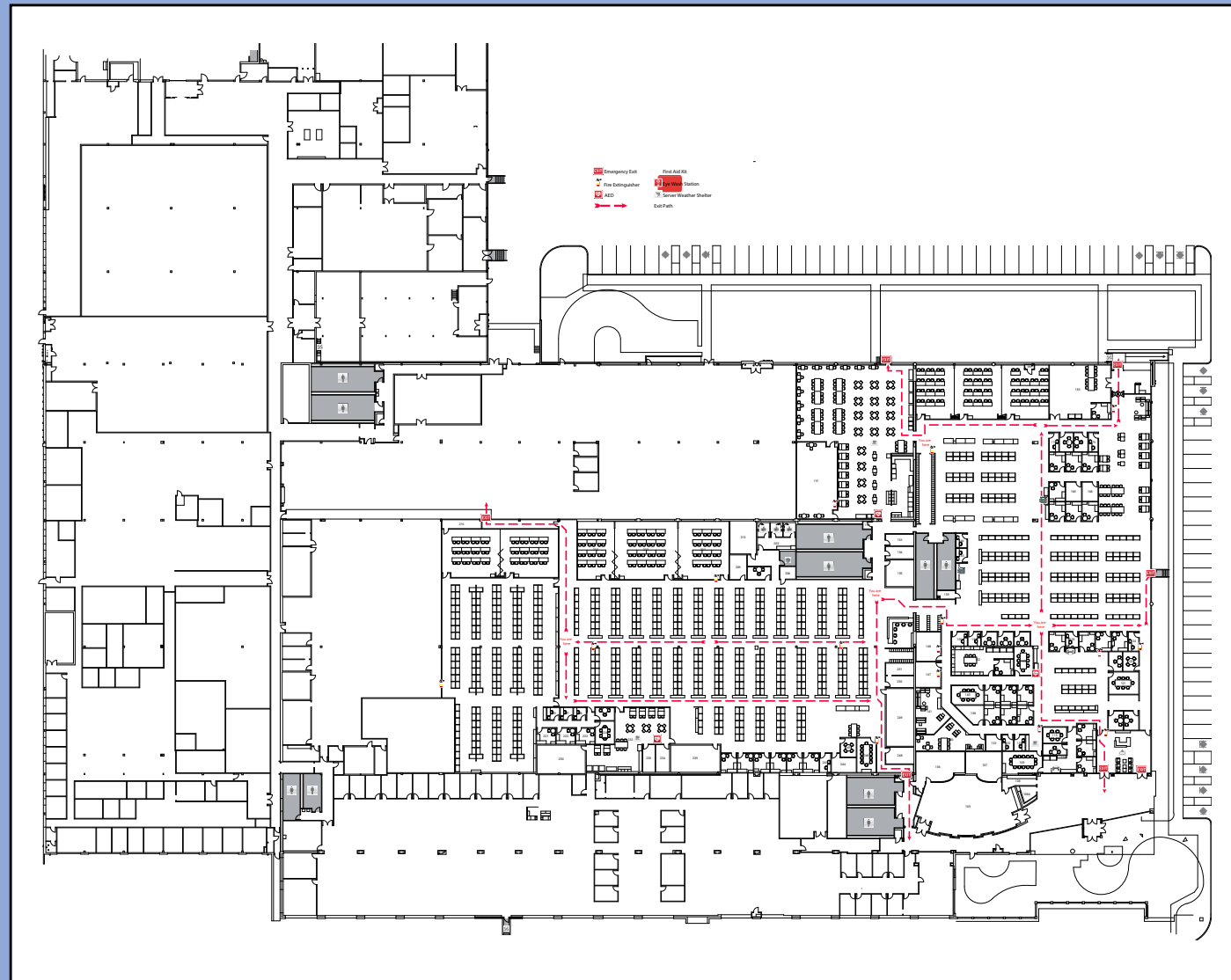

Property Photos

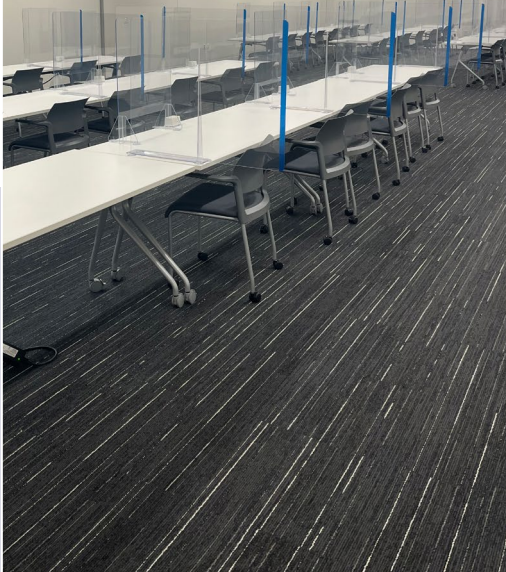
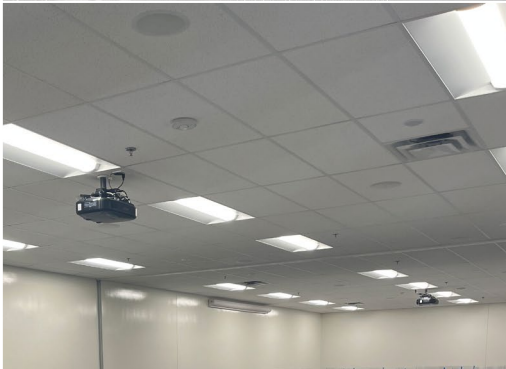



Broker Contacts:

MaryMichael McCartin

+1 214 458 5535

marymichael.mccartin@jll.com

Conor McCarthy

+1 214 438 6392

conor.mccarthy@jll.com

Although information has been obtained from sources deemed reliable, JLL does not make any guarantees, warranties or representations, express or implied, as to the completeness or accuracy as to the information contained herein. Any projections, opinions, assumptions or estimates used are for example only. There may be differences between projected and actual results, and those differences may be material. JLL does not accept any liability for any loss or damage suffered by any party resulting from reliance on this information. If the recipient of this information has signed a confidentiality agreement with JLL regarding this matter, this information is subject to the terms of that agreement. ©2023. Jones Lang LaSalle IP, Inc. All rights reserved.

