

FOR SALE/LEASE

±7,777 SF SUITE AVAILABLE

2410 WARDLOW R.D | SUITE 103 | CORONA | CA

FLOOR PLAN

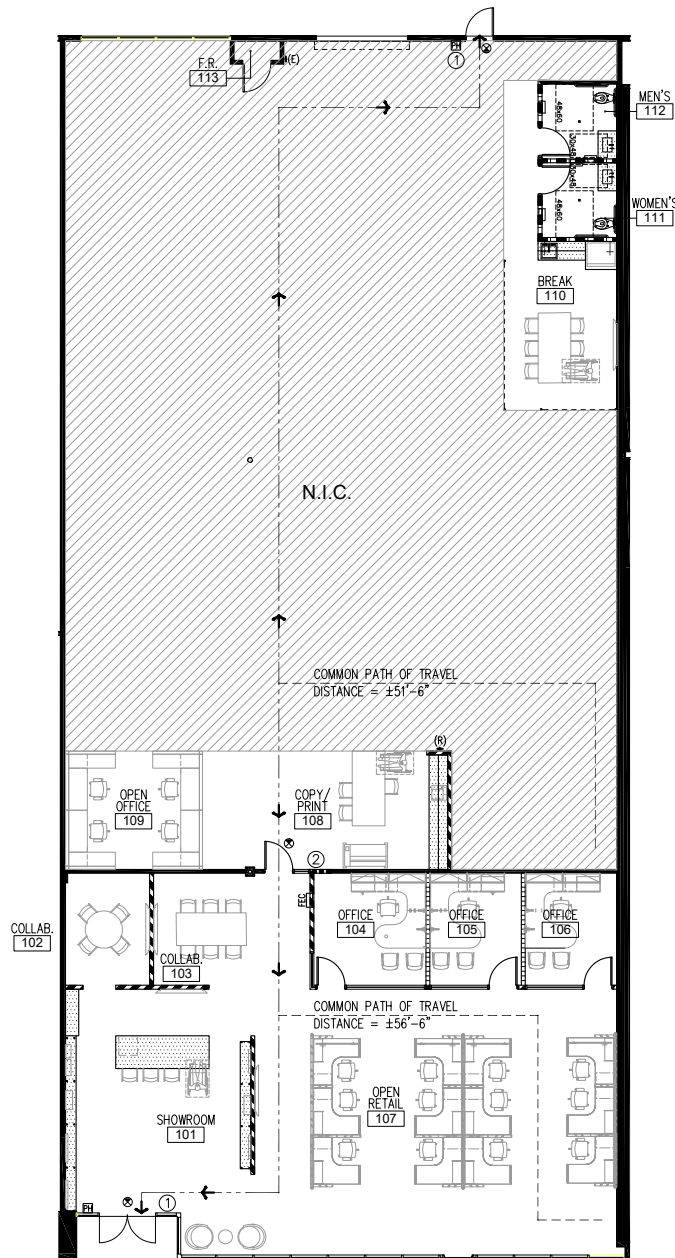

NOT TO SCALE*

FOR MORE INFORMATION, PLEASE CONTACT:

DAVID GORES

FIRST VICE PRESIDENT
M: 909.720.9437
dgores@daumcommercial.com
CADRE #01502471

NICK CANTU

ASSOCIATE VICE PRESIDENT
M: 714.787.9454
ncantu@daumcommercial.com
CADRE #02016719

NOAH SAMARIN

E.V.P. PRINCIPAL
M: 714.812.1289
nsamarin@daumcommercial.com
CADRE #01755814

Although all information is furnished regarding for sale, rental or financing from sources deemed reliable, such information has not been verified and no express representation is made nor is any to be implied as to the accuracy thereof, and it is submitted subject to errors, omissions, changes of price, rental or other conditions, prior sale, lease or financing, or withdrawal without notice. All Maps provided courtesy of Google Maps, Bing Maps, and Google Earth. D/AQ Corp. # 01129558



FOR SALE/LEASE

±7,777 SF SUITE AVAILABLE

2410 WARDLOW R.D | SUITE 103 | CORONA | CA

GALLERY



FOR MORE INFORMATION, PLEASE CONTACT:

DAVID GORES

FIRST VICE PRESIDENT

M: 909.720.9437

dgores@daumcommercial.com

CADRE #01502471

NICK CANTU

ASSOCIATE VICE PRESIDENT

M: 714.787.9454

ncantu@daumcommercial.com

CADRE #02016719

NOAH SAMARIN

E.V.P. PRINCIPAL

M: 714.812.1289

nsamarin@daumcommercial.com

CADRE #01755814

Although all information is furnished regarding for sale, rental or financing from sources deemed reliable, such information has not been verified and no express representation is made nor is any to be implied as to the accuracy thereof, and it is submitted subject to errors, omissions, changes of price, rental or other conditions, prior sale, lease or financing, or withdrawal without notice. All Maps provided courtesy of Google Maps, Bing Maps, and Google Earth. D/AQ Corp. # 01129558



FOR SALE/LEASE

±7,777 SF SUITE AVAILABLE

2410 WARDLOW R.D | SUITE 103 | CORONA | CA

AMENITIES

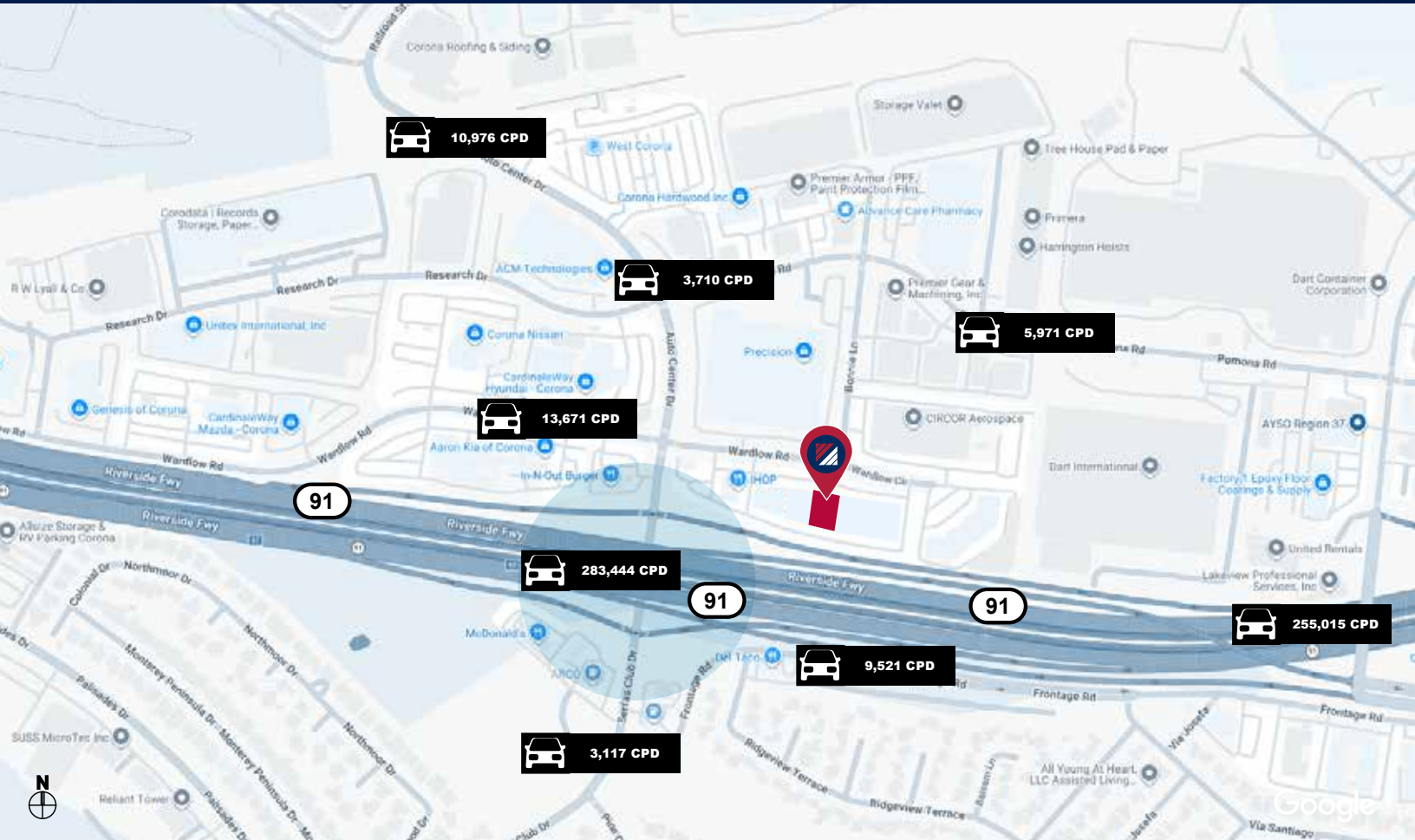

COLLECTION STREET	CROSS STREET	TRAFFIC VOLUME	COUNT YEAR	DISTANCE FROM PROPERTY
Riverside Fwy	Serfas Club Dr NW	283,444	2025	0.10 mi
Frontage Rd	Ridgeview Ter E	9,521	2025	0.14 mi
CA 91	-	253,827	2025	0.16 mi
91 Express Lanes	State Rte 91 E	264,032	2025	0.16 mi
Pomona Rincon Rd	Research Dr SW	3,710	2025	0.19 mi
Wardlow Rd	Wardlow Cir E	14,242	2025	0.21 mi
91	Sh-91 E	263,375	2025	0.22 mi
6th St	Sh-91 E	261,156	2023	0.22 mi
Pomona Rincon Rd	Bonnie Ln NW	5,976	2025	0.26 mi
91	State Rte 91 E	261,992	2024	0.27 mi

FOR MORE INFORMATION, PLEASE CONTACT:

DAVID GORES
 FIRST VICE PRESIDENT
 M: 909.720.9437
 dgores@daumcommercial.com
 CADRE #01502471

NICK CANTU
 ASSOCIATE VICE PRESIDENT
 M: 714.787.9454
 ncantu@daumcommercial.com
 CADRE #02016719

NOAH SAMARIN
 E.V.P. PRINCIPAL
 M: 714.812.1289
 nsamarin@daumcommercial.com
 CADRE #01755814

Although all information is furnished regarding for sale, rental or financing from sources deemed reliable, such information has not been verified and no express representation is made nor is any to be implied as to the accuracy thereof, and it is submitted subject to errors, omissions, changes of price, rental or other conditions, prior sale, lease or financing, or withdrawal without notice. All Maps provided courtesy of Google Maps, Bing Maps, and Google Earth. D/AQ Corp. # 01129558

