



**FOR LEASE**

# Professional Office Space

2896 Crescent Ave.  
Eugene OR 97408

## CLASS A SPACE ON CRESCENT AVENUE

- 500 rentable square feet
- Three areas
- Common restrooms and entry
- On-site parking
- \$1,100 month, including utilities

**Evans  
Elder  
Brown &  
Seubert**

COMMERCIAL REAL ESTATE

**Jeff Elder**  
jeff@eebcre.com

**Ashley Hope Elder**  
ashley@eebcre.com

**541.345.4860**

Licensed in the State of Oregon.

# Suite 102 Floor Plan

2896 Crescent Avenue  
Eugene, Oregon 97408

Evans  
Elder  
Brown &  
Seubert

COMMERCIAL REAL ESTATE

## CONTACT

Jeff  
Elder

jeff@eebcre.com

Ashley  
Hope  
Elder

ashley@eebcre.com

541.345.4860

101 East Broadway  
Suite #101  
Eugene, OR 97401

Licensed in the  
State of Oregon.

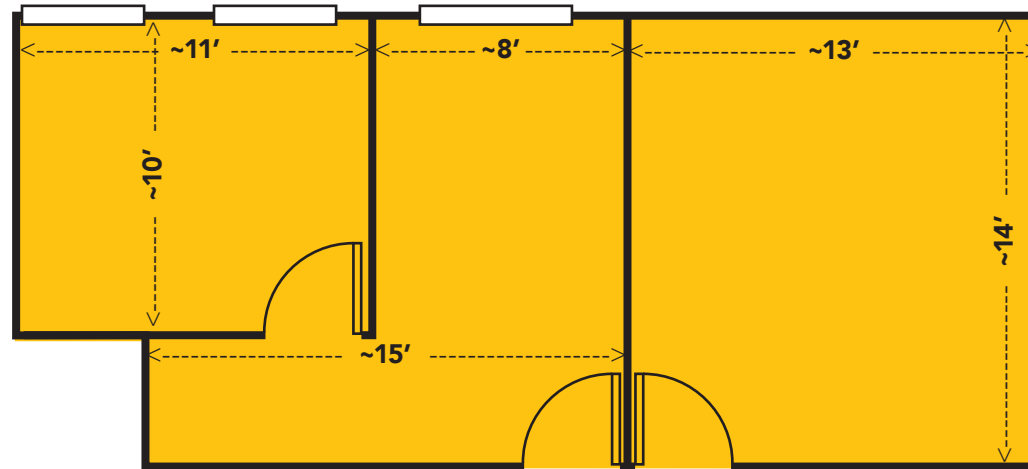

(~) measurements are approximate

**Suite 102**

**500 SF**

