

RIVERFRONT REHAB FACILITY

3650 & 3670 NE Indian River Dr. Jensen Beach, FL 34957



FOR LEASE | Call for Pricing

**JEREMIAH BARON
& CO**

COMMERCIAL REAL ESTATE

2100 SE Ocean Blvd. Suite 100
Stuart FL, 34996
www.commercialrealestatellc.com

Chris Belland
772.286.5744 Office
772.418.4506 Mobile
cbelland@commercialrealestatellc.com

PROPERTY OVERVIEW

- This property features 33 patients beds.
- Amazing chance to lease a waterfront rehab facility property boasting prime frontage along Indian River Drive.
- Spanning a total of 1 acre.
- The facility comprises around 15 rooms, a delightful common area, a commercial kitchenette, and office spaces.
- Situated within walking distance of downtown Jensen Beach, it offers easy access to trendy restaurants and shops.



PRICE	Call For Pricing
BUILDING SIZE	5,635 sf 1,200 sf
BUILDING TYPE	Multiple Res-Assisted Living Single Fam
ACREAGE	0.77 ac 0.22 ac
FRONTAGE	111' 84'
TRAFFIC COUNT	6,500 ADT
YEAR BUILT	1953 1966
PARKING SPACE	15
ZONING	Jensen Beach Redevelopment District
LAND USE	CRA Center
PARCEL ID	15-37-41-000-000-00330-5 15-37-41-000-000-00280-5

NO WARRANTY OR REPRESENTATION, EXPRESS OR IMPLIED, IS MADE AS TO THE ACCURACY OF THE INFORMATION CONTAINED HEREIN, AND THE SAME IS SUBMITTED SUBJECT TO ERRORS, OMISSIONS, CHANGE OF PRICE, RENTAL OR OTHER CONDITIONS, PRIOR SALE, LEASE OR FINANCING, OR WITHDRAWAL WITHOUT NOTICE, AND OF ANY SPECIAL LISTING CONDITIONS IMPOSED BY OUR PRINCIPALS NO WARRANTIES OR REPRESENTATIONS ARE MADE AS TO THE CONDITION OF THE PROPERTY OR ANY HAZARDS CONTAINED THEREIN ARE ANY TO BE IMPLIED.

**JEREMIAH BARON
& CO**
COMMERCIAL REAL ESTATE

2100 SE Ocean Blvd. Suite 100
Stuart FL, 34996
www.commercialrealestatellc.com

Chris Belland
772.286.5744 Office
772.418.4506 Mobile
cbelland@commercialrealestatellc.com

SITE PHOTOS



**JEREMIAH BARON
& CO**
COMMERCIAL REAL ESTATE

2100 SE Ocean Blvd. Suite 100
Stuart FL, 34996
www.commercialrealestatellc.com

Chris Belland
772.286.5744 Office
772.418.4506 Mobile
cbelland@commercialrealestatellc.com

DEMOGRAPHICS

2023 Population Estimate		2023 Average Household Income		Average Age	
1 Mile	3,835	1 Mile	\$97,442	1 Mile	48.70
3 Mile	74,712	3 Mile	\$91,954	3 Mile	49.90
5 Mile	275,922	5 Mile	\$86,354	5 Mile	50.00

2028 Population Projection		2023 Median Household Income		Median Age	
1 Mile	3,782	1 Mile	\$78,050	1 Mile	52
3 Mile	77,119	3 Mile	\$69,779	3 Mile	56
5 Mile	285,673	5 Mile	\$68,100	5 Mile	55

**JEREMIAH BARON
& CO**

COMMERCIAL REAL ESTATE

2100 SE Ocean Blvd. Suite 100
Stuart FL, 34996
www.commercialrealestatellc.com

Chris Belland
772.286.5744 Office
772.418.4506 Mobile
cbelland@commercialrealestatellc.com

ZONING INFORMATION

	Core	General	Waterfront
Residential Use Groups, see Section 12.1.03			
Accessory dwelling units	P	P	P ³
Other dwelling types	P	P	P ³
Single-family dwellings	-	P	-
Bed and breakfast inns	P	P	P ³
Agricultural Use Groups, see Section 12.1.03			
Urban farming	-	P ¹	-
Commercial & Business Use Groups, see Section 12.1.03			
Business & professional offices	P	P	P ³
Construction services, limited	P ¹	P ¹	P ^{1,3}
Hotels, motels, resorts spas	P	P	P ³
Marinas	-	-	P ³
Medical offices	P	P	-
Microbreweries & Craft Distilleries	P	-	P
Parking lots and garages	P	-	-
Restaurants	P	P	P ³
Retail & services, limited impact	P ^{1,4}	P ^{1,4}	P ^{1,3,4}
Retail & services, general impact	P ^{1,4}	-	-
Wholesale trades and services	P ¹	P ^{1,5}	P ^{1,3}
Working waterfront	-	P ⁵	P ³
Public & Institutional Use Groups, see Section 12.1.03			
Institutional uses, limited impact	P	P	P
Institutional uses, general impact	P	P	-
Industrial Use Groups, see Section 12.1.03			
Limited impact industries		-	P ^{1,2,3}

**JEREMIAH BARON
& CO**
COMMERCIAL REAL ESTATE

2100 SE Ocean Blvd. Suite 100
Stuart FL, 34996
www.commercialrealestatellc.com

Chris Belland
772.286.5744 Office
772.418.4506 Mobile
cbelland@commercialrealestatellc.com

SITE PLAN

Un-Sketched Subareas:
BRP (650)
CONCP (582)

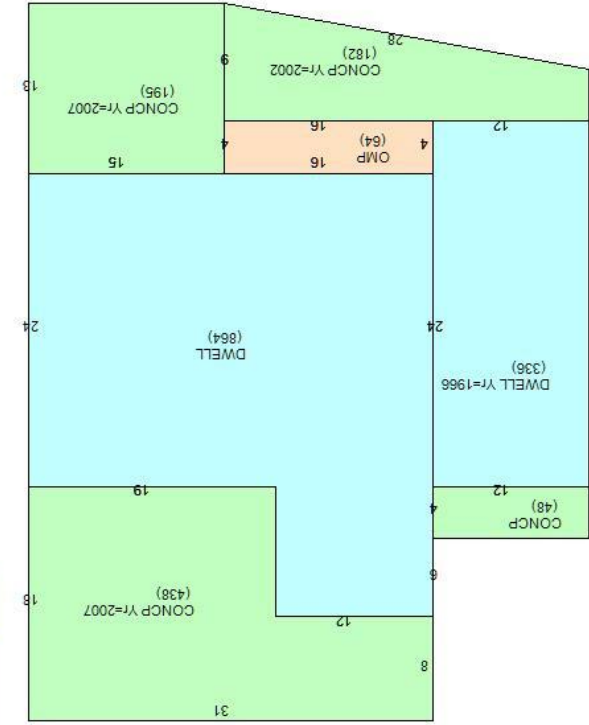
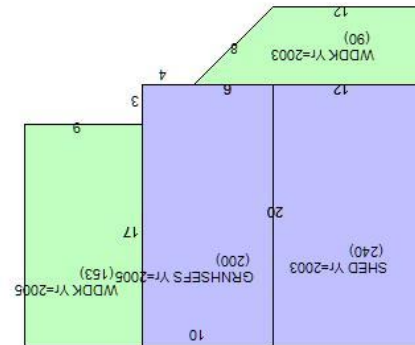
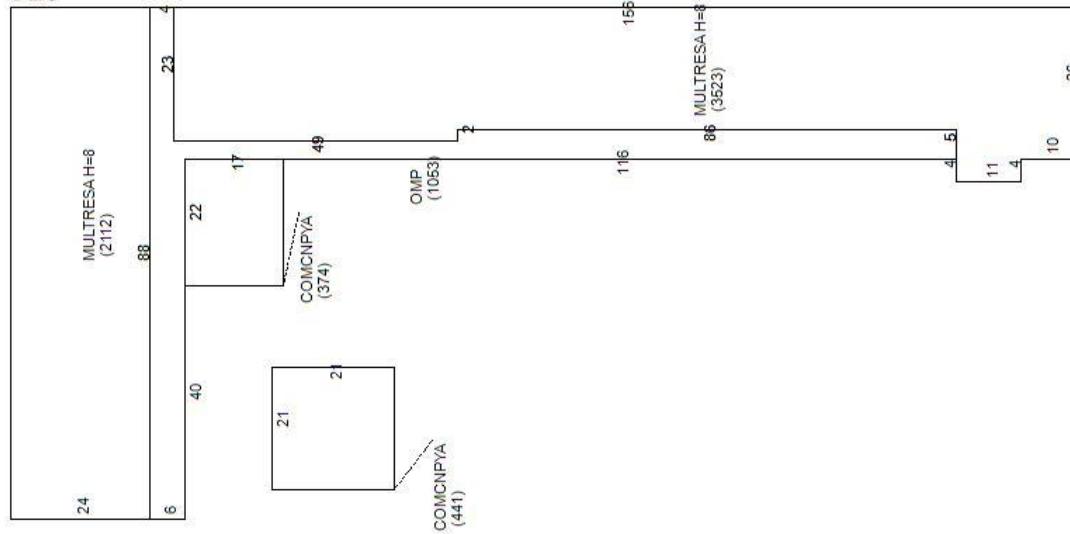

**JEREMIAH BARON
& CO**
COMMERCIAL REAL ESTATE

2100 SE Ocean Blvd. Suite 100
Stuart FL, 34996
www.commercialrealestatellc.com

Chris Belland
772.286.5744 Office
772.418.4506 Mobile
cbelland@commercialrealestatellc.com

TRADE AREA MAP

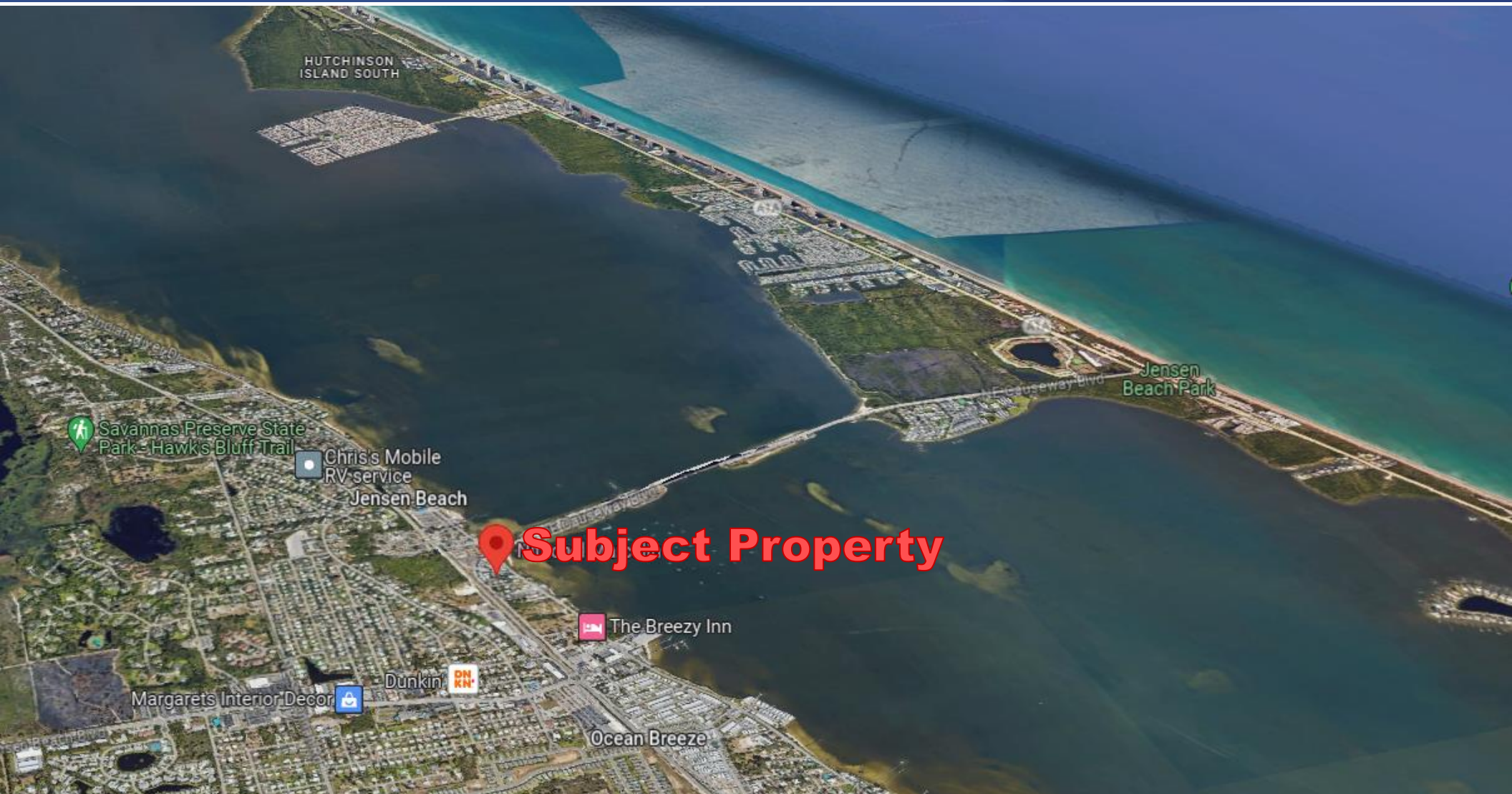

**JEREMIAH BARON
& CO**

COMMERCIAL REAL ESTATE

2100 SE Ocean Blvd. Suite 100
Stuart FL, 34996
www.commercialrealestatellc.com

Chris Belland
772.286.5744 Office
772.418.4506 Mobile
cbelland@commercialrealestatellc.com