



FOR LEASE - RETAIL/OFFICE/STORAGE

1885 PIEDMONT ROAD N, PIEDMONT, OK 73078

BANTA
Property Group



AVAILABLE
650sf



AVAILABLE
1,269sf

AVAILABLE
1,200sf

OFFERING SUMMARY

- Unit E:** 650sf / Base Rent \$16.72psf NNN
- Unit 1 - Storage:** 1,269sf / \$650 a month gross
- Unit 2 - Storage:** 1,200sf / \$600 a month gross
- Estimated NNNs:** \$2.76psf
- Building Size:** 13,955sf
- Lot Size:** 2.43 AC
- Year Built:** 2001
- Zoning:** C-2

GREG BANTA
405.840.1600
Greg@BantaPropertyGroup.com

ANNA RUSSELL
405.535.8156
Anna@BantaPropertyGroup.com

The information contained herein is from sources deemed reliable. No representation is made to the accuracy herein. Photos herein are the property of their respective owners, and use of them without express written consent of the owner is prohibited.



FOR LEASE - RETAIL/OFFICE/STORAGE

1885 PIEDMONT ROAD N, PIEDMONT, OK 73078

BANTA
Property Group

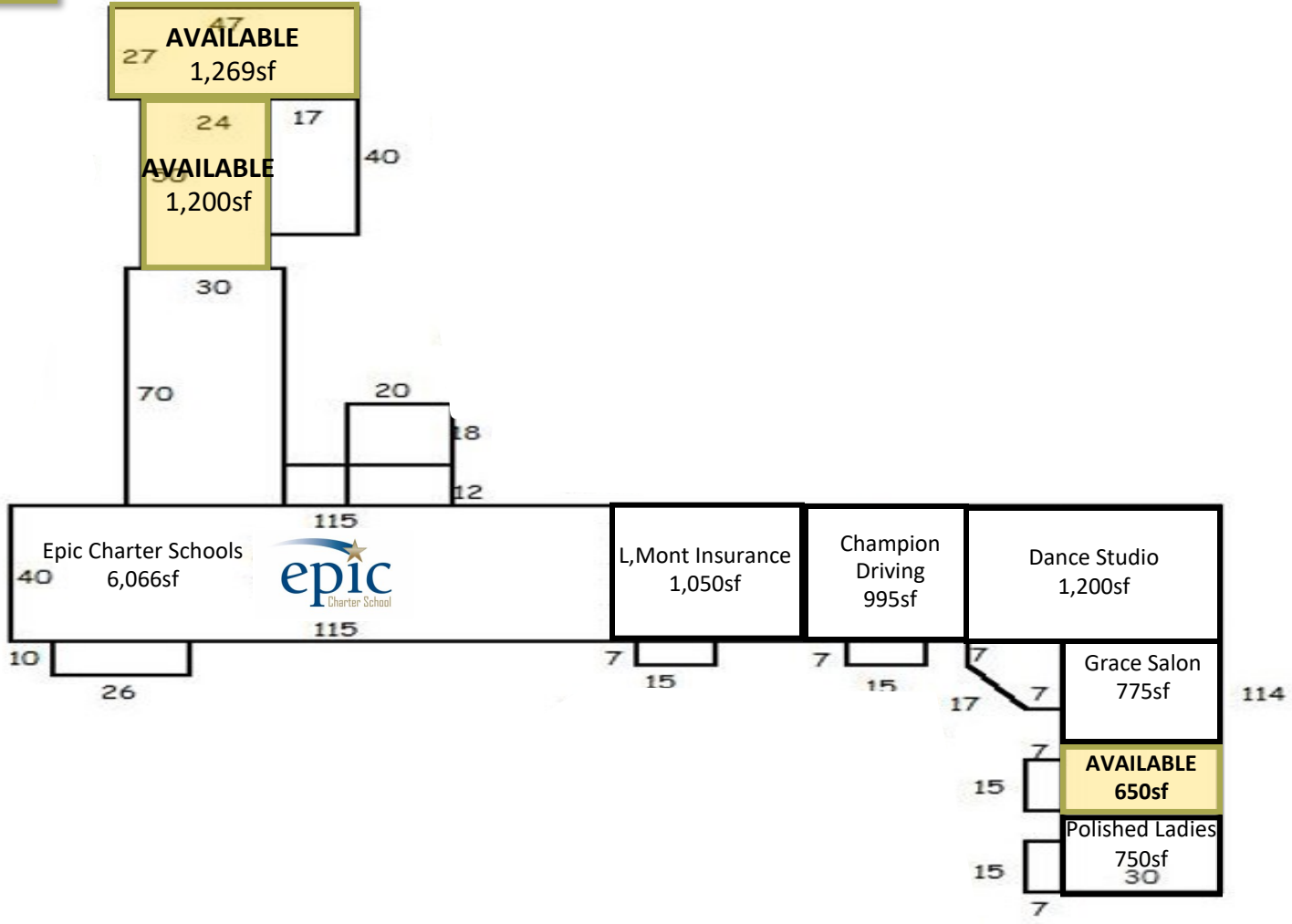

GREG BANTA

405.840.1600

Greg@BantaPropertyGroup.com

ANNA RUSSELL

405.535.8156

Anna@BantaPropertyGroup.com

The information contained herein is from sources deemed reliable. No representation is made to the accuracy herein. Photos herein are the property of their respective owners, and use of them without express written consent of the owner is prohibited.



FOR LEASE - RETAIL/OFFICE/STORAGE

1885 PIEDMONT ROAD N, PIEDMONT, OK 73078

BANTA
Property Group



GREG BANTA
405.840.1600
Greg@BantaPropertyGroup.com

ANNA RUSSELL
405.535.8156
Anna@BantaPropertyGroup.com

The information contained herein is from sources deemed reliable. No representation is made to the accuracy herein. Photos herein are the property of their respective owners, and use of them without express written consent of the owner is prohibited.