

RETAIL / OFFICE FOR LEASE

2940 GRAND PRAIRIE PKWY

KeeTown Loop District
Waukee, Iowa



Neighboring Live Nation's
vibrant music hall
Now Open in the KeeTown Loop

District



2 NORTHWEST

PROPERTY OVERVIEW

- › Ground level retail or office space
- › **1,000 – 8,550 SF** Available
- › Lease Rates Negotiable
- › Tenant Improvement Allowance Negotiable for Qualified Tenants
- › Located on the corner of Ashworth and Grand Prairie Parkway in the **KeeTown Loop District**
- › Remax Precision will occupy entire second story



FLOOR PLAN

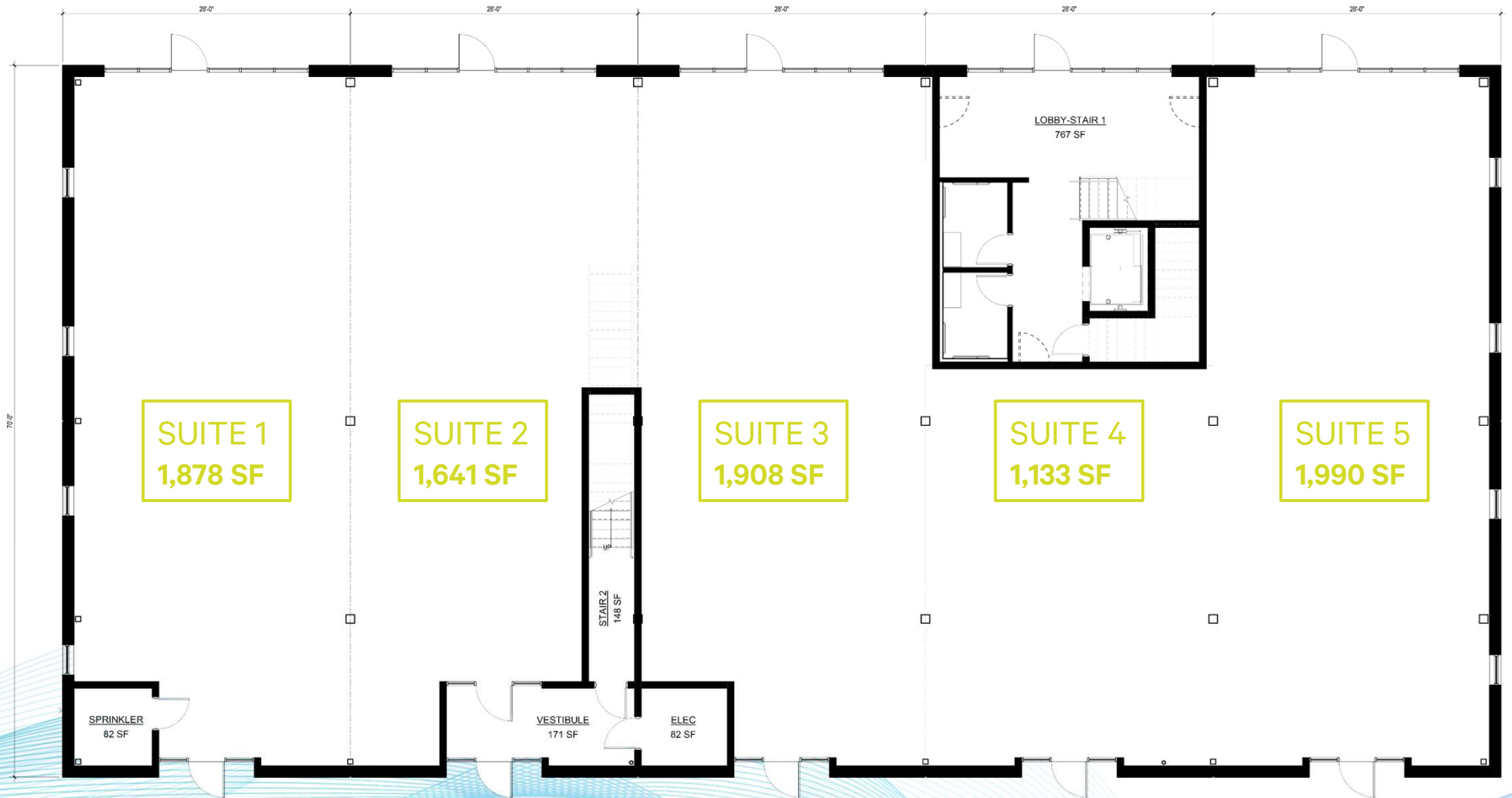



CONTACT US

Josh Masters
 Senior Associate
 +1 515 783 4174
 josh.masters2@cbre.com
 Licensed in the State of Iowa

Ben Probst
 Sales Associate
 +1 515 326 1985
 ben.probst@cbre.com
 Licensed in the State of Iowa

© 2024 CBRE, Inc. All rights reserved. This information has been obtained from sources believed reliable, but has not been verified for accuracy or completeness. You should conduct a careful, independent investigation of the property and verify all information. Any reliance on this information is solely at your own risk. CBRE and the CBRE logo are service marks of CBRE, Inc. All other marks displayed on this document are the property of their respective owners, and the use of such logos does not imply any affiliation with or endorsement of CBRE. Photos herein are the property of their respective owners. Use of these images without the express written consent of the owner is prohibited.

