



IRONWOOD COMMERCE CENTER

±45,000 SF - ±86,867 SF Available



12700 NW LeJeune Road, Building 2, Opa-Locka, FL 33054
IRONWOOD.CBRE-PROPERTIES.COM



Property Highlights



Total SF:
505,440



Clear Height:
32'



Loading:
Bldgs 1-3 Rear loading
Bldg 4 Front loading



Column Spacing:
54'



Lighting:
LED



Parking:
492 spaces



Acreage:
28.31

Ironwood Commerce Center is the newest industrial park in the Central Dade submarket of Miami. Ironwood Commerce Center includes four buildings, totaling 505,440 SF.



GRATIGNY
PARKWAY

LE JEUNE ROAD

Building 2

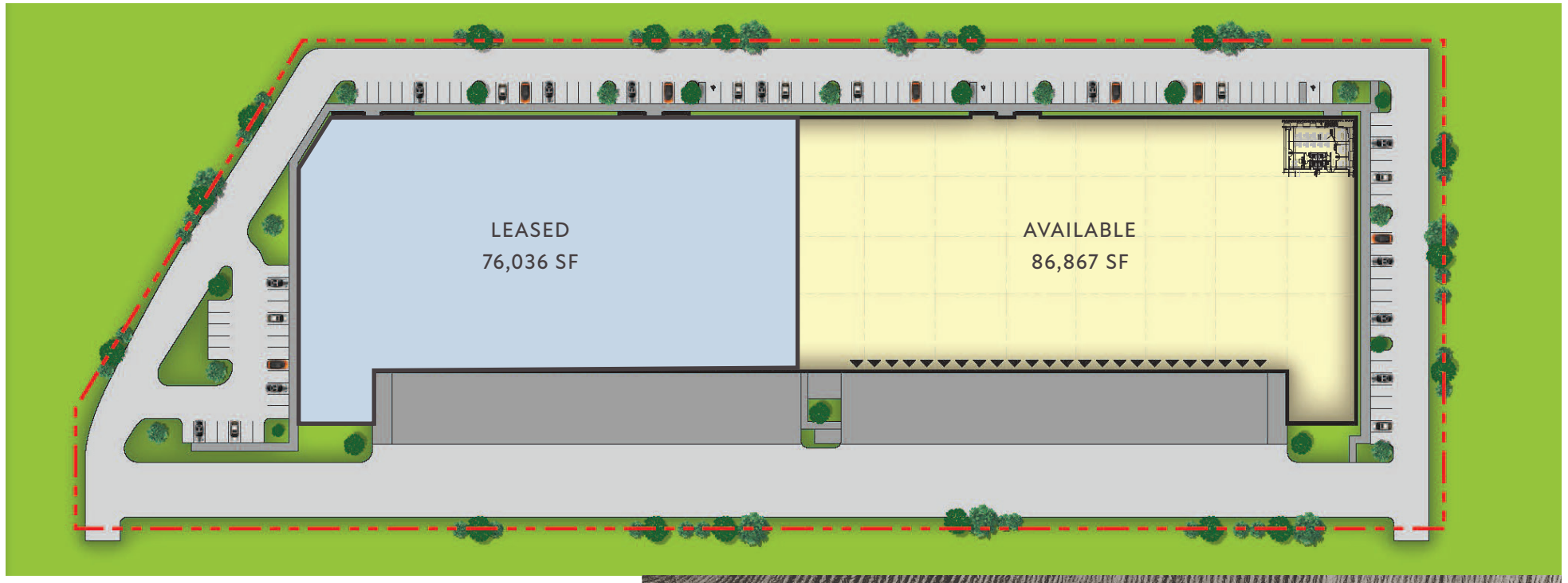

BUILDING 2

±45,000-±86,867 SF AVAILABLE

Office	±2,551 SF
Warehouse	±84,316 SF
Clear Height	32'
Loading	24 dock positions, 1 ramp
Car Parking	0.95/1,000
Building Depth	195'
Available	Immediately
Lease Rate	Call for Pricing

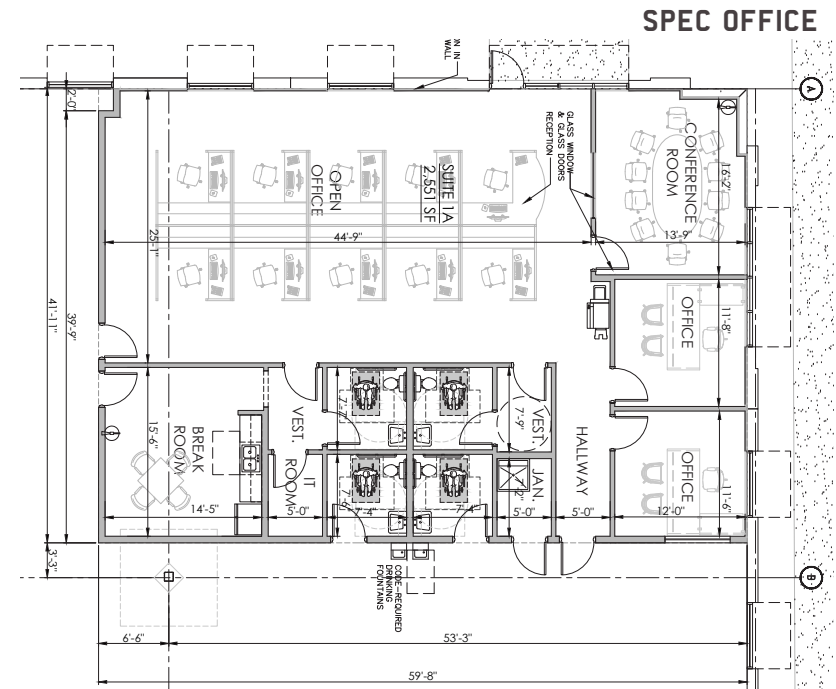



IRONWOOD COMMERCE CENTER

IRONWOOD.CBRE-PROPERTIES.COM

CONTACT US

Devin White

Executive Vice President
+1 305 381 6409
devin.white@cbre.com

David Albert

Executive Vice President
+1 305 381 6474
david.albert@cbre.com

© 2024 CBRE, Inc. All rights reserved. This information has been obtained from sources believed reliable but has not been verified for accuracy or completeness. CBRE, Inc. makes no guarantee, representation or warranty and accepts no responsibility or liability as to the accuracy, completeness, or reliability of the information contained herein. You should conduct a careful, independent investigation of the property and verify all information. Any reliance on this information is solely at your own risk. CBRE and the CBRE logo are service marks of CBRE, Inc. All other marks displayed on this document are the property of their respective owners, and the use of such marks does not imply any affiliation with or endorsement of CBRE. Photos herein are the property of their respective owners. Use of these images without the express written consent of the owner is prohibited.

