

1755

CREEKSIDE OAKS DRIVE

SACRAMENTO | CALIFORNIA

PREMIUM CLASS A OFFICE SPACE FOR LEASE

NEWMARK



Pappas Investments

LUCAS LUGO

t 916-569-2322
lucas.lugo@nmrk.com
CA RE Lic# 0196673

TOM HEACOX

t 916-569-2315
tom.heacox@nmrk.com
CA RE Lic# 00913198

MATT HEACOX

t 916-569-2314
matt.heacox@nmrk.com
CA RE Lic# 01451720

1755 CREEKSIDE OAKS DRIVE

DOWNTOWN
SACRAMENTO



GARDEN HWY

TRUXEL RD

1755
Creekside Oaks Dr.

MINUTES
TO DOWNTOWN SACRAMENTO

1755 CREEKSIDE OAKS DRIVE

PROPERTY HIGHLIGHTS

Suite 110: ±3,028 RSF

Suite 120: ±2,823 RSF

Suite 130: ±2,890 RSF

Suite 190: ±18,637 RSF (Divisible)

Suite 250: ±2,689 RSF

Suite 280: ±9,208 RSF

(Can be combined for a total of
±11,897 RSF)

- Shared conference facility launching in Q4 2024
- Deli located in the project
- Building and monument signage options are available
- New LED lighting in all common areas & parking lot
- Secure bicycle lockers available on-site
- Shower facilities with lockers available in the building
- Convenient access to Interstates 5 and 80
- Conveniently located between Downtown Sacramento, the State Capitol and Sacramento International Airport
- RT bus stops on both sides of the center
- The building is equipped with an existing fiber-optic infrastructure
- Tranquil campus setting
- Access to the American River Bike Trail
- Strong locally based building ownership/excellent property management
- Attentive building engineers and daily porter services



FLOORPLAN

FIRST FLOOR

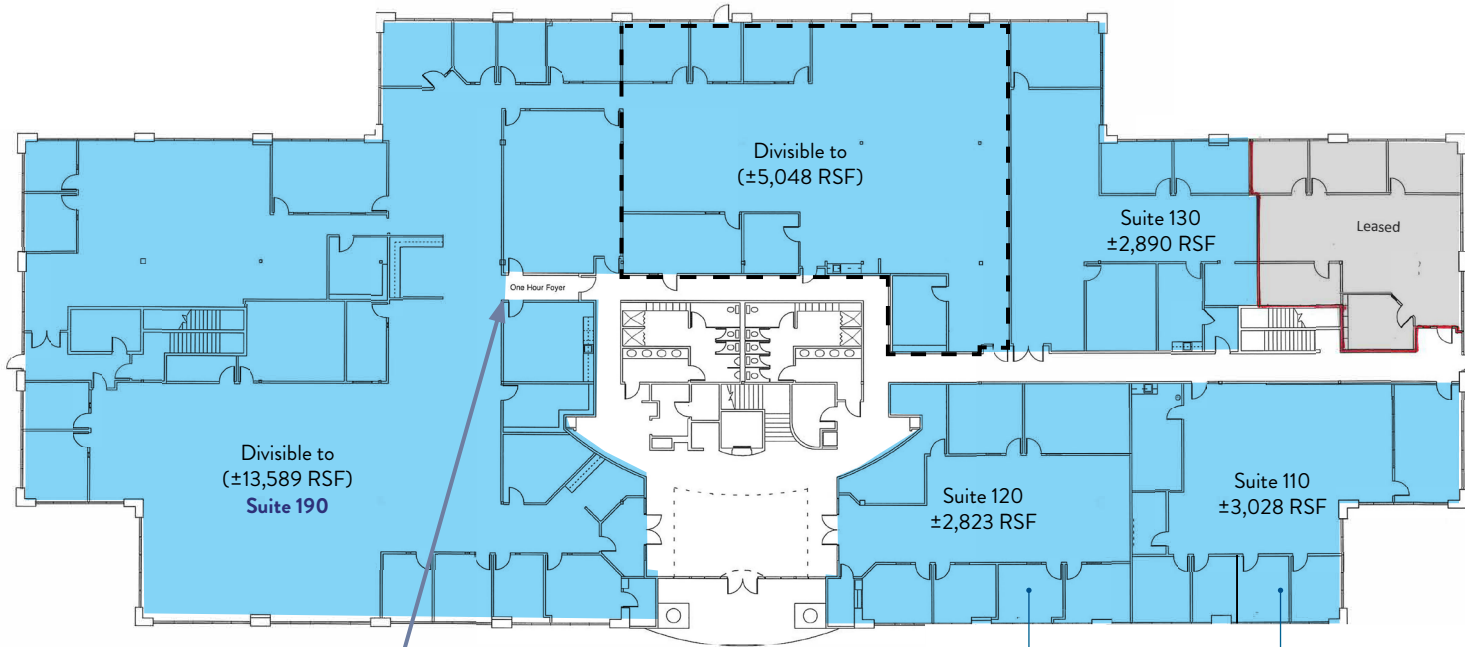

Approximate Location

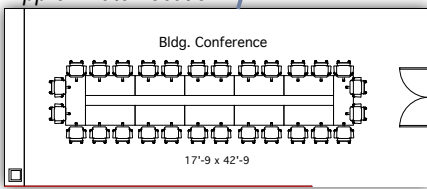

**Shared Conference Facility
Launching in Q4 2024**



Click for Photos
of Suite 120



Click for Photos
of Suite 110



FLOORPLAN

SECOND FLOOR

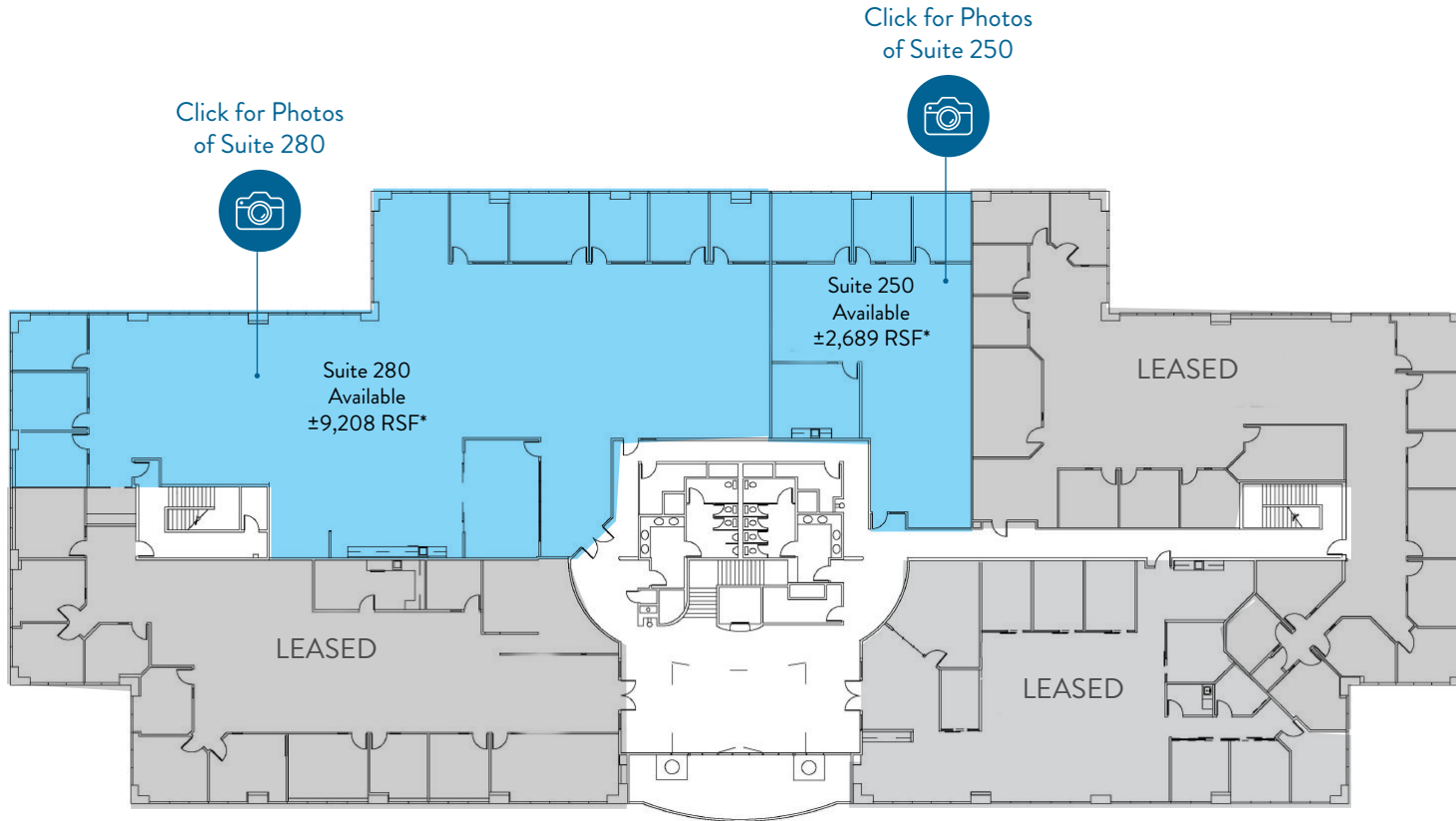

Suites 250 & 280 can be combined for a total of ±11,897 RSF



1755 CREEKSIDE OAKS DRIVE



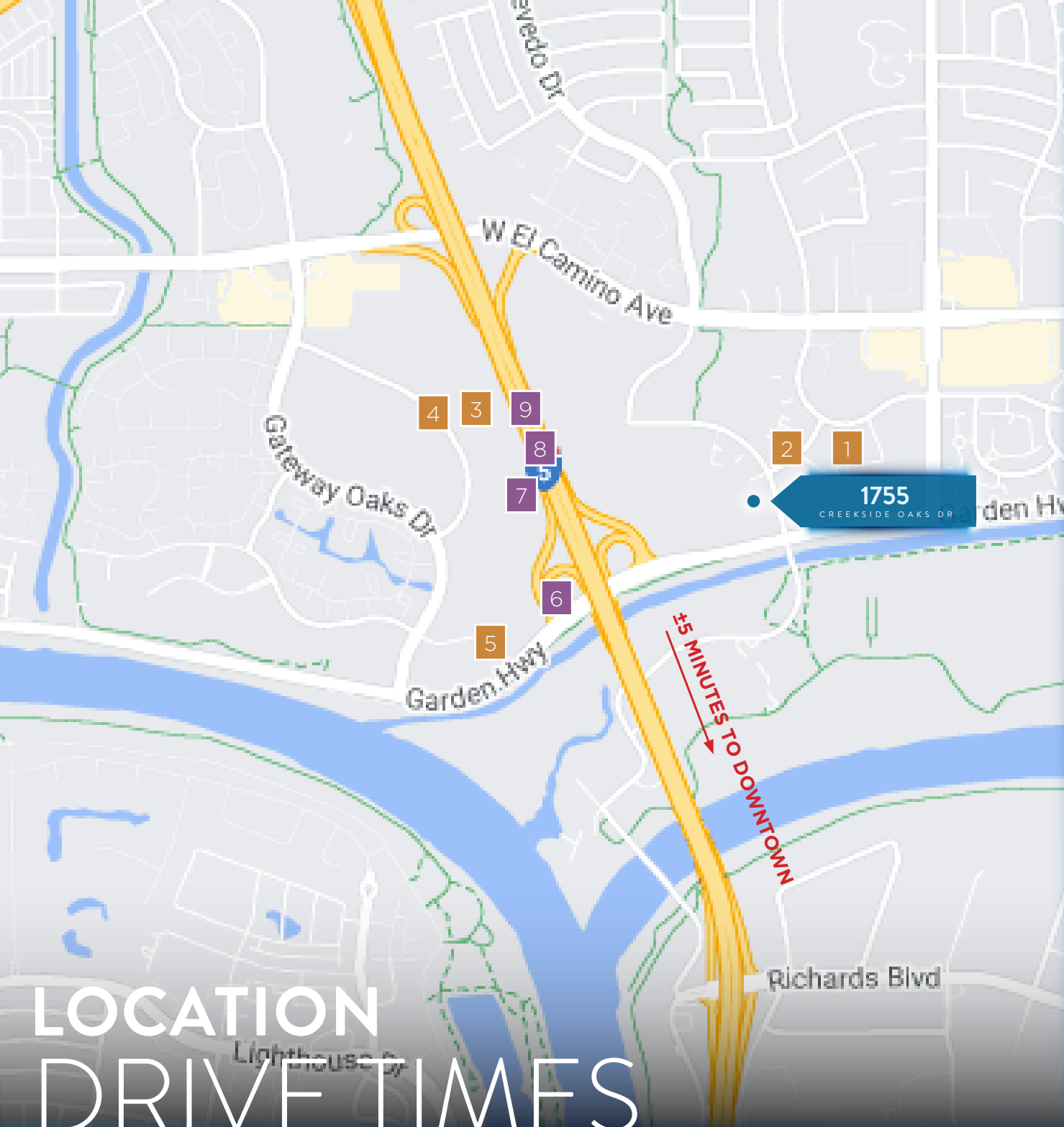

- 1 Bel Air Market
Main Street Bagel Cafe'
Starbucks
Peet's Coffee
Subway
Ole' Mexican Foods
- 2 Bangkok City Thai Cuisine
Mezcal Grill
Cheers Sports Bar
Discount Cleaners
Pizza Guys
Grocery Outlet
- 3 Starbucks
Ruchi Indian Cuisine
Fogo de Minas Steakhouse
- 4 Golden 1 Credit Union
Subway
T&Z Chinese Restaurant
New York Pizza
Sushi King
- 5 Chevys Fresh Mex
Crawdads River Cantina
Pearl on the River
- 6 Courtyard by Marriott
- 7 Marriot Springhill Suites
- 8 Hilton Garden Inn
- 9 Residence Inn by Marriott

- **Downtown Sacramento**
±2.5 Miles | ±5 Minutes
- **Sacramento International Airport**
±8 Miles - ±10 Minutes
- **Downtown San Francisco**
±89 Miles - ±2 Hours

LOCATION DRIVE TIMES

1755

CREEKSIDE OAKS DRIVE

SACRAMENTO | CALIFORNIA



The distributor of this communication is performing acts for which a real estate license is required. The information contained herein has been obtained from sources deemed reliable but has not been verified and no guarantee, warranty or representation, either express or implied, is made with respect to such information. Terms of sale or lease and availability are subject to change or withdrawal without notice. MP-454 | 09/2024

NEWMARK



Pappas Investments

LUCAS LUGO

t 916-569-2322
lucas.lugo@nmrk.com
CA RE Lic# 0196673

TOM HEACOX

t 916-569-2315
tom.heacox@nmrk.com
CA RE Lic# 00913198

MATT HEACOX

t 916-569-2314
matt.heacox@nmrk.com
CA RE Lic# 01451720