

±14,200 SF FOR LEASE

**ANCHOR BUILDING AVAILABLE AT
MAJOR INTERSECTION IN OAKLAND**

Seminary Point

5835 FOOTHILL BLVD | OAKLAND, CA 94605

STEPHEN RUSHER

srusher@theeconiccompany.com

(925) 236-2660

CalDRE: 01439740

 the econic company®



PROPERTY HIGHLIGHTS



Building is in great condition



Drive-through opportunity



Located at the intersection of two major thoroughfares

DEMOGRAPHICS	1 MILE	3 MILES	5 MILES
Population	45,924	239,703	466,650
Avg. Household Income	\$109,377	\$130,997	\$154,459
Daytime Population	32,502	189,635	419,952

TRAFFIC COUNTS

Source: 2025 Esri.

Seminary Rd	10,623 ADT
Foothill Blvd	6,245 ADT
Bancroft Ave	5,891 ADT

PROPERTY
FLOOR PLAN

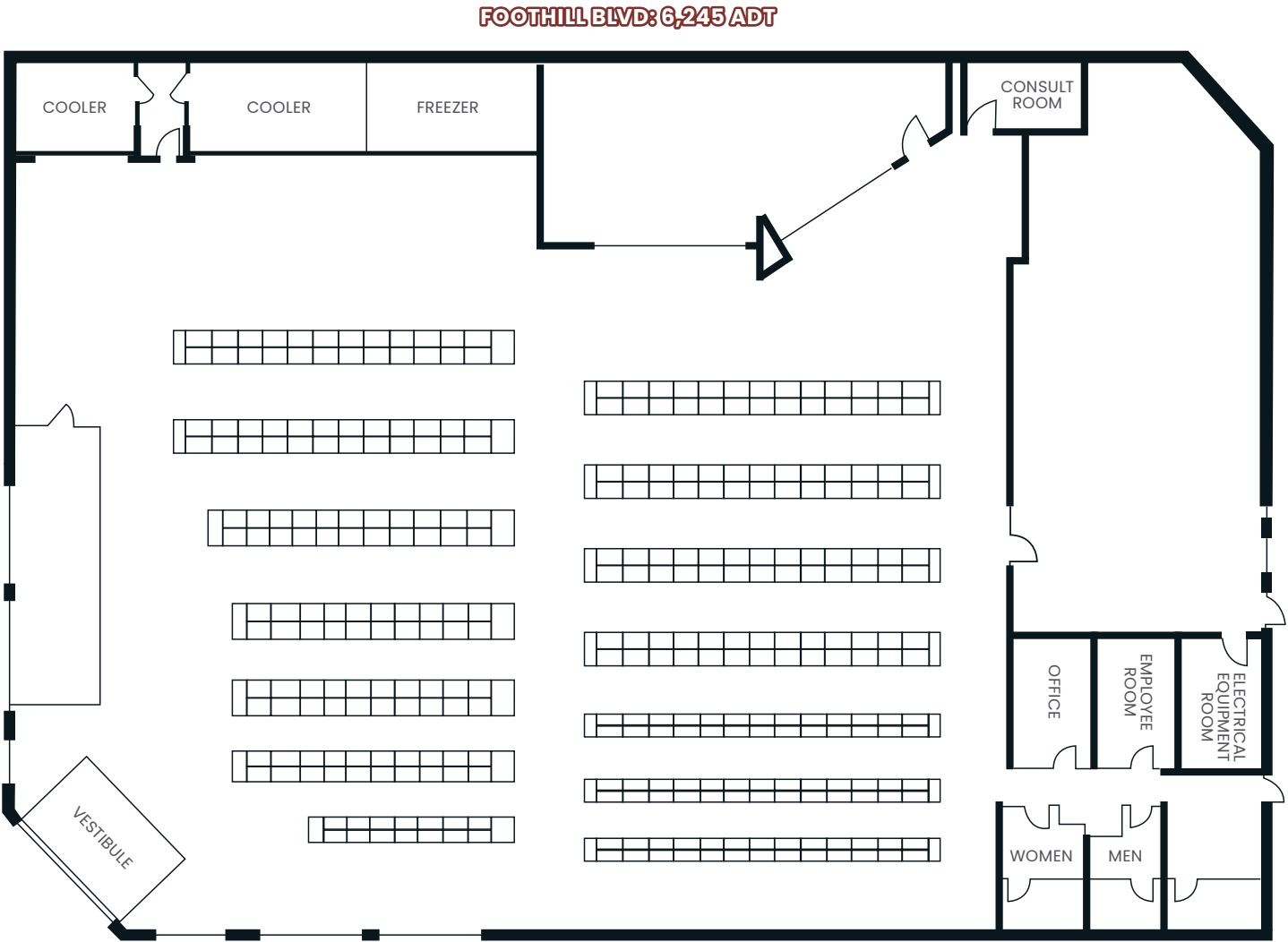



PROPERTY GALLERY



BEST BUY **Pak'n Save** **Total Wine** **Office DEPOT**
Michaels **THE HOME DEPOT** **RACK** **TARGET**

PROYECTO DIAZ
COFFEE
TOUCHSTONE
CLIMBING

PEPPER
GROCERY
BLUE BOTTLE
COFFEE
Peet's
COFFEE

SPROUTS
FARMERS MARKET
GROCERY OUTLET
Bargain Market
Starbucks **W**

WHOLE FOODS
MARKET

Lucky

DOLLAR TREE

SAFECO

ACE
Hardware
planet fitness

ALAMEDA LANDING
TARGET **SAFECO** **Jollibee**
Habit **OrangeTheory** **STRETCH LAB** **CVS**
Michaels **Firehouse Subs**
ALAMEDA **SALLY BEAUTY** **Mariner** **Aquatic**

WORLD MARKET

DOLLAR TREE

McDonald's **dd's DISCOUNTS** **CVS** **BURGER KING** **TACO BELL**
Rainbow **GOLOS** **Auto Zone**

FRUITVALE STATION
food maxx **ROSS** **Starbucks** **Habit**
DRESS FOR LESS
BURGER GRILL

Seminary Point

SOUTH SHORE CENTER
KOHL'S **SAFECO** **ULTA** **HomeGoods** **W**
OLD NAVY **Applebee's** **petco** **TJ-maxx** **McDonald's**
five BELOW **PAGANO'S** **EUROPEAN WAX CENTER** **5**

OAKLAND
ARENA

MARKET
AERIAL

Seminary Point

5835 FOOTHILL BLVD | OAKLAND, CA 94605

STEPHEN RUSHER

srusher@theeoniccompany.com

(925) 236-2660

CaIDRE: 01439740

