

FOR SUBLEASE

**1250 CONNECTICUT AVE.
WASHINGTON, DC**

3,368 RSF - 2ND FLOOR

**NATIONAL FUND FOR
WORKFORCE SOLUTIONS**

2101 L Street, N.W., Suite 500
Washington, DC 20037
United States
+1 202 463 2100

AVAILABLE IMMEDIATELY

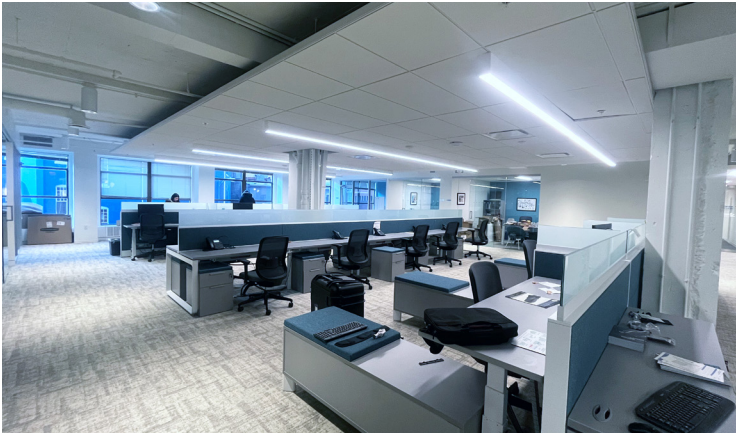

Property Highlights

- Sublease term through November 30, 2031
- 7 private windowed offices
- 16 workstations
- Access to pantry and conference room shared with one other tenant

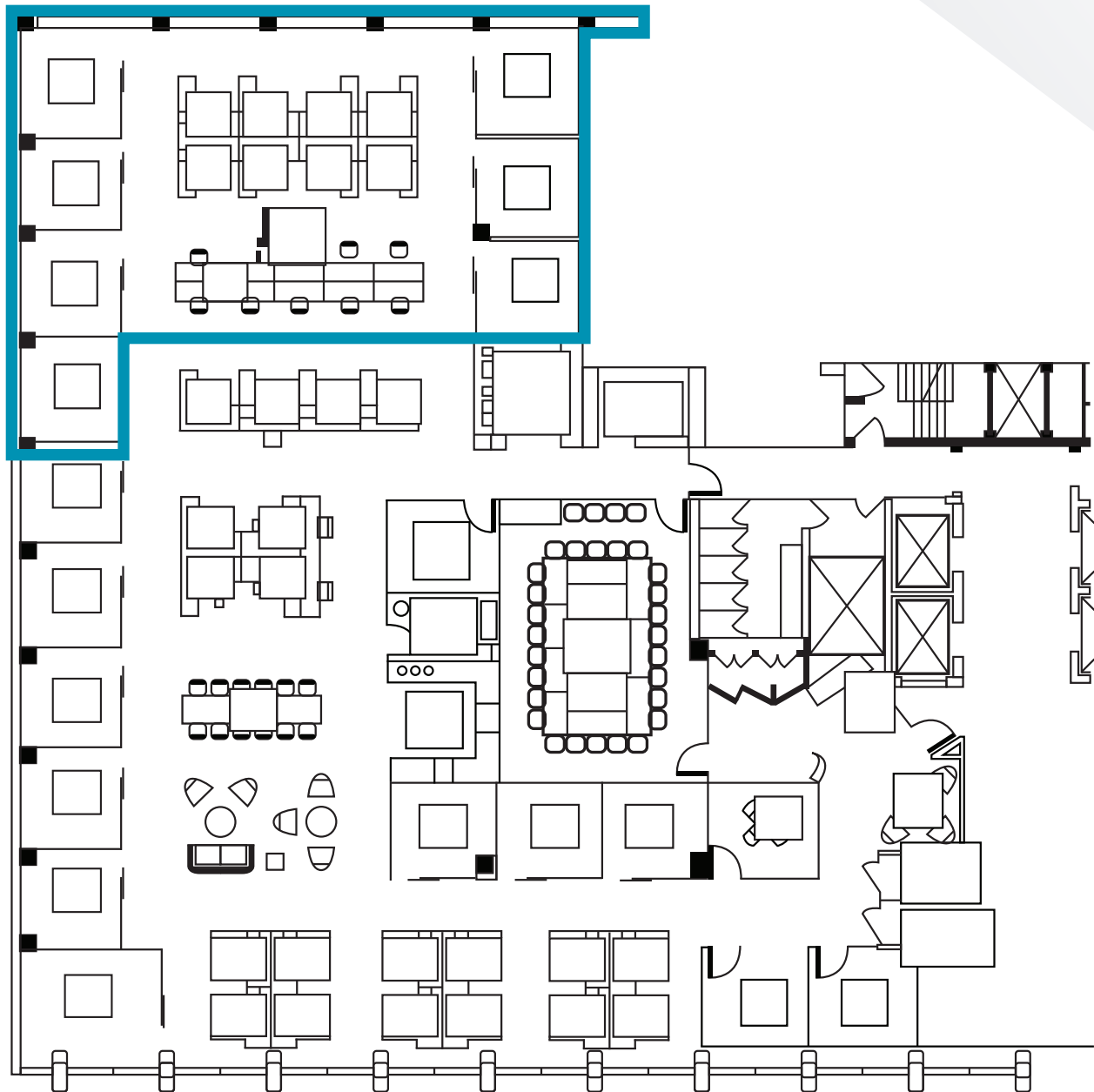

For more information, please contact:

MARK WOOTERS

Executive Director
Direct: +1 202 739 0363
Mobile: +1 202 271 2710
mark.wooters@cushwake.com

GINA DAMOND

Senior Associate
Direct: +1 202 407 8127
Mobile: +1 703 731 7212
gina.damond@cushwake.com

2101 L Street, N.W., Suite 500
Washington, DC 20037
United States
+1 202 463 2100

©2023 Cushman & Wakefield. All rights reserved. The information contained in this communication is strictly confidential. This information has been obtained from sources believed to be reliable but has not been verified. NO WARRANTY OR REPRESENTATION, EXPRESS OR IMPLIED, IS MADE AS TO THE CONDITION OF THE PROPERTY (OR PROPERTIES) REFERENCED HEREIN OR AS TO THE ACCURACY OR COMPLETENESS OF THE INFORMATION CONTAINED HEREIN, AND SAME IS SUBMITTED SUBJECT TO ERRORS, OMISSIONS, CHANGE OF PRICE, RENTAL OR OTHER CONDITIONS, WITHDRAWAL WITHOUT NOTICE, AND TO ANY SPECIAL LISTING CONDITIONS IMPOSED BY THE PROPERTY OWNER(S). ANY PROJECTIONS, OPINIONS OR ESTIMATES ARE SUBJECT TO UNCERTAINTY AND DO NOT SIGNIFY CURRENT OR FUTURE PROPERTY PERFORMANCE.