



5027 ROBERTS AVENUE

±20,413 SF INDUSTRIAL SPACE WITH
±2,470 SF OF OFFICE

CONTACT US

ZAC SWEET, SIOR
Senior Vice President
C +1 916 717 4768
ZAC.SWEET@CBRE.COM
LIC. 01352800

JEFF KVARME
First Vice President
C + 1 916 203-5257
JEFF.KVARME@CBRE.COM
LIC.01924968

TYLER HOWELL
Senior Associate
C +1 805 428 4964
TYLER.HOWELL1@CBRE.COM
LIC. 02100245

COURTNEY LEE
Associate
C +1 916 906 5544
COURTNEY.LEE@CBRE.COM
LIC. 02031694

The CBRE logo, consisting of the letters "CBRE" in a large, bold, white, sans-serif font.

FLOOR PLAN | 5027 Roberts Ave | Building 263 F



Available ±20,413 SF* Industrial Space with ±2,470 SF* of Office

FEATURES:

- Private Offices
- Column Spacing: 20'x60'
- Grade Level Door: 10'x12' & 18'x14'
- Clear Height: 14'
- Parking: 1/1,000 SF*
- Shared Loading Dock
- Fork Lift Ramp
- Fiber Ready
- Excellent Access to I-80

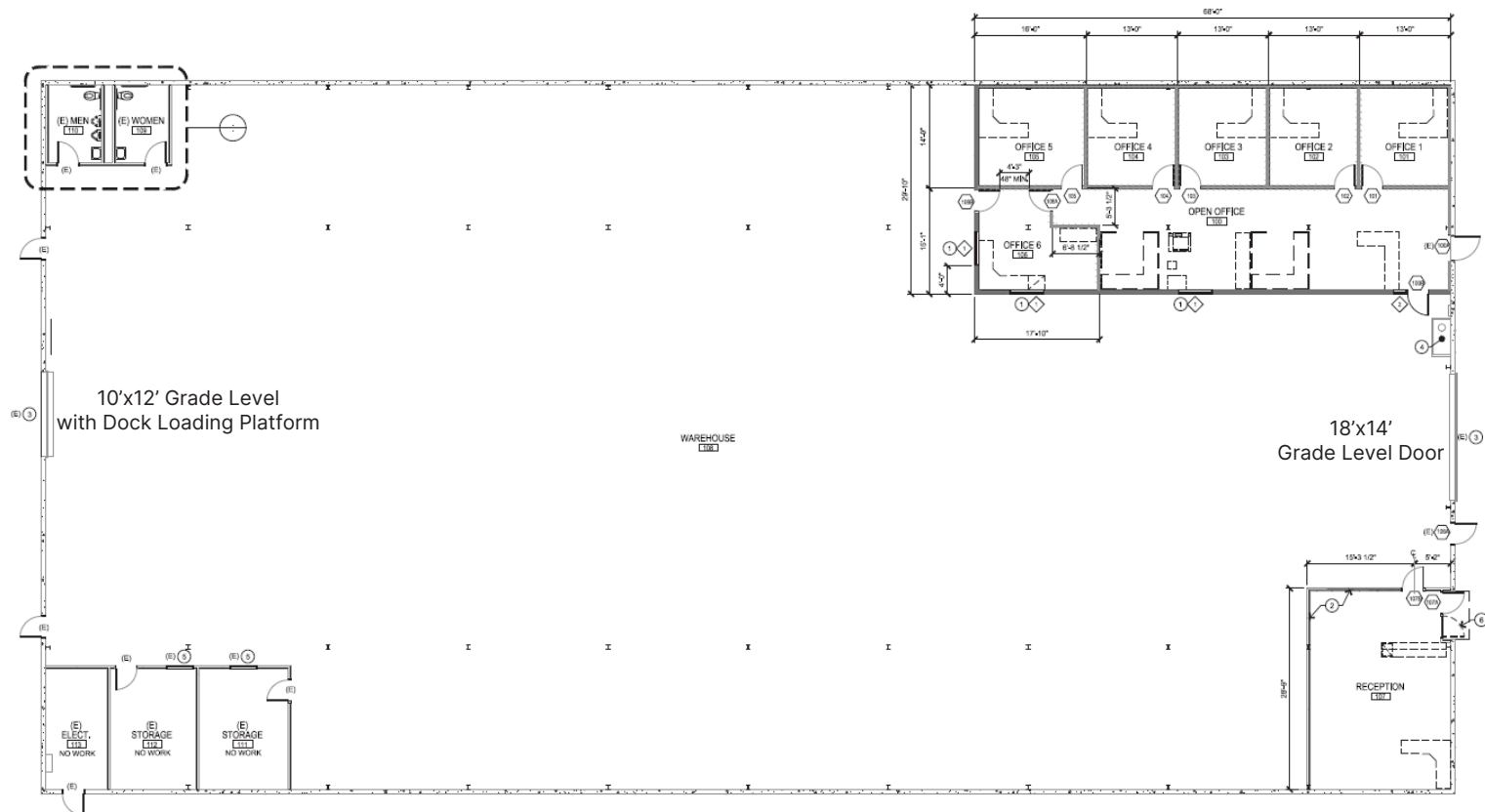

Floor plan not to scale.
*Tenant to independently verify.



AERIAL VIEW OF SITE LOCATION

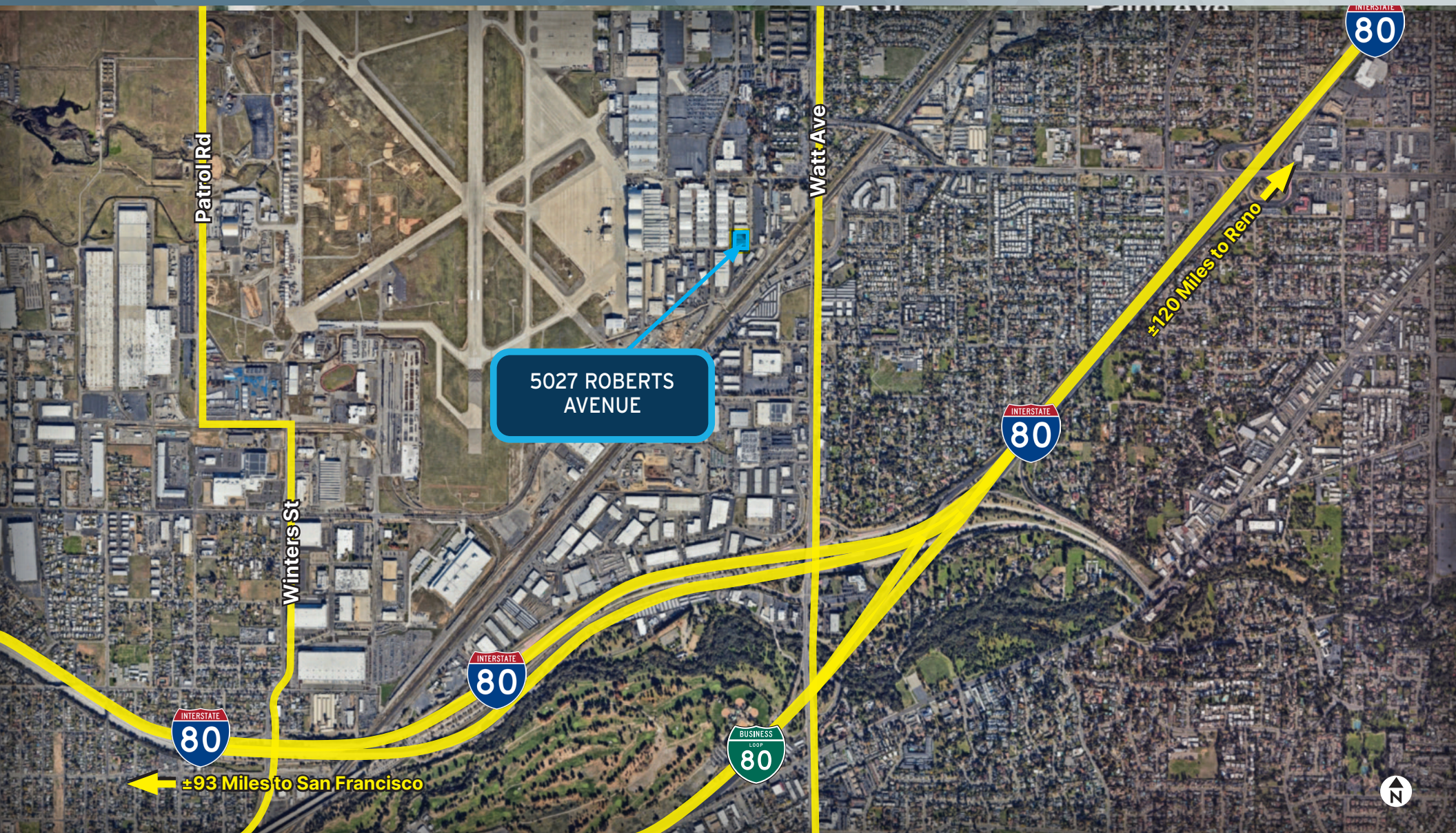

BUILDING PARK OVERVIEW | AMENITIES



LEGEND

- | | |
|--------------------------------------|--|
| 1. KeyPoint Credit Union | 13. Planet Fitness |
| 2. Broadview Federal Credit Union | 14. Americas Best Value Inn by Sonesta |
| 3. Dollar Tree | 15. Starbucks |
| 4. Texaco | 16. Panda Express |
| 5. ARCO | 17. Popeyes Louisiana Kitchen |
| 6. Quick Fuel | 18. Jack In The Box |
| 7. Chevron ExtraMile | 19. McDonald's |
| 8. ARCO | 20. Subway |
| 9. Shell | 21. Carl's Jr. |
| 10. Chevron ExtraMile | 22. Louisiana Fried Chicken |
| 11. 76 | 23. Taco Bell |
| 12. Defense Commissary Agency (DeCA) | 24. CubeSmart |
| | 25. Public Storage |
| | 26. Storage Pros |

PARK HIGHLIGHTS



- On-Site Meeting and Event Center
- On-Site Full Service Hotel
- On-Site Full Service Airport and FBO
- On-Site Restaurants
- 24/7/365 On-Site Security Patrol
- Regional Transit Shuttle to Light Rail
- Proximity to Watt Ave & I-80/Bus-80 Highways
- Residential Apartments and Homes For Rent within the Park
- Full Broker Cooperation
- Fenced/Secured Parking
- Third-Party Logistics Companies On-Site
- Opportunities to Grow within McClellan Park
- Opportunities for Intermodal Transportation (Railroad Providers: Patriot Rail, Union Pacific, & BNSF)

CONTACT US

ZAC SWEET, SIOR
Senior Vice President
C +1 916 717 4768
ZAC.SWEET@CBRE.COM
LIC. 01352800

JEFF KVARME
First Vice President
C +1 916 203-5257
JEFF.KVARME@CBRE.COM
LIC.01924968

TYLER HOWELL
Senior Associate
C +1 805 428 4964
TYLER.HOWELL1@CBRE.COM
LIC. 02100245

COURTNEY LEE
Associate
C +1 916 906 5544
COURTNEY.LEE@CBRE.COM
LIC. 02031694



**McCLELLAN
PARK**

WWW.CBRE.COM/SACRAMENTO

© 2026 CBRE, Inc. All rights reserved. This information has been obtained from sources believed reliable, but has not been verified for accuracy or completeness. You should conduct a careful, independent investigation of the property and verify all information. Any reliance on this information is solely at your own risk. CBRE and the CBRE logo are service marks of CBRE, Inc. All other marks displayed on this document are the property of their respective owners, and the use of such logos does not imply any affiliation with or endorsement of CBRE. Photos herein are the property of their respective owners. Use of these images without the express written consent of the owner is prohibited.PMStudio_April2026