

144 WEST 27TH STREET

Between 6th & 7th Avenues

CHELSEA | MIDTOWN WEST



RETAIL CONDO FOR SALE



144 WEST 27TH STREET

RETAIL CONDO FOR SALE

144 West 27th Street – New York, New York 10001
(Between 6th and 7th Avenues)

Block: 802

Lot: 1001

SIZE

Ground Floor:

Approximately 5,000 SF

Selling Lower Level:

Approximately 4,500 SF

CEILINGS

Ground Floor:

16'

Lower Level:

10'5"

ASKING PRICE

Upon Request

TAXES

\$135,977 (2024/2025)

CAM

\$72,000

COMMENTS

- Prime Chelsea retail/restaurant opportunity located steps away from FIT and Penn Station
- Directly adjacent to the new INNSIDE by Melia hotel with over 300 rooms
- Sky lights and windows in the rear of the space on ground and lower levels for great natural light throughout

NEIGHBORS

FIT, INNSIDE by Melia, Kobeyaki, Planet Fitness, Hilton New York, Ainsworth, Chipotle, Rare Bar & Grill



1ST FLOOR

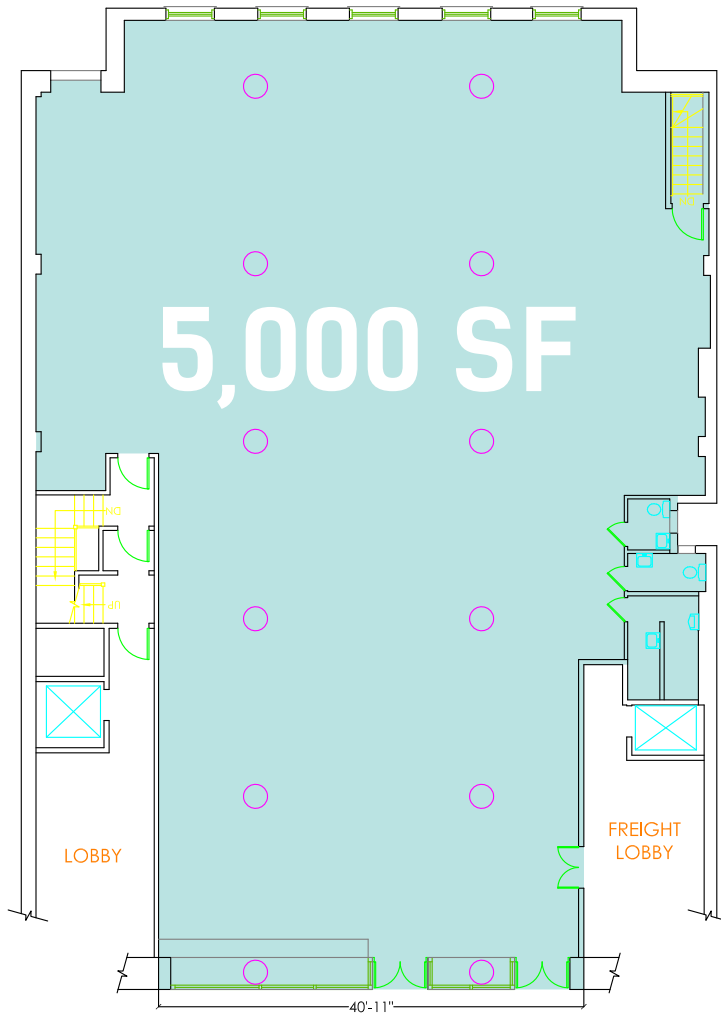

WEST 27th STREET

BASEMENT

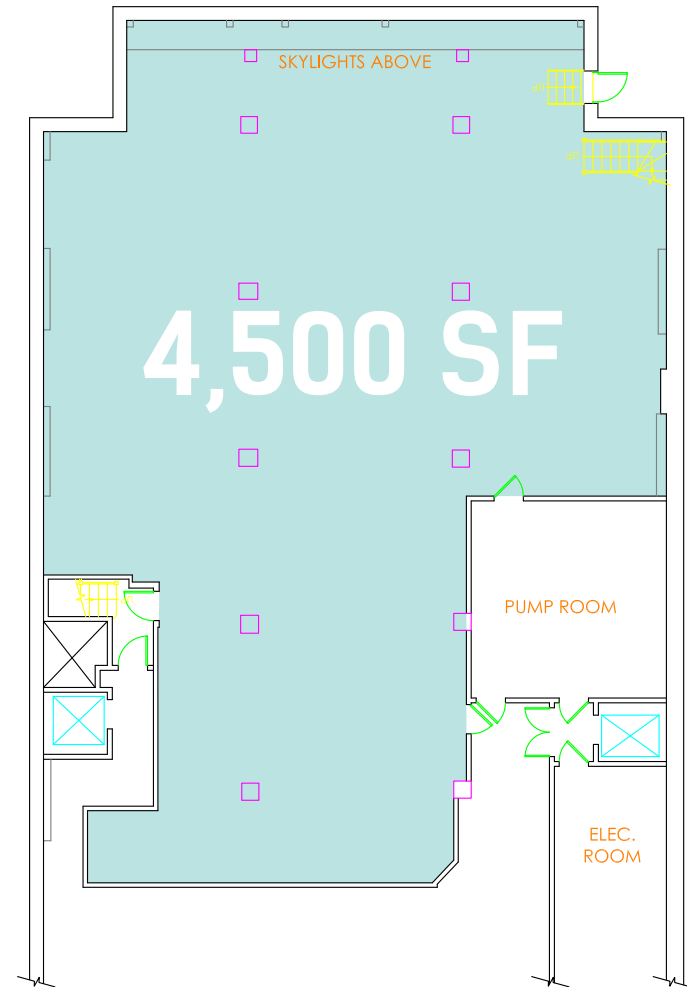

WEST 27th STREET

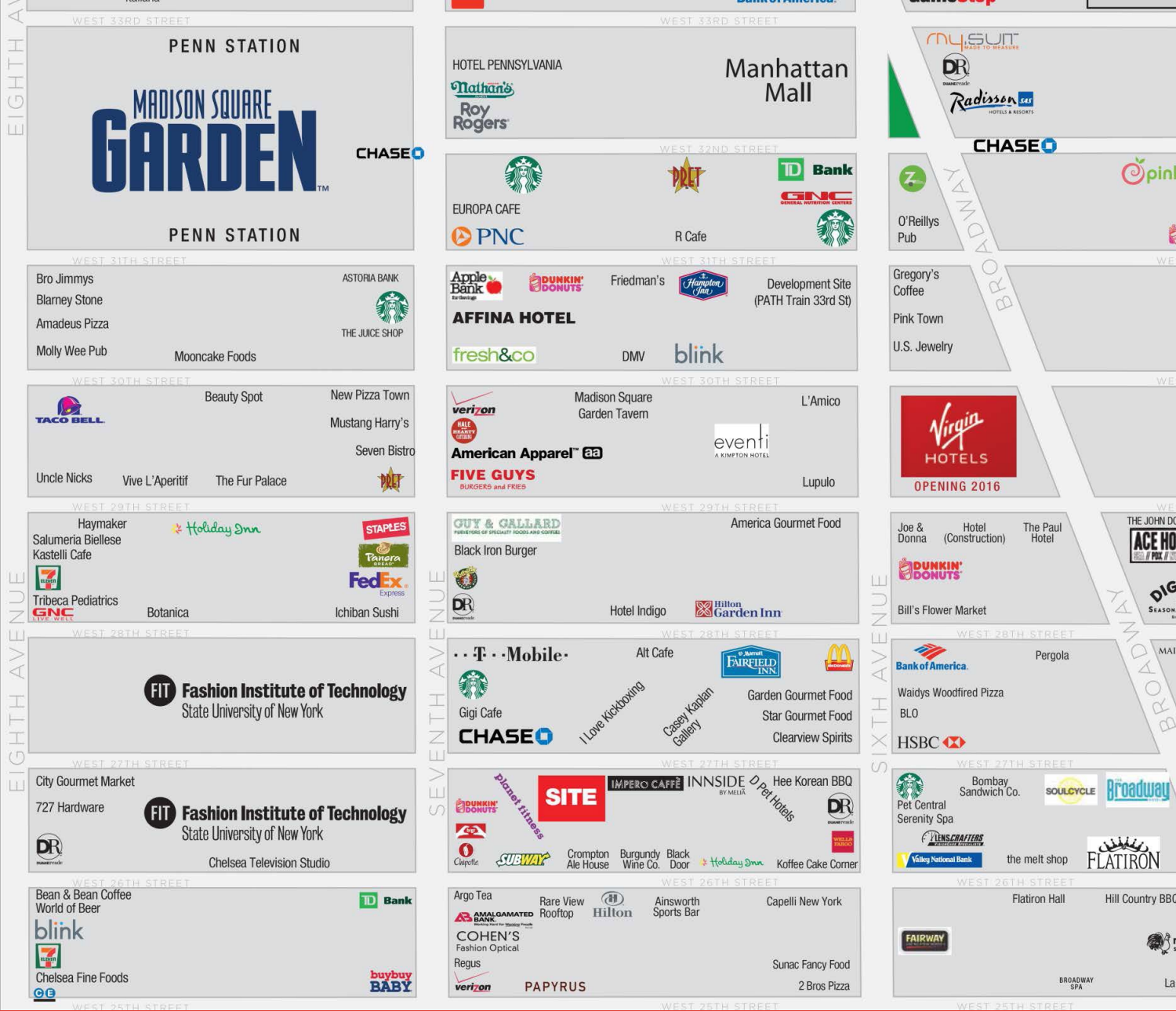

144 WEST 27TH STREET RETAIL CONDO FOR SALE

FOR MORE INFORMATION CONTACT
EXCLUSIVE AGENTS:

LEE BLOCK
212.792.2649
lee@rtl-re.com

JEFF WINICK
212.792.2601
jeff@rtl-re.com

**CHELSEA
MIDTOWN
WEST**



RTL Partners LLC, Licensed Real Estate Brokers
655 Third Avenue, 24th Floor | New York, NY 10017
T 212.792.2600 | F 212.792.2660 | rtl-re.com

ALTHOUGH ALL INFORMATION REGARDING PROPERTY FOR SALE, RENTAL OR FINANCING IS FROM SOURCES DEEMED RELIABLE SUCH INFORMATION HAS NOT BEEN VERIFIED, AND NO EXPRESS REPRESENTATION IS MADE NOR IS ANY TO BE IMPLIED AS TO THE ACCURACY THEREOF, AND IT IS SUBMITTED SUBJECT TO ERRORS, OMISSIONS, CHANGE OF PRICE, RENTAL OR OTHER CONDITIONS, PRIOR SALE, LEASE OR FINANCING, OR WITHDRAWAL WITHOUT NOTICE