

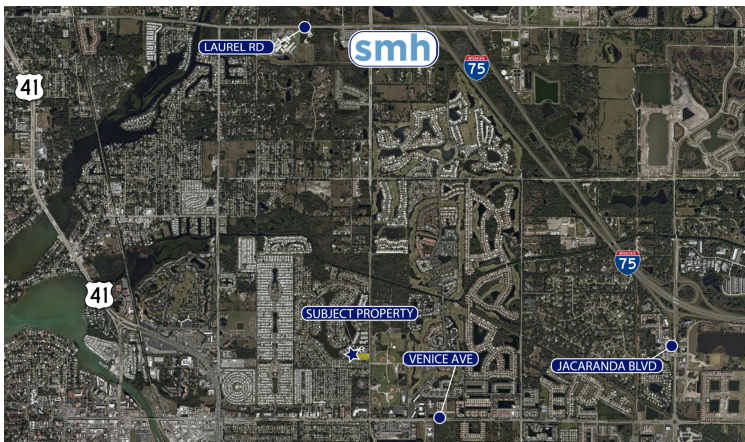

DEVELOPMENT OPPORTUNITY FOR ASSISTED LIVING HOUSING 1220 Pinebrook Rd , Venice, FL 34285



PROPERTY OVERVIEW

Prime opportunity to purchase an infill suburban development site suitable for assisted living, office or residential. The existing PUD allows for up to 110 ALF units in an up to 9 story building. The property enjoys an excellent location positioned between the vibrant retail activity on Venice Ave and the new growth to the east and on Laurel Rd.

PROPERTY SUMMARY

Sale Price:	Subject To Offer
Lot Size:	2.4 Acres
Zoning:	Planned Unit Development (PUD)
Market:	Venice



MICHELE FULLER
941.228.4189
michele@ian-black.com



IAN BLACK, CCIM
941.906.8688 x102
ian@ian-black.com



DEVELOPMENT OPPORTUNITY FOR ASSISTED LIVING HOUSING

ADDITIONAL PHOTOS

Development Opportunity for Assisted Living Housing

1220 Pinebrook Rd , Venice, FL 34285

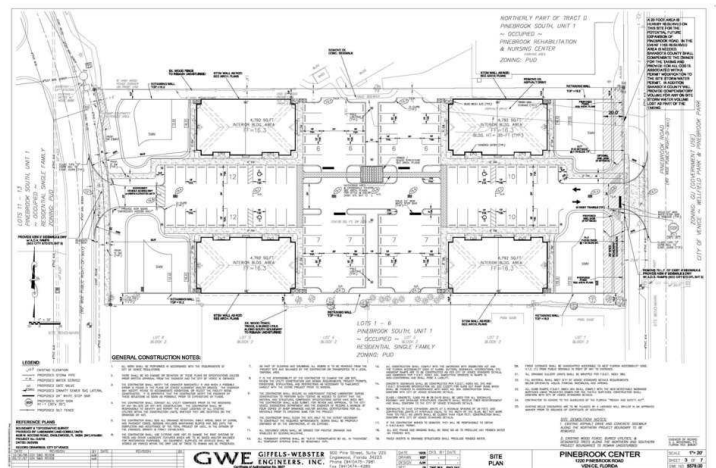
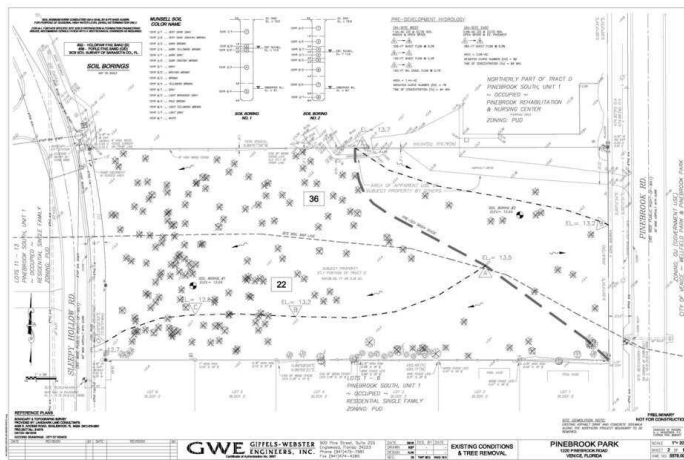
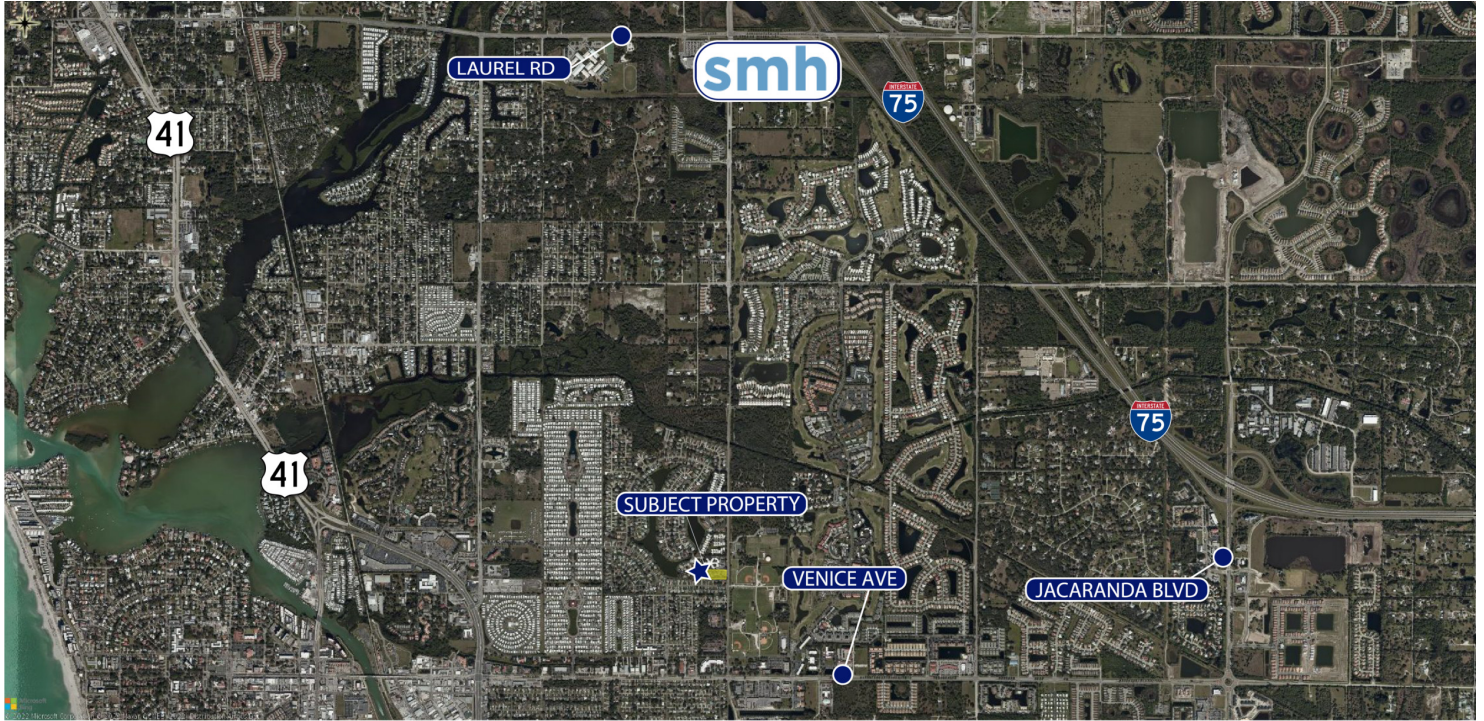

MICHELE FULLER
941.228.4189
michele@ian-black.com



IAN BLACK, CCIM
941.906.8688 x102
ian@ian-black.com

IAN BLACK
REAL ESTATE
THE PLACE FOR SPACE