

INDUSTRIAL BUILDING FOR LEASE

**865 S. WASHINGTON AVENUE**

SAN BERNARDINO, CA 92408



FOR LEASE  
**107,600 SF**

**CONTACT**

**Chuck Belden, SIOR**  
909 942 4640  
chuck.belden@cushwake.com  
Lic. No: 00844840

**Tim Pimentel, SIOR**  
909 942 4647  
tim.pimentel@cushwake.com  
Lic. No: 01421452

**Brice Larson**  
909 942 4642  
brice.larson@cushwake.com  
Lic. No: 02056356

**Chris Pimentel**  
909 942 4600  
chris.pimentel@cushwake.com  
Lic. No: 02207362





## // PROPERTY FEATURES

### BUILDING SIZE

107,600 SF

### SITE AREA

4.79 ACRES

### CLEAR HEIGHT

32' INTERIOR

### OFFICE AREA

±8,000 SF

### LOADING DOCKS

16 (9' X 10')

### DRIVE-IN DOOR

1 (12' X 14')

### CAR PARKING

75 SPACES

### SPRINKLERS

ESFR

### ELECTRICAL

1,200 AMP, 277/480V  
(EXPANDABLE TO 4,000 AMP)

### SKYLIGHTS

3% SKYLIGHTS W/ BURGLAR BARS

### FLOOR SLAB

7", 4,000 PSI (REINFORCED)

### LOCATION

I-215 FREEWAY ACCESS VIA  
ORANGE SHOW RD ON/OFF  
RAMPS AND I-10 FREEWAY ACCESS  
VIA WATERMAN AVE ON/OFF  
RAMPS

# // SITE PLAN

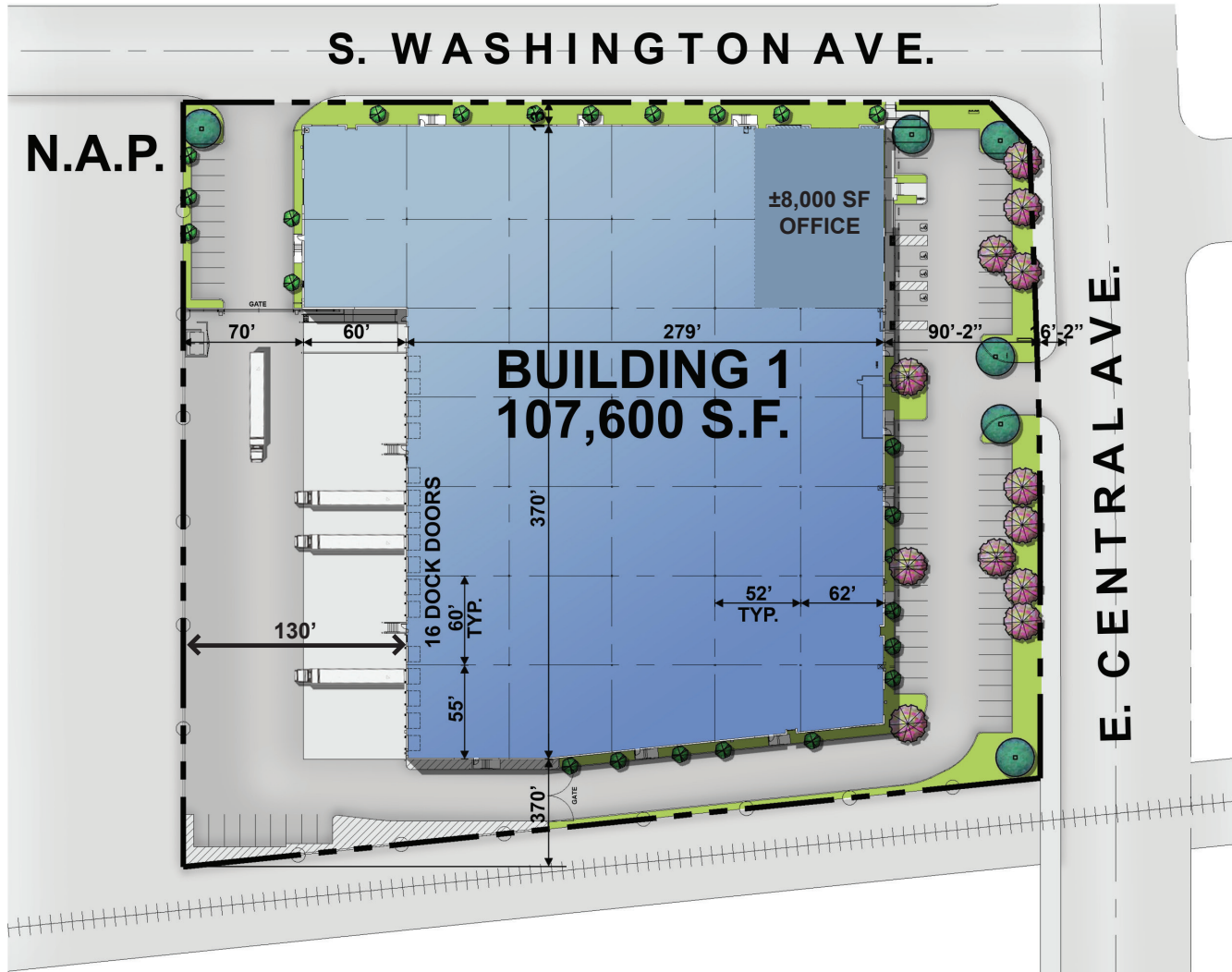

Development, Marketing & Management by:



Asset Management by:



// 865 S. WASHINGTON AVENUE  
San Bernardino, CA 92408

No warranty or representation, express or implied, is made as to the accuracy of the information contained herein, and same is submitted subject to errors, omissions, change of price, rental or other conditions, withdrawal without notice, and to any specific listing conditions, imposed by our principals. This listing shall not be deemed an offer to lease, sublease or sell such property and, in the event of any transaction for such property, no commission shall be earned by or payable to any cooperating broker except if otherwise provided pursuant to the express terms, rate and conditions of C&W's arrangement with its principal, if, as and when such commission (if any) is actually received from such principal.



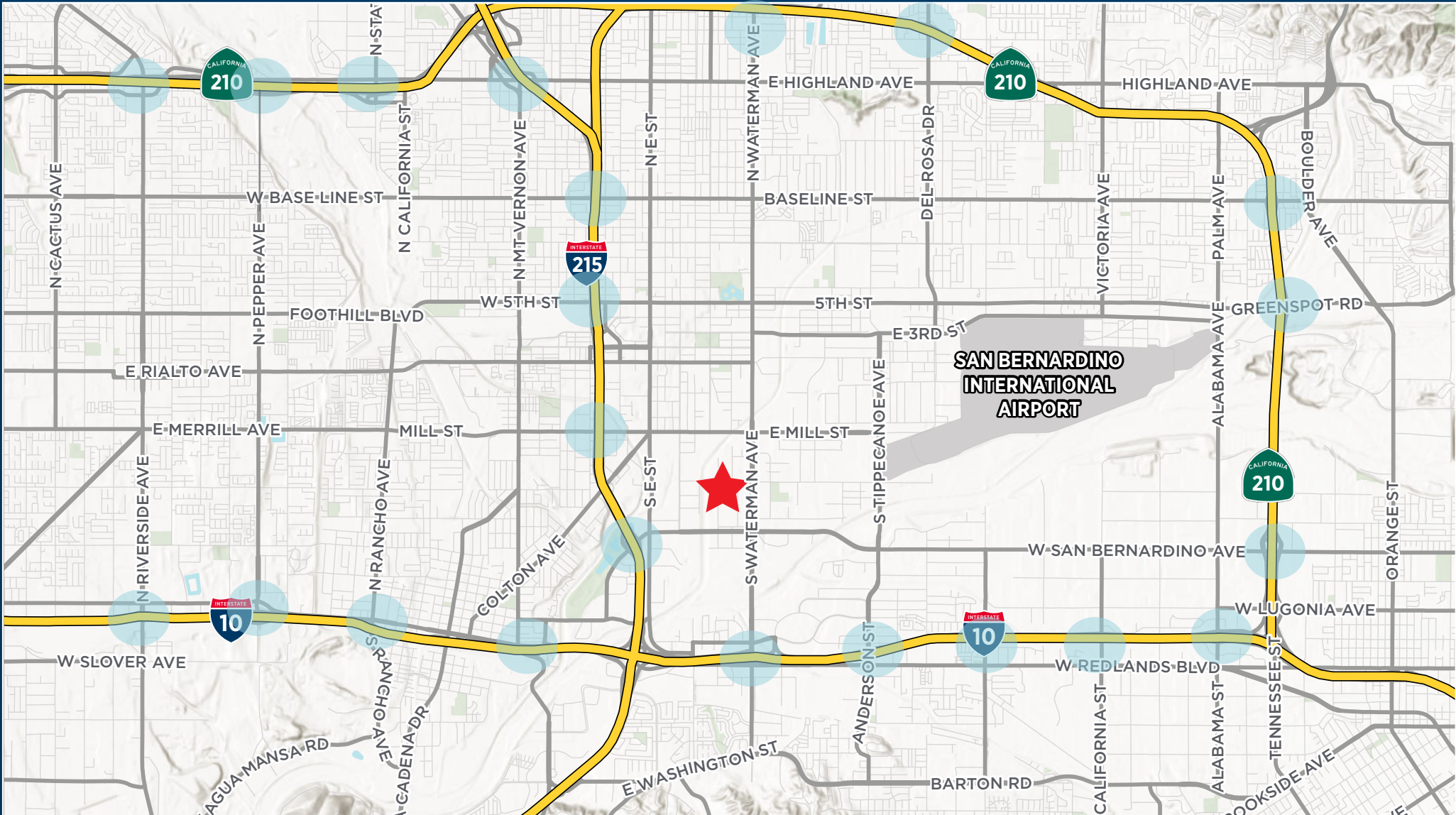

**CONTACT**

**Chuck Belden, SIOR**  
 909 942 4640  
 chuck.belden@cushwake.com  
 Lic. No: 00844840

**Tim Pimentel, SIOR**  
 909 942 4647  
 tim.pimentel@cushwake.com  
 Lic. No: 01421452

**Brice Larson**  
 909 942 4642  
 brice.larson@cushwake.com  
 Lic. No: 02056356

**Chris Pimentel**  
 909 942 4600  
 chris.pimentel@cushwake.com  
 Lic. No: 02207362



901 Via Piemonte, Suite 200 | Ontario, California 91764

©2023 Cushman & Wakefield. All rights reserved. The material in this presentation has been prepared solely for information purposes, and is strictly confidential. Any disclosure, use, copying or circulation of this presentation (or the information contained within it) is strictly prohibited, unless you have obtained Cushman & Wakefield's prior written consent. The views expressed in this presentation are the views of the author and do not necessarily reflect the views of Cushman & Wakefield. Neither this presentation nor any part of it shall form the basis of, or be relied upon in connection with any offer, or act as an inducement to enter into any contract or commitment whatsoever. NO REPRESENTATION OR WARRANTY IS GIVEN, EXPRESS OR IMPLIED, AS TO THE ACCURACY OF THE INFORMATION CONTAINED WITHIN THIS PRESENTATION, AND CUSHMAN & WAKEFIELD IS UNDER NO OBLIGATION TO SUBSEQUENTLY CORRECT IT IN THE EVENT OF ERRORS.