



RETAIL PROPERTY/PAD SITE AVAILABLE

RIGGS PLAZA

5735-5815 EASTERN AVE, HYATTSVILLE, MD 20782



RIGGS PLAZA

5735-5815 EASTERN AVE, HYATTSVILLE, MD 20782

PROPERTY OVERVIEW



OFFERING SUMMARY

Available SF:	250 - 10,000 SF
Lease Rate:	Negotiable
Lot Size:	2.83 Acres
Building Size:	95,531 SF
Zoning:	CSC
Market:	Hyattsville
Submarket:	Chillum
Traffic Count:	20,511

PROPERTY HIGHLIGHTS

- 10,000 square feet of lower level (on grade) space.
- Landlord will install a new roll up door for access to the space.
- 2.83 Acre pad site available.
- Tenants include Giant Foods, MetroPCS, & DaVita.
- Multiple points of access and strong visibility from Riggs Road (20,000 ADT).
- Densely populated area with 110,986 households within a 3-mile radius.
- Average household income of \$91,857 within a 3-mile radius.
- Abundant surface level parking.
- Located on the border of Maryland and Washington D.C.
- Strong PM side of the street traffic and access.

RIGGS PLAZA

5735-5815 EASTERN AVE, HYATTSVILLE, MD 20782

RETAILER MAP

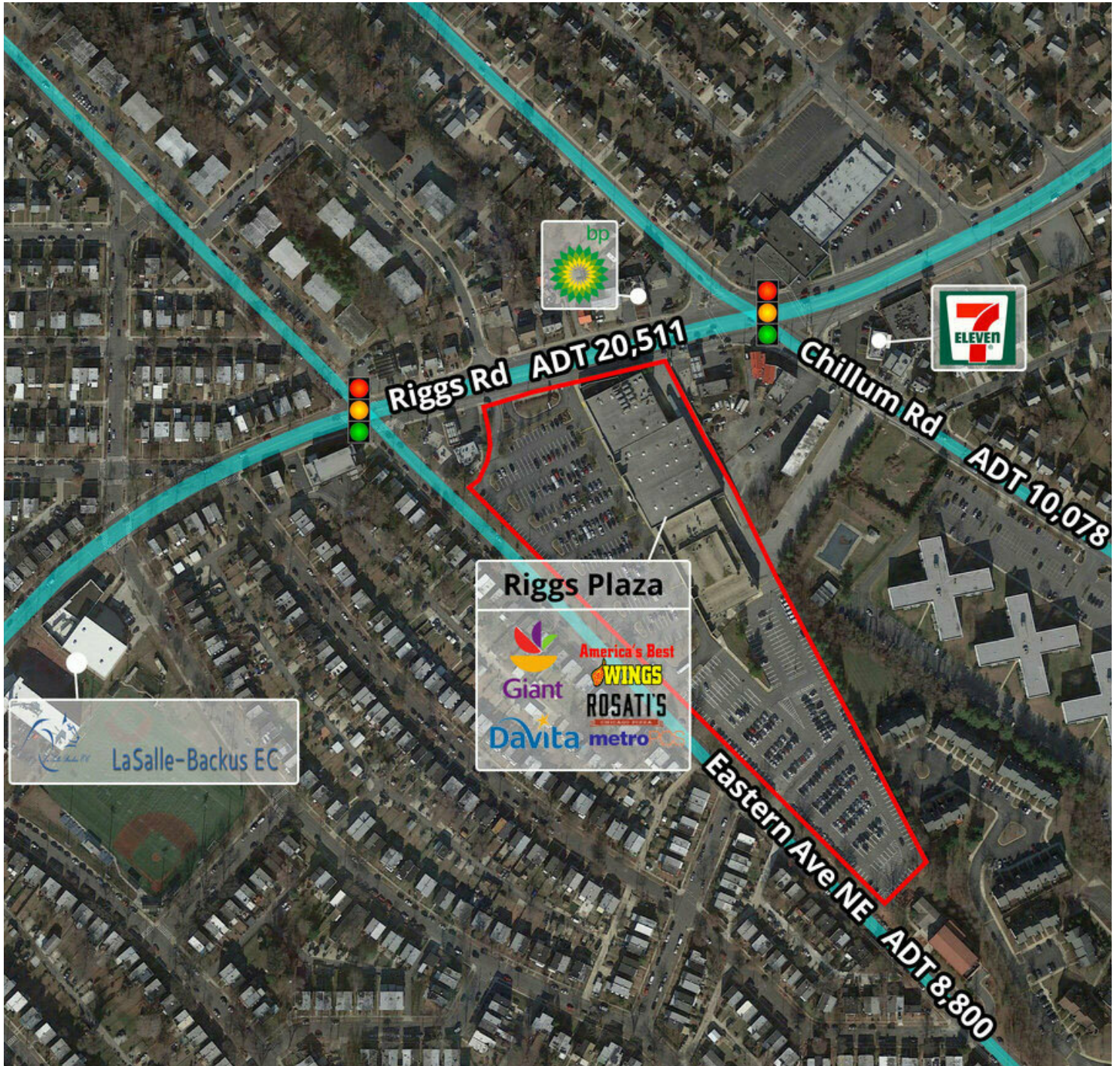

RIGGS PLAZA

5735-5815 EASTERN AVE, HYATTSVILLE, MD 20782

SITE PLAN



1	METROPCS	1,990 SF
2	GIANT FOOD	45,561 SF
3	AVAILABLE	250 SF
4	BURKE LIQUORS	2,656 SF
5	AMERICA'S BEST WINGS	3,000 SF
6	ROSATI'S PIZZA	1,337 SF
7	NAIL SALON	1,365 SF
8	DAVITA DIALYSIS	8,000 SF
8 LL	AVAILABLE	10,000 SF
9	BARBER SHOP	500 SF
10	AVAILABLE	500 SF

RIGGS PLAZA

5735-5815 EASTERN AVE, HYATTSVILLE, MD 20782

UNIT 8 | LOWER LEVEL

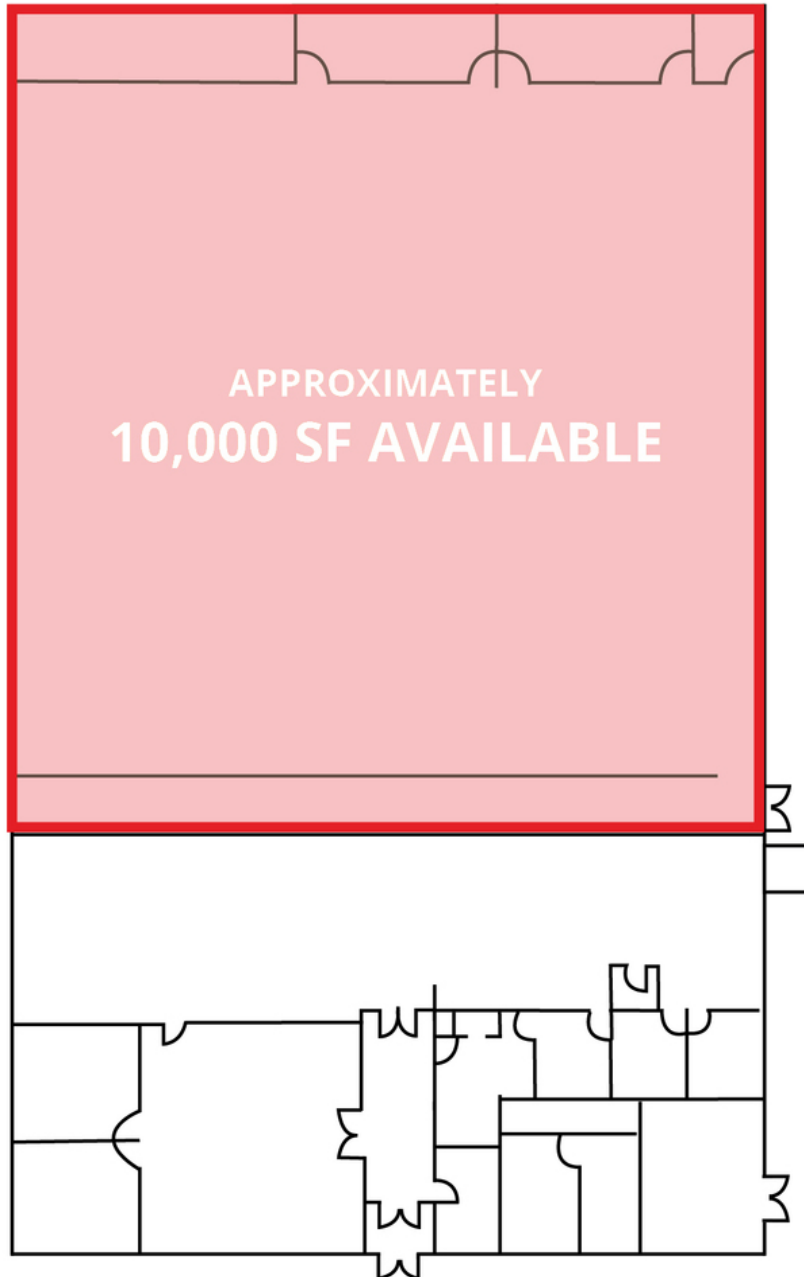

RIGGS PLAZA

5735-5815 EASTERN AVE, HYATTSVILLE, MD 20782

DEMOGRAPHICS MAP

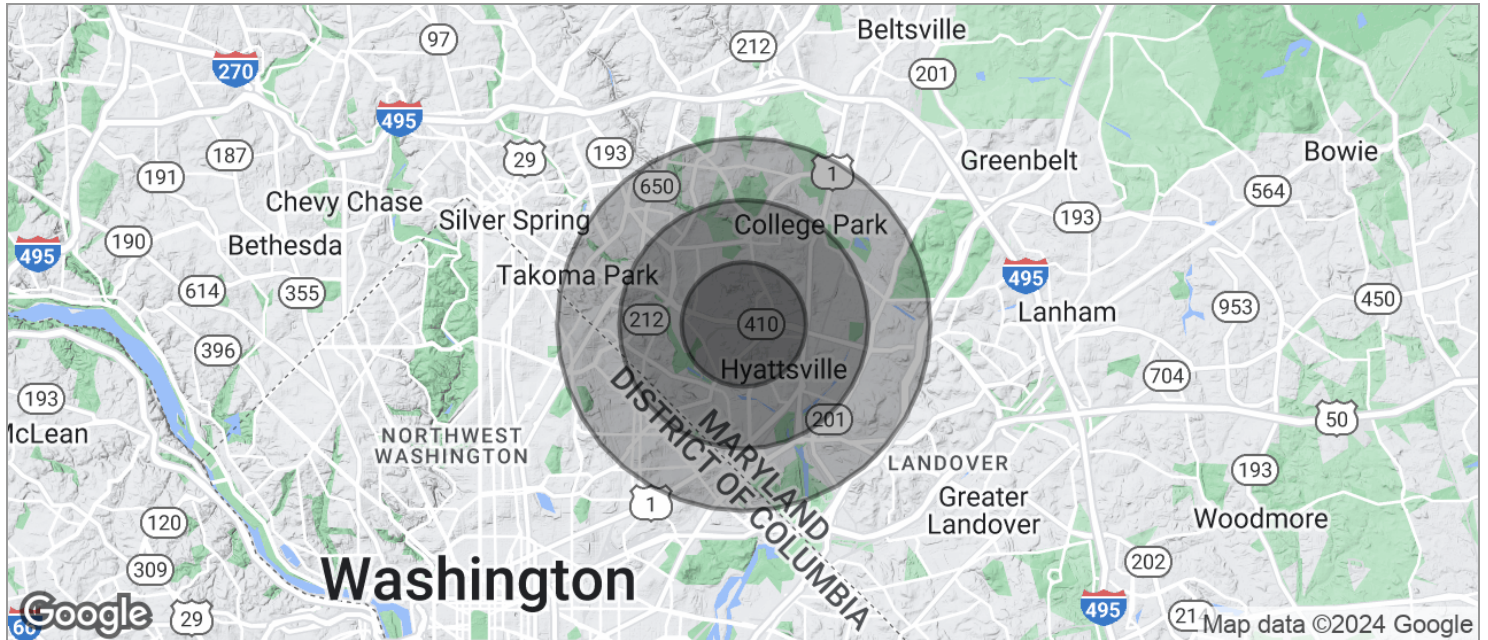

	1 MILE	2 MILES	3 MILES
POPULATION			
TOTAL POPULATION	32,646	135,770	300,009
MEDIAN AGE	39.5	37.7	36.4
MEDIAN AGE (MALE)	35.7	35.9	34.5
MEDIAN AGE (FEMALE)	41.7	38.6	37.6
HOUSEHOLDS & INCOME			
TOTAL HOUSEHOLDS	12,632	50,287	110,986
# OF PERSONS PER HH	2.7	2.7	2.7
AVERAGE HH INCOME	\$78,373	\$87,943	\$91,857
AVERAGE HOUSE VALUE	\$357,690	\$423,363	\$415,881

* Demographic data derived from 2020 ACS - US Census

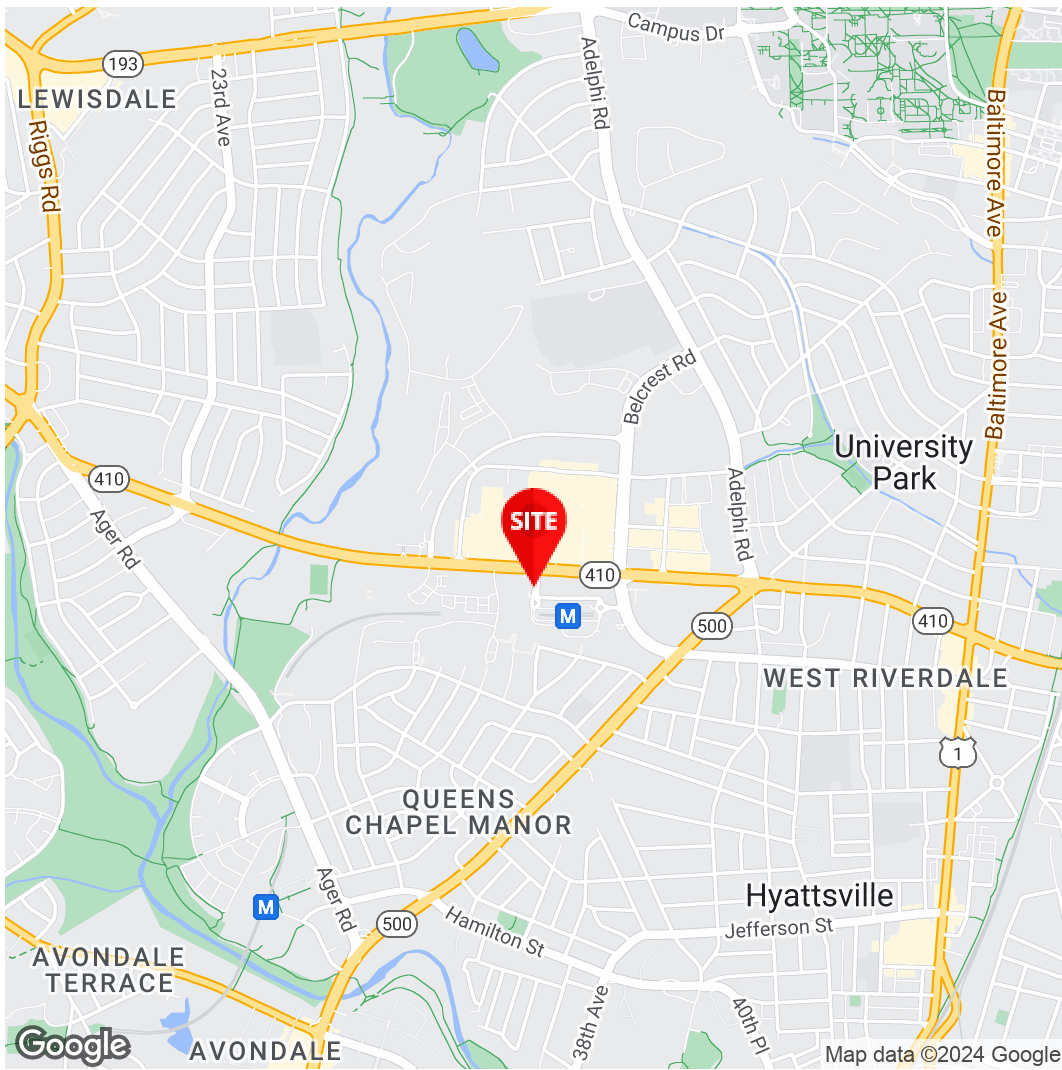

Joseph Farina
Principal
571.389.7362
jfarina@Divaris.Com

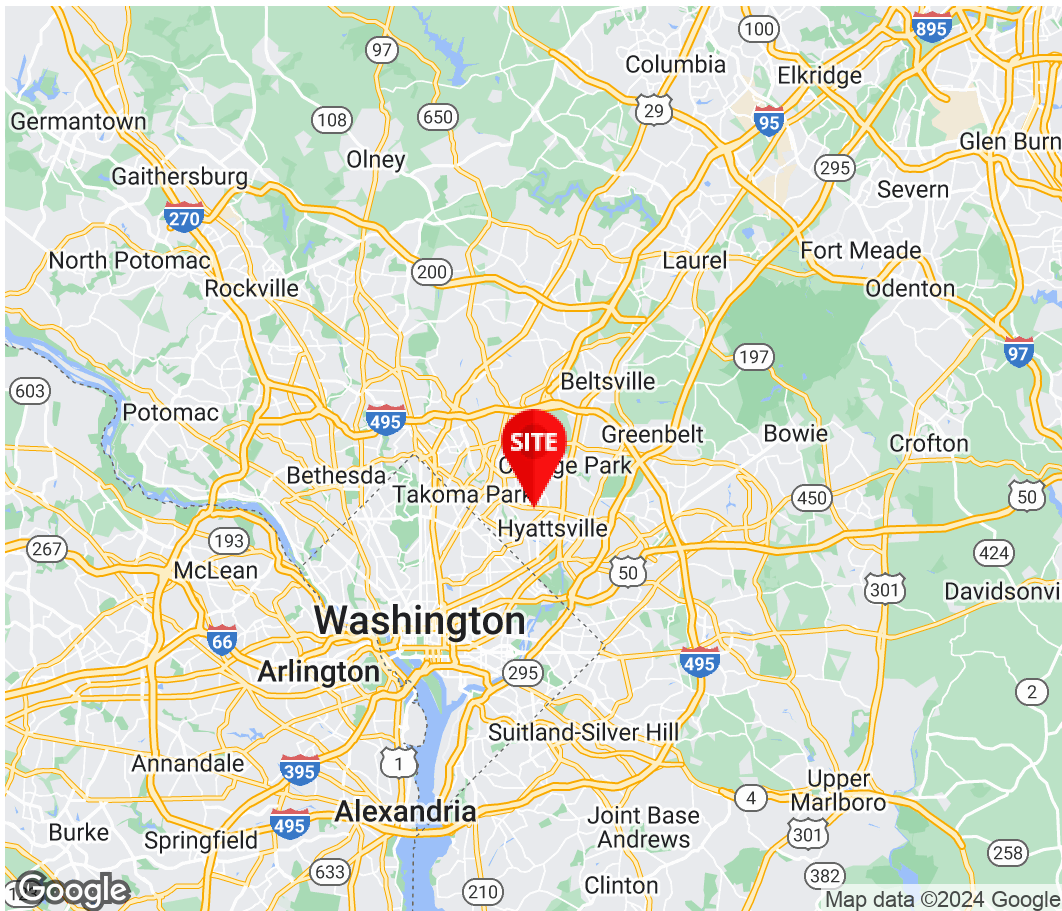

The information contained herein should be considered confidential and remains the sole property of Divaris Real Estate, Inc. at all times. Although every effort has been made to ensure accuracy, no liability will be accepted for any errors or omissions. Disclosure of any information contained herein is prohibited except with the express written permission of Divaris Real Estate, Inc.