



Available: For Lease

## WAREHOUSE IN SUN VALLEY

±17,640 SQUARE FEET AVAILABLE | Just Leased 11,200 SF

8647 San Fernando Rd | Sun Valley, CA 91351

### GREG BARSAMIAN

Senior Vice President

+1 (818) 406-3658

Lic. No. 00873206

[gregory.barsamian@cbre.com](mailto:gregory.barsamian@cbre.com)

### JULIEN MASCARADE

Associate

+1 (310) 613-3549

Lic. No. 02204928

[julien.mascarade@cbre.com](mailto:julien.mascarade@cbre.com)

**CBRE**

# Property Highlights

8647 San Fernando Rd. Sun Valley, CA 91352

## Property Information:

**Lease Rate:** YR:1 \$0.95 IG / Yr:2 \$1.35 IG  
Yearly lease rate increases will apply after year two

**Rentable SF:** ±17,640 SF

**Configuration:** The Building is 28,840 SF.  
17,640 is available and 11,200 has been leased.

**Building Type:** Warehouse

**Loading Doors:** 2 Ground Level

**Power:** 100a/120-240v 1p 3w

**Ceiling Clearance:** 16-32 ft

**Zoning:** M1

## Features:

- Inexpensive warehouse and storage space
- Immediate Golden State Freeway access
- Great natural light
- Ideal for all storage uses
- Private fenced yard with additional fenced parking available on Tujunga Avenue directly behind the property

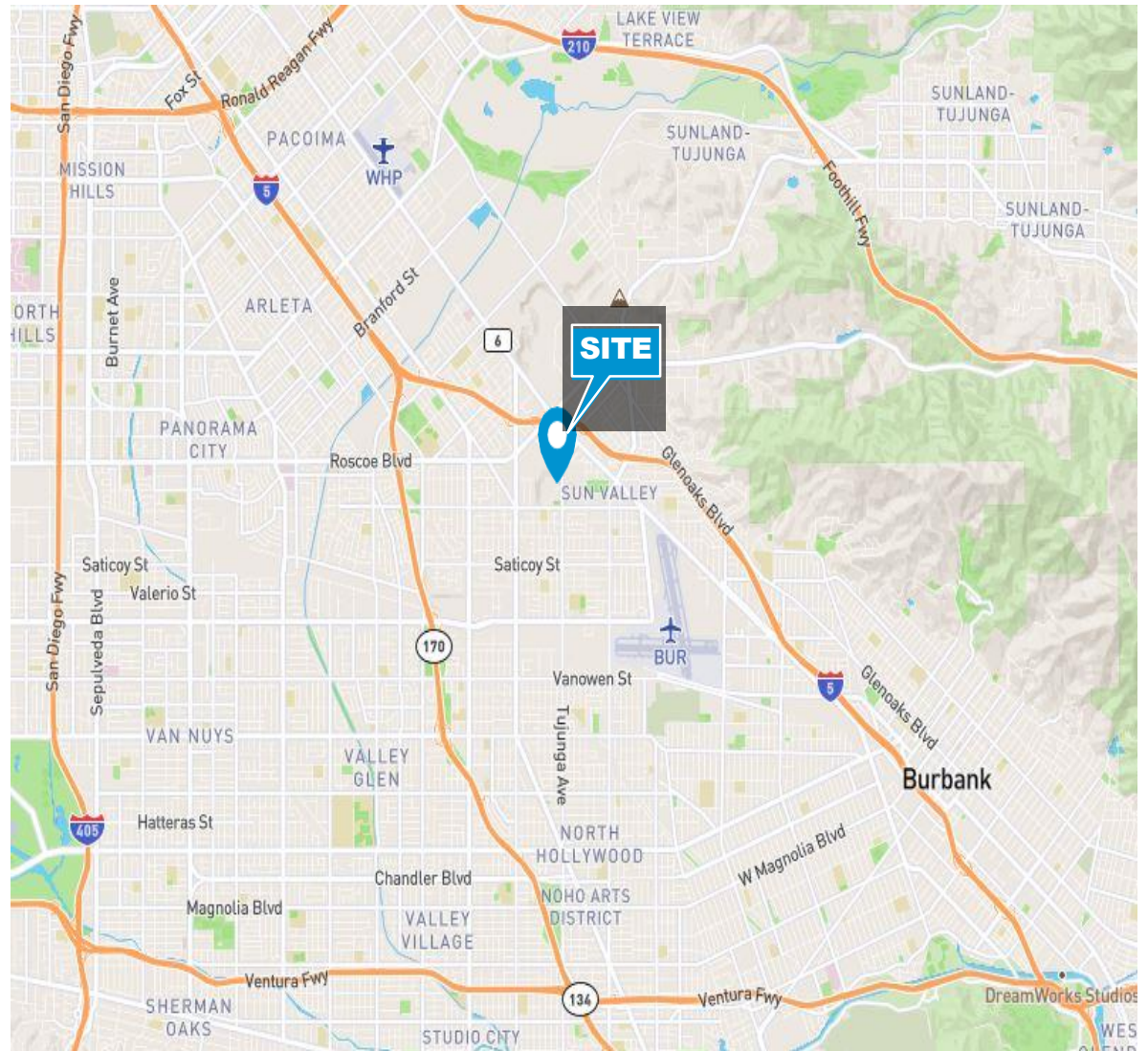

**CBRE**

234 S. Brand Boulevard | Suite 800  
Glendale, CA 91204  
☎ +1 818 406 3658  
[www.CBRE.com](http://www.CBRE.com)

Leaders of Market Knowledge and Global Insight

# Property Photos



© 2022 CBRE, Inc. All rights reserved. This information has been obtained from reliable sources but has not been verified for accuracy or completeness. CBRE, Inc. makes no guarantee, representation, or warranty and accepts no responsibility or liability for the accuracy, completeness, or reliability of the information contained herein. You should conduct a careful, independent investigation of the property and verify all information. Any reliance on this information is solely at your own risk. CBRE and the CBRE logo are service marks of CBRE, Inc. All other marks displayed on this document are the property of their respective owners, and the use of such marks does not imply any affiliation with or endorsement of CBRE. Photos herein are the property of their respective owners. Use of these images without the express written consent of the owner is prohibited.

**CBRE**

234 S. Brand Boulevard | Suite 800

Glendale, CA 91204

☎ +1 818 406 3658

[www.CBRE.com](http://www.CBRE.com)

Leaders of Market Knowledge and Global Insight

# Amenities Map

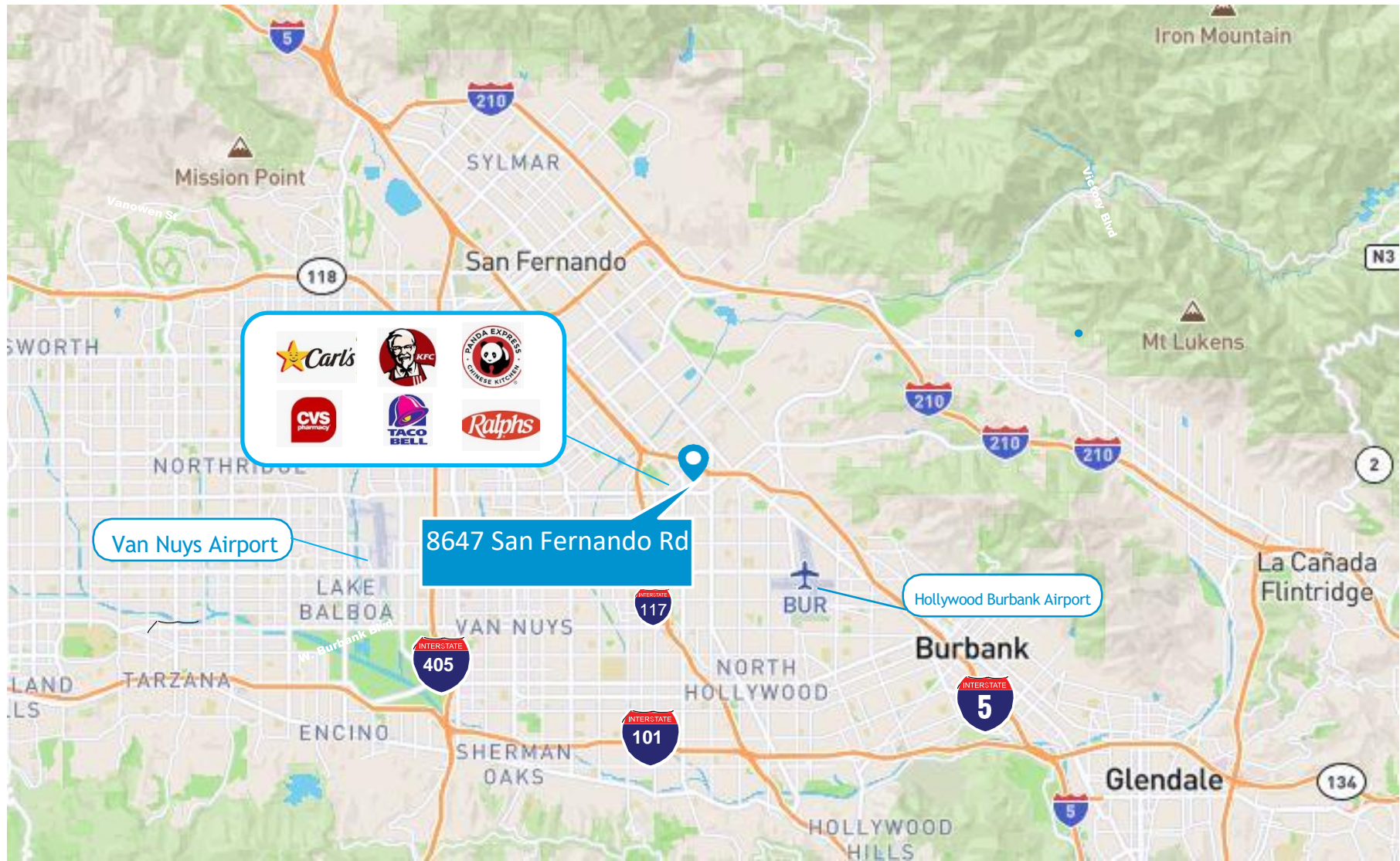

**CBRE**

234 S. Brand Boulevard | Suite 800  
Glendale, CA 91204  
☎ +1 818 406 3658  
[www.CBRE.com](http://www.CBRE.com)

Leaders of Market Knowledge and Global Insight

© 2022 CBRE, Inc. All rights reserved. This information has been obtained from reliable sources but has not been verified for accuracy or completeness. CBRE, Inc. makes no guarantee, representation, or warranty and accepts no responsibility or liability for the accuracy, completeness, or reliability of the information contained herein. You should conduct a careful, independent investigation of the property and verify all information. Any reliance on this information is solely at your own risk. CBRE and the CBRE logo are service marks of CBRE, Inc. All other marks displayed on this document are the property of their respective owners, and the use of such marks does not imply any affiliation with or endorsement of CBRE. Photos herein are the property of their respective owners. Use of these images without the express written consent of the owner is prohibited.

San Fernando Rd.

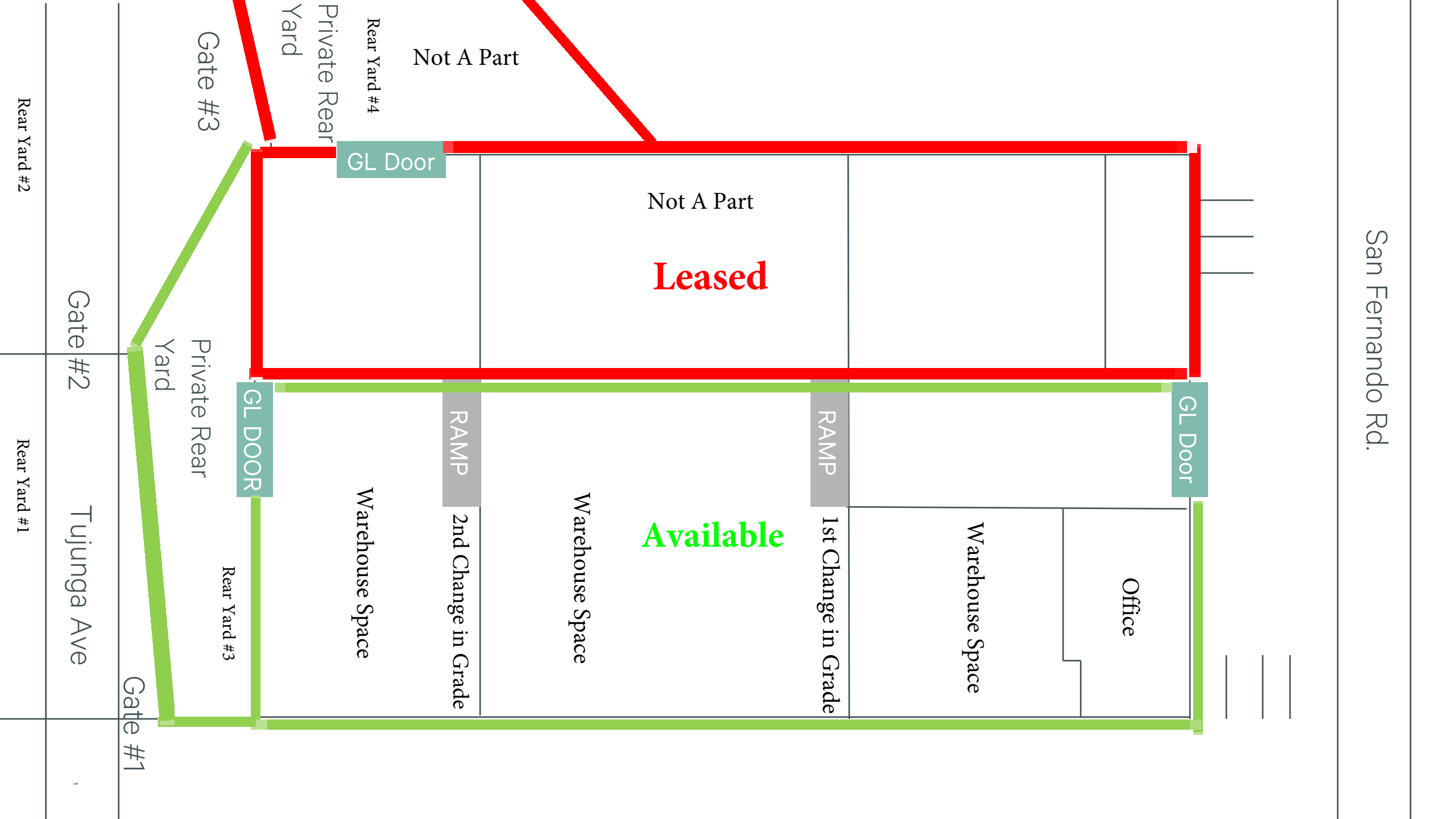

Gate #2 Tujunga Ave

Gate #1

Gate #3

Rear Yard #2

Rear Yard #1

Private Rear Yard

Warehouse Space

RAMP 2nd Change in Grade

Warehouse Space

Available

RAMP 1st Change in Grade

Warehouse Space

Office

GL Door

GL Door

Rear Yard #4

Rear Yard #3

Private Rear Yard

# Contact Us



## GREG BARSAMIAN

Senior Vice President

☎ +1 (818) 406-3658

Lic. No. 00873206

[gregory.barsamian@cbre.com](mailto:gregory.barsamian@cbre.com)

## STEVE SCOTT

President

☎ +1 (818) 606-5861

Lic. No. 00954006

[steve@sscommercialrealty.com](mailto:steve@sscommercialrealty.com)

## JULIEN MASCARADE

Associate

☎ +1 (310) 613-3549

Lic. No. 02204928

[julien.mascarade@cbre.com](mailto:julien.mascarade@cbre.com)

## CBRE

234 S. Brand Boulevard | Suite 800

Glendale, CA 91204

☎ +1 818 406 3658

[www.CBRE.com](http://www.CBRE.com)

Leaders of Market Knowledge and Global Insight