



**SUBLEASE | 4,708 SF – DOCK HIGH & CLEAR SPAN**

**6102 Benjamin Road, Tampa, FL 33634**

**2 DOCK HIGH DOORS | CORNER UNIT | 1 MILE FROM TAMPA INTERNATIONAL**

Robbie Lober, SIOR  
Managing Member  
727 999 1806  
Robbie@Loberrealestate.com

Devin Beeler, CPA  
Senior Associate  
727 709 2179  
Devin@Loberrealestate.com

**LOBER**  
REAL ESTATE INVESTMENTS AND LEASING



# Property Overview

<b>Google Maps Link:</b>	<a href="#"><u>Click Link Here!</u></a>
<b>Address:</b>	6102 Benjamin Rd, Tampa, FL 33634
<b>Unit Size:</b>	4,708 SF (clear span)
<b>Term:</b>	Negotiable
<b>Loading:</b>	Two (2) dock high doors (10'Wx10'H)
<b>Power:</b>	400 Amps 280 Volt 3 phase
<b>Clear Height:</b>	18 ft
<b>Zoning:</b>	SPI-AP-3 - Special Public Interest - Airport
<b>Office:</b>	400 sq ft + 2 restrooms
<b>County / Market:</b>	Hillsborough / Tampa Airport

**Call or text for pricing & details!  
Same day showings offered!**

**Devin Beeler (727) - 709 - 2179  
Robbie Lober (727) - 999 - 1806**





# Unit Photos



# FLOOR PLAN

6102 Benjamin Rd, Tampa, FL 33634

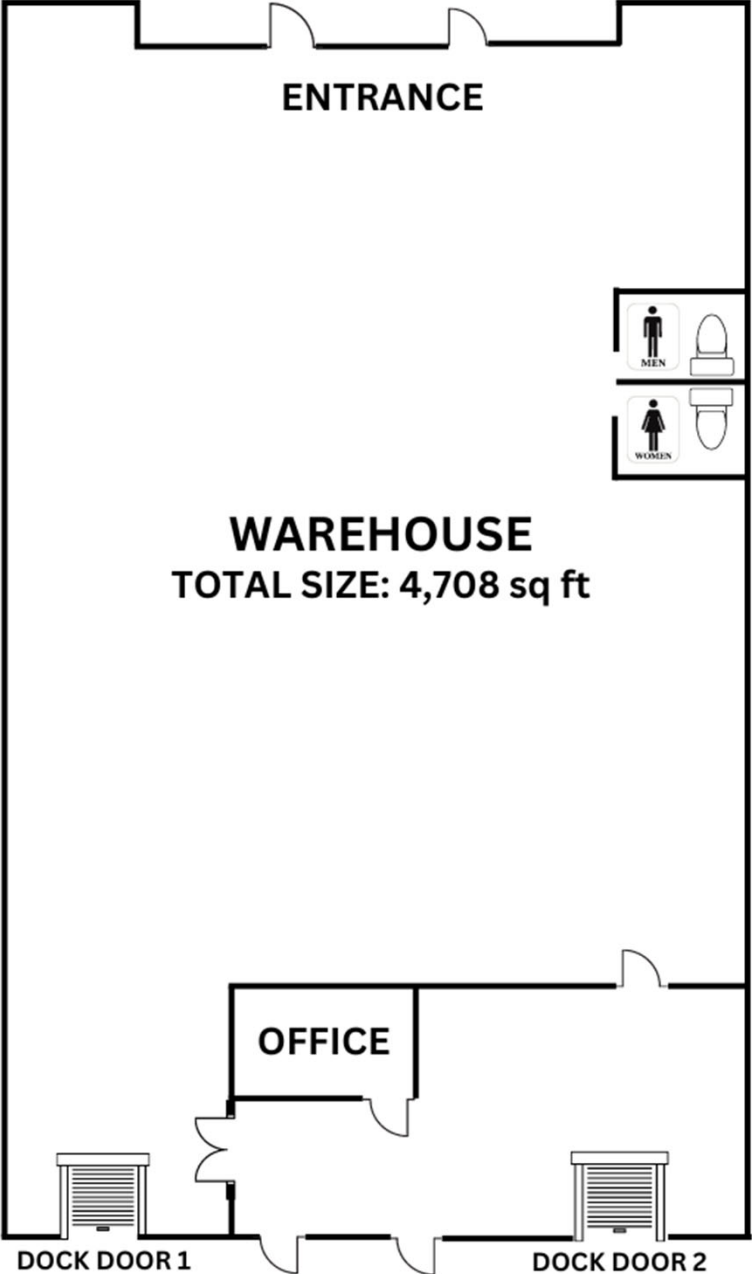

\*not to scale









Building  
517

Contact for pricing and more info:

Robbie Lober, SIOR  
Managing Member  
727 999 1806  
Robbie@Loberrealestate.com

Devin Beeler, CPA  
Senior Associate  
727 709 2179  
Devin@Loberrealestate.com

**LOBER**  
REAL ESTATE INVESTMENTS AND LEASING

*The information contained in this document has been obtained from sources believed reliable. While Lober Real Estate LLC does not doubt its accuracy, Lober Real Estate LLC has not verified it and makes no guarantee, warranty, or representation about it. It is your responsibility to independently confirm its accuracy and completeness. Any projections, opinions, assumptions, or estimates used are for example only and do not represent the current or future performance of the property. The value of this transaction to you depends on tax and other factors which should be evaluated by your tax, financial, and legal advisors. You and your advisors should conduct a careful, independent investigation of the property to determine to your satisfaction the suitability of the property for your needs.*