

**OBERFELD SNOWCAP**

**FOR LEASE** ↘

**1400 St-Jean-Baptiste**  
**Québec, QC**

**Manon Larose \***

Managing Director  
Commercial Real Estate Services  
438.990.8968  
[manonl@oberfeldsnowcap.com](mailto:manonl@oberfeldsnowcap.com)

**Michelle Marcotte-Blart \*\***

Director  
Commercial Real Estate Services  
514.972.6163  
[michelle@oberfeldsnowcap.com](mailto:michelle@oberfeldsnowcap.com)

**Maxime St-Pierre \*\*\***

Associate Vice President  
CBRE  
418.564.7465  
[maxime.st-pierre@cbre.com](mailto:maxime.st-pierre@cbre.com)



**CBRE**



\*Chartered real estate broker, DA \*\*Commercial real estate broker  
\*\*\* Commercial real estate broker acting within the corporation Maxime St-Pierre Real Estate Services Inc.



# Overview

SQUARE FOOTAGE	Ground Floor : <u>28,654 SF</u> (divisible)   2 <sup>nd</sup> Floor : <u>1,195 SF - 8,887 SF</u>
ADDRESS	1400 Avenue Saint-Jean Baptiste, Québec QC
AVAILABILITY	Immediate
NET RENT	Ask listing brokers
ADDITIONNAL RENT	\$7.45 PSF + Electricity ( Ground floor)
FREE HEIGHT	16,5
FLOOR LEVEL DOORS	1

DIVISIBLE



STRIP CENTER



7 LOADING DOCKS



AMPLE PARKING





# Area Demographics

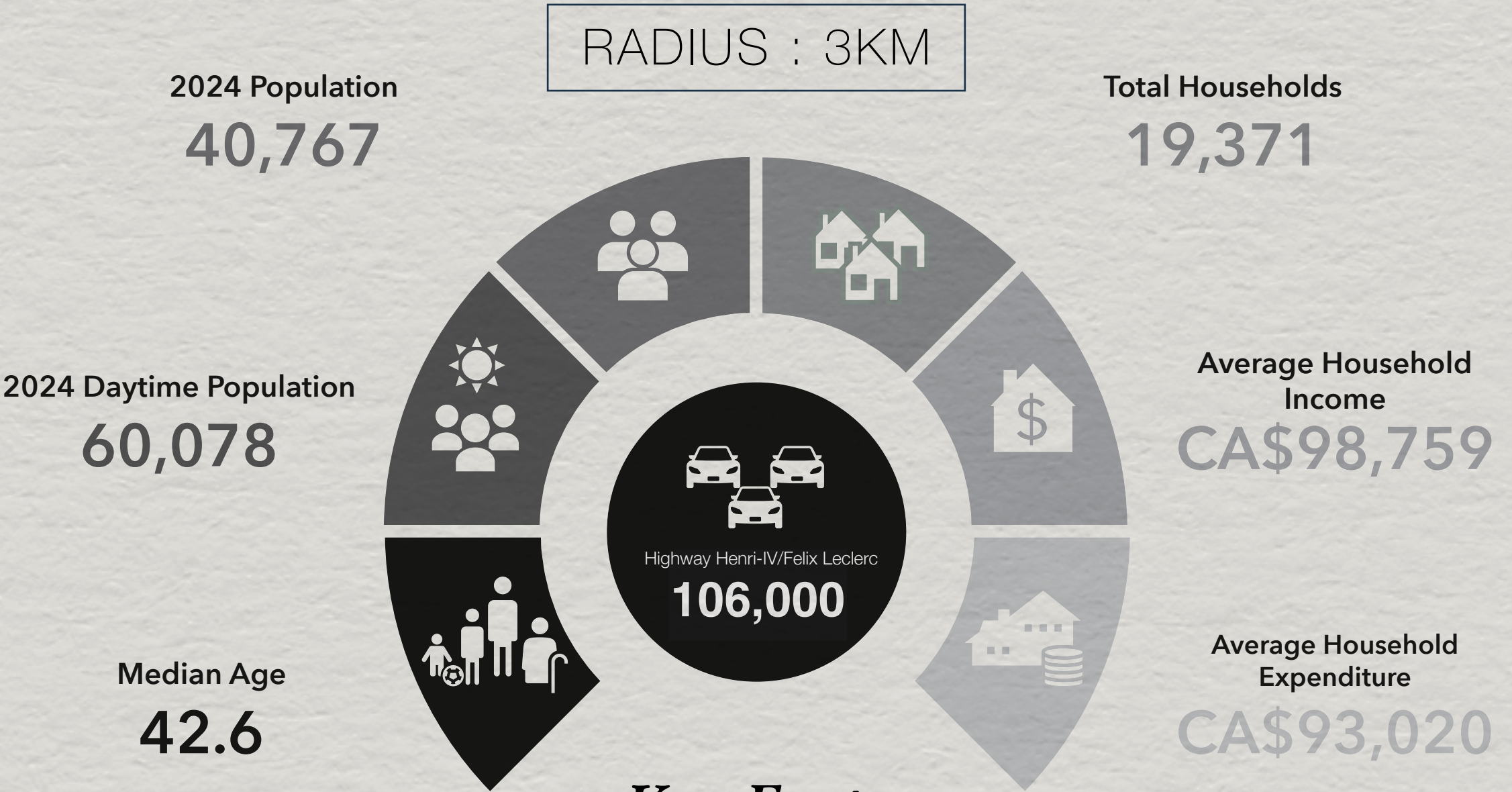

## Key Facts

Demographic Data Source: Environics (2024)





28,654 SF (divisible)

# Plan - Ground Floor



# Plan - Second Floor

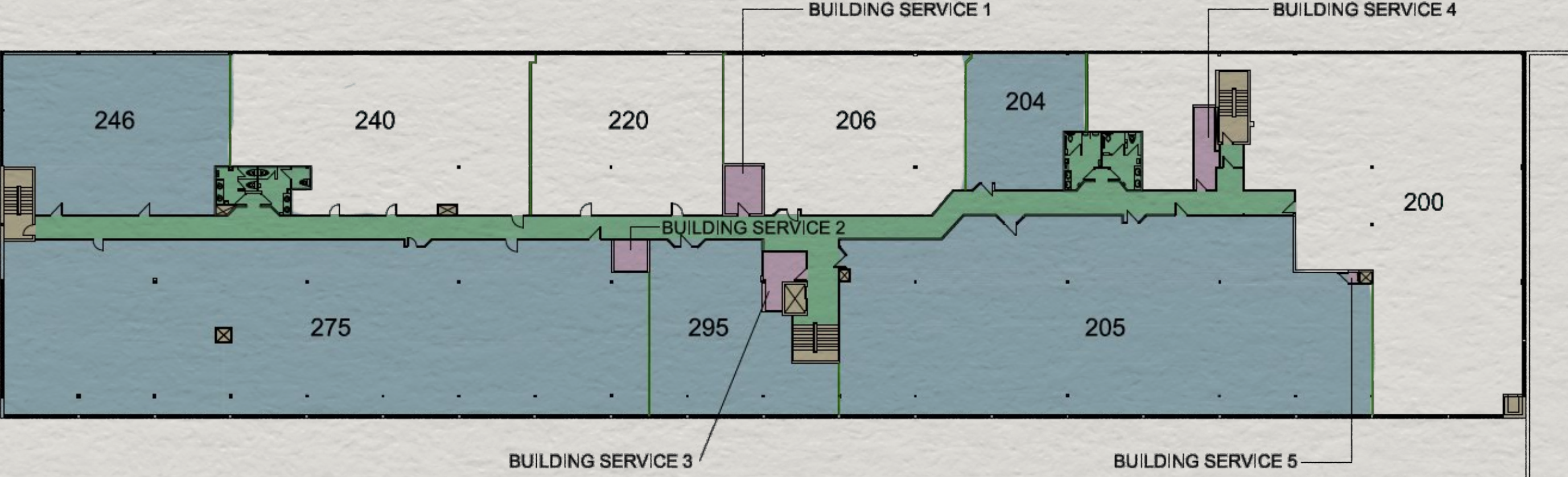

UNIT	204	205	246	275	295
SIZE (SF)	1,195	7,818	2,736	8,887	2,014



# Retailer Map

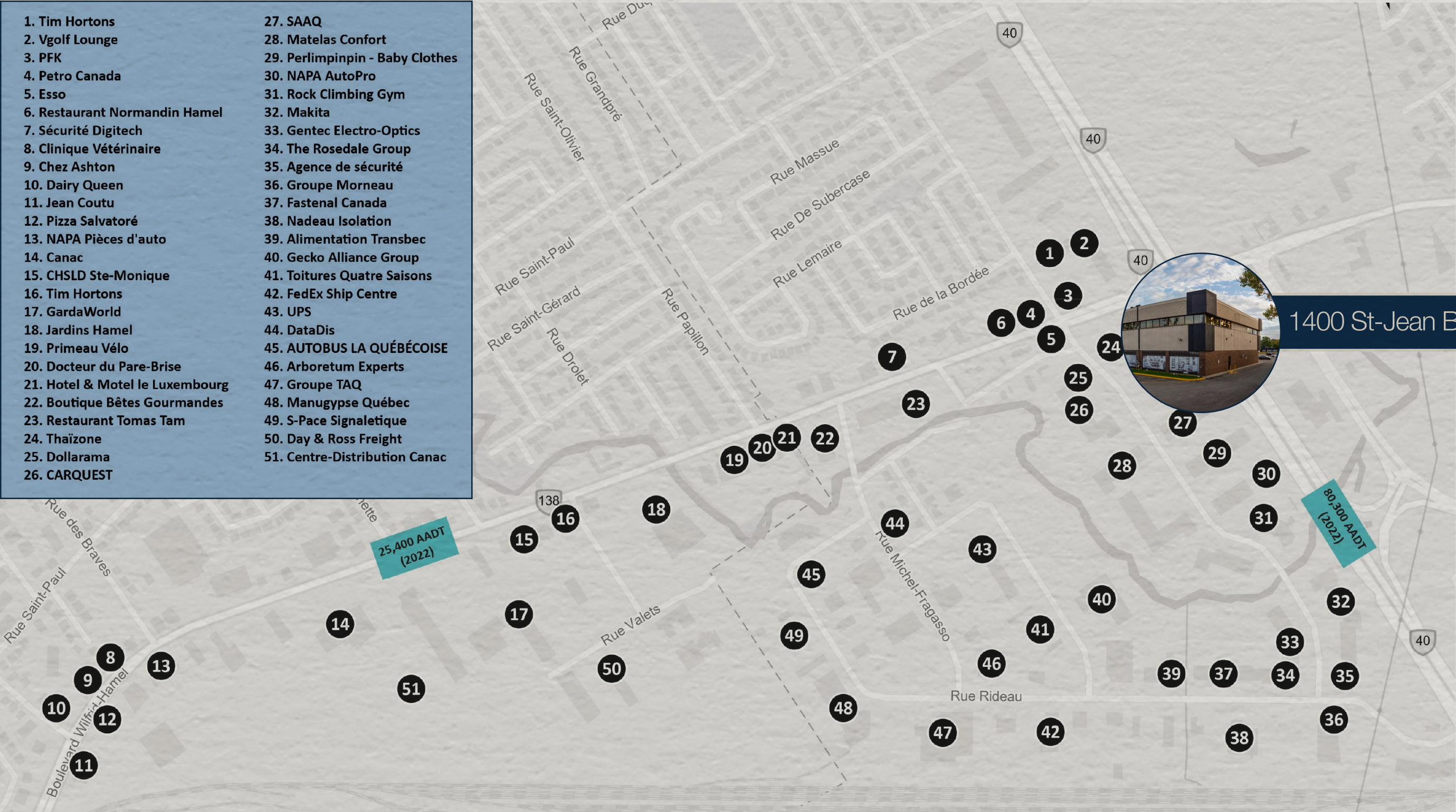



# OBERFELD SNOWCAP

## **Manon Larose \***

Managing Director  
Commercial Real Estate Services  
438.990.8968  
[manonl@oberfeldsnowcap.com](mailto:manonl@oberfeldsnowcap.com)

## **Michelle Marcotte-Blart \*\***

Director  
Commercial Real Estate Services  
514.972.6163  
[michelle@oberfeldsnowcap.com](mailto:michelle@oberfeldsnowcap.com)

## **Maxime St-Pierre \*\*\***

Associate Vice President  
CBRE  
418.564.7465  
[maxime.st-pierre@cbre.com](mailto:maxime.st-pierre@cbre.com)