

# AVAILABLE FOR LEASE

2730-2738 N BRISTOL ST, SANTA ANA, CA



## PROPERTY OVERVIEW

Lee & Associates - Newport Beach is pleased to offer for lease the 5-tenant retail center located at 2730-2738 N Bristol St in Santa Ana. Retail spaces are available ranging from 750 sq ft up to 1,500 sq ft. The property is undergoing a major modernizing renovation with a new signage program. Come join an eclectic tenant mix!

Centrally located in Orange County, adjacent to the intersection of the 5 and 22 Freeways. The Outlets at Orange and UCI Medical Center are located less than 1 mile to the northwest and MainPlace Mall and CHOC/St Joseph Hospital are located one mile to the east of the property.

LEASE RATE:	\$3.50psf + NNN
AVAILABLE SPACE:	750 to 1,500sf
AMENITIES:	Storefront glass, HVAC, rear patio, monument signage
TRAFFIC COUNTS:	Bristol St: 44,300 AADT Memory Ln: 27,700 AADT

Ken Gould  
kgould@lee-associates.com  
D 949.724.4728

Brian Barson, CCIM  
bbarson@lee-associates.com  
D 949.724.4717

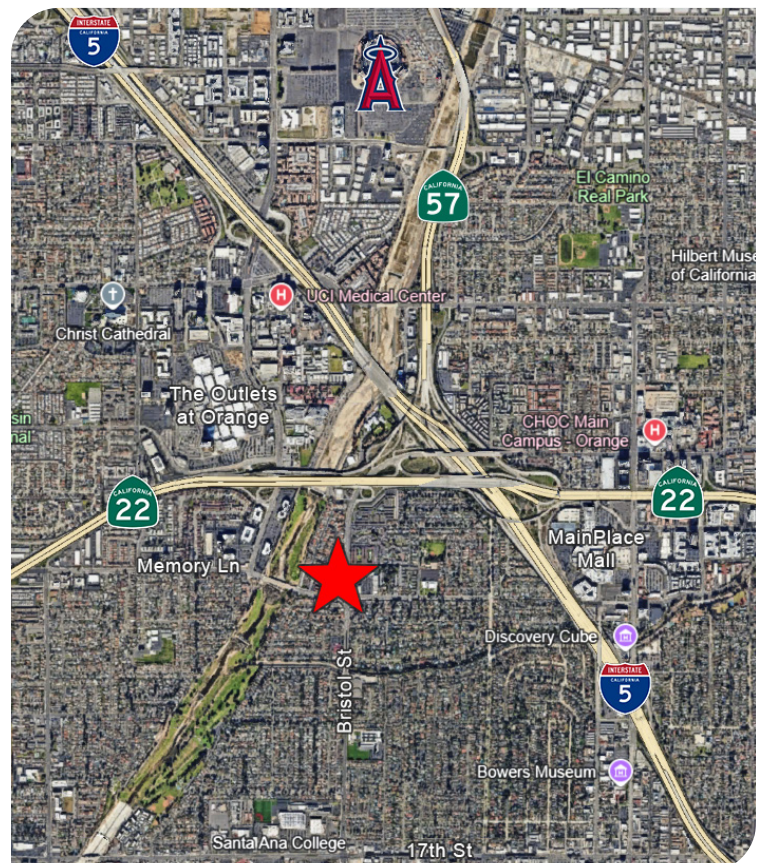

All information furnished regarding property for sale, rental or financing is from sources deemed reliable, but no warranty or representation is made to the accuracy thereof and same is submitted to errors, omissions, change of price, rental or other conditions prior to sale, lease or financing or withdrawal without notice. No liability of any kind is to be imposed on the broker herein.

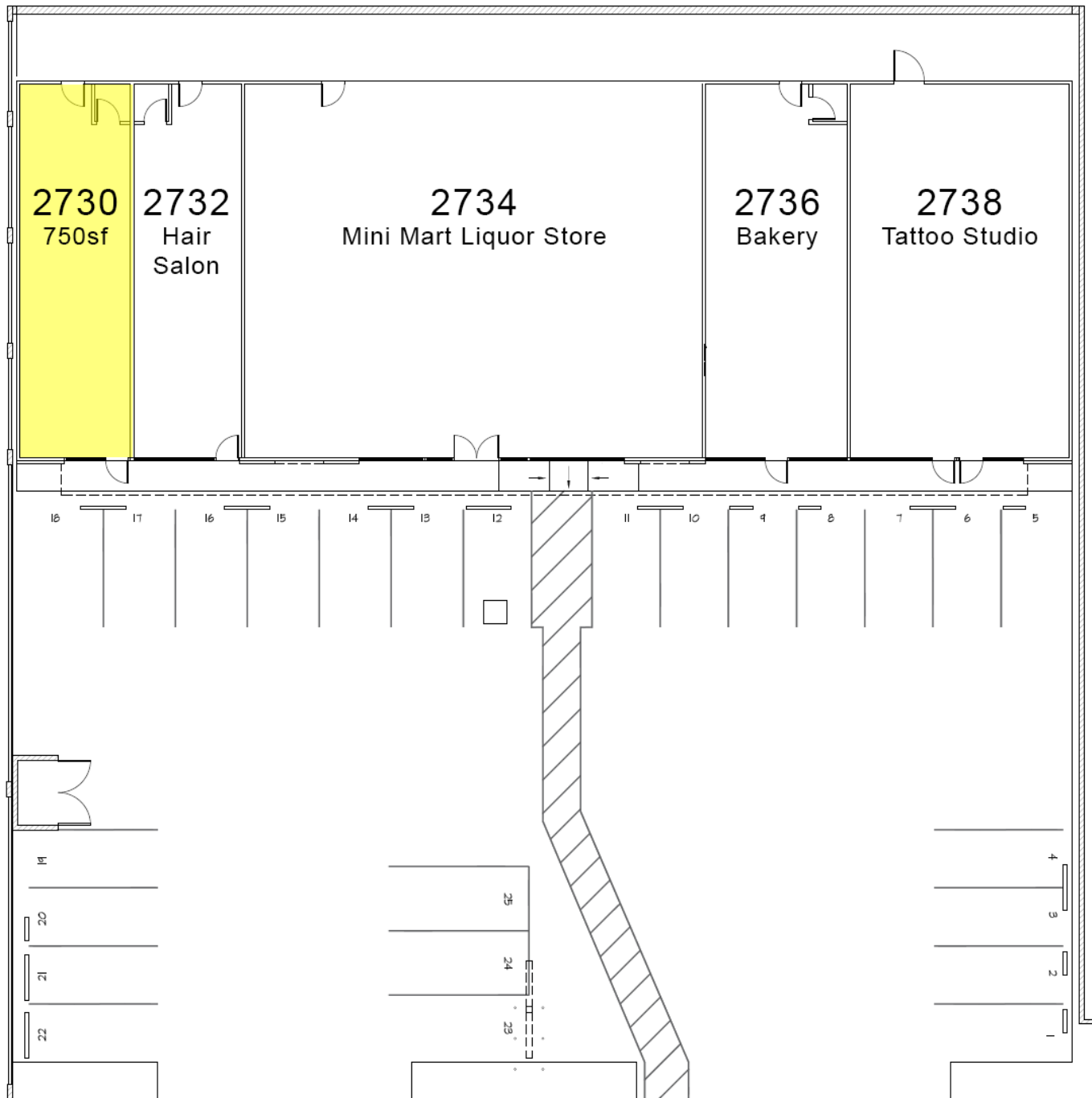

Bristol Street

Ken Gould  
kgould@lee-associates.com  
D 949.724.4728

Brian Barson, CCIM  
bbarson@lee-associates.com  
D 949.724.4717

**LEE & ASSOCIATES**  
COMMERCIAL REAL ESTATE SERVICES

All information furnished regarding property for sale, rental or financing is from sources deemed reliable, but no warranty or representation is made to the accuracy thereof and same is submitted to errors, omissions, change of price, rental or other conditions prior to sale, lease or financing or withdrawal without notice. No liability of any kind is to be imposed on the broker herein.