



For Lease

2,089 SF | Negotiable Lease Rate

Free-Standing Bank w/ Drive-Thru East Wichita



## Former Fidelity Bank

1306 N Woodlawn St Wichita, Kansas 67208

### Property Highlights

- Former Fidelity Bank Branch
- 2,089 SF Building, 22,645 SF Lot
- 29 Parking Spaces
- Monument & Building Signage
- Year Built: 2001
- Quality Interior Finishes
- 3 Manager Offices
- Zoned: LC
- 2024 RE Taxes: \$14,070
- Lease Rate: Negotiable NN

### Offering Summary

|                |               |
|----------------|---------------|
| Lease Rate:    | Negotiable NN |
| Building Size: | 2,089 SF      |
| Lot Size:      | 22,642 SF     |

### For More Information

**Troy Farha**

O: 316 847 4904

tfarha@naimartens.com

| Former Fidelity Bank Branch 1306 N Woodlawn St Wichita, KS 67208





For Lease

2,089 SF | Negotiable Lease Rate

Free-Standing Bank w/ Drive-Thru East Wichita



| Former Fidelity Bank Branch 1306 N Woodlawn St Wichita, KS 67208



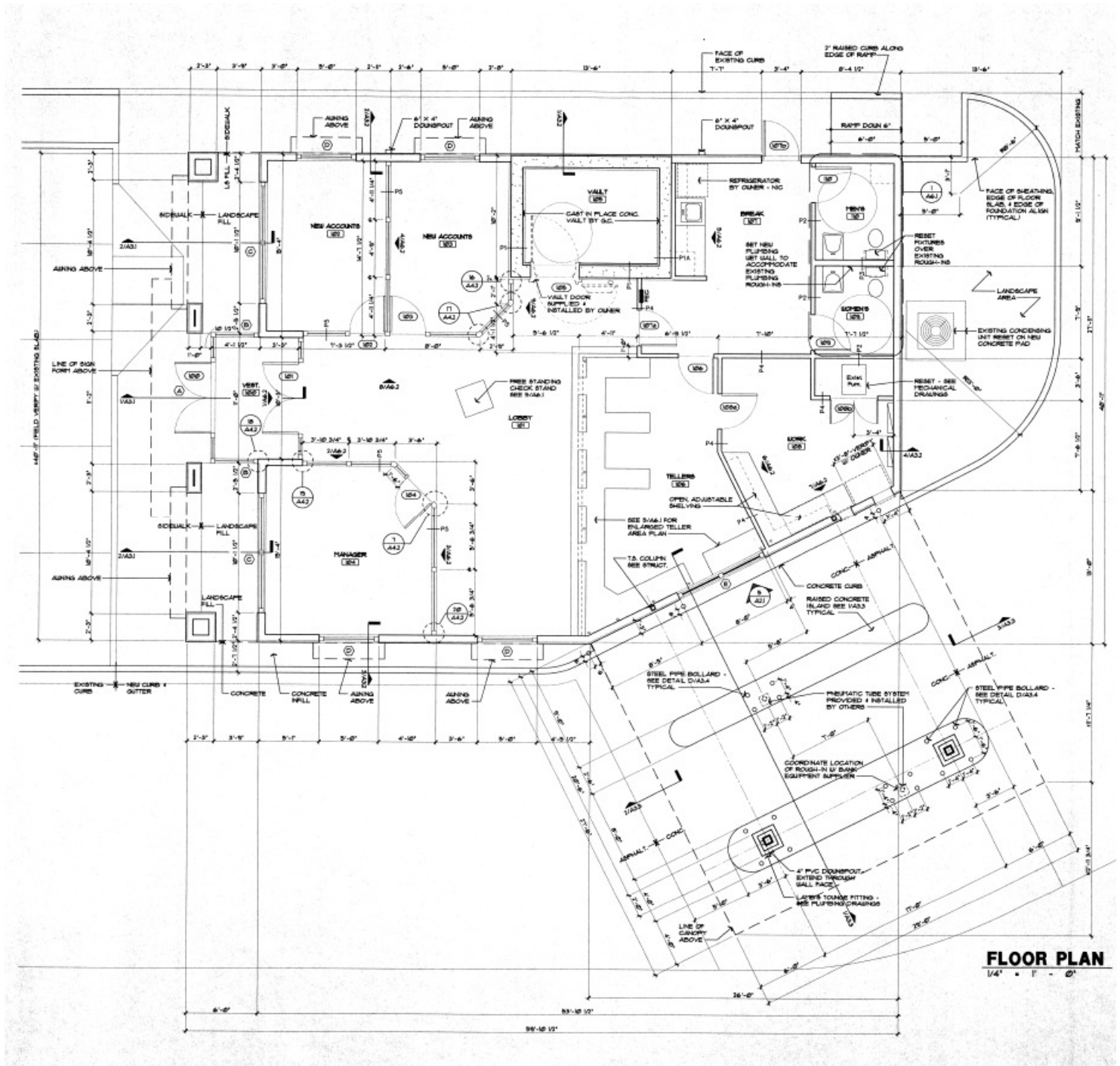

Former Fidelity Bank Branch 1306 N Woodlawn St Wichita, KS 67208





For Lease

2,089 SF | Negotiable Lease Rate

Free-Standing Bank w/ Drive-Thru East Wichita



Former Fidelity Bank Branch 1306 N Woodlawn St Wichita, KS 67208