

# FOR LEASE | LOGIC PARK | 40,000 SF - 70,000 SF

1500 S 91ST AVE & 9393 W BUCKEYE RD, PHOENIX AZ



## PROJECT OVERVIEW

- Building 1 SF ±256,000 SF
- Building 2 SF ±229,030 SF
- Building 3 SF ±243,360 SF



**GARY ANDERSON**  
+1 602 224 4439  
gary.anderson1@cushwake.com

**NIK VALLENS**  
+1 949 981 7725  
nik.vallens@cushwake.com



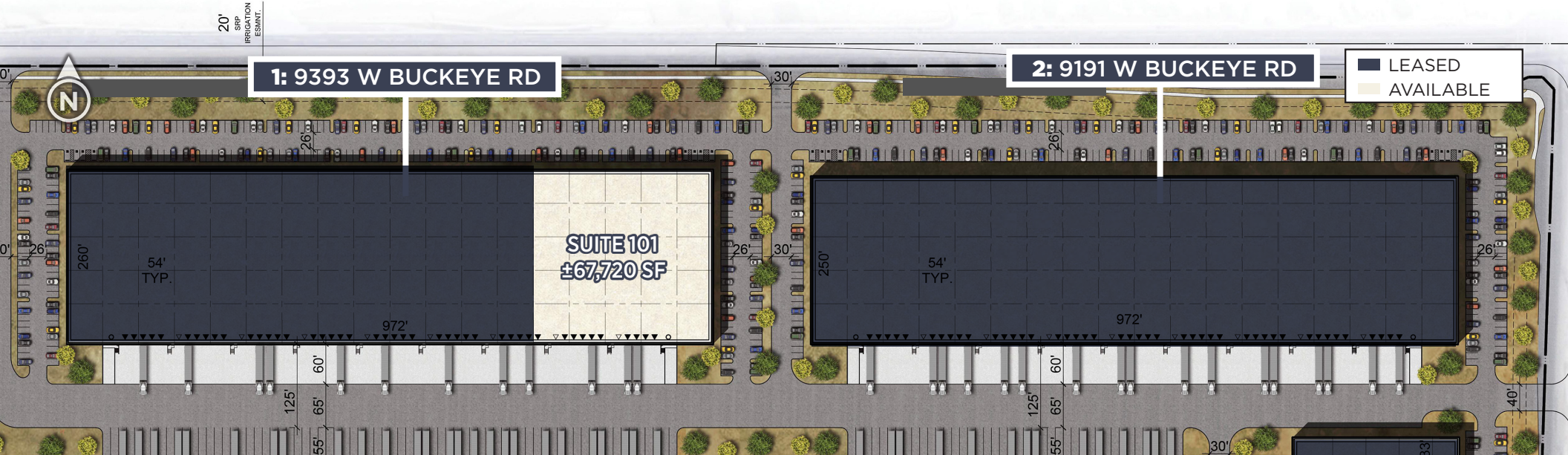

**1: 9393 W BUCKEYE RD**

**2: 9191 W BUCKEYE RD**

■ LEASED  
■ AVAILABLE



**SUITE 101**  
**±67,720 SF**

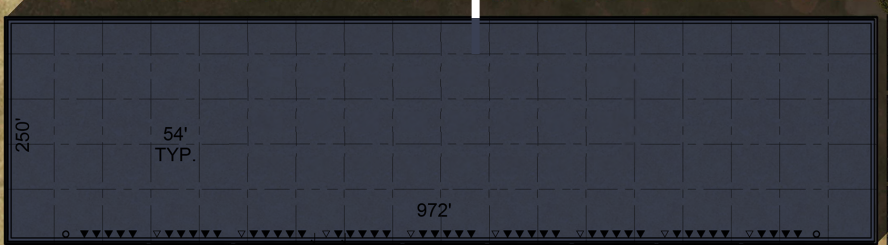

**SUITE 119**  
**±40,646 SF**

	<b>BUILDING 1</b>	<b>BUILDING 3</b>
<b>ADDRESS:</b>	9393 W Buckeye Rd	1500 S 91 <sup>st</sup> Ave
<b>SUITE:</b>	Suite 101	Suite 119
<b>AVAILABLE SF:</b>	±67,720 SF	±40,646 SF
<b>OFFICE SF:</b>	±1,800 SF	±6,886 SF
<b>WAREHOUSE COOLING:</b>	100% HVAC	100% HVAC
<b>WAREHOUSE LIGHTING:</b>	LED	LED
<b>WAREHOUSE INSULATION:</b>	R-38 Envelope	R-38 Envelope
<b>COLUMN SPACING (TYPICAL):</b>	52' x 50'	52' x 50'
<b>DOCK POSITIONS:</b>	8 (expandable to 14)	10 (expandable to 16)
<b>DOCK EQUIPMENT:</b>	PIT Leveler (2)	PIT Leveler (2)
<b>RAMP TO GRADE:</b>	1	1
<b>CLEAR HEIGHT:</b>	32'	32'
<b>SLAB THICKNESS</b>	7"	7"
<b>BUILDING DEPTH:</b>	260'	260'
<b>POWER:</b>	600 AMPS	600 AMPS
<b>TRUCK COURT DEPTH:</b>	180'	135'

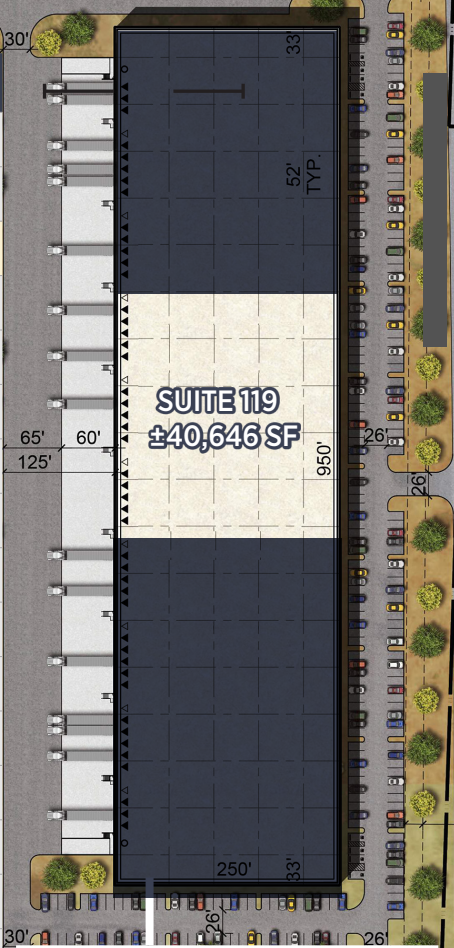

**3: 1500 S 91<sup>ST</sup> AVE**

**\* EACH BUILDING CAN PROVIDE AUTONOMOUS TRUCK QUEING LANES & FULLY SECURED TRUCK COURTS**

# FOR LEASE | 9393 W BUCKEYE RD | LOGIC PARK

SWC 91<sup>ST</sup> AVENUE & BUCKEYE ROAD | PHOENIX, AZ

## 9393 W BUCKEYE RD

Suite 101 | ±67,720 SF

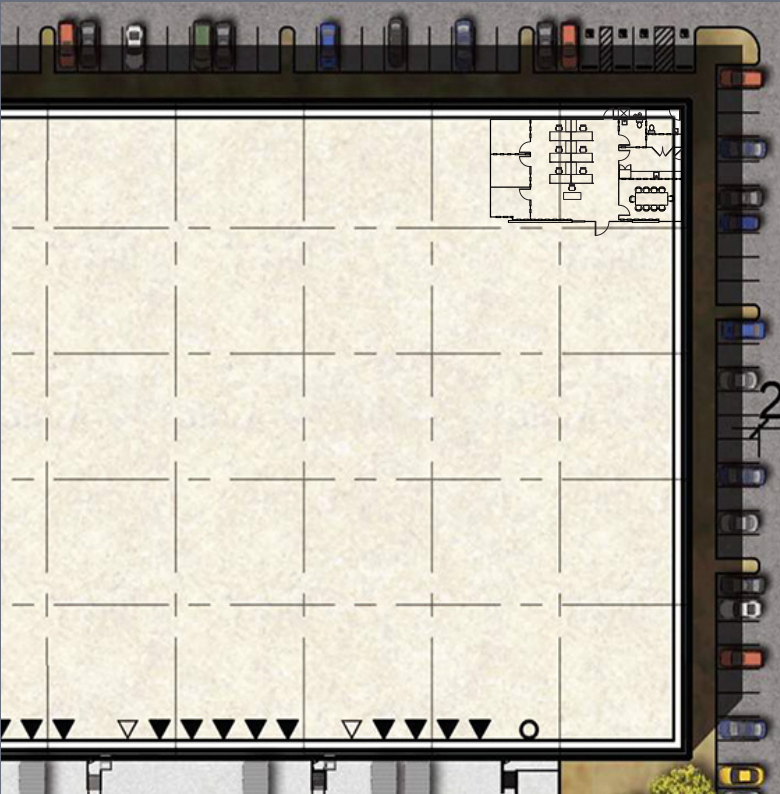

## 1500 S 91st STREET

Suite 119 | ±40,646 SF

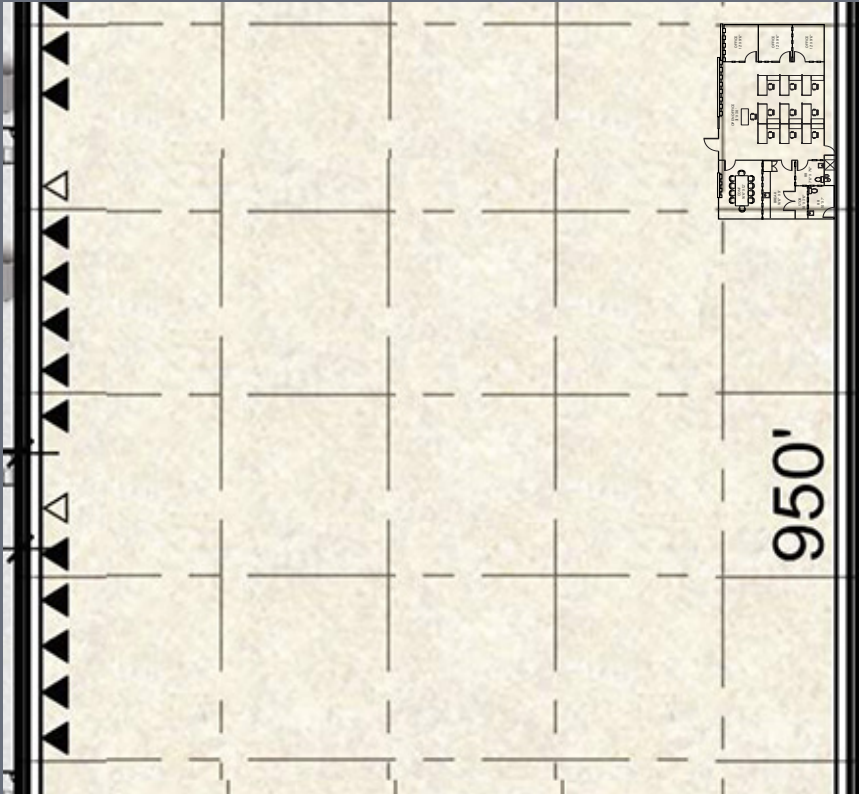

# FOR LEASE | 9393 W BUCKEYE RD | LOGIC PARK

SWC 91<sup>ST</sup> AVENUE & BUCKEYE ROAD | PHOENIX, AZ



**GARY ANDERSON**  
+1 602 224 4439  
gary.anderson1@cushwake.com

**NIK VALLENS**  
+1 949 981 7725  
nik.valLens@cushwake.com



DEVELOPED BY:

