









FOR LEASE



2,400 SF Flex Space Available



PROPERTY DETAILS

-  3605 Latrobe Dr. Charlotte, NC 28211
-  +/-2,400 SF
-  +/-700 SF Office
-  +/-1,700 SF of Warehouse with 16' ceiling heights
-  I-1 Zoning
-  12'x14' Drive in Door
-  Located in central Charlotte near downtown, US-74, I-77 and I-85 and popular Southeast Charlotte neighborhoods.
- 

William Maxwell

P (704) 575-1130 E wmaxwell@colony-commercial.com



SPACE PLAN

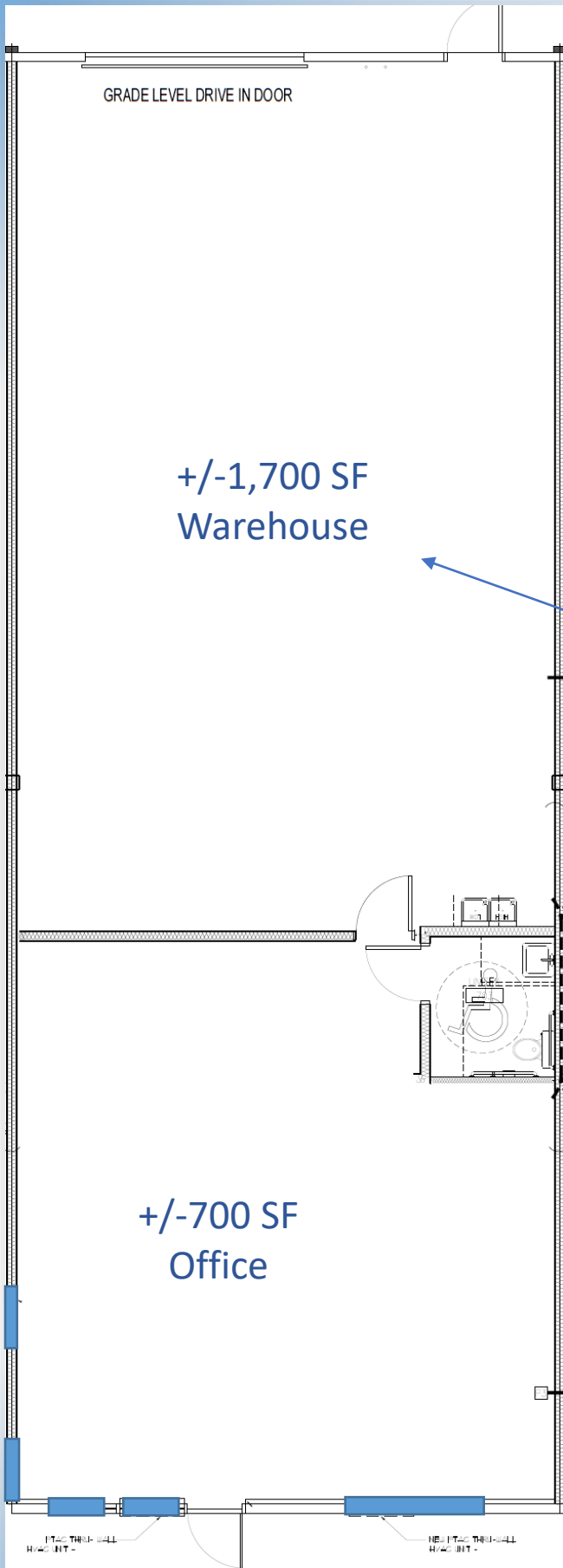

- ❖ 10 minutes to downtown
- ❖ 10 minutes to I-277
- ❖ 15 minutes to I-85
- ❖ 13 miles to Airport

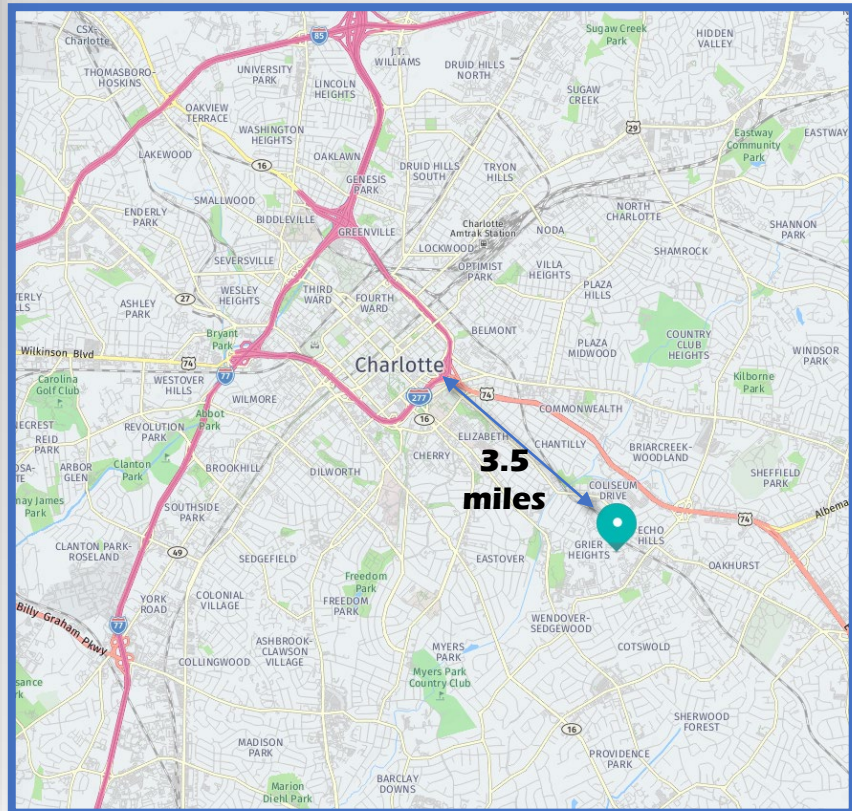

William Maxwell

P (704) 575-1130 E wmaxwell@colony-commercial.com



COLONY
COMMERCIAL