

90 West Street

FINANCIAL DISTRICT
NEW YORK, NY



NEWMARK

90 WEST STREET

Property Details

Location

Space A	Northeast corner of Albany Street
Space B	Southeast corner of Cedar Street
Space C	South block of Cedar Street between West and Washington Streets

Approximate Size

Space A	Ground Floor	2,000 SF
Space B	Ground Floor	2,099 SF*
Space C	Ground Floor	3,390 SF*

*Space B and C can be combined for a total of 6,089 SF

Frontage

Space A	95 FT of wraparound frontage
Space B	102 FT of wraparound frontage
Space C	71 FT on Cedar Street

Ceiling Heights

Ground Floor	13 FT
--------------	-------

Term

Negotiable

Possession

Immediate

Neighbors

Sixpoint Brewery, Starbucks, Morton's The Steakhouse, Bill's Bar & Burger, Harry's Italian, Blue Smoke, P.J. Clarke's, Parm, Le District and Chop't

Comments

Large customer base of tourists, affluent office workers and residents

\$4.7 billion of annual spending power in Lower Manhattan

Adjacent to the entrance of the National September 11 Memorial & Museum, which has had 18 million visitors since opening in 2011

One block south of the World Trade Center which has over 11,700,000 SF of commercial space

All uses considered

In close proximity to the **1 2 3 4 5** and **PATH** trains with over 31 million annual ridership

Located at the base of a Gothic, Cass Gilbert-designed landmark building with 410 apartments

Ground Floor

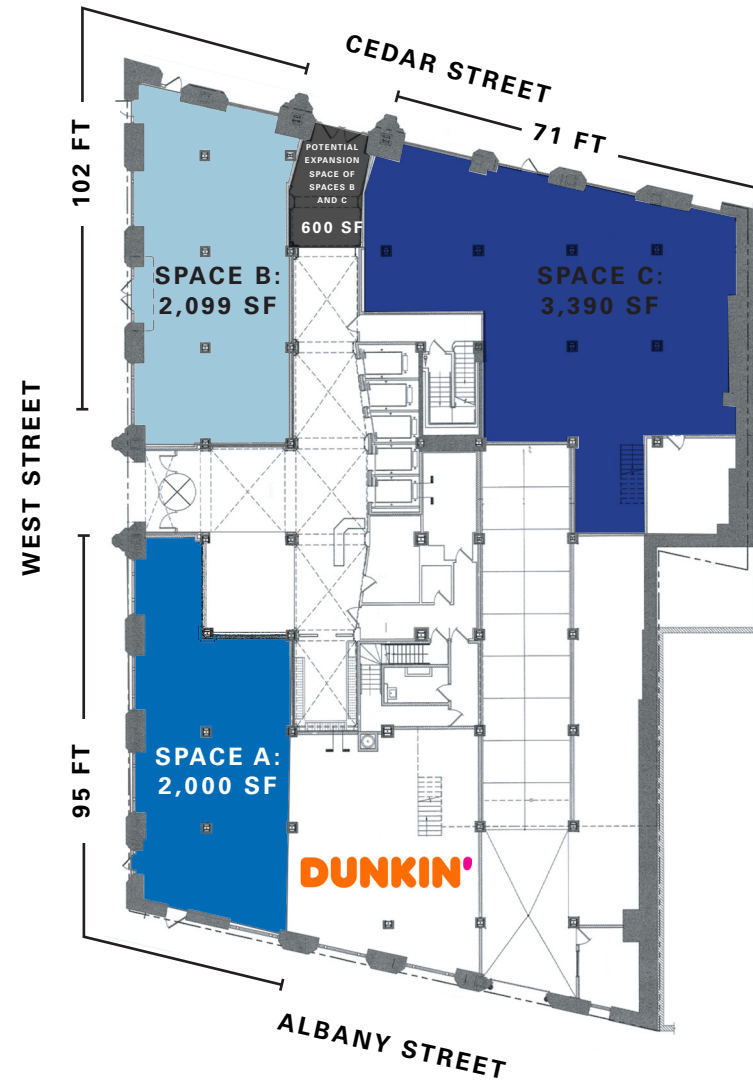

90 WEST STREET

Interior Photos



90 WEST STREET

Neighboring Tenants



Space A



Space B



Space C



90 WEST STREET

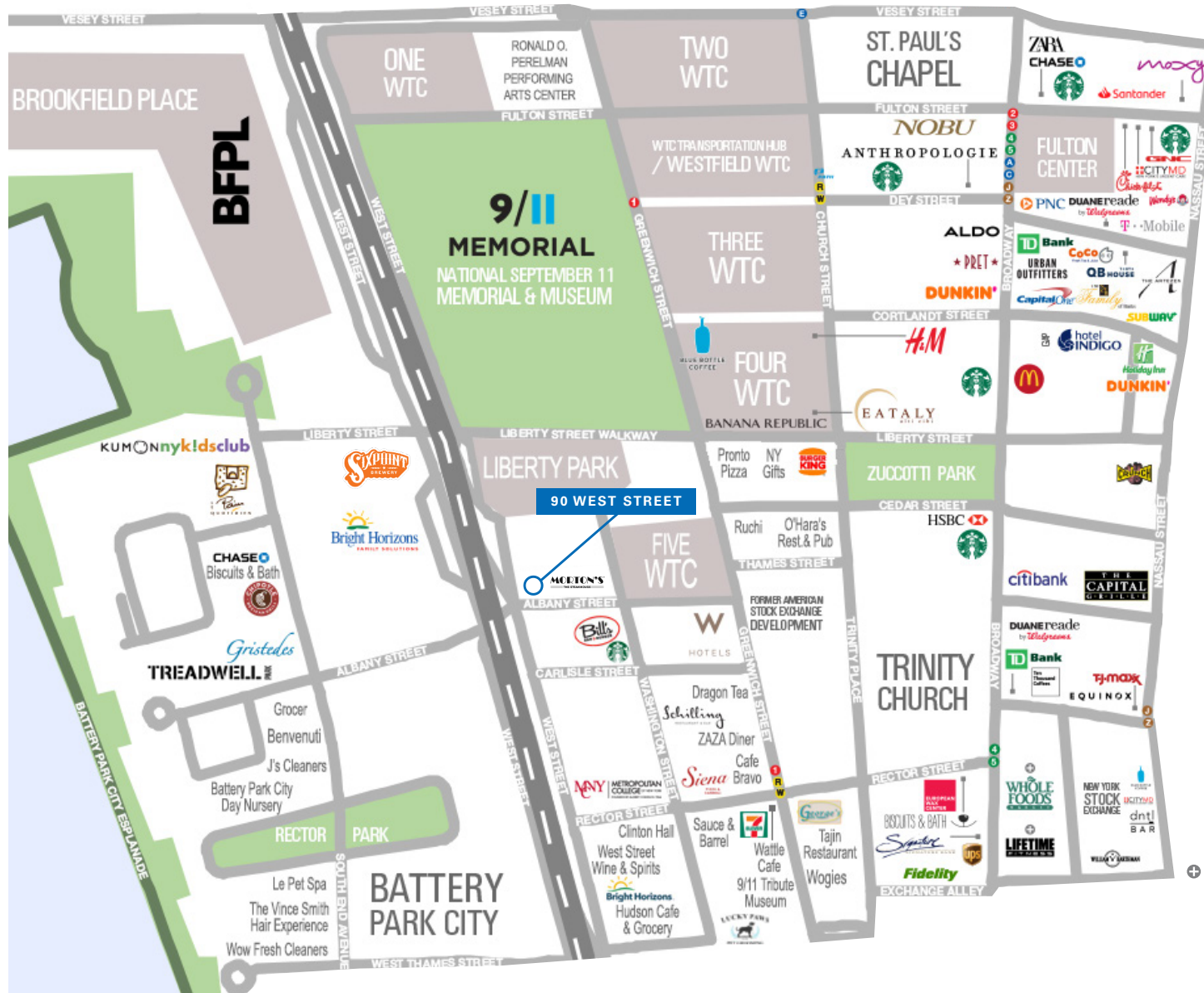

CONTACT

Gary Alterman
 t 212-916-3367
 gary.alterman@nrmk.com

Andrew Stern
 t 212-351-9353
 andrew.stern@nrmk.com

nrmk.com

©2022 NEWMARK The information contained herein has been obtained from sources deemed reliable but has not been verified and no guarantee, warranty or representation, either express or implied, is made with respect to such information. Terms of sale or lease and availability are subject to change or withdrawal without notice.