



Excellent Class A
Warehouse-Distribution Facility



±144,920 SF AVAILABLE FOR LEASE

2301 E PACIFICA PL | RANCHO DOMINGUEZ, CA 90220

30' CLEAR | ESRF SPRINKLER SYSTEM | 16 DOCK HIGH POSITIONS



**Rexford
Industrial**

CBRE

±144,920 SF Building

2301 E PACIFICA PLACE



Property Highlights

- Rancho Pacifica Industrial Park
- Private Secured Park Environment
- 24 Hour Park Security
- ESFR Sprinkler System
- 30' Clearance
- 16 Dock Positions
- ±6,828 SF Office
- Close Proximity to Ports of LA & LB, and the 405, 110, 91 & 710 Freeways

PACIFIC OCEAN

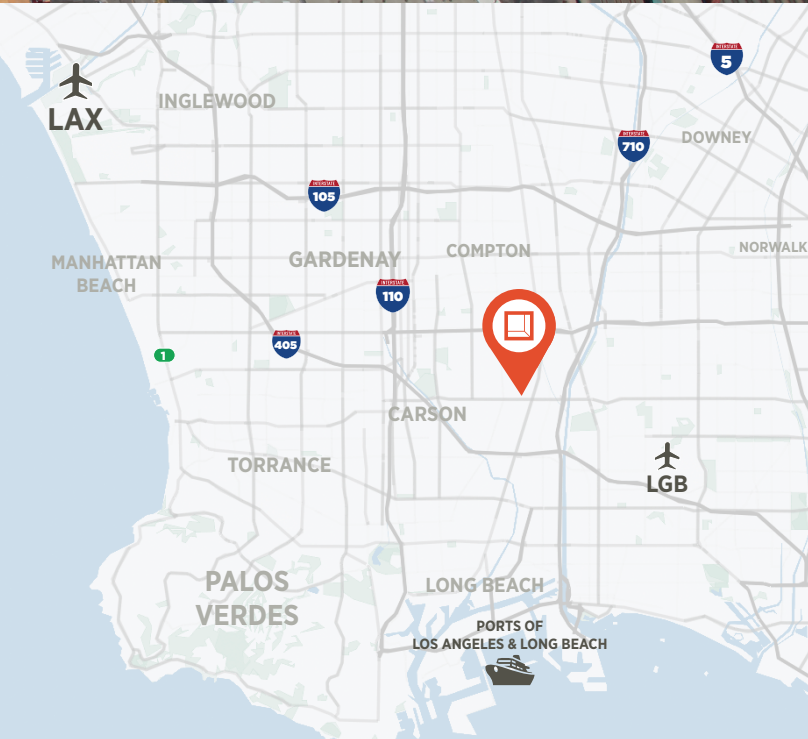

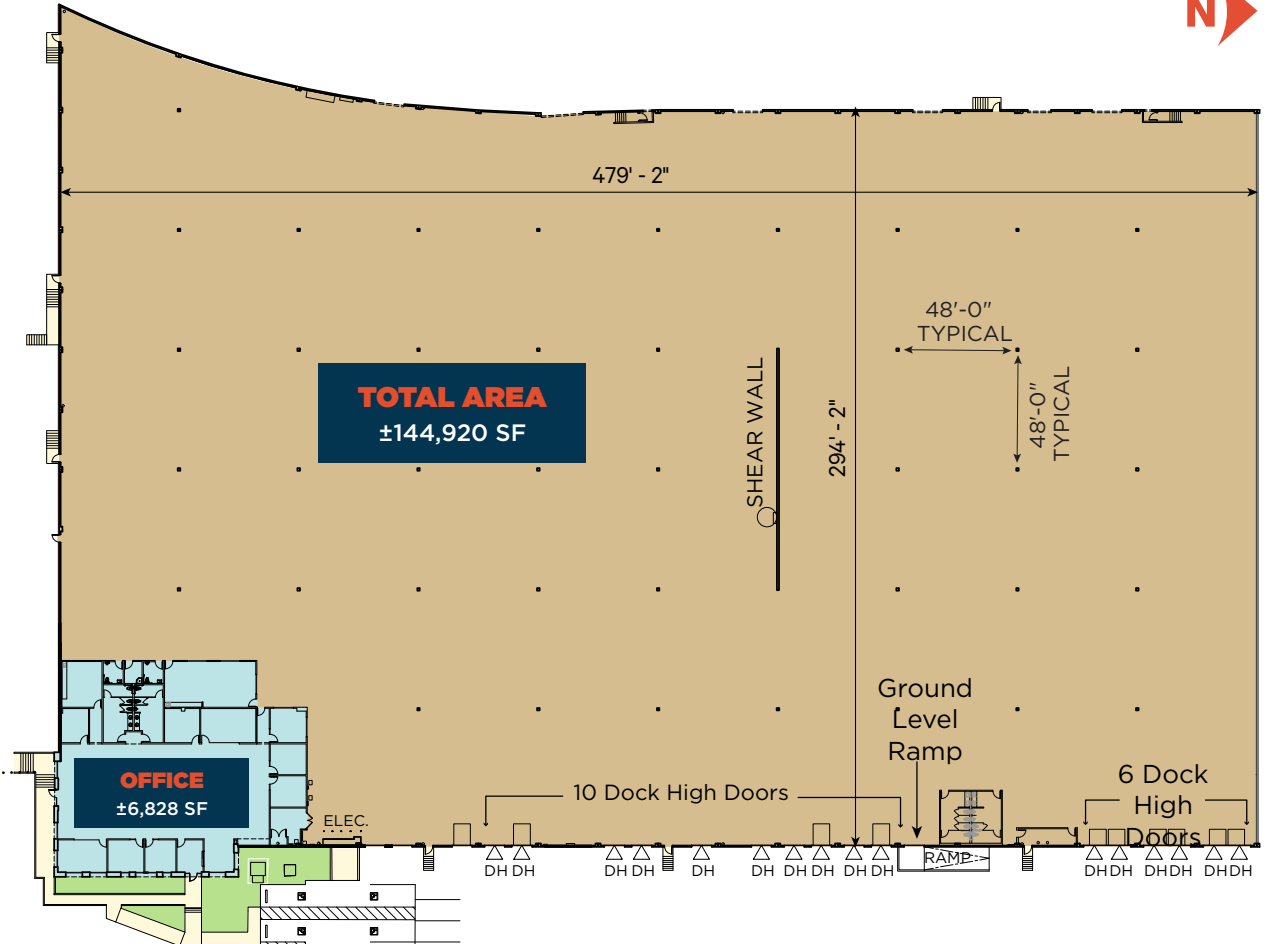
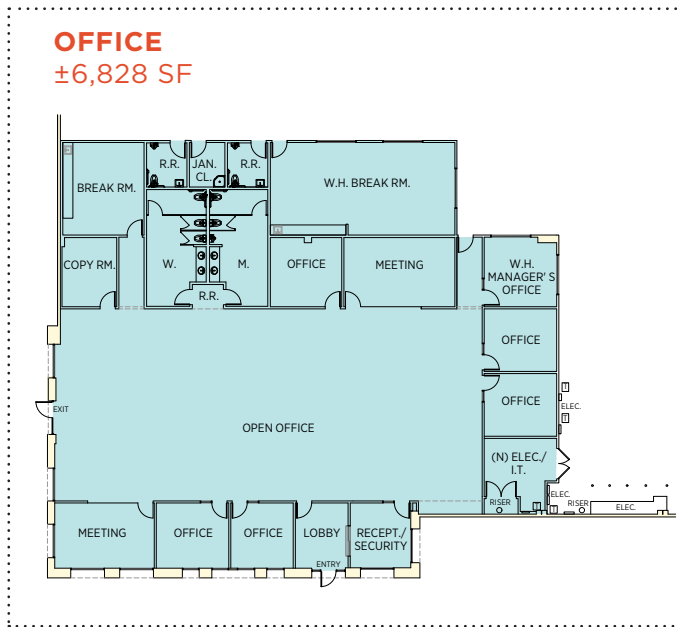

OFFICE
±6,828 SF

WAREHOUSE
±138,092 SF

TOTAL
±144,920 SF

PLAN LAYOUT SUBJECT TO FIELD CONDITIONS AND MAY DIFFER FROM PLAN AS SHOWN. ALL INFORMATION PRESENTED ON THIS DRAWING IS PRESUMED TO BE ACCURATE, HOWEVER TENANT SHOULD VERIFY PERTINENT INFORMATION PRIOR TO COMMITTING TO A LEASE. ANY FURNITURE OR APPLIANCES SHOWN ON PLAN ARE FOR CONCEPT ONLY AND WILL BE TENANT PROVIDED.



**Rexford
Industrial**

Leasing Contacts

JOHN SCHUMACHER

+1 310 489 1439

JOHN.SCHUMACHER@CBRE.COM

LIC. 00987225

CAROLINE REID

+1 310 947 4219

CAROLINE.REID@CBRE.COM

LIC. 02188038

NICKI PEETZ

+1 310 433 0602

NICKI.PEETZ@CBRE.COM

LIC. 01720809

CBRE

CBRE

2221 Rosecrans Ave, STE 100

El Segundo, CA 90245

© 2024 CBRE, Inc. All rights reserved. This information has been obtained from sources believed reliable but has not been verified for accuracy or completeness. CBRE, Inc. makes no guarantee, representation or warranty and accepts no responsibility or liability as to the accuracy, completeness, or reliability of the information contained herein. You should conduct a careful, independent investigation of the property and verify all information. Any reliance on this information is solely at your own risk. CBRE and the CBRE logo are service marks of CBRE, Inc. All other marks displayed on this document are the property of their respective owners, and the use of such marks does not imply any affiliation with or endorsement of CBRE. Photos herein are the property of their respective owners. Use of these images without the express written consent of the owner is prohibited.