

323 Andover Street, Wilmington, MA



323 Andover Street is a 24,920 +/-sf single-story industrial office building consisting of office, storage, and light manufacturing space.

Office & Flex Space For Lease

- Various leasing opportunities currently available (see page 2):
- Some units with a loading dock, overhead loading door, private restroom; and/or direct exterior entry
- Units may be combined to expand your space
- Common on-site daytime parking
- Zoned: General Industrial
- Located 1.1 miles to Route 93; 6.8 miles to Route 495; 7.1 miles to Route 95/128; 20 miles to Logan International Airport; and 36 miles to Manchester Regional Airport



Edward Carbone, CCIM

781.935.5444 (o)

978.930.1579 (c)

Edward@CarboneRE.com

CarboneRE.com

CARBONE Commercial Real Estate, Inc.

All information furnished is from sources deemed reliable, but no warranty or representation is made as to the accuracy thereof, and the same is presented subject to errors, omissions, change of price, rental or other conditions, prior sale or lease, or withdrawal without notice. Copyright © 2024 Carbone Commercial Real Estate, Inc., agent of the Owner/Lessor.

AVAILABLE SPACE FOR LEASE

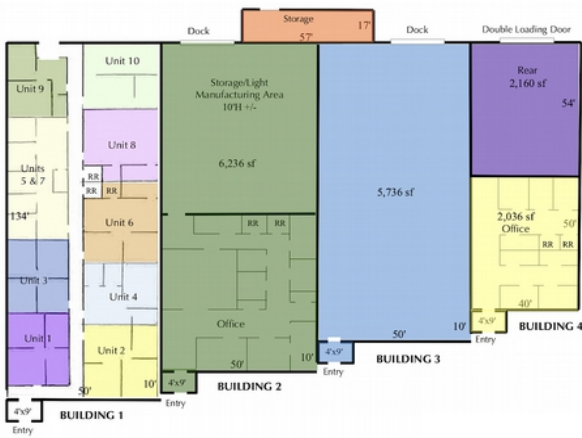

Bldg 2
6,236 +/- sf
\$13.00/sf n

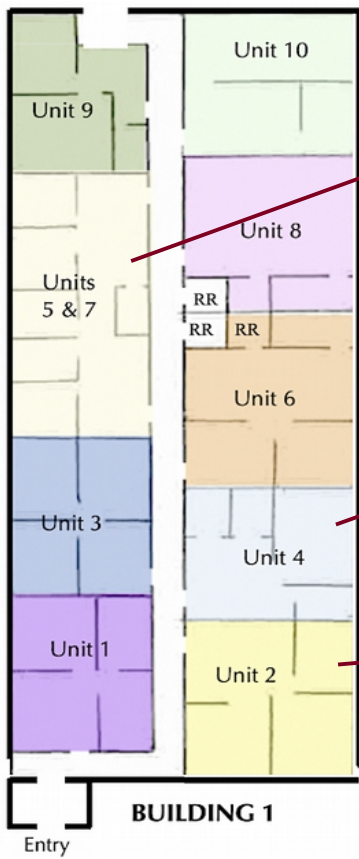
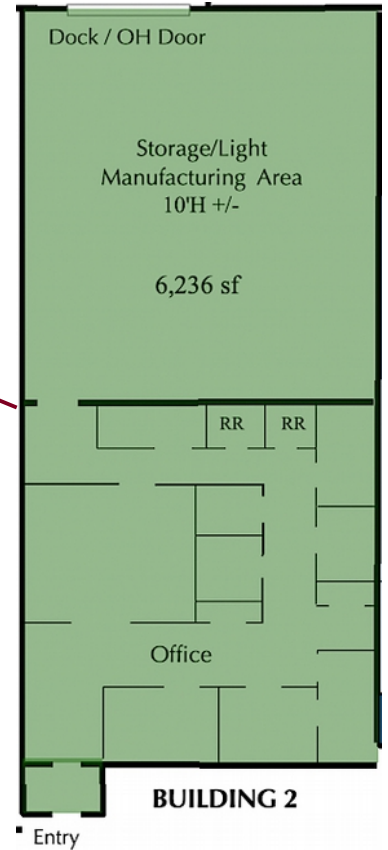

Bldg 1: U5 & U7
919 +/- sf
\$1,380/month includes utilities

Bldg 1: U4
409 +/- sf
\$700/month includes utilities

Bldg 1: U2
560 +/- sf
\$840/month includes utilities

Bldg 1: U4 & U2
969 +/- sf
\$1,455/month includes utilities