

FOR LEASE | 66,452 SF AVAILABLE

3-7 TIMBER COURT | BOLINGBROOK, ILLINOIS

Functional Industrial Space Situated Along I-55 at Route 53



JASON WEST, SIOR
Executive Vice Chair
847 518 3210
jason.west@cushwake.com

SEAN HENRICK, SIOR
Vice Chair
847 518 3215
sean.henrick@cushwake.com

RYAN KLINK
Managing Director
847 518 3211
ryan.klink@cushwake.com

GID
INDUSTRIAL

**CUSHMAN &
WAKEFIELD**



3-7 Timber Court

3-7 Timber Court is a 320,722 square foot, Class A industrial building located within the Remington Lakes Business Park. Situated in one of Chicago's most sought-after industrial submarkets, the I-55 Industrial Corridor, the property benefits from unmatched interstate access, proximity to a deep labor pool, access to an abundance of amenities, and low Will County taxes.

Property Highlights

» Total Building Size	320,722 SF
» Available Unit	A
» Available Date	October 1, 2025
» Total Available Space	66,452 SF
» Existing Office Space	3,752 SF
» Exterior Docks	7
» Drive-In Door	1
» Clear Height	26'
» Typical Bay Size	40'x50'
» Sprinkler System	ESFR
» Power	400 Amps, 277/480 Volts
» Lease Rate	Subject to Offer

Site Plan

Find the Perfect Fit with Our 66,452 SF Availability

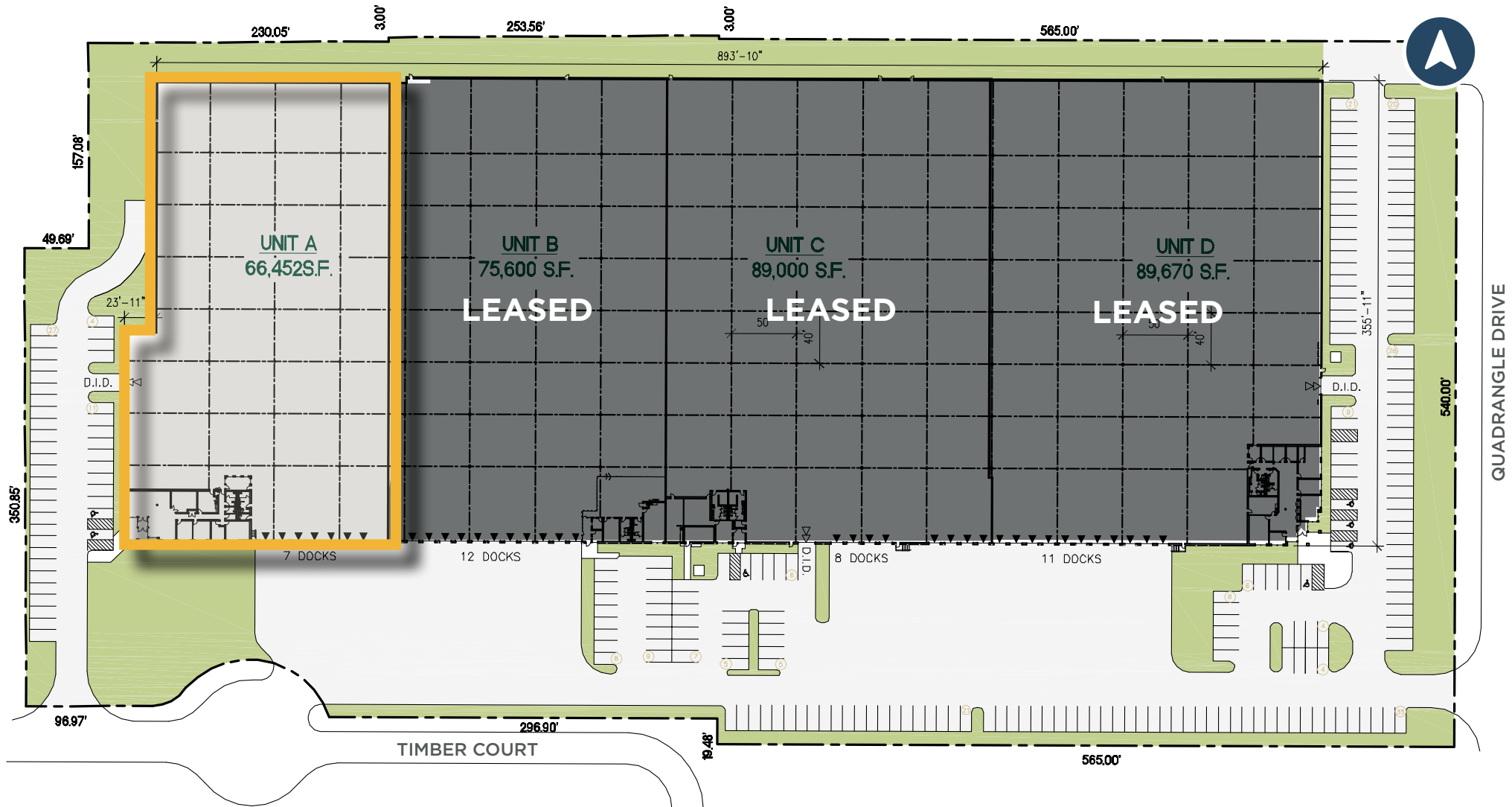



66,452 SF AVAILABLE FOR LEASE | 3-7 TIMBER CT, BOLINGBROOK, IL

Access Map

- » 3 Minutes to I-55 Full Interchange
- » Flexible Industrial Space Situated Along I-55 at Route 53



FOR LEASE | 66,452 SF AVAILABLE

3-7 TIMBER COURT | BOLINGBROOK, ILLINOIS



CONTACT

JASON WEST, SIOR

Executive Vice Chair
847 518 3210

jason.west@cushwake.com

SEAN HENRICK, SIOR

Vice Chair
847 518 3215

sean.henrick@cushwake.com

RYAN KLINK

Managing Director
847 518 3211

ryan.klink@cushwake.com



©2025 Cushman & Wakefield. All rights reserved. The information contained in this communication is strictly confidential. This information has been obtained from sources believed to be reliable but has not been verified. NO WARRANTY OR REPRESENTATION, EXPRESS OR IMPLIED, IS MADE AS TO THE CONDITION OF THE PROPERTY (OR PROPERTIES) REFERENCED HEREIN OR AS TO THE ACCURACY OR COMPLETENESS OF THE INFORMATION CONTAINED HEREIN, AND SAME IS SUBMITTED SUBJECT TO ERRORS, OMISSIONS, CHANGE OF PRICE, RENTAL OR OTHER CONDITIONS, WITHDRAWAL WITHOUT NOTICE, AND TO ANY SPECIAL LISTING CONDITIONS IMPOSED BY THE PROPERTY OWNER(S). ANY PROJECTIONS, OPINIONS OR ESTIMATES ARE SUBJECT TO UNCERTAINTY AND DO NOT SIGNIFY CURRENT OR FUTURE PROPERTY PERFORMANCE.