



GARRY KLEIN
Licensed Associate Real Estate Broker
M. 914.588.1585
GKlein@houlihanlawrence.com

JEFFREY LANDSMAN
Licensed Associate Real Estate Broker
M. 917.859.0331
JLandsman@houlihanlawrence.com

800 Westchester Avenue, Suite N-517 • Rye Brook, NY 10573 • O. 914.798.4900

CVS Power Center Retail Spaces For Lease

**1703-1729 CENTRAL PARK AVENUE
YONKERS, NY 10710**

STARTING AT: \$25.00 PSF NNN



CVS POWER CENTER - RETAIL SPACES FOR LEASE

- 3,289 Sq. Ft. (former gym, next to brand new laundromat)
- 1,970 Sq. Ft. (former dry cleaners)
- **STARTING at \$25 PSF NNN**
- Join CVS and Outback Steakhouse in this 56,000 Sq. Ft. Power Center with over 280 on-site parking spaces
- 16 Ft high ceilings
- Located on busiest section of Central Park Avenue with over 43,060 cars per day
- Highly visible signage and signalized intersection

Yonkers Shopping Center is a 56,361 square foot power center located at the intersection of Route 100 and Balint Drive in Yonkers, NY.

Route 100 is the primary retail corridor in Yonkers and is densely developed with a variety of retail and commercial establishments.

The center, which was built in 1972 and renovated in 1999, is located on a 6.03-acre site.

CVS and Outback Steak House anchor the property.



GARRY KLEIN
Licensed Associate Real Estate Broker
M. 914.588.1585
GKlein@houlihanlawrence.com

JEFFREY LANDSMAN
Licensed Associate Real Estate Broker
M. 917.859.0331
JLandsman@houlihanlawrence.com

800 Westchester Avenue, Suite N-517 • Rye Brook, NY 10573 • O. 914.798.4900

CVS Power Center Retail Spaces For Lease

**1703-1729 CENTRAL PARK AVENUE
YONKERS, NY 10710**

STARTING AT: \$25.00 PSF NNN



Floor Plans

**1729 CENTRAL PARK AVENUE
YONKERS, NY 10710**

STARTING AT: \$25.00 PSF NNN

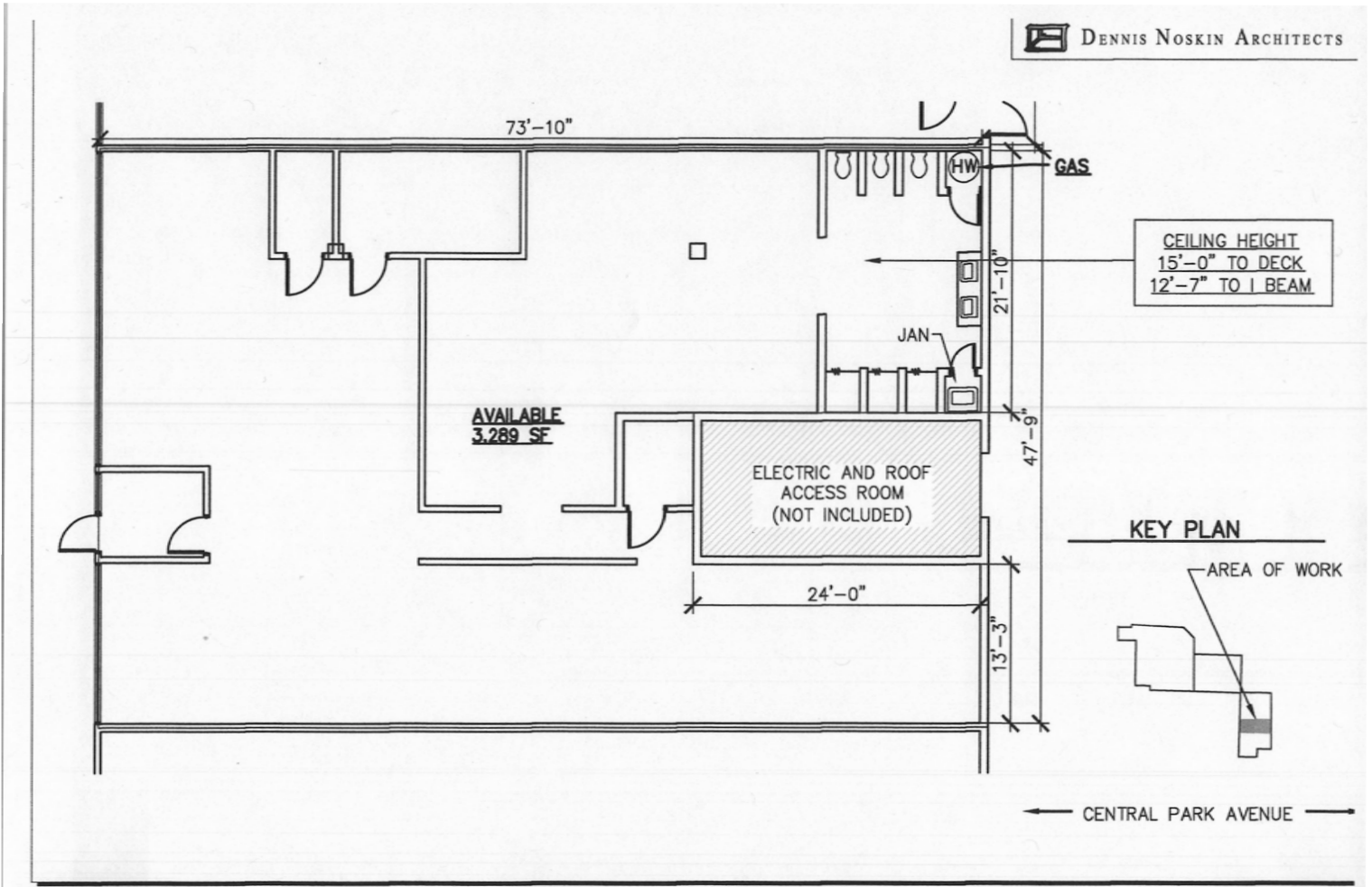

 DENNIS NOSKIN ARCHITECTS



JOB TITLE: **SPACE 3**
DWG TITLE: **MARKETING PLAN**
© 2020 DENNIS NOSKIN ARCHITECT, P.C.

JOB No.: **20023**
SCALE: **3/32"=1'-0"**
ISSUE DATE: **2.19.20**





GARRY KLEIN
Licensed Associate Real Estate Broker
M. 914.588.1585
GKlein@houlihanlawrence.com

JEFFREY LANDSMAN
Licensed Associate Real Estate Broker
M. 917.859.0331
JLandsman@houlihanlawrence.com

800 Westchester Avenue, Suite N-517 • Rye Brook, NY 10573 • O. 914.798.4900

CVS Power Center Retail Spaces For Lease

**1715 CENTRAL PARK AVENUE
YONKERS, NY 10710**

STARTING AT: \$25.00 PSF NNN



800 Westchester Avenue, Suite N-517 • Rye Brook, NY 10573 • O. 914.798.4900

Retail Map

**1703-1729 CENTRAL PARK AVENUE
YONKERS, NY 10710**

STARTING AT: \$25.00 PSF NNN

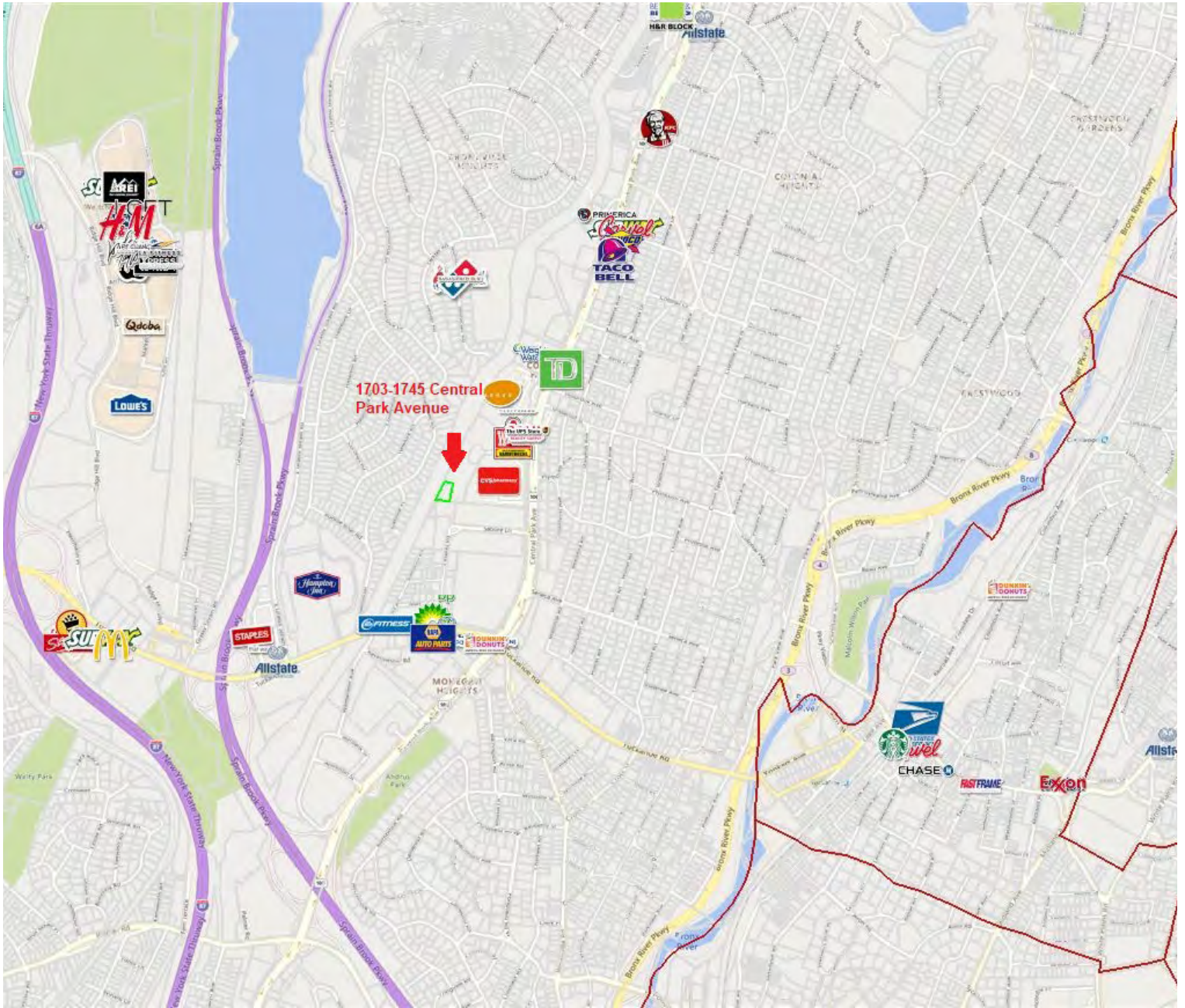

800 Westchester Avenue, Suite N-517 • Rye Brook, NY 10573 • O. 914.798.4900

Aerial View and Regional Map

**1703-1729 CENTRAL PARK AVENUE
YONKERS, NY 10710**

STARTING AT: \$25.00 PSF NNN

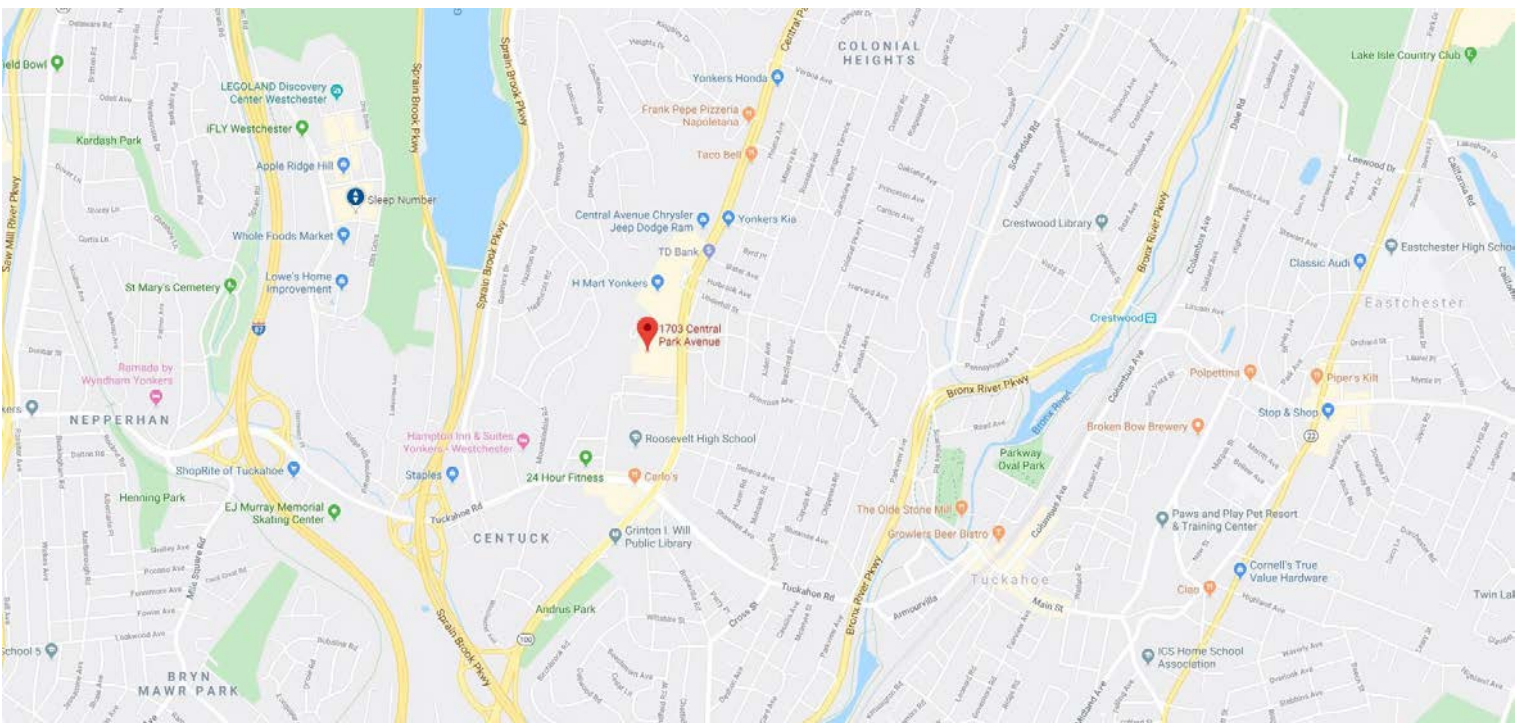

The information contained in this Offering Memorandum is confidential, furnished solely for the purpose of review by a prospective purchaser of certain information relating to the property mentioned herein (the "Property"), and is not to be used for any other purpose or made available to any other person without the prior written consent of HLC. The material is subject to errors and omissions and based on part upon information supplied by sources deemed reliable.