

AVAILABLE FOR LEASE



KASCommercial
— REAL ESTATE —

15705 DETROIT AVE
LAKEWOOD, OH 44107

BROKERED BY
exp[®]
COMMERCIAL

15705 DETROIT AVE LAKEWOOD, OH 44107

PROPERTY
INFORMATION



Type	Office
Term	Negotiable
Price	\$750 / MG
Tenancy	Single
Space sq	572 sf
Parking	Parking Lot





PROPERTY HIGHLIGHTS

Prime Location:

Situated at the corner of Detroit Ave and Westwood Ave, within walking distance to Lakewood's vibrant restaurants, bars, and retail stores.

Convenient Amenities:

Shared restrooms, kitchen with fridge, and a designated parking lot for tenants.

Flexible Office Space:

A variety of office sizes available, perfect for small businesses and entrepreneurs with flexible lease terms.

Secure Access:

Front door locked for security, with key fobs and access codes for easy client entry.

15705 DETROIT AVE LAKEWOOD, OH 44107

PROPERTY DESCRIPTION

The Rosewood Building, located at the corner of Detroit Ave and Westwood Ave in Lakewood, OH, offers office spaces in various sizes, perfect for small businesses and entrepreneurs.

The building features a welcoming lobby, community area, and several individual office spaces of various sizes. Tenants benefit from a designated parking lot, shared restrooms on both floors, and a shared kitchen with fridge.

Tenants are responsible for electricity and Wi-Fi, while the owner covers everything else. The front door is locked for security, with key fobs and access codes provided for easy client entry.

Located within walking distance of Lakewood's vibrant restaurants, bars, and retail stores, this prime location offers the perfect mix of convenience and opportunity. Flexible lease terms make it an ideal choice for your next office space at the Rosewood Building!



15705 DETROIT AVE LAKEWOOD, OH 44107



15705 DETROIT AVE LAKEWOOD, OH 44107



15705 DETROIT AVE LAKEWOOD, OH 44107

LOCATION

MAP

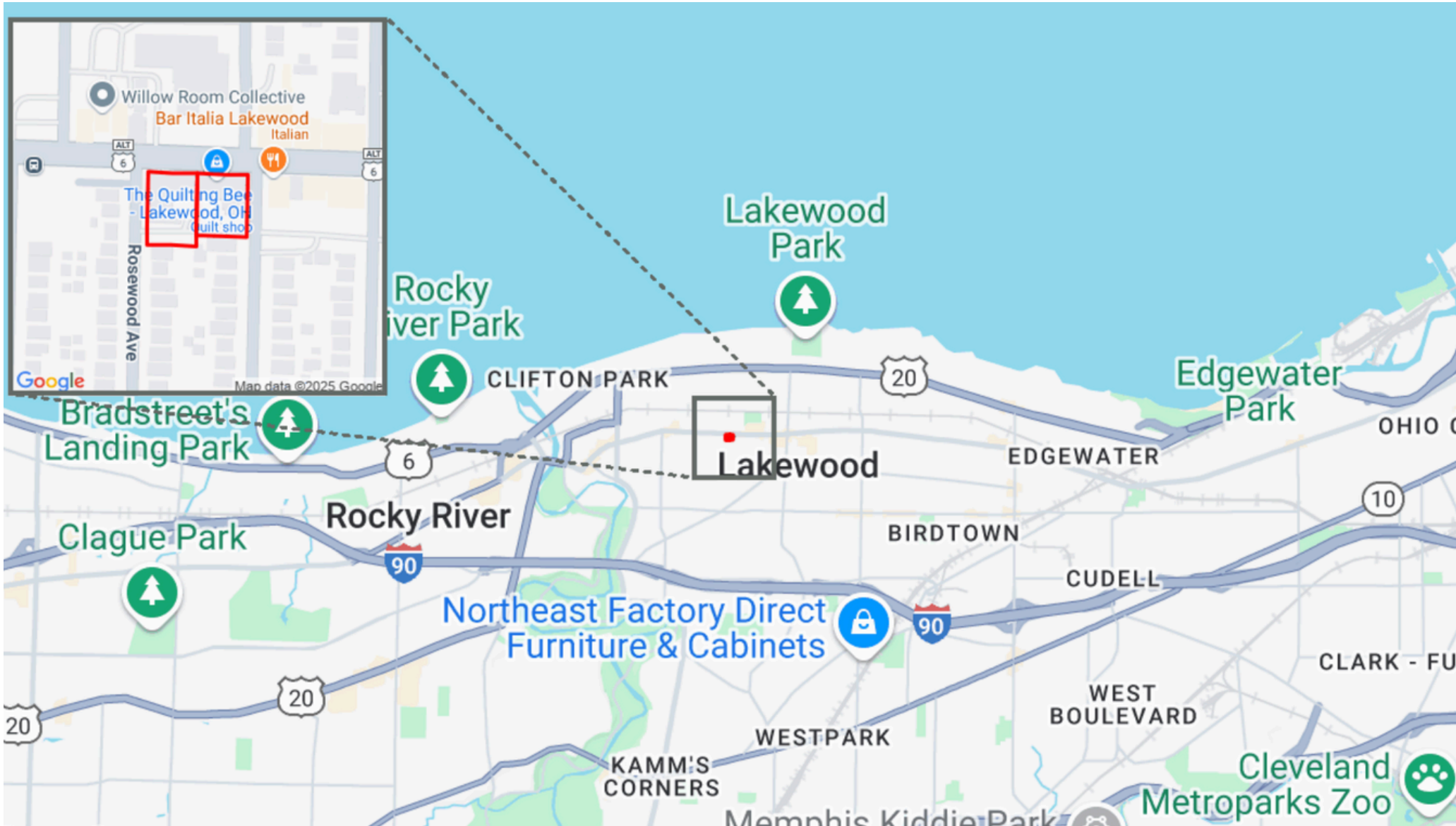

15705 DETROIT AVE LAKEWOOD, OH 44107

FLOOR PLAN

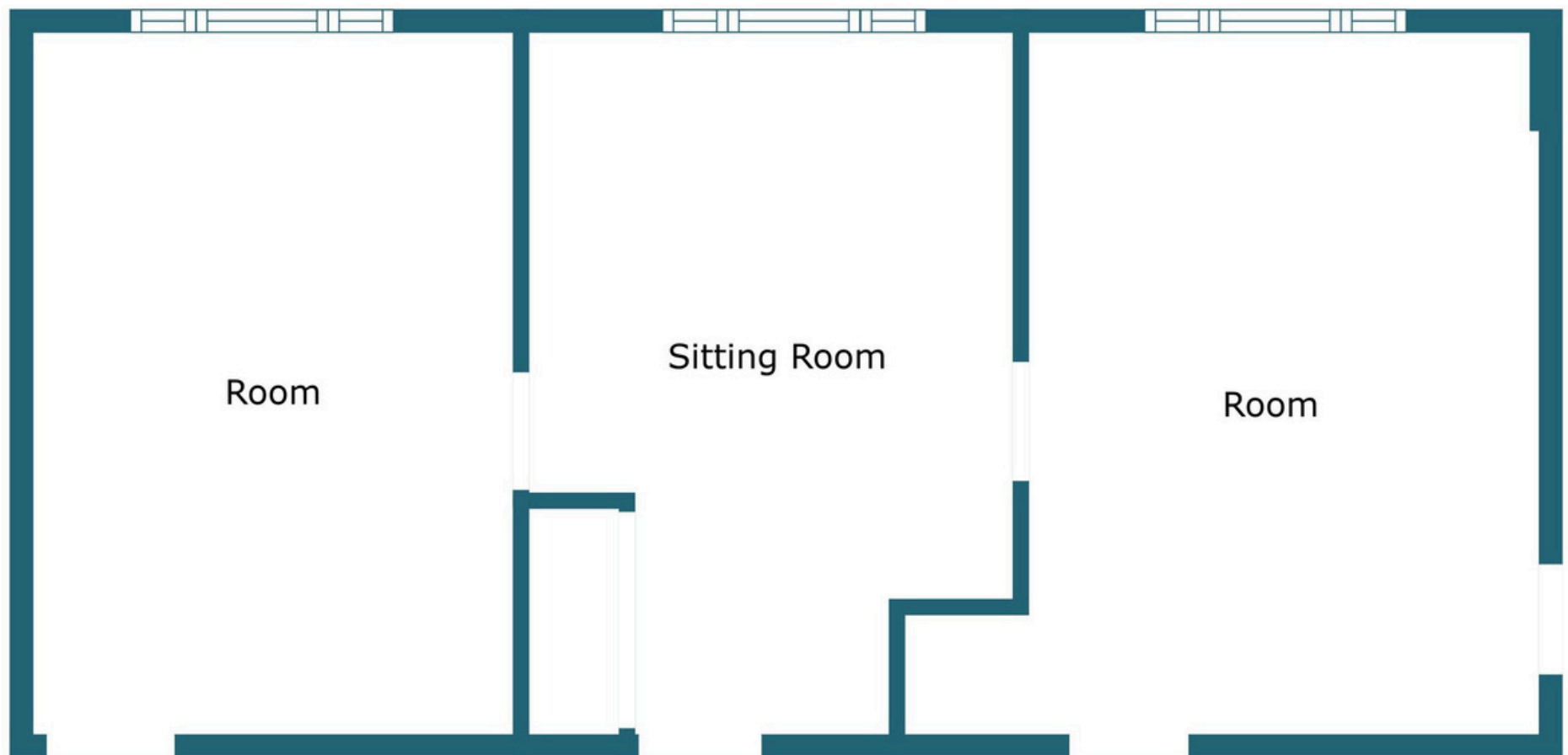

15705 DETROIT AVE LAKEWOOD, OH 44107



Location Facts & Demographics

Demographics are determined by a 10 minute drive from 15705 Detroit Ave, Lakewood, OH 44107

CITY, STATE

Lakewood, OH

POPULATION

118,221

AVG. HH SIZE

2.30

MEDIAN HH INCOME

\$45,945

HOME OWNERSHIP

Renters: **26,705**

Owners: **27,459**

EMPLOYMENT

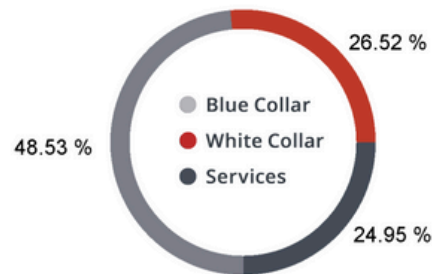

52.10 %

Employed

2.25 %

Unemployed

EDUCATION

High School Grad: **25.25 %**

Some College: **21.90 %**

Associates: **5.32 %**

Bachelors: **34.78 %**

GENDER & AGE

49.05 %  50.95 % 

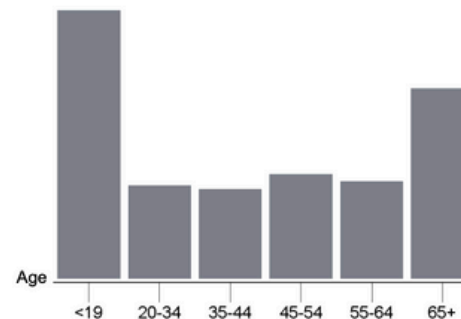

RACE & ETHNICITY

White:	90.84 %
Asian:	0.77 %
Native American:	0.01 %
Pacific Islanders:	0.00 %
African-American:	2.77 %
Hispanic:	2.94 %
Two or More Races:	2.67 %

 Catylist Research

INCOME BY HOUSEHOLD

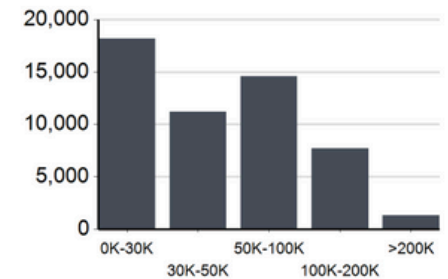

HH SPENDING

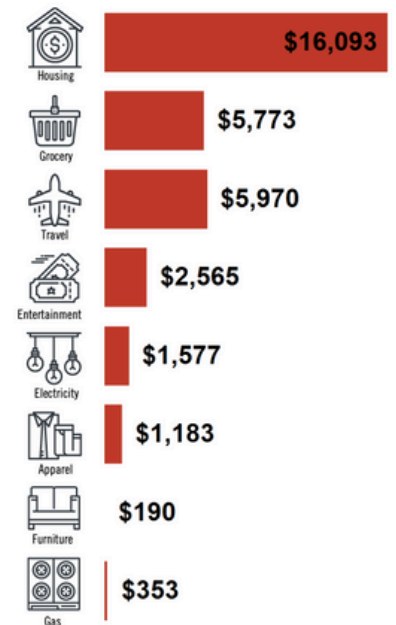



CONTACT ME

EXP COMMERCIAL

Kas Filippova

216-374-3689
kas@theiconicpartners.com

