

one eighth" inch = one foot
 one quarter" inch = one foot
 three eighths" inch = one foot
 one half" inch = one foot
 one inch = one foot
 one and one half" inches = one foot

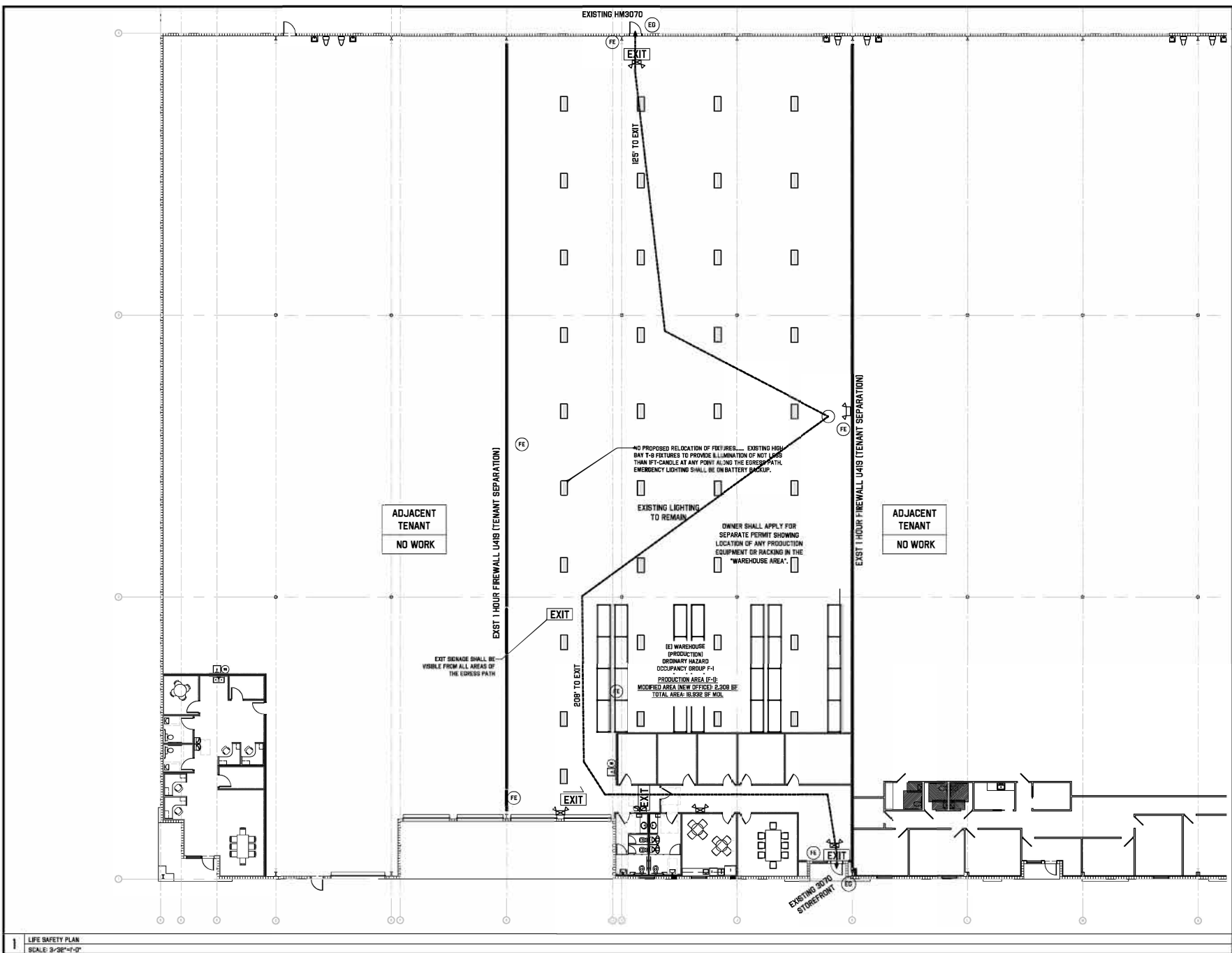

1 LIFE SAFETY PLAN
 SCALE: 3/32"=1'-0"

TAVRIDA ELEC		CG20-002
PROJECT: _____ DESIGNER: _____ DRAWN BY: _____ CHECKED BY: _____		
FBC 6TH EDITION (2017)		
<small>CONNELLY GROUP CONSULTING ENGINEERS AND THEIR AGENTS, RESERVING THE RIGHT TO MAKE DETAILS MODIFIED HERE AT ANY TIME OR REVISION. WE ACCEPT NO LIABILITY FOR ECONOMIC IMPROVEMENTS, THEREAFTER, AND SPECIFIC REPRESENTATIONS OR DESIGN CONCEPTS, ACTUAL DETAILS SUBJECT TO FIELD VERIFICATION.</small>		
SHEET DATE: 3/26/2018 4:46 PM SHEET TITLE: LIFE SAFETY PLAN		SUITE 200
Mosk Development suite 200 2000 TALL PINES DR LARGO, FL 33771		
DRAWING SETS		
REVIEW	DATE	BY
CHRISTOPHER S. CONNELLY, PE P.L. 15100087 - 0001 (08/01)		
LIFE SAFETY PLAN		
A201		