

1234 Market Street

Philadelphia, PA

Space Profile:

Floor	3rd
RSF	16,726 RSF
Rental Rate	\$21.00 + Electric
Availability	Immediate
Term	Until 1/31/2026
Submarket	Market East
Built	1973, renovated 1995

Features:

- Plug & Play Sublease
- Building has direct access to the Market Frankford SEPTA Line
- 3-minute walk to Jefferson Station – access to Regional Rail
- Amenity rich location
- Mix of private offices, conference rooms and collaboration space
- Space is currently used as a call center
- Furniture can be made available

Contact:



Eric Pinchak
570.573.3930
epinchak@cresa.com



Jeff Baker
610.888.5379
jbaker@cresa.com



1234 Market Street

3rd Floor - 16,726 RSF

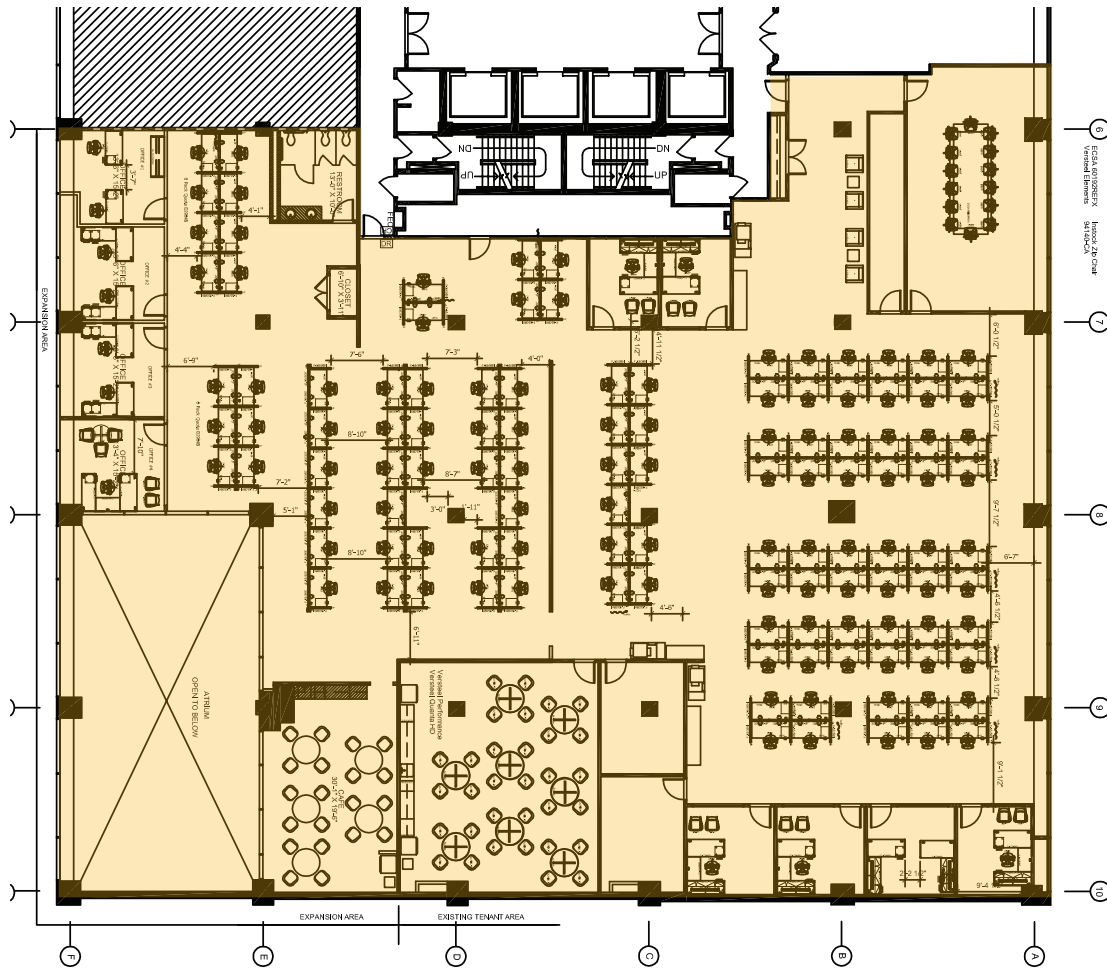

Location Map:

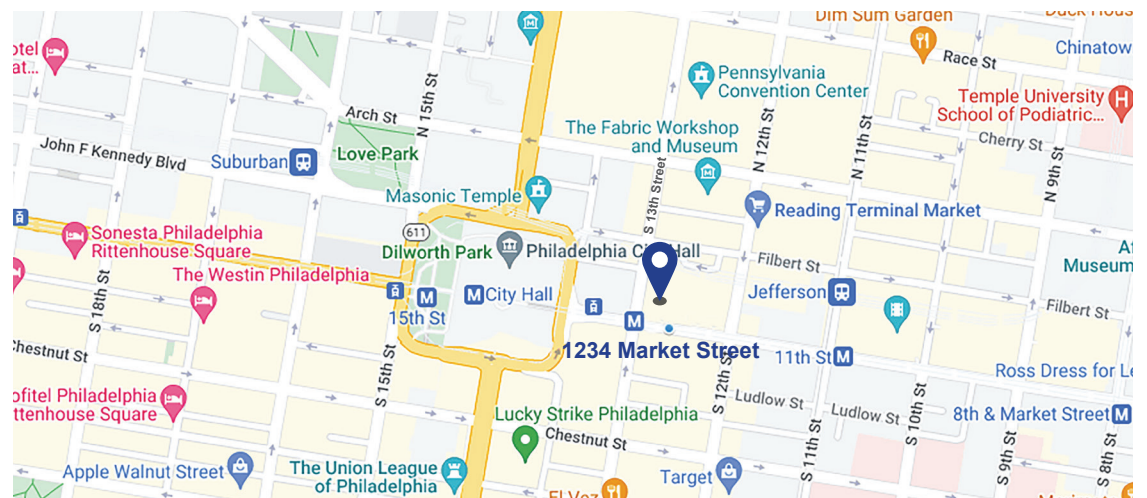



1234 Market Street

3rd Floor - 16,726 RSF



cresa ::

Cresa © 2022. All rights reserved. The information contained in this document has been obtained from sources believed reliable. While Cresa does not doubt its accuracy, Cresa has not verified it and makes no guarantee, warranty, or representation about it. It is your responsibility to independently confirm its accuracy and completeness. Any projections, opinions, assumptions or estimates used are for example only and do not represent the current or future performance of the property. The value of this transaction to you depends on tax and other factors which should be evaluated by your tax, financial and legal advisors. You and your advisors should conduct a careful, independent investigation of the property to determine to your satisfaction the suitability of the property for your needs.