

**SUBLEASE**

**10,705 SF AVAILABLE**



# BLACKHAWK CORPORATE CENTER II

**2902 W AGUA FRIA FREEWAY PHOENIX, AZ**



# SUITE 1020

## SUBLEASE

Suite 1020 is in shell condition, demise-able, and includes a TI allowance, providing space and flexibility for a customized build-out. Expires November 31, 2032.

### LOCATION HIGHLIGHTS

- + Excellent freeway access and exposure along Loop 101 & I-17
- + Centered in a major employment hub
- + Just five minutes from Deer Valley Airport
- + Four minutes from HonorHealth Deer Valley hospital
- + 6/1,000 parking ratio
- + Ideal for medical or office uses

### PROPERTY FEATURES

- + Building size: ±84,410 SF
- + Available: 10,705 SF
- + Leasing Rate: \$19 NNN
- + \$75/SF tenant improvement allowance
- + 10 year term
- + 24' clear height
- + Potential building signage
- + Year built: 1998
- + Potential for on-site backup generator

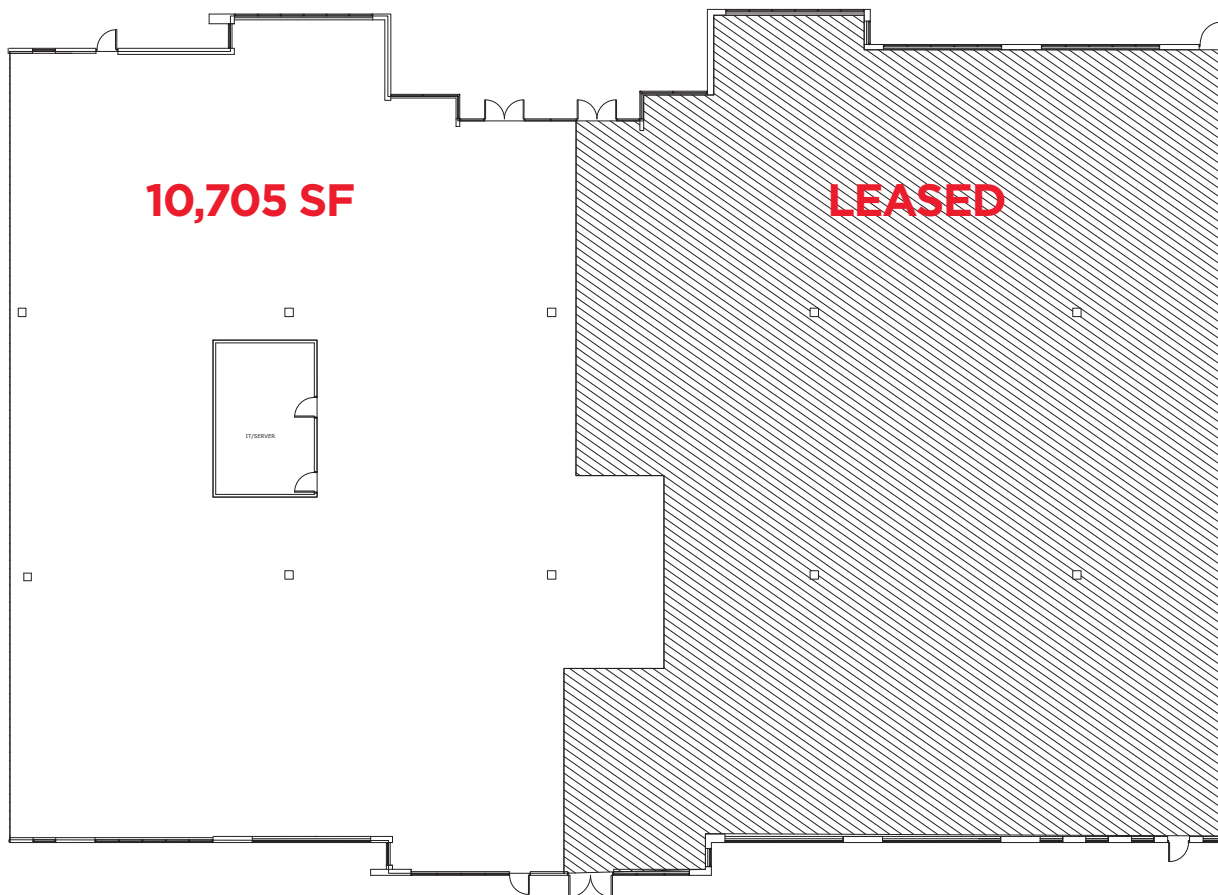

# NEARBY AMENITIES

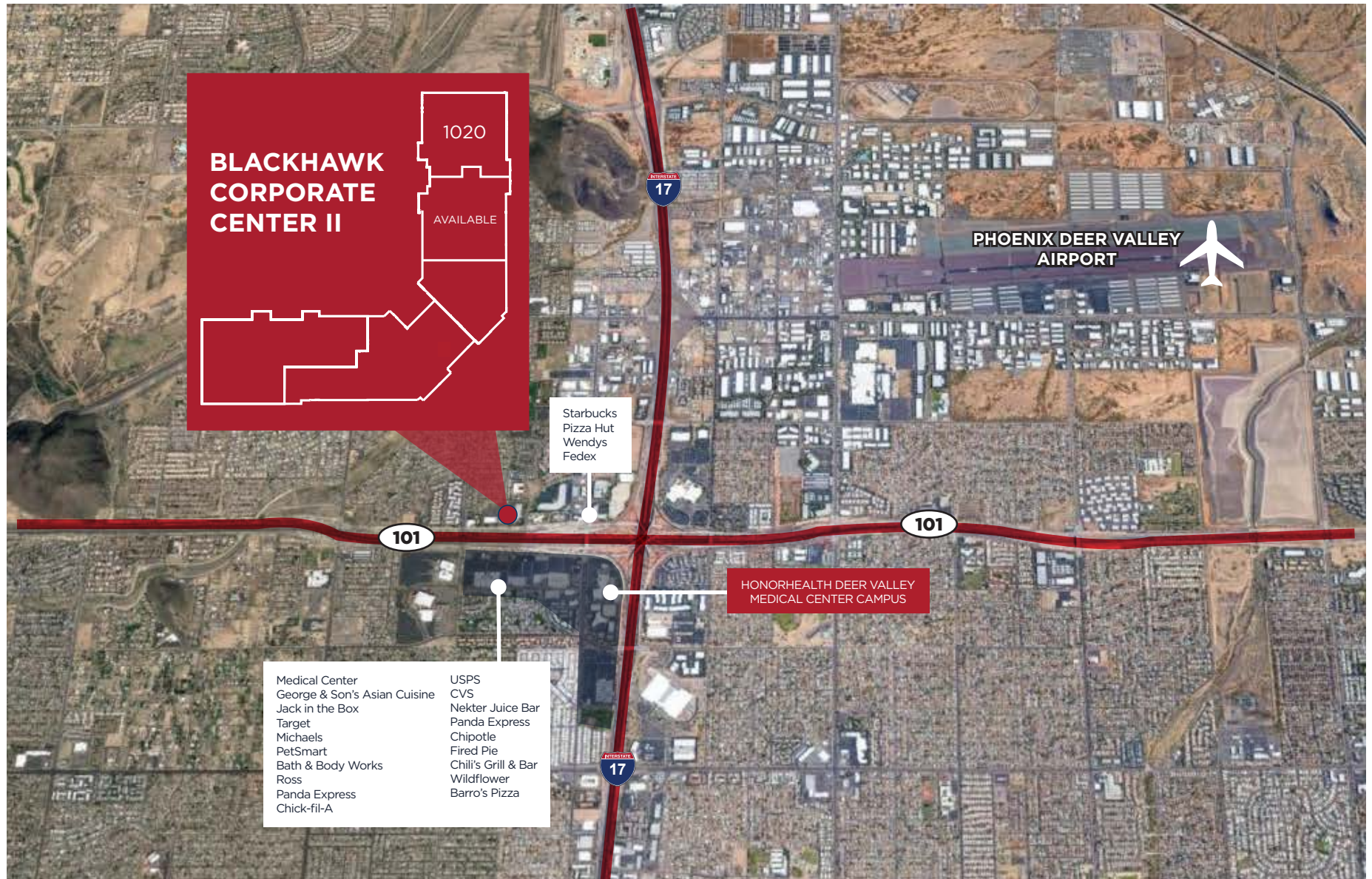

## SERVICE LINE GROWTH PROJECTIONS 10-MILE RADIUS

SERVICE LINE	2020 VOLUME	2025 VOLUME	2030 VOLUME	5 YR GROWTH	10 YR GROWTH
PHYSICAL THERAPY REHABILITATION	637,096	880,443	1,044,750	38.20%	64.00%
THORACIC SURGERY	1,345	1,852	2,158	37.80%	60.50%
PAIN MANAGEMENT	28,048	38,609	46,579	37.70%	66.10%
SPINE	4,894	6,685	7,710	36.60%	57.50%
ORTHOPEDICS	73,865	100,363	119,234	35.90%	61.40%
PODIATRY	40,340	54,122	68,255	34.20%	69.20%
NEUROSURGERY	2,319	3,078	3,617	32.70%	55.90%
NEUROLOGY	43,060	55,402	65,661	28.70%	52.50%
VASCULAR	40,942	51,845	61,574	26.60%	50.40%
OPHTHALMOLOGY	219,807	277,816	326,366	26.40%	48.50%



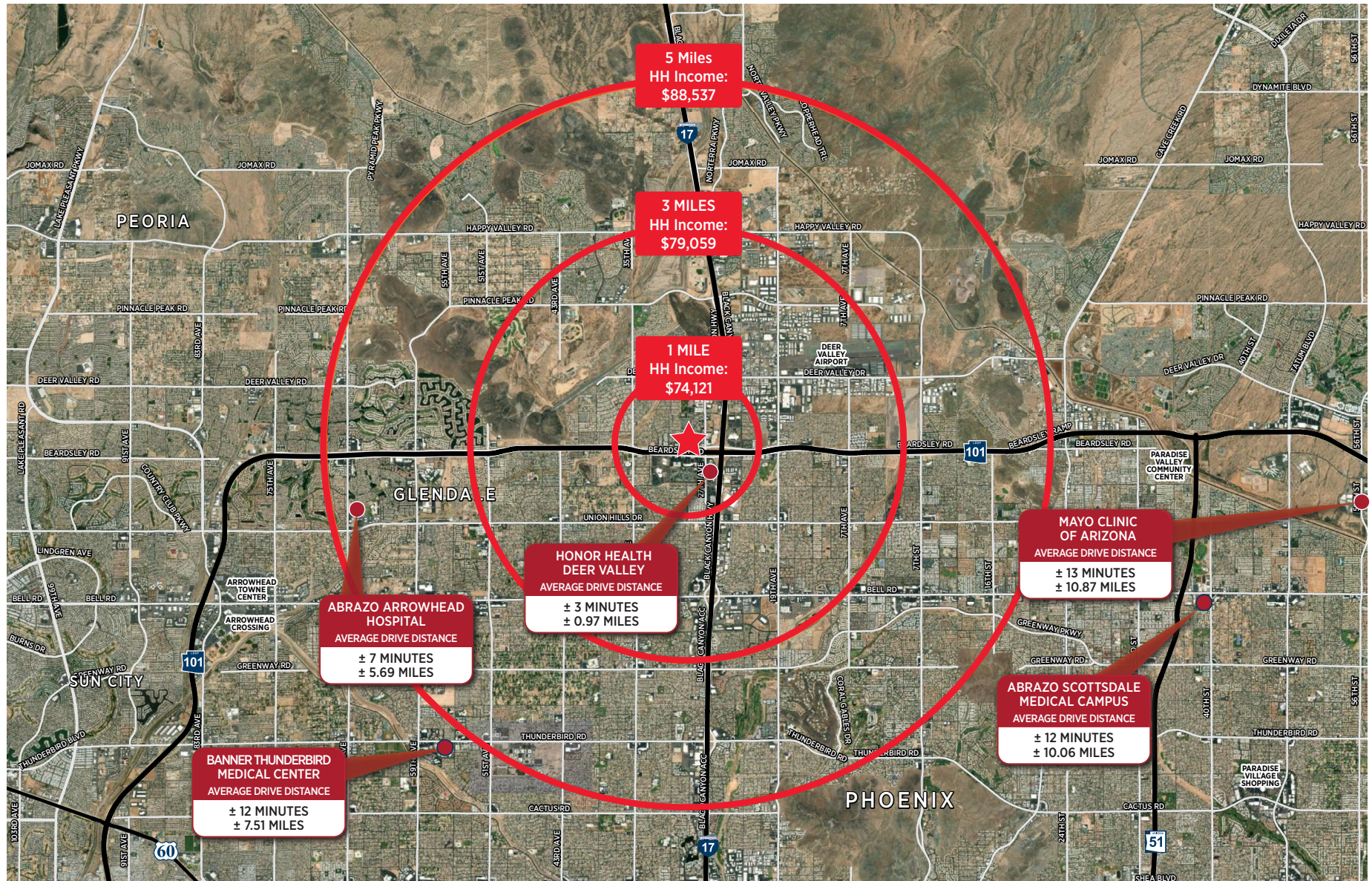

# CONTACT INFORMATION

## **SHEILA BALE**

Managing Director  
+1 602 224 4454  
[sheila.bale@cushwake.com](mailto:sheila.bale@cushwake.com)

## **TOM WEINHOLD**

Managing Director  
+1 602 224 4428  
[tom.weinhold@cushwake.com](mailto:tom.weinhold@cushwake.com)

## **ERIKA ECKBLAD**

Associate  
+1 602 224 4451  
[erika.eckblad@cushwake.com](mailto:erika.eckblad@cushwake.com)



©2022 Cushman & Wakefield. All rights reserved. The information contained in this communication is strictly confidential. This information has been obtained from sources believed to be reliable but has not been verified. NO WARRANTY OR REPRESENTATION, EXPRESS OR IMPLIED, IS MADE AS TO THE CONDITION OF THE PROPERTY (OR PROPERTIES) REFERENCED HEREIN OR AS TO THE ACCURACY OR COMPLETENESS OF THE INFORMATION CONTAINED HEREIN, AND SAME IS SUBMITTED SUBJECT TO ERRORS, OMISSIONS, CHANGE OF PRICE, RENTAL OR OTHER CONDITIONS, WITHDRAWAL WITHOUT NOTICE, AND TO ANY SPECIAL LISTING CONDITIONS IMPOSED BY THE PROPERTY OWNER(S). ANY PROJECTIONS, OPINIONS OR ESTIMATES ARE SUBJECT TO UNCERTAINTY AND DO NOT SIGNIFY CURRENT OR FUTURE PROPERTY PERFORMANCE.