

±122,262 SF INDUSTRIAL LAND AVAILABLE

636 E ROSECRANS AVE | LOS ANGELES, CA 90059

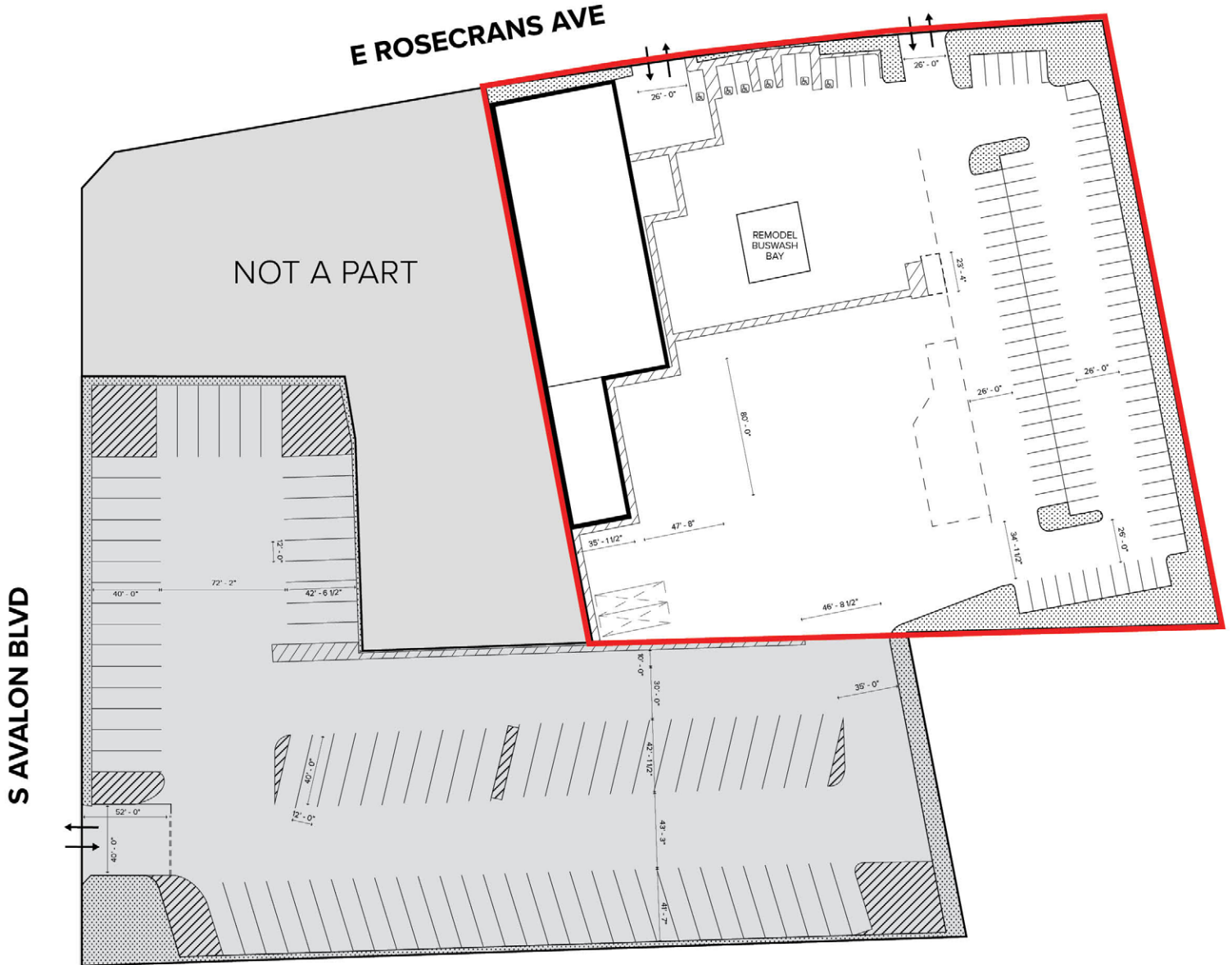

NOTE: Drawing not to scale. All measurements and sizes are approximate. Lessee to Verify

FOR MORE INFORMATION, PLEASE CONTACT

DAVID COX

Associate | LIC NO 02130657
e dcox@lee-associates.com
c 760.571.4827

MILES SOLOMON

Senior Vice President & Land Specialist | LIC NO 02099423
e msolomon@lee-associates.com
c 949.532.8609

DOUG CLINE

Senior Vice President | LIC NO 01142005
e dcline@lee-associates.com
c 213.324.2957

JACK R. CLINE, JR.

President | LIC NO 00854279
e jcline@lee-associates.com
c 213.590.3512



Lee & Associates® Los Angeles, Inc.
CORP ID 02174865

1201 North Main Street,
Los Angeles, California 90012

LEE-ASSOCIATES.COM/DOWNTOWNLA

The information supplied herein is deemed to be reliable, however, it is provided without any representations, warranty or guarantee, expressed or implied. Buyer/Tenant to verify all and to conduct independent investigation and verification of all material information, including, but not limited to environmental, survey, and zoning. Consult your attorney, accountant, or other professional advisor.