

F O R L E A S E

# NEW HAVEN PLAZA

540 & 560 Ella T. Grasso Boulevard / New Haven, CT 06519

## 5,000 - 60,000 SF OF OFFICE/FLEX SPACE

CBRE is pleased to present New Haven Plaza, an excellent opportunity to lease quality space at 540 & 560 Ella T. Grasso Boulevard in New Haven, Connecticut, ideal for Life Science, Educational and standard office or flex uses. The property offers excellent highway access and proximity to Yale-New Haven Hospital, Yale University, University of New Haven and the Central Business District with a scenic riverscape and open green space.

### Currently Available:

<b>+ 540 Ella T. Grasso Boulevard:</b>	32,000 SF (column free)
<b>+ 560 Ella T. Grasso Boulevard:</b>	60,000 SF
<b>+ Lease Rate:</b>	\$16.50/SF Gross

### Property Highlights:

- + Available space can be subdivided to 5,000 SF
- + Ample surface parking
- + Less than one mile to Interstate 95
- + Less than five minutes to Yale-New Haven Hospital and Downtown New Haven
- + Single story building can be an easy conversion to Life Science/Biotech

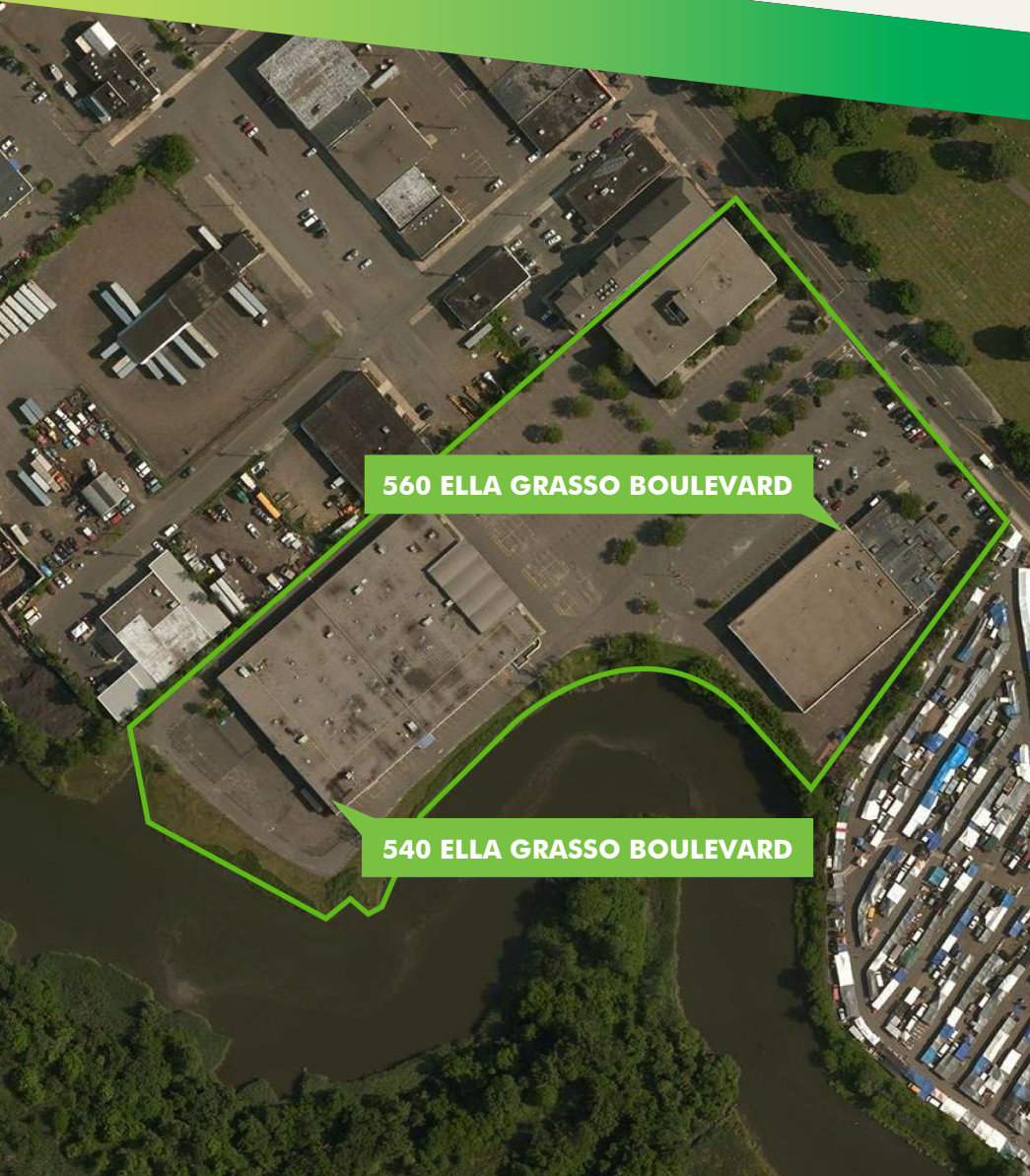



## 540 ELLA T. GRASSO BOULEVARD









# 560 ELLA T. GRASSO BOULEVARD





# FLOOR PLAN

## 560 ELLA T. GRASSO BOULEVARD

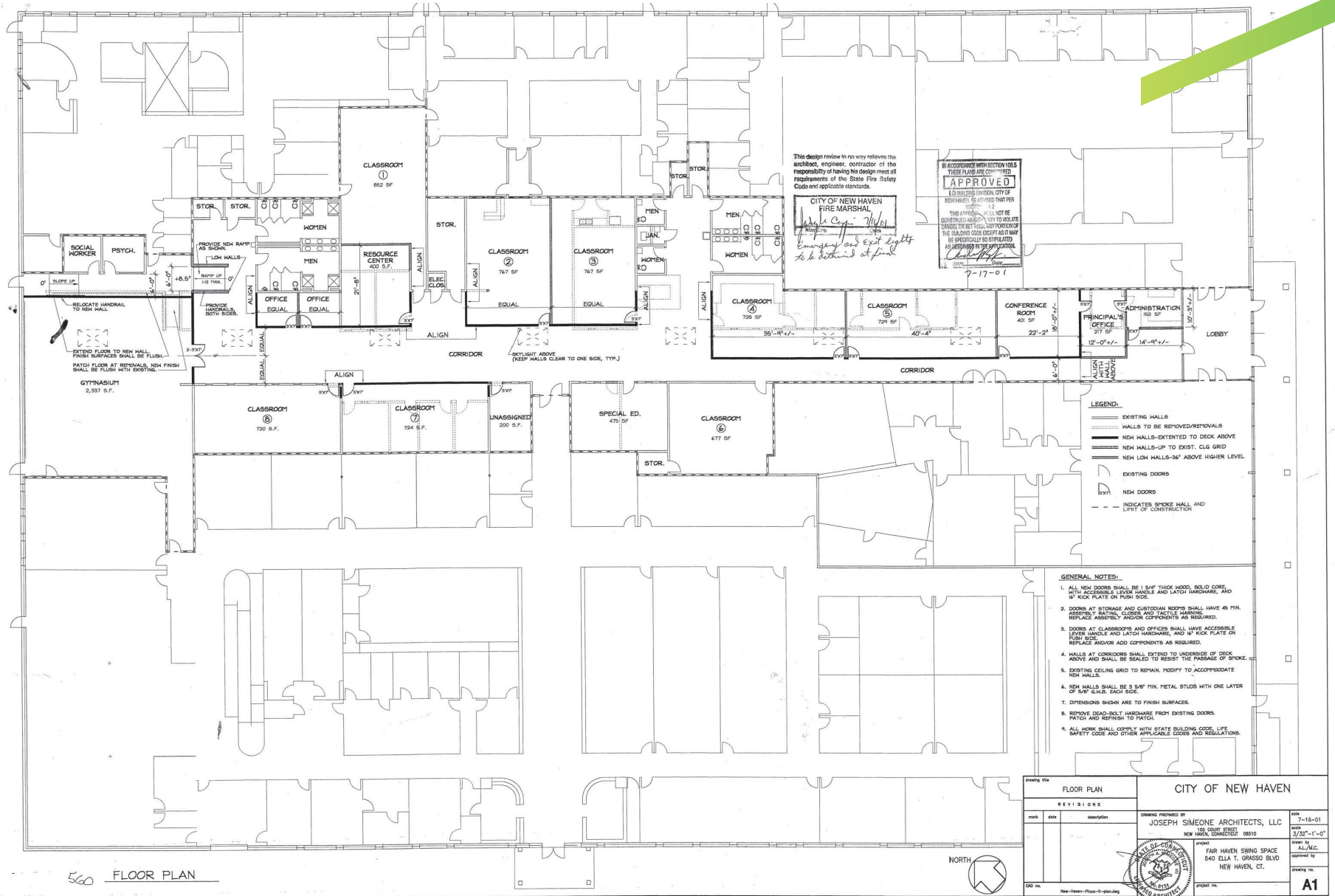

# NEW HAVEN PLAZA

540 & 560 Ella T. Grasso Boulevard / New Haven, CT 06519

## PLEASE CONTACT:

DAVID HANSEN

Vice President

+1 203 777 5996

david.hansen@cbre.com

---

© 2020 CBRE, Inc. All rights reserved. This information has been obtained from sources believed reliable, but has not been verified for accuracy or completeness. You should conduct a careful, independent investigation of the property and verify all information. Any reliance on this information is solely at your own risk. CBRE and the CBRE logo are service marks of CBRE, Inc. All other marks displayed on this document are the property of their respective owners, and the use of such logos does not imply any affiliation with or endorsement of CBRE. Photos herein are the property of their respective owners. Use of these images without the express written consent of the owner is prohibited.