

PECOS WINDMILL PLAZA



2667 WINDMILL PARKWAY
HENDERSON, NV 89014



RESTAURANT CONCEPTS
WELCOMED BY LANDLORD

MULTI-TENANT RETAIL CENTER

FOR LEASE

PROPERTY HIGHLIGHTS

- Vons anchored shopping center
- Parking Ratio 5/1,000 SF
- Pylon sign available along Pecos Road
- Located within the highly desirable Henderson Submarket
- Zoning: Community Commercial (CC)

SHOPPING CENTER HIGHLIGHTS

This grocery anchored center is located in the highly desirable Henderson Submarket with easy ingress and egress and ample parking for customers and tenants. The center has great visibility from Pecos Road and Windmill Parkway and is just off the 215 Beltway. Join Dairy Queen, GameStop, Little Caesars Supercuts, Sherwin Williams, The UPS Store and many more fine amenities and services.



AREA DEMOGRAPHICS



Population

22,862
within 1 Mile

155,698
within 3 Miles

370,415
within 5 Miles



Average HH Income

\$101,205
within 1 Mile

\$97,653
within 3 Miles

\$91,058
within 5 Miles



An aerial map of an industrial area along North Pecos Road. The map shows several large industrial buildings, some labeled "NAP". A central horizontal road is labeled "WINDMILL PARKWAY". To the right, a vertical road is labeled "NORTH PECOS ROAD". Various businesses are indicated by logos: Scenthound, The UPS Store, Green County, Supercuts, Little Caesars Pizza, and Jackson Hewitt. Numerous lot numbers are displayed, including 2601, 2603, 2605, 2607, 197, 195, 193 #110, 193 #100, 191, 2663, 2661, 2659, 2657, 2655, 2653, 2651, 2649, 2647, 2645, 2643, 2641, 2639, 2637, 2635, 2631, and 195. Two specific locations are highlighted with red dots and labeled "AVAILABLE": one near lot 195 and another near lot 2631. At the bottom, there are two circular icons with arrows indicating a 360-degree view, labeled "193-100 TOUR" and "195 TOUR". A north arrow is located in the top left corner.

AVAILABILITIES

2601-2607 WINDMILL PARKWAY

SUITE	TENANT	SF
2601	Sandwich Spot	1,380
2603	Tenkogu	1,200
2605	Siri Thai Restaurant	1,200
2607	Dairy Queen	1,200

193-197 NORTH PECOS ROAD

SUITE	TENANT	SF
193-100 	AVAILABLE	2,200
193-110	Anderson Audiology	1,119
195 	AVAILABLE	1,500
197	Elan Beaute	1,800

191 NORTH PECOS ROAD

SUITE	TENANT	SF
191	Sherwin-Williams	4,800

2631-2663 WINDMILL PARKWAY

SUITE	TENANT	SF
2631	AVAILABLE	1,100
2633	Anthony's Jewelry and Watch Repair	1,100
2635	Jackson Hewitt	825
2637	Al Phillips The Cleaner	1,100
2639	Little Caesars Pizza	1,100
2641	Healing Garden	832
2643	Hashu Smoke Shop	1,191
2645	B of A ATM	747
2647	Pecos-Windmill Water Storage	1,100
2649	Supercuts	1,100
2651	Family ATA	1,925
2655	Cactus Comics	825
2657	The UPS Store	1,100
2659	Scent Hound	1,375
2661	VQ Nails	1,100
2663	Elle A Boutique and Salon	1,622



AERIAL MAP

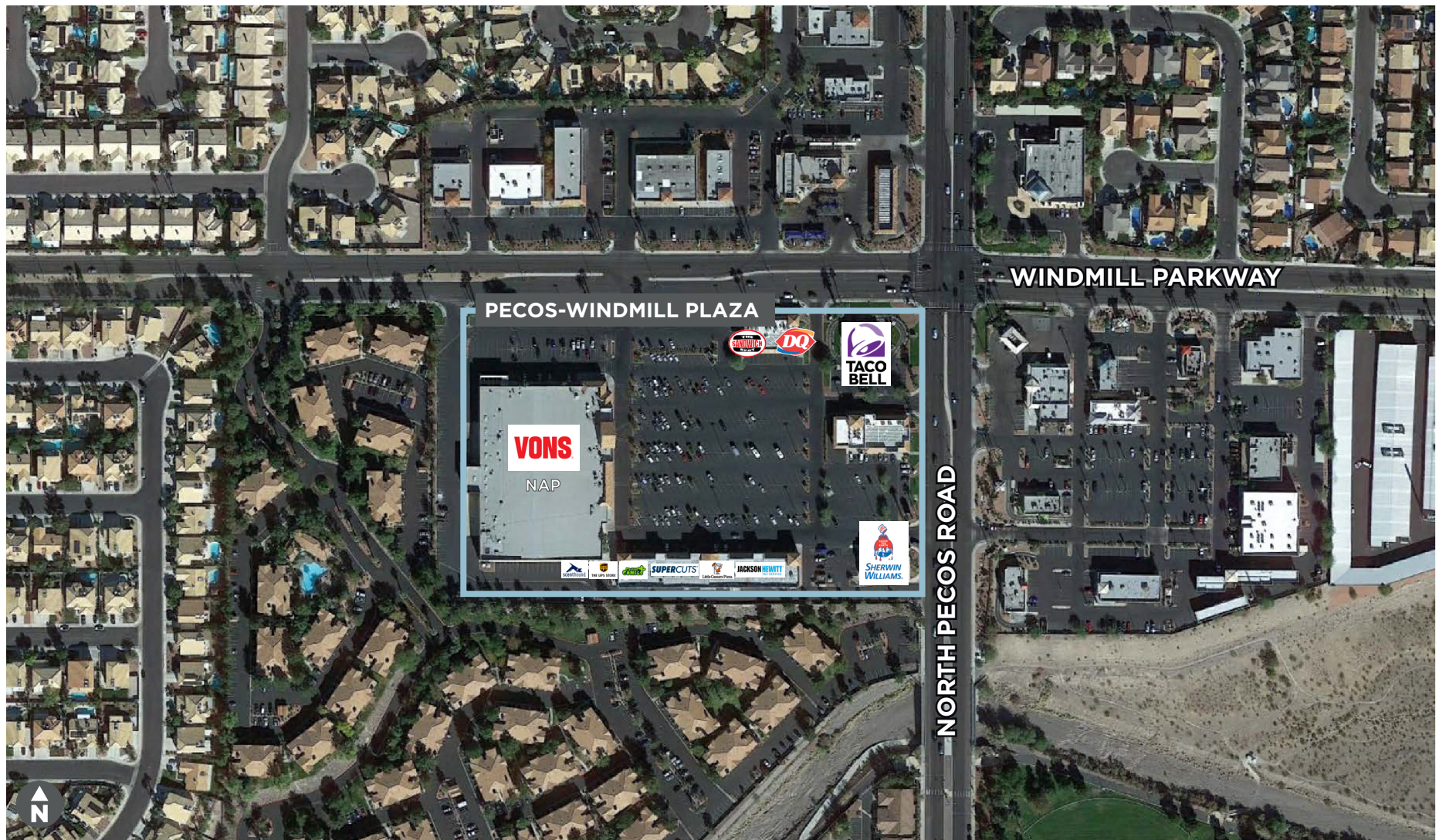

CONTACT



Scot Marker
Director - Retail
NV License S 0034109
Direct: +1 702 688 6890
Mobile: +1 702 592 5030
Fax: +1 702 796 7920
scot.marker@cushwake.com



Nadia Mumtaz
Associate
Office: +1 702 796 7900
Mobile: +1 702 375 8809
Lic #NV-S.0201377
nadia.mumtaz@cushwake.com

10845 Griffith Peak Drive, Suite 160
Las Vegas, NV 89135
cushmanwakefield.com

2667

WINDMILL PARKWAY HENDERSON, NV 89014

©2026 Cushman & Wakefield. All rights reserved. The information contained in this communication is strictly confidential. This information has been obtained from sources believed to be reliable but has not been verified. NO WARRANTY OR REPRESENTATION, EXPRESS OR IMPLIED, IS MADE AS TO THE CONDITION OF THE PROPERTY (OR PROPERTIES) REFERENCED HEREIN OR AS TO THE ACCURACY OR COMPLETENESS OF THE INFORMATION CONTAINED HEREIN, AND SAME IS SUBMITTED SUBJECT TO ERRORS, OMISSIONS, CHANGE OF PRICE, RENTAL OR OTHER CONDITIONS, WITHDRAWAL WITHOUT NOTICE, AND TO ANY SPECIAL LISTING CONDITIONS IMPOSED BY THE PROPERTY OWNER(S). ANY PROJECTIONS, OPINIONS OR ESTIMATES ARE SUBJECT TO UNCERTAINTY AND DO NOT SIGNIFY CURRENT OR FUTURE PROPERTY PERFORMANCE.

