

# Pine Hill Business Center 2521 Schieffelin Road

FLEX SUITE FOR LEASE | APEX, NC

**PINE HILL BUSINESS CENTER**  
**2521 SCHIEFFELIN ROAD**

## CONTACT

GRAY CREECH | 919.880.0284 | [gcreech@triprop.com](mailto:gcreech@triprop.com)

**NAI** TRI PROPERTIES

All information provided herein is from sources deemed reliable. However, all information is subject to verification.  
NAI Tri Properties does not independently verify nor warrant the accuracy of the information.

# PINE HILL BUSINESS PARK

One suite for Lease located at US 1 and Ten Ten Road exit.

ADDRESS:	2521 Schieffelin Road Suites 104 & 106 Apex, North Carolina 27502
AVAILABLE SF:	Suite 104: 2,275 SF
RATE:	\$19.75/PSF, NNN
TICAM:	TICAM includes: cold water, exterior, lighting, dumpster, \$3.25 PSF
POWER:	3-Phase 120/208 service
LOCATION:	Located 8 miles from Raleigh Located 9 miles to Research Triangle Park
DOCK DOORS:	Suite 104: 1
OFFICES	Suite 104: 3
HVAC:	100%
FEATURES:	US 1 visibility US 1 access via service road Signage allowed on building Natural gas City water & sewer Can be leased separately

## CONTACT

GRAY CREECH | 919.880.0284 | [gcreech@triprop.com](mailto:gcreech@triprop.com)

**NAI**TRI PROPERTIES



# FLOOR PLAN

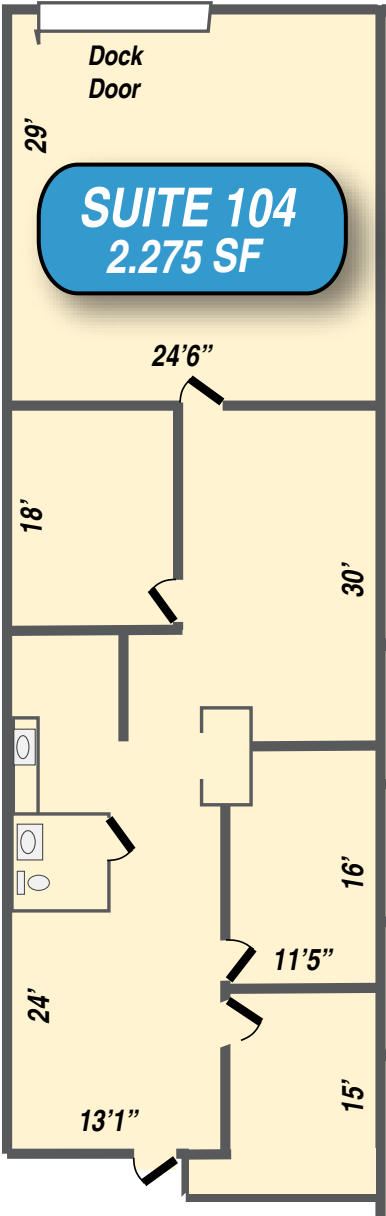

## CONTACT

GRAY CREECH | 919.880.0284 | GCREECH@TRIPROP.COM

All information provided herein is from sources deemed reliable. However, all information is subject to verification. NAI Tri Properties does not independently verify nor warrant the accuracy of the information.

# SITE PLAN

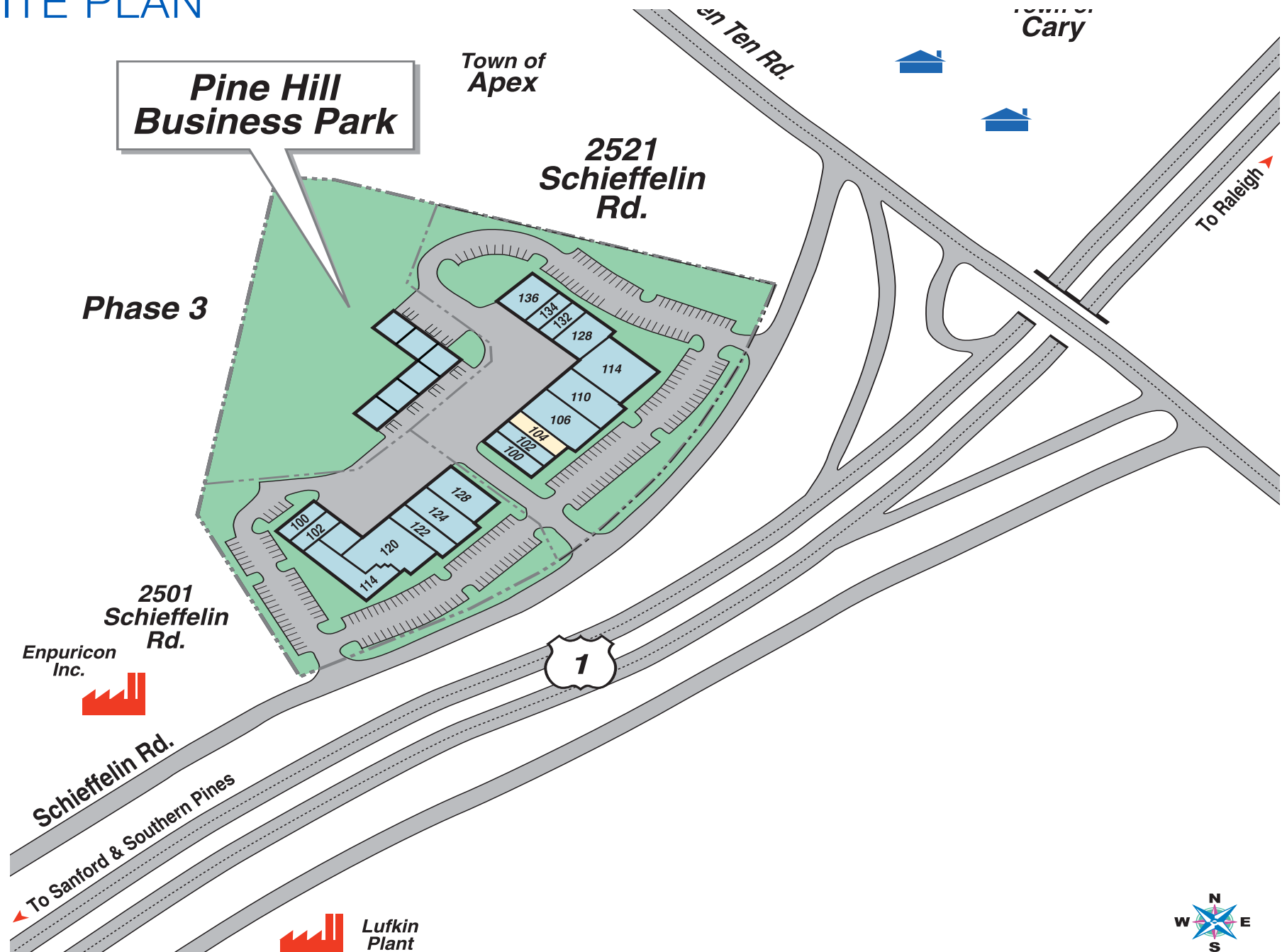

## CONTACT

GRAY CREECH | 919.880.0284 | GCREECH@TRIPROP.COM

All information provided herein is from sources deemed reliable. However, all information is subject to verification. NAI Tri Properties does not independently verify nor warrant the accuracy of the information.



# AERIAL



## CONTACT

GRAY CREECH | 919.880.0284 | [GCREECH@TRIPROP.COM](mailto:GCREECH@TRIPROP.COM)

All information provided herein is from sources deemed reliable. However, all information is subject to verification. NAI Tri Properties does not independently verify nor warrant the accuracy of the information.

**NAI**TRI PROPERTIES

# TRIANGLE REGION

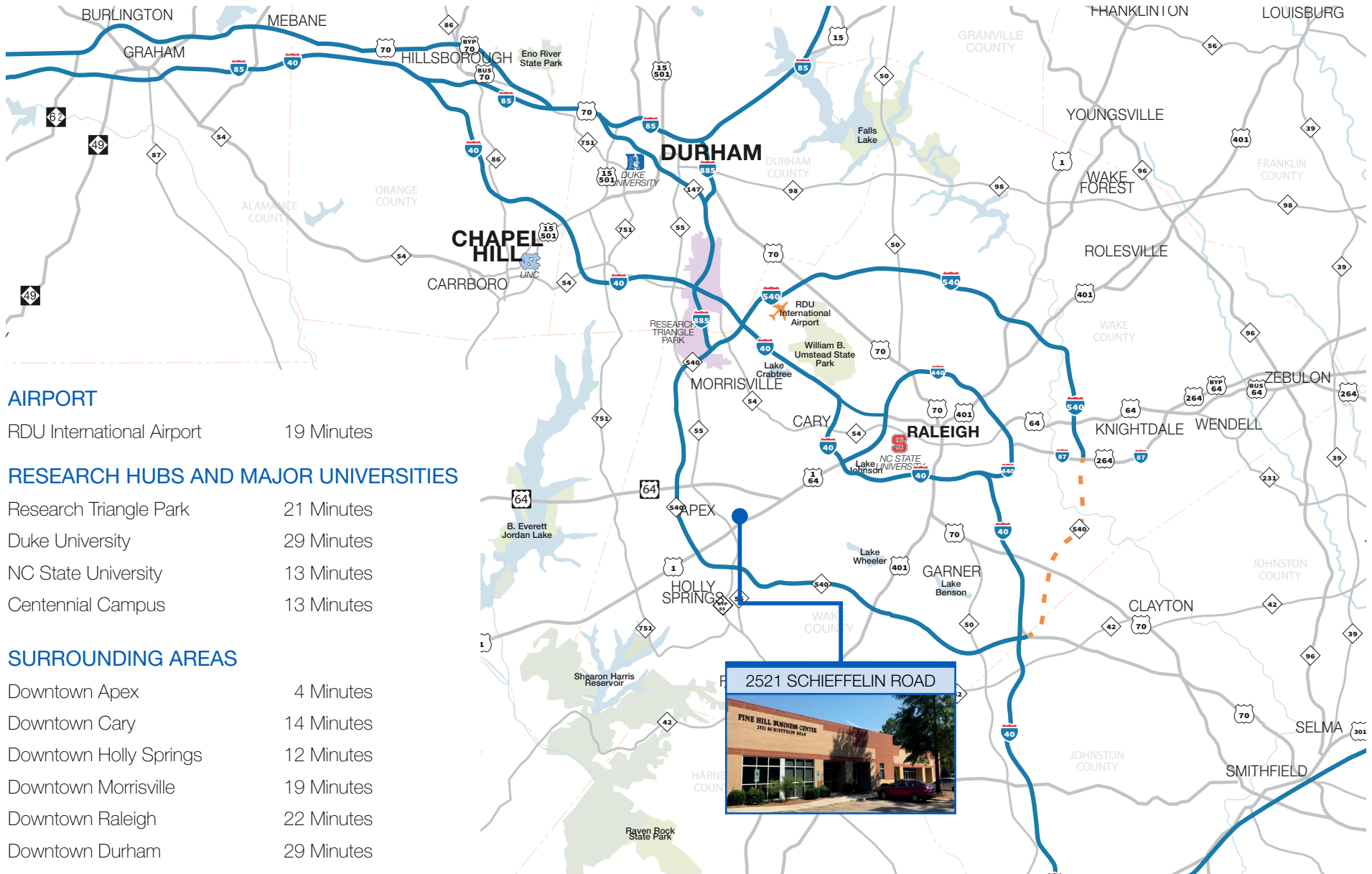

## AIRPORT

RDU International Airport 19 Minutes

## RESEARCH HUBS AND MAJOR UNIVERSITIES

Research Triangle Park 21 Minutes

Duke University 29 Minutes

NC State University 13 Minutes

Centennial Campus 13 Minutes

## SURROUNDING AREAS

Downtown Apex 4 Minutes

Downtown Cary 14 Minutes

Downtown Holly Springs 12 Minutes

Downtown Morrisville 19 Minutes

Downtown Raleigh 22 Minutes

Downtown Durham 29 Minutes

## CONTACT

GRAY CREECH | 919.880.0284 | GCREECH@TRIPROP.COM

All information provided herein is from sources deemed reliable. However, all information is subject to verification. NAI Tri Properties does not independently verify nor warrant the accuracy of the information.

**NAI TRI PROPERTIES**

# DEMOGRAPHICS - 10 Miles

## KEY FACTS

413,986

Population



2.6

Average  
Household Size

36.7

Median Age

\$131,617

Median Household  
Income

## EDUCATION

3%

No High School  
Diploma



9%

High School  
Graduate



18%

Some College



69%

Bachelor's/Grad/Pr  
of Degree

## EMPLOYMENT



81.6%

White Collar



8.8%

Blue Collar



9.5%

Services

2.9%

Unemployment  
Rate

## INCOME



\$131,617

Median Household  
Income



\$63,410

Per Capita Income



\$474,858

Median Net Worth

## BUSINESS



13,602

Total Businesses



137,719

Total Employees

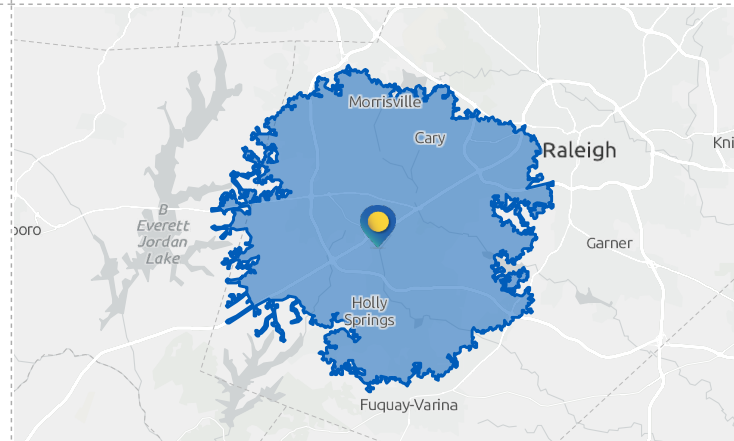

## CONTACT

GRAY CREECH | 919.880.0284 | GCREECH@TRIPROP.COM

All information provided herein is from sources deemed reliable. However, all information is subject to verification. NAI Tri Properties does not independently verify nor warrant the accuracy of the information.

**NAI**TRI PROPERTIES