

Hard to Find Flex Industrial Space Available Near Downtown Columbus

1600 DUBLIN ROAD | EAST BUILDING
COLUMBUS, OHIO

1600 EAST

NEWMARK

FLEX SPACE FOR LEASE

1600 Dublin Road East Building

COLUMBUS, OHIO

Location

Located at the corner of 5th Avenue and Dublin Road with prominent roadside visibility. Mere minutes from freeway access to I-670 and just seven minutes to Downtown Columbus.

Potential Use

The first floor space features multiple move-in ready spaces, some suites with direct outside access. Above average ceiling heights throughout as well as potential two-story warehouse space with a 26'0" ceiling height.

Year Built

Originally built in 1969, and recently renovated and updated with many modern amenities.

Neighbors

Around the corner from the 5th Avenue retail corridor and the heart of Grandview. Multiple shopping, restaurant and entertainment venues are a short drive, and possibly a walk, away. Quarry Trails Metro Park is five minutes away with several outdoor recreational options.

Other Highlights

- Building signage is available
- Regular visits from popular food truck vendors
- Ample outdoor space with patios and gazebos
- Free and abundant parking



1600 DUBLIN ROAD

East Building



25,823 SF
Space Available



\$14.50/SF
to \$16.50/SF
Asking Rate (FSG)



25,823 SF
Max Contiguous



574 Spaces
Shared Parking



48,000 SF
Total Size



Immediate
Availability



First Floor *Single Tenant*

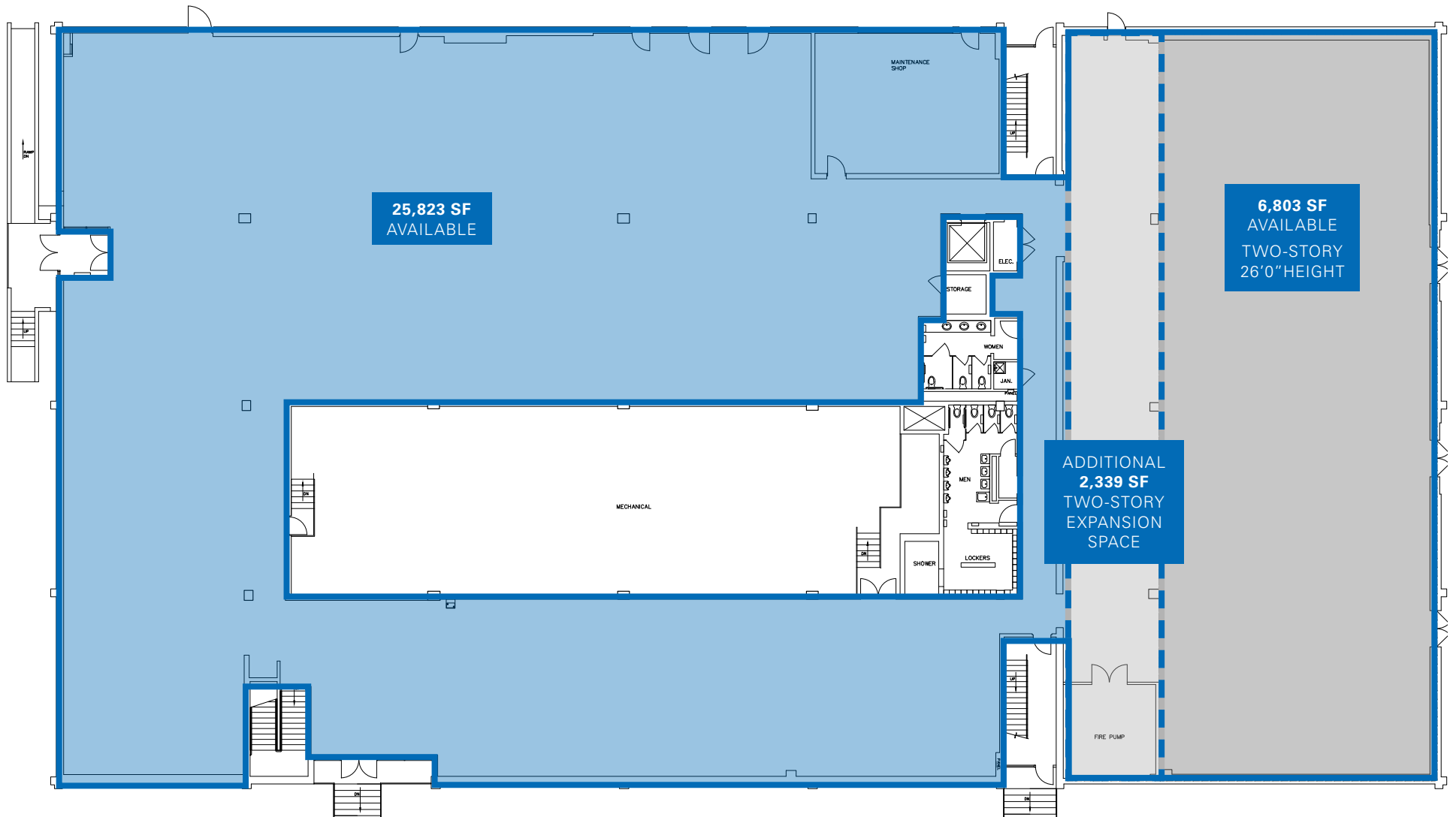

First Floor *Multi-Tenant*

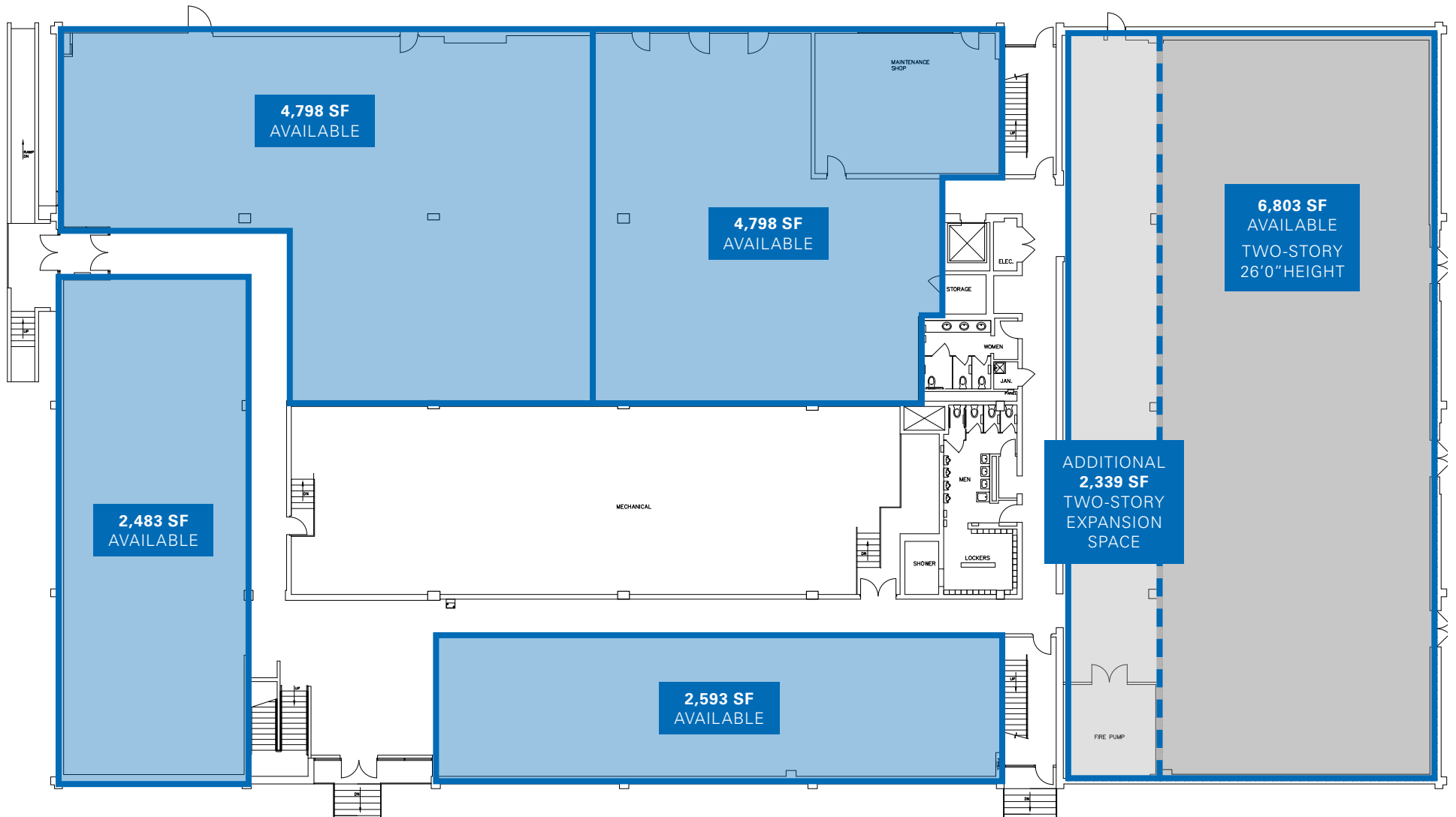

1600 DUBLIN ROAD | EAST

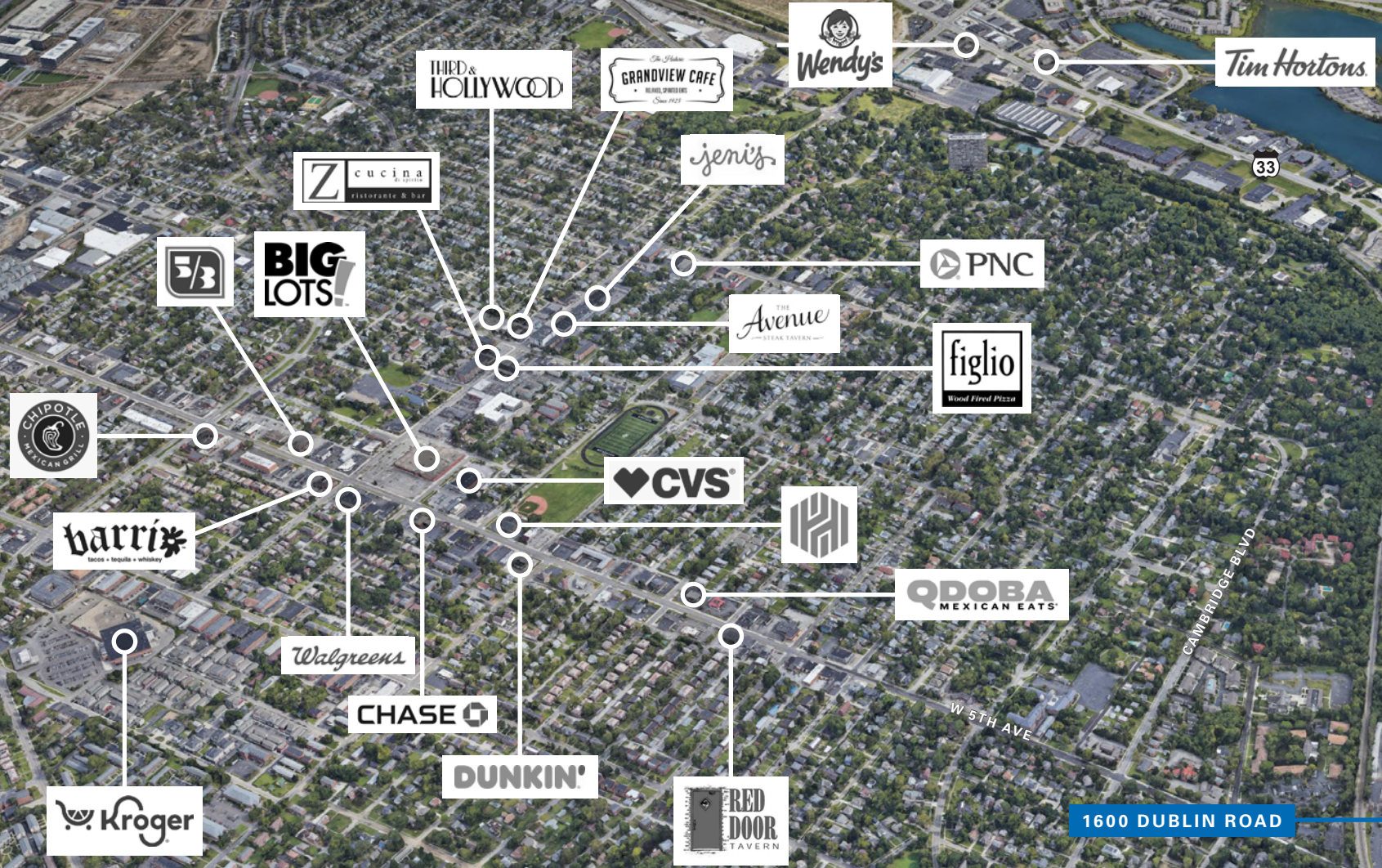

CAMBRIDGE BLVD

DUBLIN RD

W 5TH AVE

TREMONT RD



1600 DUBLIN ROAD | EAST

Area Demographics

	1 Mile	3 Miles	5 Miles
Population	13,876	123,107	351,597
Projected Population	14,547	129,109	369,119
Population Growth	1.2%	1.6%	1.4%
Median Age	36.6	33.5	34.2
College Educated	74%	53%	44%
Daytime Employees	3,741	16,124	29,417
Households	7,017	49,995	147,688
Median Income	\$103,560	\$68,231	\$60,895
Median Home Value	\$526,830	\$279,770	\$232,392
Median Year Built	1963	1958	1963



Quarry Trails Metro Park

Mere minutes from 1600 Dublin Road is the newest recreational area in Columbus, Quarry Trails Metro Park.

Sitting on 220 acres, this abandoned quarry has been transformed into an outdoor destination. The park features multiple hiking trails, observation areas, a mountain bike trail, a 25-foot waterfall and lakes.

Future plans for the park include an outdoor amphitheater, rock climbing, a sledding hill, dog park, kayaking and fishing.

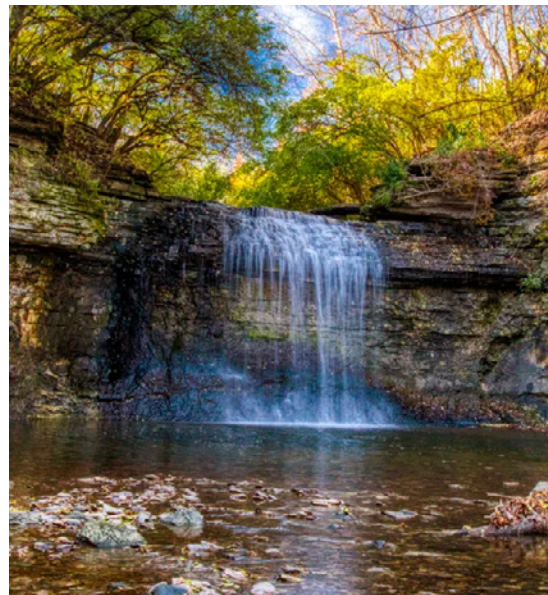

Hard to Find Flex Industrial Space Available Near Downtown Columbus

For more information, please contact:

Derek Lichtfuss

Director

t 614-883-1239

derek.lichtfuss@nmrk.com

Terry Coyne, SIOR, CCIM

Vice Chairman

t 216-218-0259

terry.coyne@nmrk.com

The information contained herein has been obtained from sources deemed reliable but has not been verified and no guarantee, warranty or representation, either express or implied, is made with respect to such information. Terms of sale or lease and availability are subject to change or withdrawal without notice.

NEWMARK