



# 3705 Clinton Parkway

## Suite 102, Lawrence, Kansas

Office Space For Lease  
2,949 SF

- Fully renovated property located just west of Kasold Drive off of Clinton Parkway
- Join the professional offices of Allworth Financial, M Cubed Technologies, Colliers Lawrence, Kansas Recreation & Park Association, and SBB Engineering
- Suite 102: 2,949 SF with a monthly rate of \$5,001.66
  - » Suite available by approximately October 1, 2023
  - » Utilities billed by Landlord monthly on a pro rata basis
  - » 100/100 Fiber available at a discounted rate
  - » Main entrance and private entrance
  - » Monument signage available at Tenant's expense
  - » Common area conference room available

### Lease rate:

**\$11.50**/SF  
per month, NNN  
(est. at \$5,001.66/month, full service, including internet)

### Contact us:

**Allison Vance Moore** SIOR  
Senior Vice President  
+1 785 865 3924  
allison.moore@colliers.com

**Colliers Lawrence**  
3705 Clinton Parkway, Suite 201  
Lawrence, KS 66047  
+1 785 865 5100

# Photo Gallery





# Floor Plan

First Floor

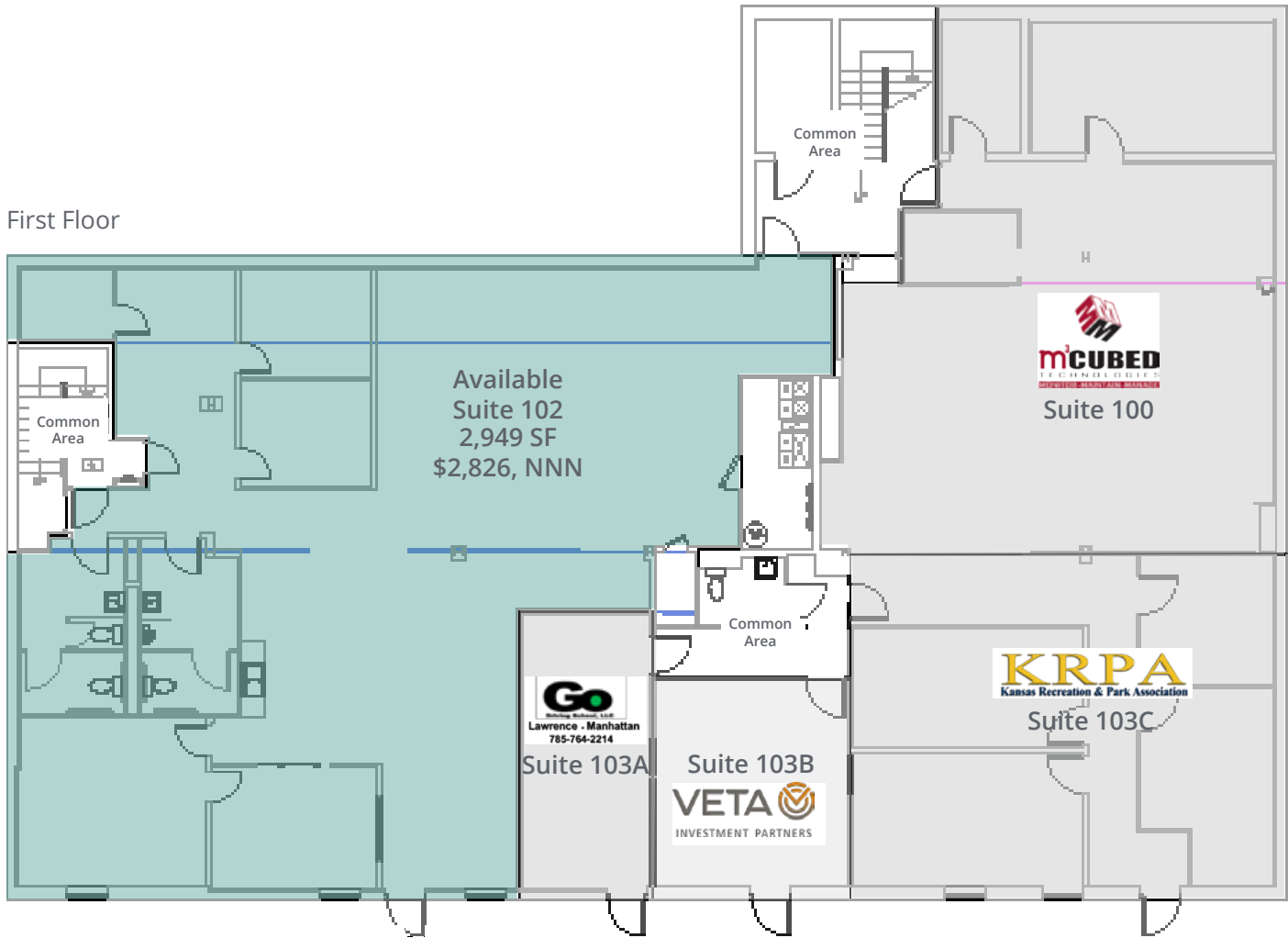

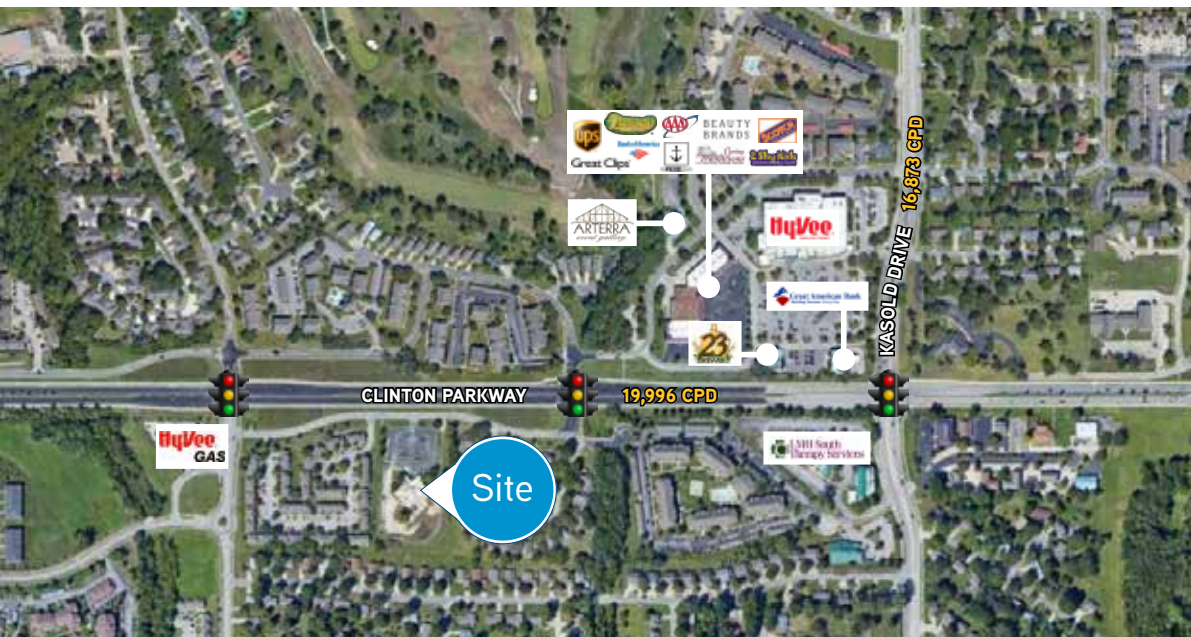

This document has been prepared by Colliers International for advertising and general information only. Colliers International makes no guarantees, representations or warranties of any kind, expressed or implied, regarding the information including, but not limited to, warranties of content, accuracy and reliability. Any interested party should undertake their own inquiries as to the accuracy of the information. Colliers International excludes unequivocally all inferred or implied terms, conditions and warranties arising out of this document and excludes all liability for loss and damages arising there from. This publication is the copyrighted property of Colliers International and/or its licensor(s). © 2024. All rights reserved.

**Contact us:**

**Allison Vance Moore** SIOR  
 Senior Vice President  
 +1 785 865 3924  
 allison.moore@colliers.com

**Colliers Lawrence**  
 3705 Clinton Parkway, Suite 201  
 Lawrence, KS 66047  
 +1 785 865 5100

