

HOUSER DRIVE LOT

10925 Houser Drive, Fredericksburg, VA 22408

Jarrell Properties

Real Estate Development



PROPERTY DETAILS

This 0.80 Acre lot is being offered as fenced in storage space for lease and/or build to suit flex/warehouse building. The property is conveniently located ½ mile from US Route 1 in the Four Mile Fork area of Spotsylvania County, Virginia.

- 0.80 Acres | TM#: 23-14-A1 & 23-14-A2
- Individual yard/lot spaces available for lease
- Owner may consider sale of lot
- Zoned I-1 (Light Industrial)
- Strong location just 1.5 Miles from I-95 (Exit 126)
- Flexible lease terms for qualified lessees

CONCEPTUAL BUILDING LAYOUT

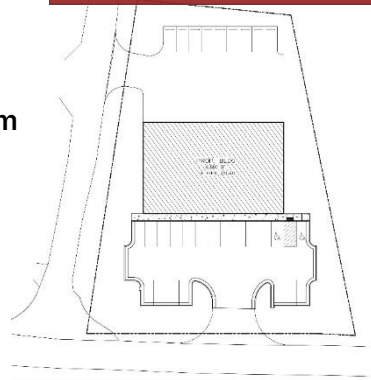

PROPOSED FENCED LOT PLAN

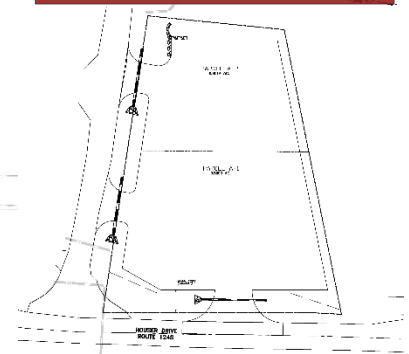

HOUSER DRIVE LOT

10925 Houser Drive, Fredericksburg, VA 22408

Jarrell Properties

Real Estate Development



CONTACT

Joshua Grady
jgrady@jarrellinc.com



Jarrell Properties, Inc.

jarrellinc.com | 540.899.3825

1300 Princess Anne St, Fredericksburg, VA 22401