

Lighted intersection location w/ drive-through! **FOR LEASE**

8000 Jumpers Hole Road, Pasadena, Maryland 21122

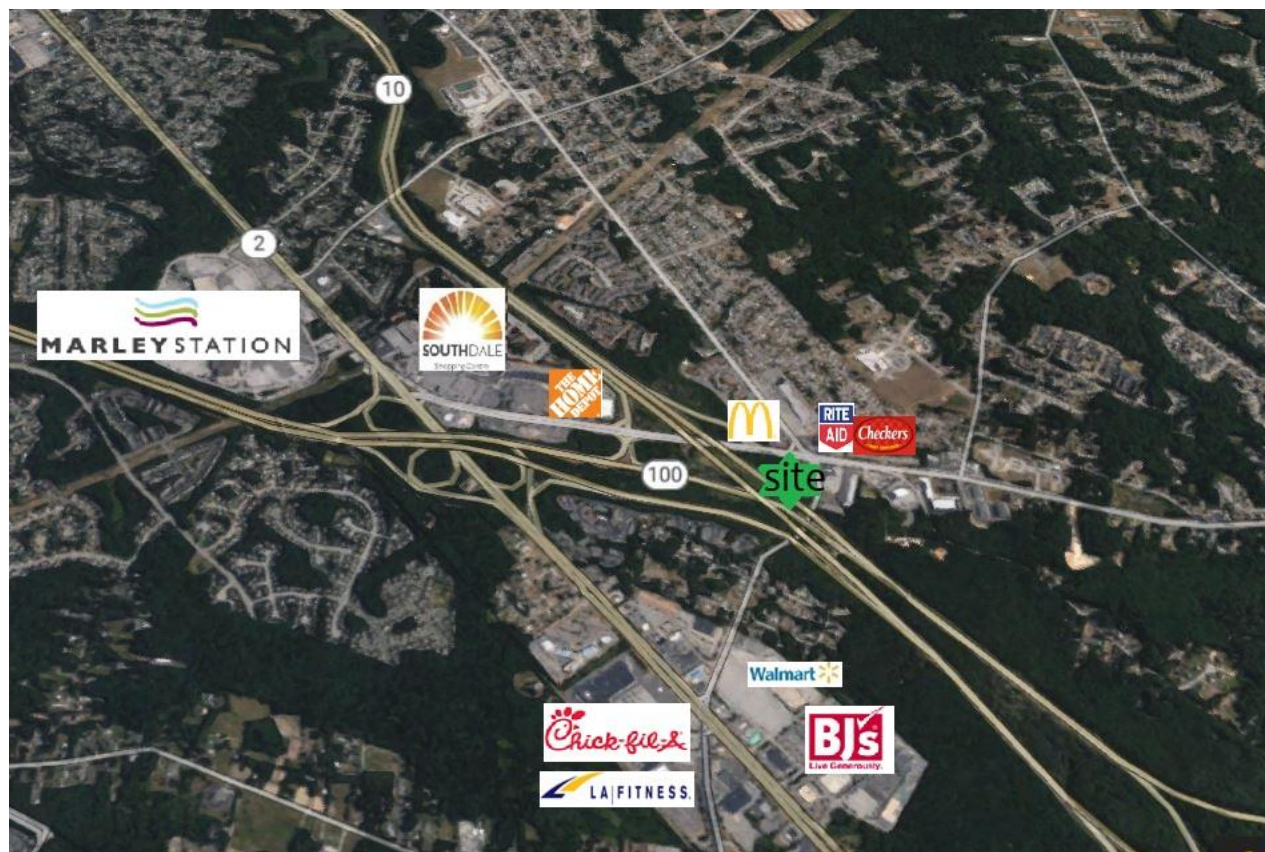

NRT



## PROPERTY OVERVIEW

This C 4-zoned property is located at the lighted intersection which four corners are McDonald's, Rite Aid, Shell and this property. Marley Station Mall, Southdale Shopping Center, Walmart and Anne Arundel Medical Center are all within a half mile or so.

Adjacent 2.03 acre pad site is also now under redeveloped.

### FOR MORE DETAILS CONTACT:

Ernestine H. "Ernie" Shineman  
[ernieshineman@gmail.com](mailto:ernieshineman@gmail.com)

## DETAILS

- Available:** 1307 +/- sf to 2002 sf +/-
- Features:** New Storefront in mid-construction with new drive-through, and major expanded parking.
- Signage:** Prominent storefront and monument signage
- Parking:** Abundant and on-site
- Comments:** Diagonally across the intersection from McDonald's, Sun Valley Shopping Center with the Movie 6 Theater, Route Aid and more.
- Across from the Route 10 ramp, and minutes from 695 and I 97.

<b>Direct</b>	410.919.2522	<b>Mobile</b>	<b>410.570.7707</b>	170 Jennifer Road, Suite 102
<b>Fax</b>	410.224.2258	<b>Main</b>	410.919.2550	Annapolis, Maryland 21401

**CBCWorldwide.com**

©2015 Coldwell Banker Real Estate LLC, dba Coldwell Banker Commercial Affiliates. All Rights Reserved. Coldwell Banker Real Estate LLC, dba Coldwell Banker Commercial Affiliates fully supports the principles of the Equal Opportunity Act. Each Office is Independently Owned and Operated. Coldwell Banker Commercial and the Coldwell Banker Commercial Logo are registered service marks owned by Coldwell Banker Real Estate LLC, dba Coldwell Banker Commercial Affiliates.

8000 JUMPERS HOLE ROAD, PASADENA, MD.



← additional parking      2 Rows of expanded parking NOW under construction

New storefront

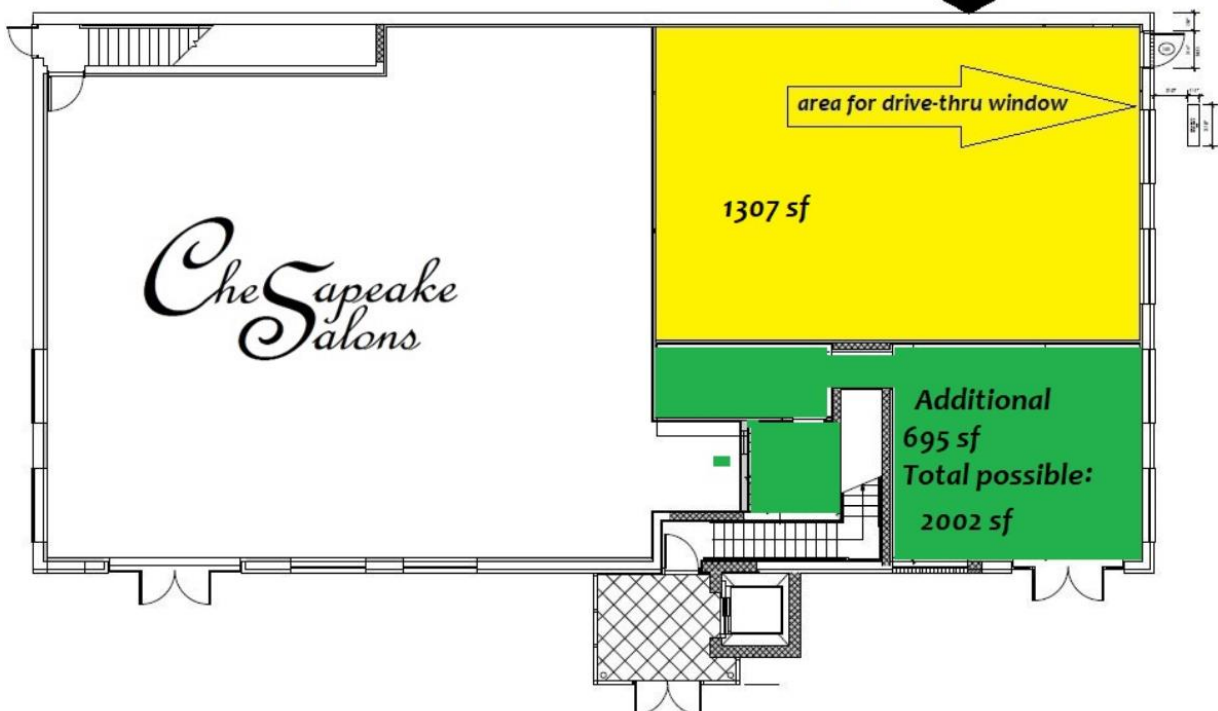

**FOR MORE DETAILS CONTACT:**

Ernestine H. "Ernie" Shineman  
[ernieshineman@gmail.com](mailto:ernieshineman@gmail.com)

Direct 410.919.2522  
Fax 410.224.2258

Mobile 410.570.7707  
Main 410.919.2550

170 Jennifer Road, Suite 102  
Annapolis, Maryland 21401

**CBCWorldwide.com**

©2015 Coldwell Banker Real Estate LLC, dba Coldwell Banker Commercial Affiliates. All Rights Reserved. Coldwell Banker Real Estate LLC, dba Coldwell Banker Commercial Affiliates fully supports the principles of the Equal Opportunity Act. Each Office is Independently Owned and Operated. Coldwell Banker Commercial and the Coldwell Banker Commercial Logo are registered service marks owned by Coldwell Banker Real Estate LLC, dba Coldwell Banker Commercial Affiliates.



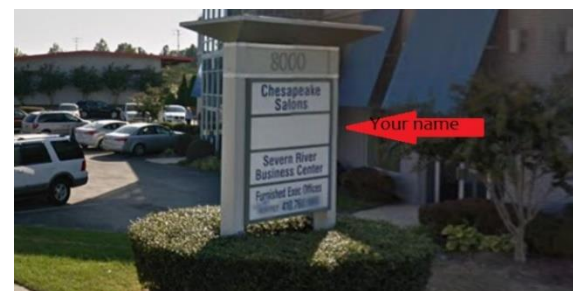
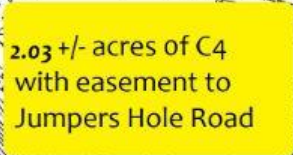

©2015 Coldwell Banker Real Estate LLC, dba Coldwell Banker Commercial Affiliates. All Rights Reserved. Coldwell Banker Real Estate LLC, dba Coldwell Banker Commercial Affiliates fully supports the principles of the Equal Opportunity Act. Each Office is Independently Owned and Operated. Coldwell Banker Commercial and the Coldwell Banker Commercial Logo are registered service marks owned by Coldwell Banker Real Estate LLC, dba Coldwell Banker Commercial Affiliates.