

*Ground Lease
or Sale*

RETAIL PAD SITE

0.7604 ACRE
(33,125 SF)

REDEVELOPMENT
OPPORTUNITY



3500 GRAPEVINE MILLS PKWY #200 | GRAPEVINE TX 76051

Property Highlights

- Located at the intersection of Grapevine Mills Blvd and Grapevine Mills Pkwy with excellent accessibility
- Available pad site with existing 2-story Drive-Thru
- Near various mixed-use projects, housing, restaurants, and retail in the center of the DFW Metroplex



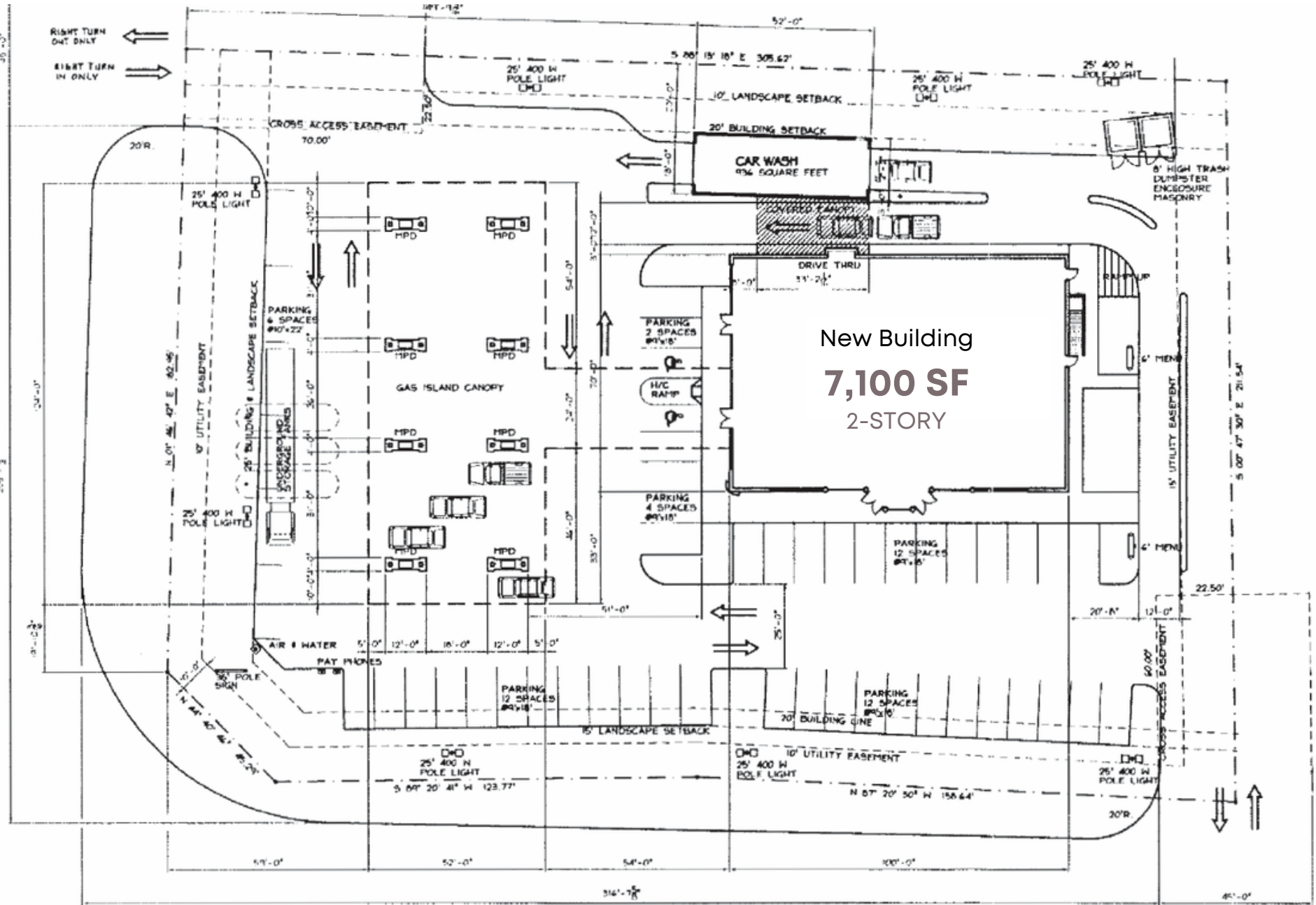

GRAPEVINE MILLS BLVD. NORTH

DEMOGRAPHICS

	1 MILE	3 MILES	5 MILES
Population	3,955	48,827	190,386
Average HH Income	\$81,676	\$119,718	\$127,090
Total Households	2,252	18,023	71,848
Daytime Employment	5,080	35,945	123,688

30 MIN DRIVE TO
DOWNTOWN DALLAS
& LOVE FIELD AIRPORT



GRAPEVINE LAKE

GRAPEVINE MILLS
A SIMON CENTER

Hilton
DFW LAKES
EXECUTIVE CONFERENCE CENTER

COWBOYS
GOLF CLUB

GAYLORD
TEXAN



10 MIN DRIVE TO
DFW AIRPORT



121
TEXAS



Contact Us

Jennie Wi Viswanath
jviswanath@hart-cre.com
214.298.5144

Allison Johnston Frizzo
afrizzo@hart-cre.com
214.499.5101