

ASKING \$3,150,000

MULTI-TENANT

FOR SALE: ±2.27 Acres

NEC OF BERMUDA RD
& LARSON LN



SITE

 VIEW PROPERTY VIDEO

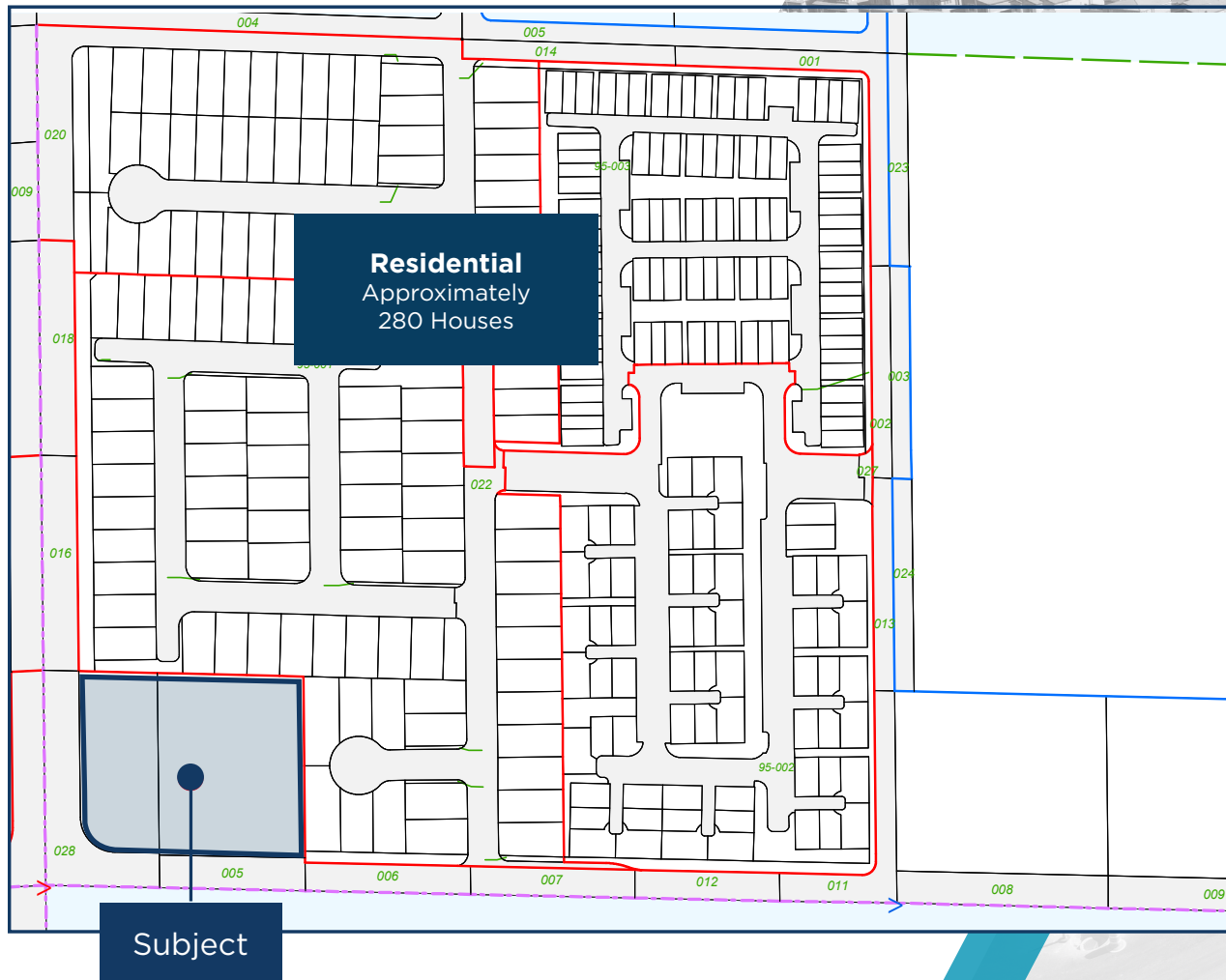

AREA DEMOGRAPHICS

SOURCE: 2021 ESRI



TOTAL POPULATION

(as of June 2022)
3 miles: 31,924
5 miles: 143,677



AVG. HOUSEHOLD INCOME

3 miles: \$122,145
5 miles: \$109,814



NUMBER OF HOUSEHOLD

3 miles: 12,088
5 miles: 56,551

PROPERTY HIGHLIGHTS

Asking Price: \$3,150,000 | APN: 191-10-401-015 & 016

1.

Rapidly growing
Inspirada Master Plan

2.

Great location for medical
suites or office park.

3.

Commercial Potential

4.

Surrounded by
residential communities

AERIAL MAP



SITE

±2.27 Acres
APN 191-10-401-015 & 016



**CUSHMAN &
WAKEFIELD**

BERMUDA ROAD

LARSON LANE

For more information, please contact:

SCOT MARKER

Director
+1 702 688 6890
scot.marker@cushwake.com
Lic #NV-S.0034109

6725 Via Austi Pkwy., Suite 275
Las Vegas, NV 89119
+1 702 796 7900

cushmanwakefield.com

©2023 Cushman & Wakefield. All rights reserved. The information contained in this communication is strictly confidential. This information has been obtained from sources believed to be reliable but has not been verified. NO WARRANTY OR REPRESENTATION, EXPRESS OR IMPLIED, IS MADE AS TO THE CONDITION OF THE PROPERTY (OR PROPERTIES) REFERENCED HEREIN OR AS TO THE ACCURACY OR COMPLETENESS OF THE INFORMATION CONTAINED HEREIN, AND SAME IS SUBMITTED SUBJECT TO ERRORS, OMISSIONS, CHANGE OF PRICE, RENTAL OR OTHER CONDITIONS, WITHDRAWAL WITHOUT NOTICE, AND TO ANY SPECIAL LISTING CONDITIONS IMPOSED BY THE PROPERTY OWNER(S). ANY PROJECTIONS, OPINIONS OR ESTIMATES ARE SUBJECT TO UNCERTAINTY AND DO NOT SIGNIFY CURRENT OR FUTURE PROPERTY PERFORMANCE.

