

Cocoa City Renovated Warehouse

203 N Fiske Blvd. Cocoa, FL 32922



Sale Price: **\$704,000**

LOCATION DETAILS

This triple frontage property offers multiple access points and a convenient location in Florida's Space Coast region. Situated 1/4 mile north of SR-520/King St and less than a mile west of US-1. Less than a 10-minute drive from I-95 and the Beachline Expressway (SR 528)/A1A intersection, providing easy access throughout the area. Surrounded by residential and wholesale commercial.

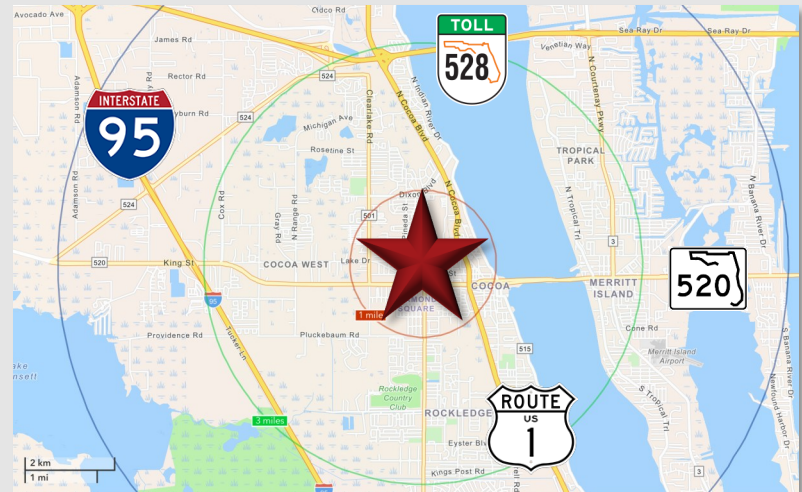

PROPERTY DETAILS

- **±4,416 SF** warehouse with office space
- **Recently renovated** with new and upgraded electric and lighting, as well as a new roof, plumbing, roll-up doors, paint, and flooring in the office space
- **4 roll-up doors** (12' x 12' grade level)
- 2 bathrooms, including 1 ADA bathroom
- **14' clear height**
- Freshly paved parking lot coming soon
- **Seller financing available**

2024 DEMOGRAPHICS	1-MILE	3-MILE	5-MILE
Population	9,331	47,316	95,019
Average HH Income	\$73,336	\$82,907	\$101,343
Median HH Income	\$51,656	\$59,256	\$72,917

CONTACT FOR MORE INFORMATION

Rebecca Craddock
(407) 227-1197
RebeccaR@palkiper.com

Marie Shorey, CCIM
(407) 383-8142
Marie@palkiper.com

Cocoa City Renovated Warehouse

203 N Fiske Blvd. Cocoa, FL 32922



New Paint, Electrical, & Lighting



Parking Improvements Underway



Office with A/C



4 Brand New Roll-up Doors



ADA Compliant Bathroom

CONTACT FOR MORE INFORMATION

Rebecca Craddock

(407) 227-1197

RebeccaR@palkiper.com

Marie Shorey, CCIM

(407) 383-8142

Marie@palkiper.com

Cocoa City Renovated Warehouse

203 N Fiske Blvd. Cocoa, FL 32922

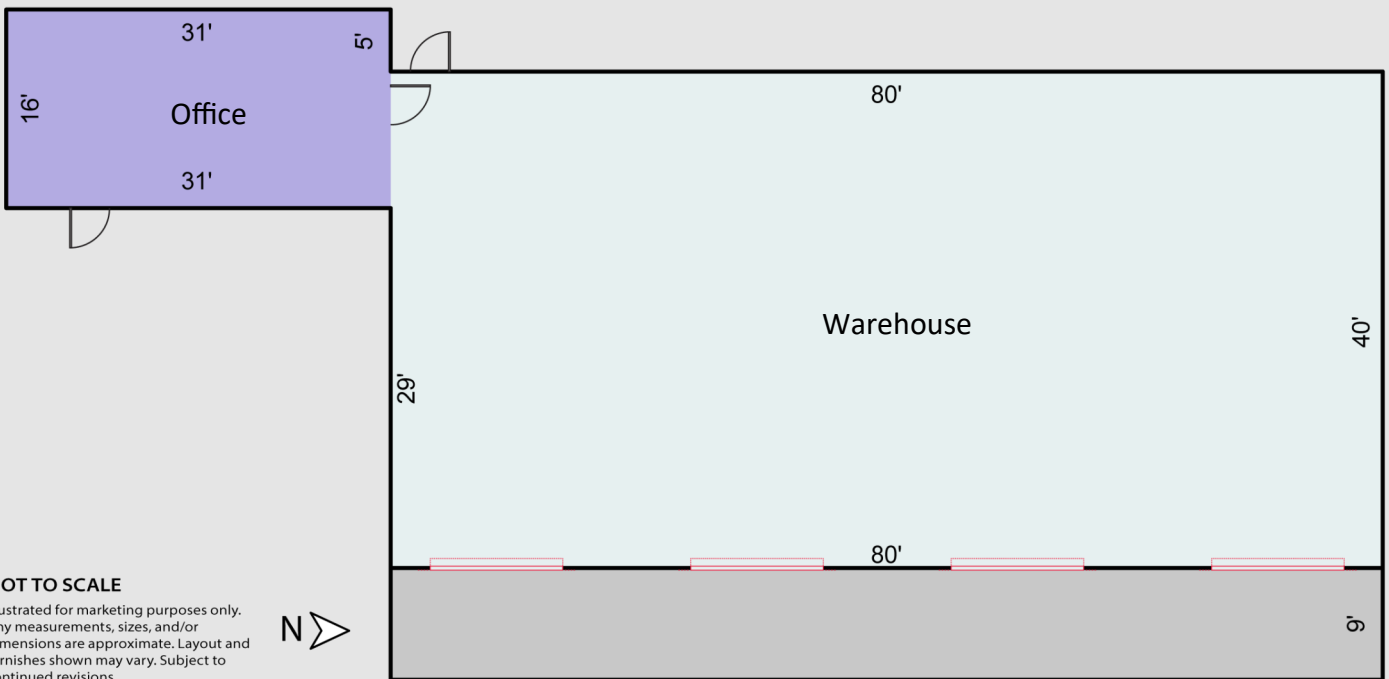

NOT TO SCALE

Illustrated for marketing purposes only. Any measurements, sizes, and/or dimensions are approximate. Layout and furnishes shown may vary. Subject to continued revisions.

CONTACT FOR MORE INFORMATION

Rebecca Craddock
(407) 227-1197
RebeccaR@palkiper.com

Marie Shorey, CCIM
(407) 383-8142
Marie@palkiper.com