

# For Lease 1905 Airport Industrial Park Dr

## 2000 SF Industrial Space

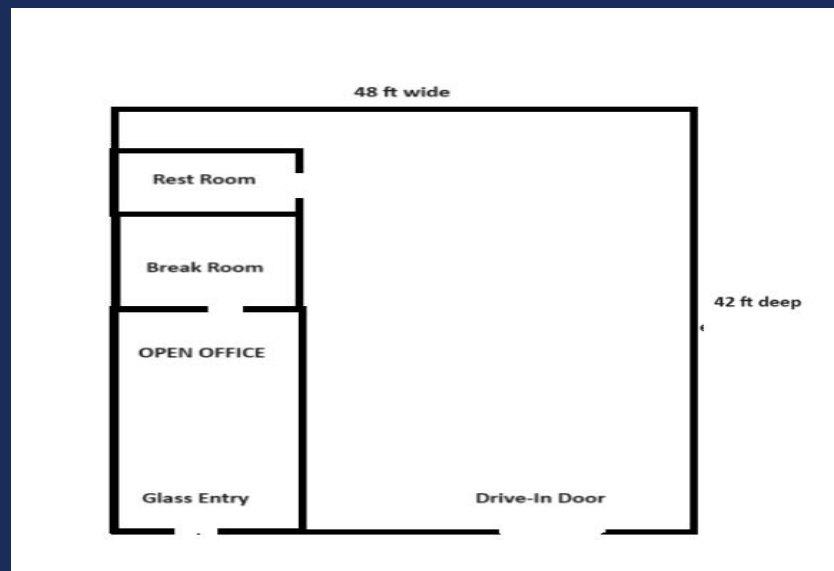

- 2000 SF Total with 600SF open office
- 2 tenant building
- 14ft ceiling height
- 1-drive-in grade- level door
- Storage mezzanine
- Store front entrance



Adam Alterman

404-797-6033

aalterman@commercialreadvisors.com

Commercial Realty Advisors LLC

www.commercialreadvisors.com

# For Lease 1905 Airport Industrial Park Dr

2000 SF Industrial Space

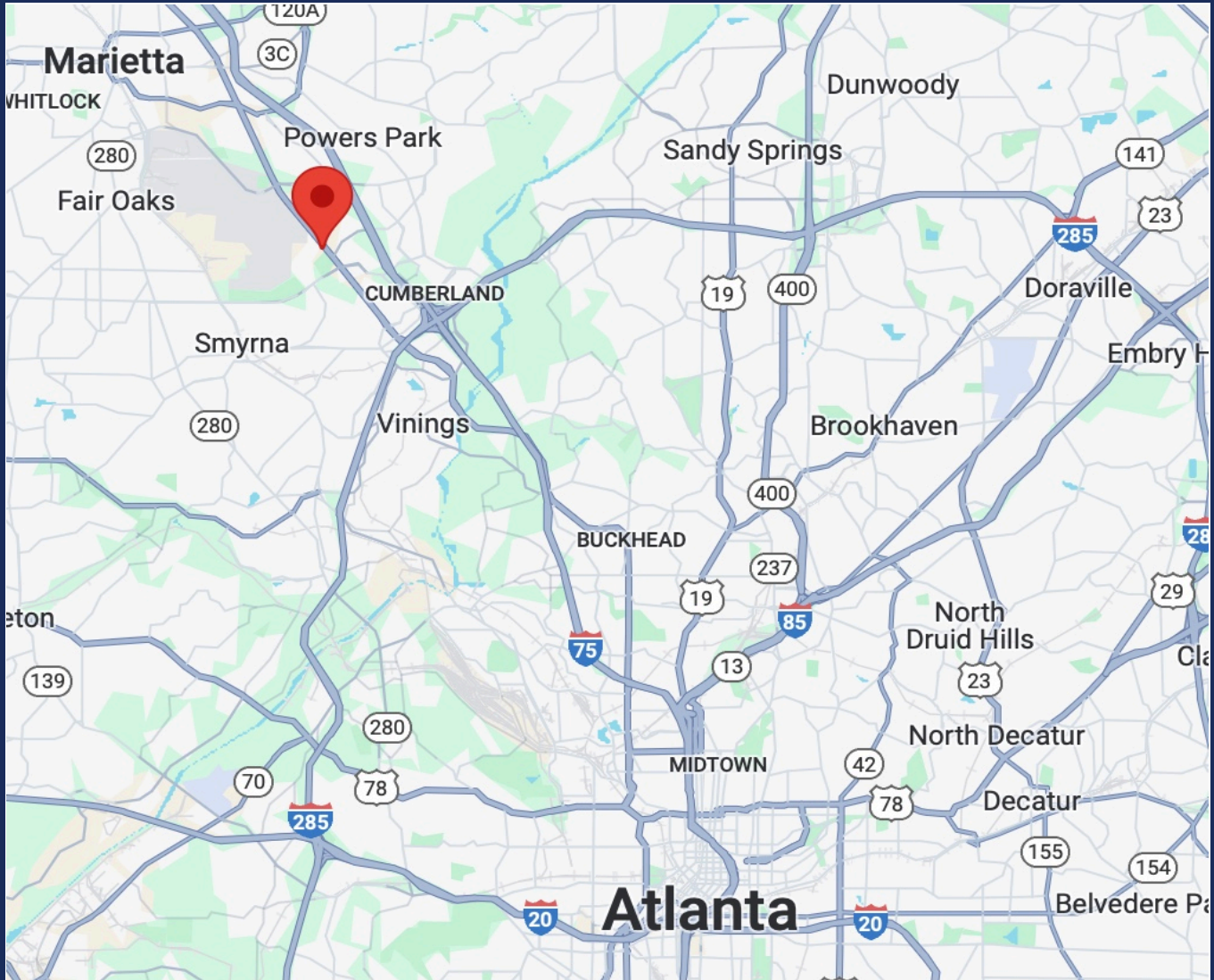

Adam Alterman

404-797-6033

[aalterman@commercialreadvisors.com](mailto:aalterman@commercialreadvisors.com)

Commercial Realty Advisors LLC

[www.commercialreadvisors.com](http://www.commercialreadvisors.com)

