

FOR LEASE

WESTPARK BUSINESS CENTER
8752 Westpark Houston, TX 77063



WESTPARK BUSINESS CENTER
8752 Westpark Houston, TX 77063

Property Size:

- 9,750 SF Total (Divisible)
- 4,865 SF Office (Divisible)

Property Features:

- Tiltwall Construction
- (3) Dock High Loading Doors
- 16' Clear Height
- 100% Fire Sprinklered
- Security Lighting

Property Location:

- Westpark Drive near Fondren. Great access to Westpark Tollway, 59 and 610 Loop



Leased by:

Ed Bane, SIOR
Jon Michael

(713) 589-3353

The information contained here in has been given to us by the owner of the property or other sources we deem reliable, we have no reason to doubt the accuracy, but we do not guarantee it. All information should be verified prior to purchase or lease.

FOR LEASE

WYNNWOOD INDUSTRIAL PARK
8752 Westpark Houston, TX 77063

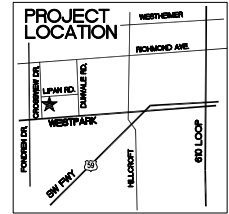
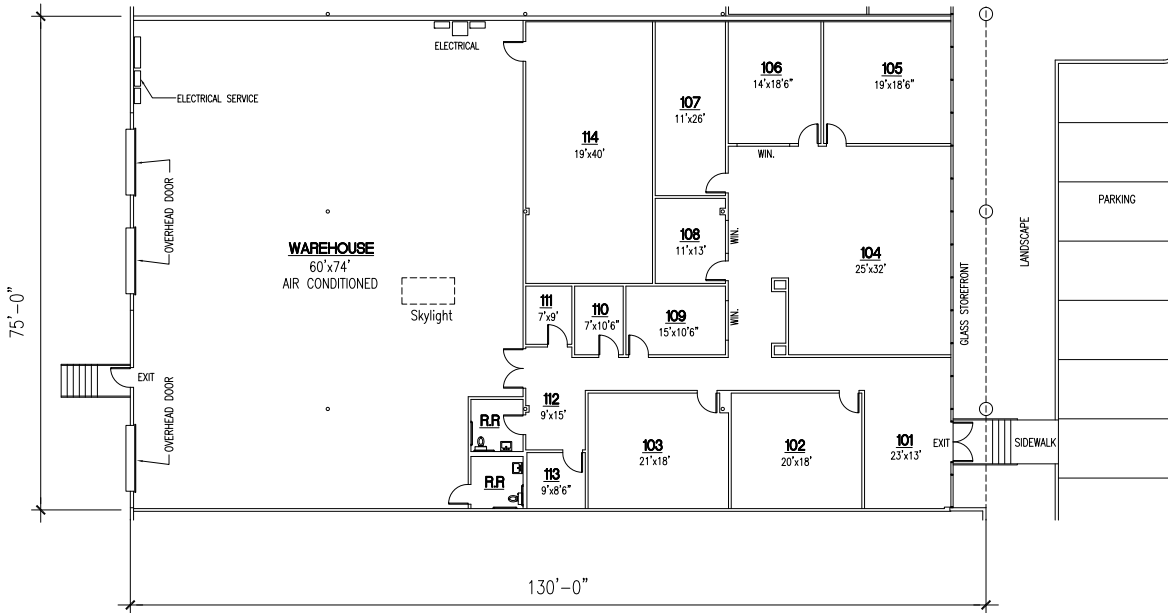

LOCATION MAP

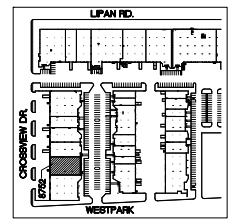

SITE PLAN

WESTPARK BUSINESS CENTER
8752 WESTPARK
HOUSTON, TEXAS

BUILDING SUMMARY

OFFICE	4,866 SQ. FT.
WAREHOUSE	4,866 SQ. FT.
TOTAL	9,730 SQ. FT.

BUILDING FEATURES

- 3 DOCK HIGH REAR LOADING DOORS
- 18' CLEAR HEIGHT
- SECURITY LIGHTING
- EASY ACCESS WESTPARK TOLL WAY
- 100% FIRE SPRINKLERED
- ALL CONCRETE PAVING

SUITE 8752 FLOOR PLAN



Jon L. Michael
Edward Bane
Phone (713) 589-3353
www.bridgecommercialre.com

6575 West Loop South,
Suite 250
Dallas, Texas 77041



Leased by:

Ed Bane, SIOR
Jon Michael

(713) 589-3353