

TCP
TOUCHSTONE
COMMERCIAL PARTNERS

CITIVISION
COMMERCIAL REAL ESTATE

For Lease // 2200 Jerrold Avenue, San Francisco, CA
INDUSTRIAL / WAREHOUSE SPACES



2200 JERROLD AVENUE

PROPERTY SUMMARY

ADDRESS

2200 Jerrold Avenue
San Francisco, CA 94124

AVAILABLE SPACE

Unit K: +/- 6,563 Square Feet
Unit R & Unit S: +/- 6,400 Square Feet (+/- 1,200 SF Office)
Unit O & Unit P: +/- 5,124 Square Feet
Unit X: +/- 4,050 Square Feet

NET RENTAL RATE

Negotiable

AVAILABLE

Immediately

BUILDING ATTRIBUTES

- + Class A - Clear Span Warehouse Space
- + One (1) Grade Level Drive-In Roll Up Door per Unit
- + Small Office Area w/ Restrooms
- + Professionally Managed Property
- + Secured/Gated Parking and Fenced Lot



Unit K Interior



Unit X Interior

2200 JERROLD
AVENUE



2200 JERROLD AVENUE

FLOOR PLANS

Unit K: +/- 6,563 Square Feet

Unit R & Unit S: +/- 6,400 Square Feet

Unit O & Unit P: +/- 5,124 Square Feet

Unit X: +/- 4,050 Square Feet

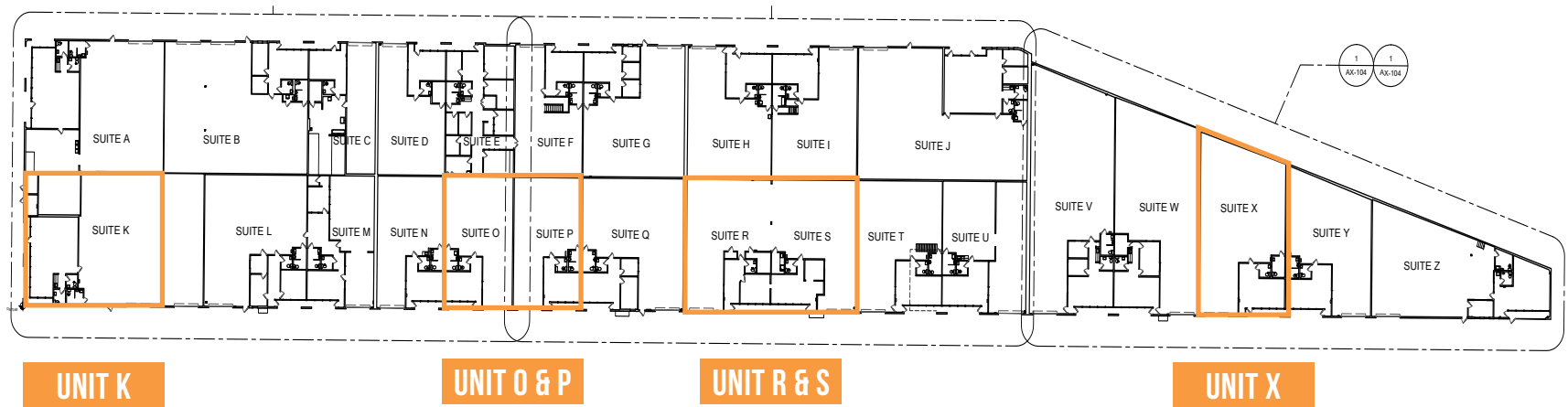

2200 JERROLD AVENUE

NEARBY AMENITIES

- 1.....Kid Abelha Sanduiche
- 2..... United States Postal Service
- 3.....FedEx Ship Center
- 4..... Good Eggs
- 5.....Burger King
- 6..... The Old Clam House
- 7..... Bayshore Taqueria
- 8..... Domino's Pizza
- 9..... McDonald's
- 10..... Grand Seven Liquor & Deli
- 11..... The Chairman
- 12..... Feve Artisan Chocolatier
- 13..... BevMo!
- 14..... Silver Crest Donut Shop
- 15.....Jack in the Box
- 16.....Sequoia Sake
- 17..... Cellars 33
- 18..... Starbucks
- 19..... Huli Huli Hawaiian Grill
- 20..... All Good Pizza
- 21..... Barebottle Brewing Company



05 MIN to 101 On-Ramp
05 MIN to 280 On-Ramp

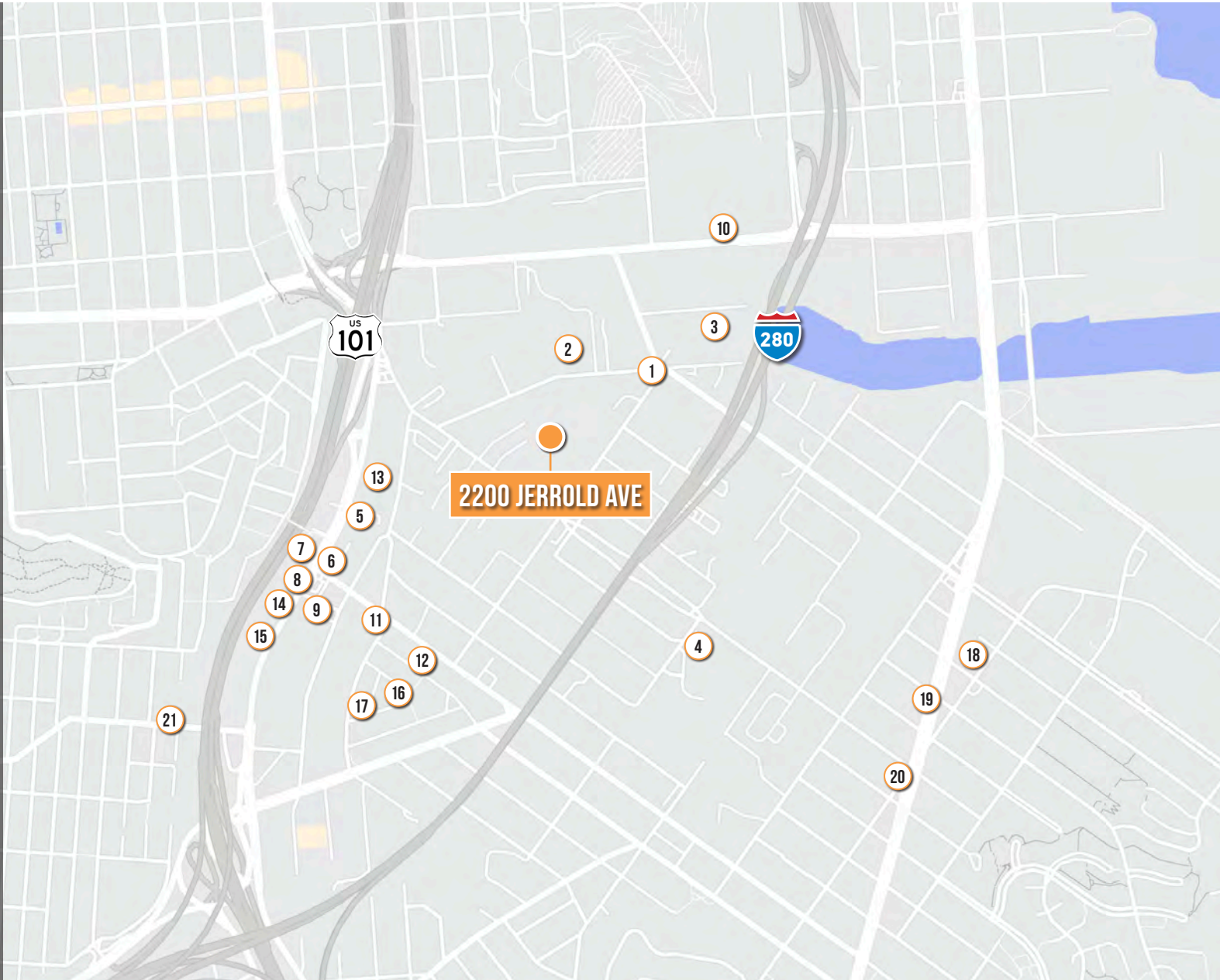

TCP

TOUCHSTONE COMMERCIAL PARTNERS

Corp. Lic. 01112906
www.tcp.com

ZACH HAUPERT

D 415.539.1121 C 415.812.1219
zhaupert@tcp.com DRE # 01822907

MICHAEL SANBERG

D 415.539.1103 C 415.697.6088
msanberg@tcp.com DRE # 01930041

TREVOR GUDIM

D 415.539.1122 C 858.922.2632
trevor@tcp.com DRE # 01979980



CITIVISION

COMMERCIAL REAL ESTATE

ED MAIELLO

D 415.543.2002 C 415.407.3523
ed@citivisioncommercial.com DRE # 00974529

The information presented has been secured from sources we believe to be reliable but we make no representations or warranties, expressed or implied, as to the accuracy of the information. Lessee must verify the information and bears all risk for any inaccuracies.

2200 JERROLD AVENUE

