



Prosper, TX | Retail Center

1200 S Coit Rd, Prosper, TX 75078



Macro Aerial

1200 S Coit Rd, Prosper, TX 75078



Summary

- Lease Rate: Call for Pricing
- Building Size: 11,737 SF
- Available For Lease: \pm 1,700 - 5,503 SF
- Co-Tenants: Prime Dental, The Little Gym

Property Overview

- End-cap and Inline space available
- Highly desirable positioning along Hwy 380 (42,000+ VPD) and Coit Rd (10,000+ VPD)
- Robust demographic profile - 15% annual growth projected over the next 5 year in all radii

Demographics

2025 Population

9,243	71,596	162,057
1 Mile	3 Mile	5 Mile

2029 Projected Growth ('25-'29)

16.88%	15.48%	15.07%
1 Mile	3 Mile	5 Mile

Avg. Household Income

\$138,202	\$168,424	\$169,474
1 Mile	3 Mile	5 Mile

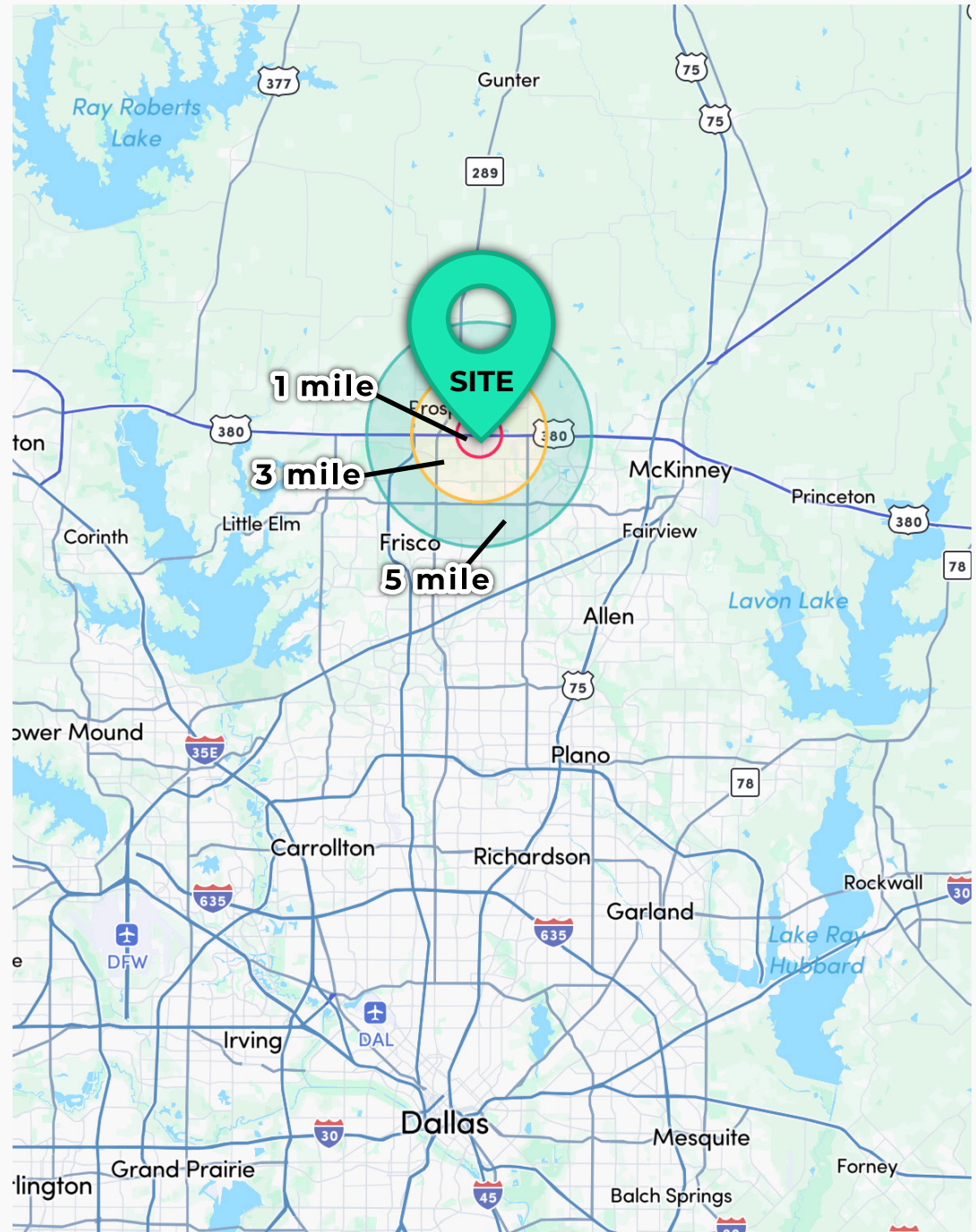

1200 S Coit Rd, Prosper, TX 75078

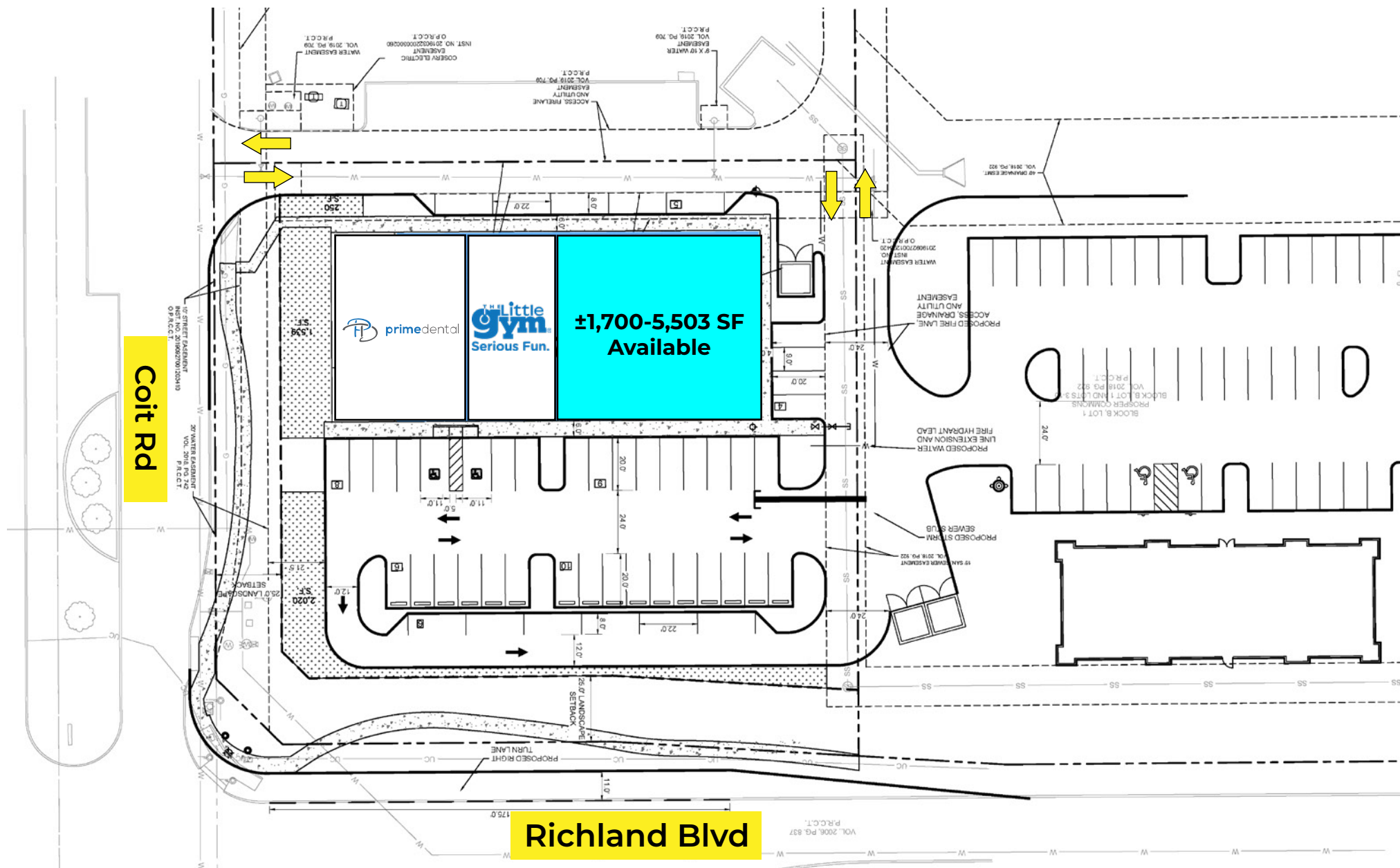

Floor Plan

1200 S Coit Rd, Prosper, TX 75078

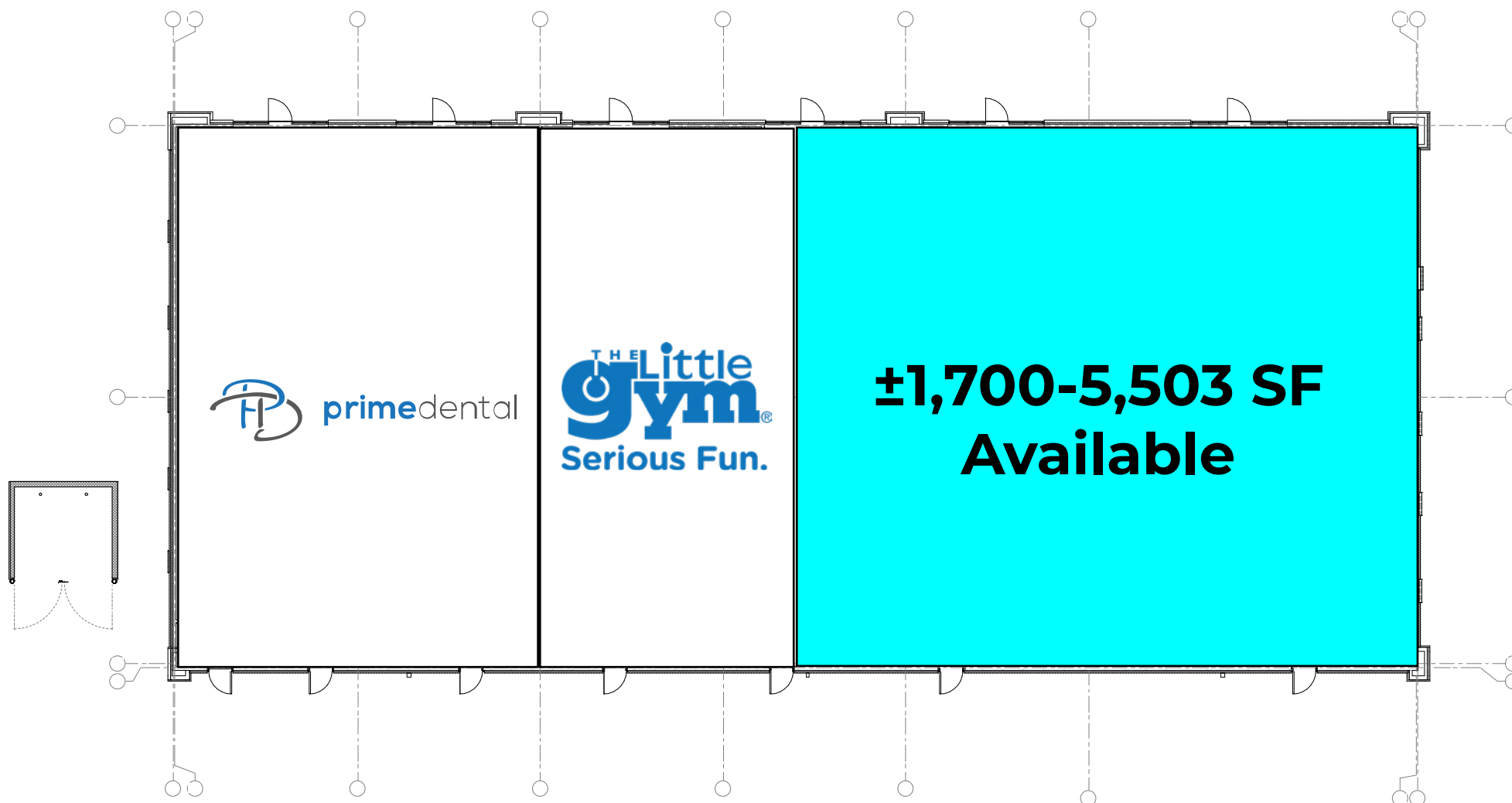



Michael Feighny
Director, Retail Leasing - Texas

O: +1 (405) 300-4003
P: +1 (405) 361-9778
E: michaelfeighny@ashtongray.com



Jack Geurkink
Director, Healthcare Leasing

O: +1 (405) 300-4003
P: +1 (405) 249-0890
E: jackgeurkink@ashtongray.com

