

For Lease

**97 Foster Road, Suites 1-2
Moorestown, NJ 08057**



HEAVY POWER



**The
Flynn
Company**

DAVID M. RICCI
DRICCI@FLYNNCO.COM
215-561-6565 x 154

BRANDO CASALICCHIO
BCASALICCHIO@FLYNNCO.COM
215-561-6565 x 153

No warranty or representation, expressed or implied, is made as to the accuracy of the information contained herein, and same is submitted subject to error and omissions.

For Lease

97 Foster Road, Suites 1-2 Moorestown, NJ 08057



PROPERTY HIGHLIGHTS



Total SF: 10,891 SF



Warehouse SF: 7,423 SF
Office SF: 3,468 SF



Loading: 2 Tailgate Doors



Clear Height: 14' - 17'



Power: 600 amps, 480v, 3 phase



LOCATION

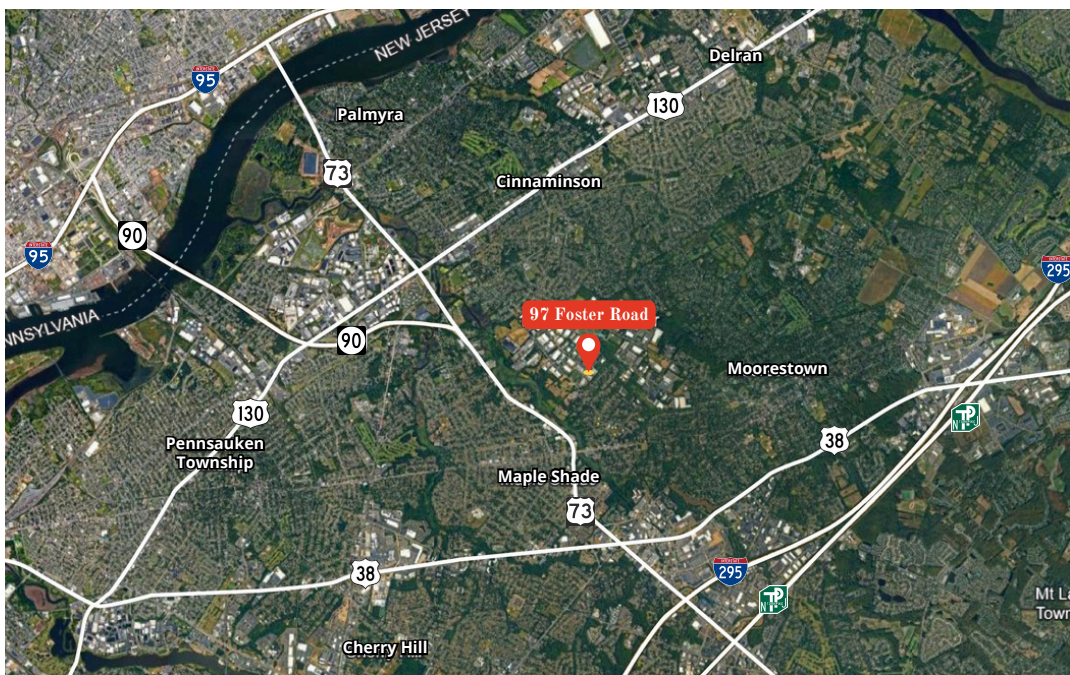

- Situated in Moorestown West Corporate Center, a 133 acre, 5,000,000 SF professional campus with over 100 buildings
- Located off North Church Street in Moorestown, NJ with easy access to I-295, the NJ Turnpike, the Betsy Ross and Tacony Bridge and Routes 38, 73, 90 and 130
- Minutes to Center City Philadelphia and its airports

No warranty or representation, expressed or implied, is made as to the accuracy of the information contained herein, and same is submitted subject to error and omissions.

For Lease

**97 Foster Road, Suites 1-2
Moorestown, NJ 08057**



FLOOR PLAN

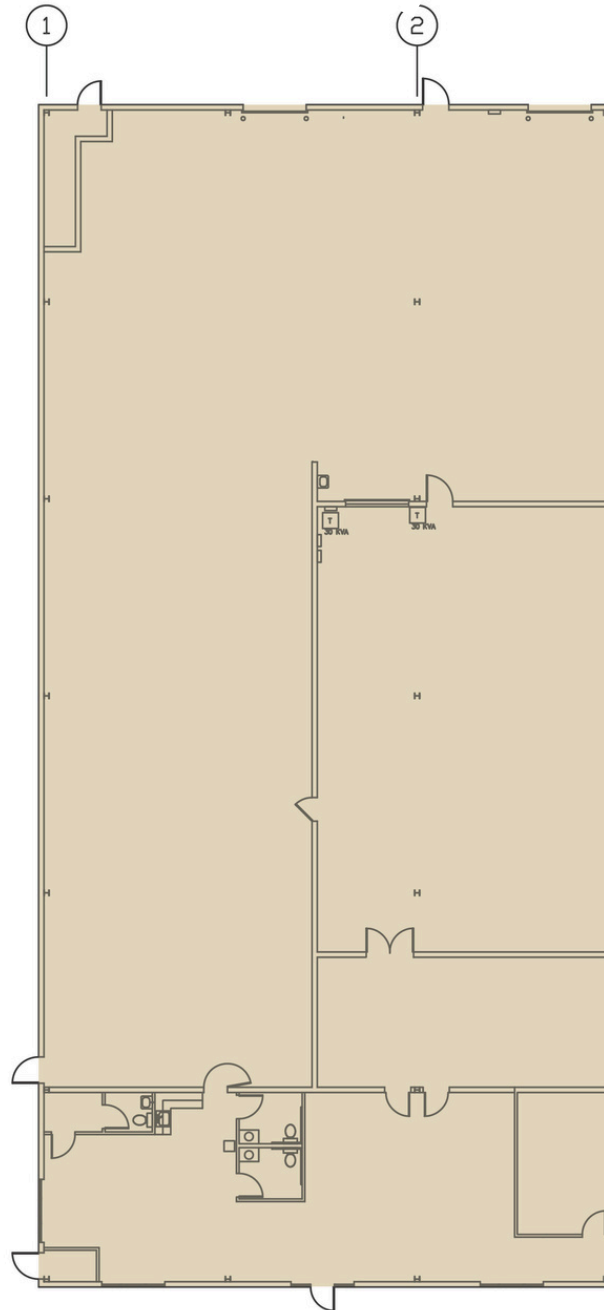

1 EXISTING OFFICE PLAN
EC-1 SCALE: 1/16" = 1'-0"

No warranty or representation, expressed or implied, is made as to the accuracy of the information contained herein, and same is submitted subject to error and omissions.