

CONSTRUCTION SEQUENCE

1. INSTALL STABILIZED CONSTRUCTION ENTRANCE
2. INSTALL SILT FENCES (STAKED EVERY 100' MAX) AND SYNTHETIC BALES AS REQUIRED
3. STOCKPILE TOPSOIL IF REQUIRED
4. PERFORM PRELIMINARY GRADING ON SITE AS REQUIRED
5. STABILIZE DENUDEED AREAS AND STOCKPILES AS SOON AS PRACTICAL
6. INSTALL STORM SEWER
7. CONSTRUCT BUILDING AND OTHER UNDERGROUND UTILITIES
8. INSTALL PAVEMENT AND CURBING
9. INSTALL LANDSCAPE AND SOIL
10. REMOVE ACCUMULATED SEDIMENT FROM BASINS
11. WHEN ALL CONSTRUCTION ACTIVITY IS COMPLETE AND THE SITE IS STABILIZED, REMOVE ANY TEMPORARY BMP MEASURES.

SOIL TYPES

SEE SOILS REPORT

DEWATERING METHODS AND LOCATIONS

DEWATERING SHALL BE UTILIZED ONLY IF NECESSARY BY MEANS OF WELL POINT SYSTEM. DISCHARGE FROM THE WELL POINT SYSTEM SHALL BE DIRECTED TO THE PROPOSED DRAINAGE STRUCTURES. THE CONTRACTOR SHALL OBTAIN ALL NECESSARY PERMITS FOR WELL POINT SYSTEM PRIOR TO CONSTRUCTION.

EROSION TEMPORARY MEASURES (BMP'S)

1. SYNTHETIC BALE BARRIERS SHALL BE USED TO PROTECT PROPOSED INLETS PER DETAILS
2. FILTER FABRIC BARRIERS SHALL BE USED AT THE PERIMETER/LIMITS OF PROPOSED CONSTRUCTION TO PREVENT SEDIMENT FROM LEAVING THE PROJECT BOUNDARIES OR DISCHARGING INTO OFF-SITE DRAINAGE FACILITIES
3. STOCKPILING MATERIAL: NO EXCAVATED MATERIAL SHALL BE STOCKPILED IN SUCH A MANNER AS TO DIRECT RUNOFF DIRECTLY OFF THE PROJECT SITE INTO ANY ADJACENT WATER BODY OR STORM WATER COLLECTION FACILITY
4. INLET PROTECTION: INLETS AND CATCH BASINS WHICH DISCHARGE DIRECTLY OFF-SITE SHALL BE PROTECTED FROM SEDIMENT-LADEN STORM RUNOFF UNTIL THE COMPLETION OF ALL CONSTRUCTION OPERATIONS THAT MAY CONTRIBUTE SEDIMENT TO THE INLET
 TEMPORARY SEEDING AND MULCHING: AREAS OPENED BY CONSTRUCTION OPERATIONS AND THAT AREA NOT ANTICIPATED TO BE RE-EXCAVATED OR DRESSED AND RECEIVE FINAL GRASSING TREATMENT WITHIN 30 DAYS SHALL BE SEEDDED WITH A QUICK GROWING GRASS SPECIES WHICH WILL PROVIDE AN EARLY COVER DURING THE SEASON IN WHICH IT IS PLANTED AND WILL NOT LATER COMPETE WITH THE PERMANENT GRASSING SLOPES STEEPER THAN 6:1 THAT FALL WITHIN THE CATEGORY ESTABLISHED IN PARAGRAPH NUMBER 2 ABOVE SHALL ADDITIONALLY RECEIVE MULCHING OF APPROXIMATELY 2 INCHES LOOSE MEASURE OF MULCH MATERIAL CUT INTO THE SOIL OF SEEDED AREA ADEQUATE TO PREVENT MOVEMENT OF SEED AND MULCH.
5. MAINTENANCE: ALL FEATURES OF THE PROJECT DESIGNED AND CONSTRUCTED TO PREVENT EROSION AND SEDIMENT CONTROL SHALL BE MAINTAINED DURING THE LIFE OF THE CONSTRUCTION SO AS TO FUNCTION AS THEY WERE ORIGINALLY DESIGNED AND CONSTRUCTED.

TEMPORARY CONSTRUCTION ENTRANCE

INSERT #1

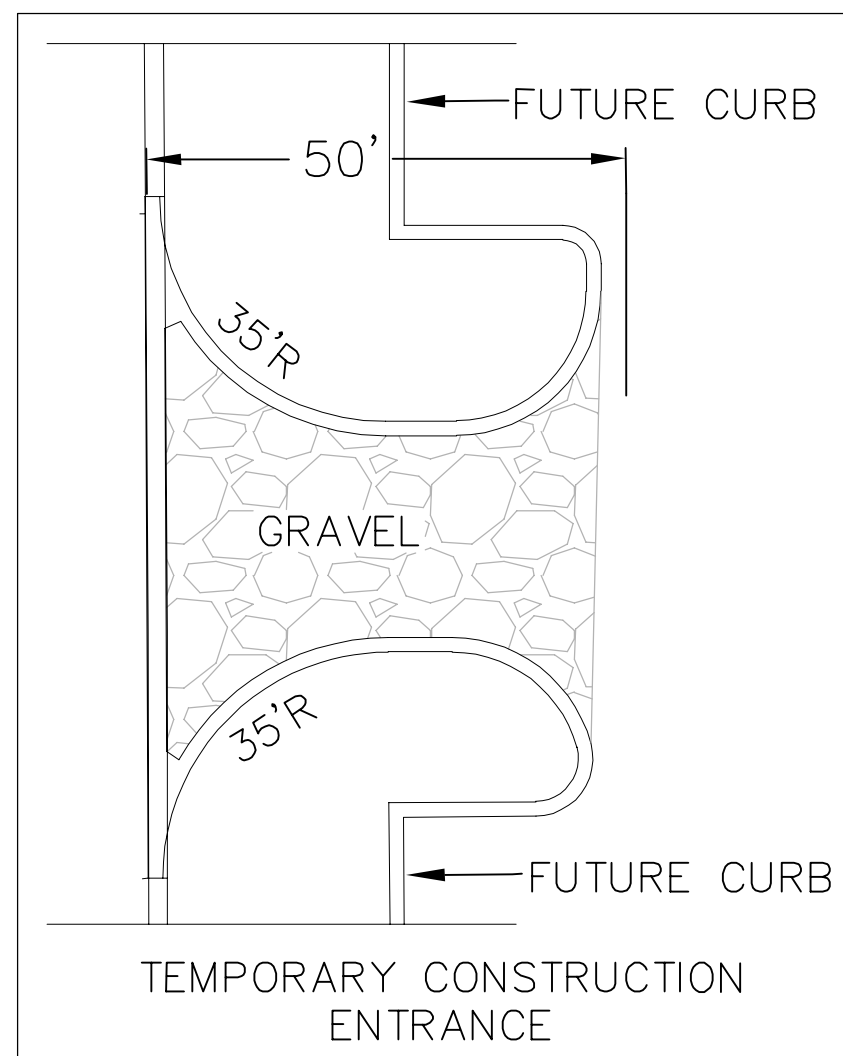

INSERT #1

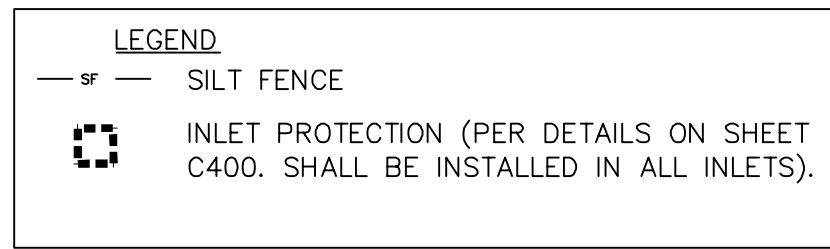

SEE SHEET C9 FOR EROSION CONTROL DETAILS.

REVISIONS			
NO.	DATE	COMMENT	APPROVED BY

PREPARED FOR:
 ATLAS WAREHOUSE SOLUTIONS
 EDUARDO GOMES, CEO.
 MOBILE: 1-786-832-0005
 EMAIL: EDUARDO@EXSTONTRADING.COM
 9112 YONATH ST. ORLANDO, FL. 32827

ATLAS WAREHOUSE
 EROSION CONTROL PLAN

CITY OF ORLANDO

FLORIDA

DATE:	08/31/2023
DESIGNED:	PLM/
DRAWN:	AT
CHECKED:	PLM

C-4

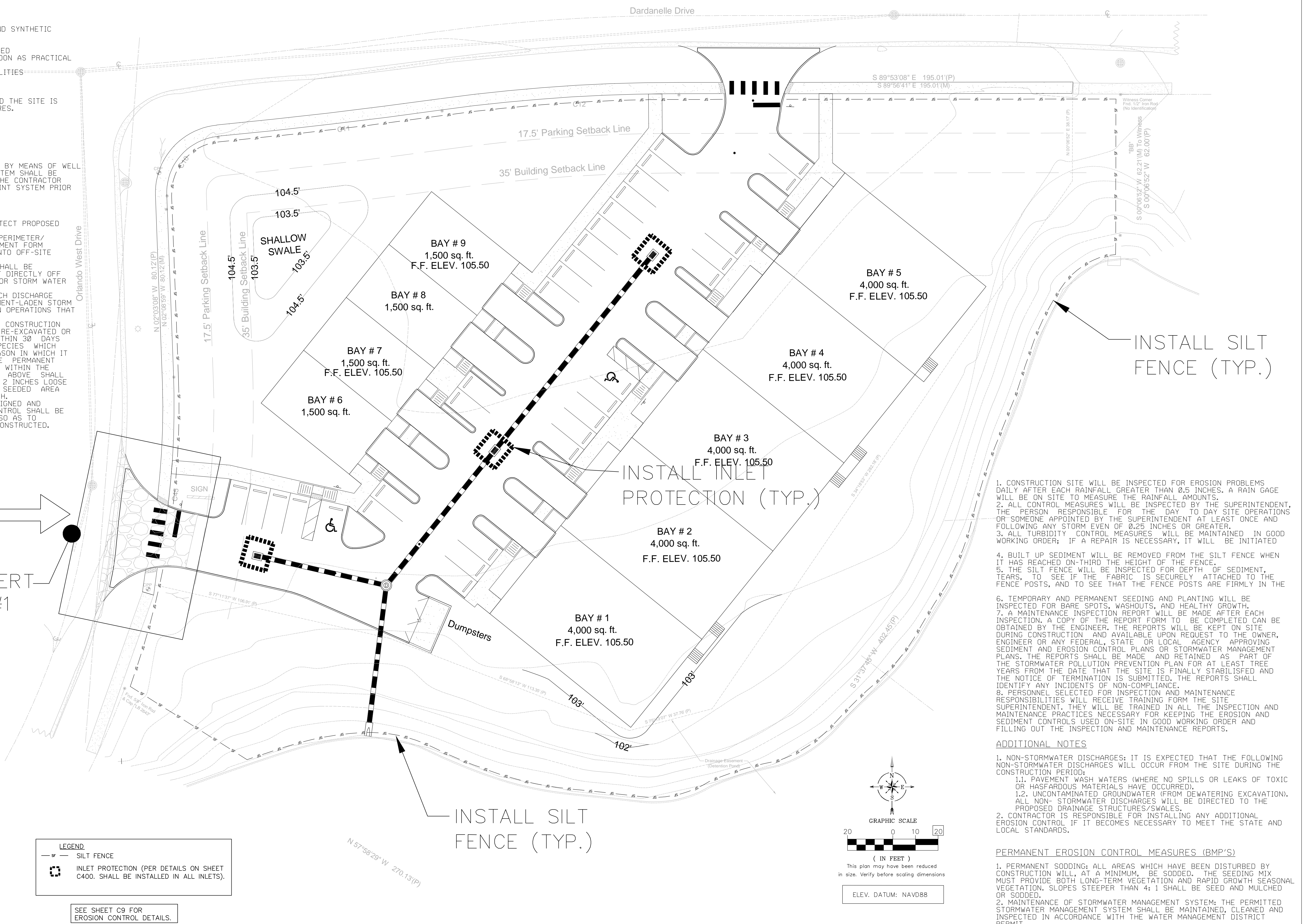

1. CONSTRUCTION SITE WILL BE INSPECTED FOR EROSION PROBLEMS DAILY AFTER EACH RAINFALL GREATER THAN 0.5 INCHES. A RAIN GAGE WILL BE ON SITE TO MEASURE THE RAINFALL AMOUNTS.
2. ALL CONTROL MEASURES WILL BE INSPECTED BY THE SUPERINTENDENT, THE PERSON RESPONSIBLE FOR THE DAY TO DAY SITE OPERATIONS OR SOMEONE APPOINTED BY THE SUPERINTENDENT AT LEAST ONCE AND FOLLOWING ANY STORM EVEN OF 0.25 INCHES OR GREATER.
3. ALL TURBIDITY CONTROL MEASURES WILL BE MAINTAINED IN GOOD WORKING ORDER; IF A REPAIR IS NECESSARY, IT WILL BE INITIATED
4. BUILT UP SEDIMENT WILL BE REMOVED FROM THE SILT FENCE WHEN IT HAS REACHED ON-THIRD THE HEIGHT OF THE FENCE.
5. THE SILT FENCE WILL BE INSPECTED FOR DEPTH OF SEDIMENT, TEARS, TO SEE IF THE FABRIC IS SECURELY ATTACHED TO THE FENCE POSTS, AND TO SEE THAT THE FENCE POSTS ARE FIRMLY IN THE
6. TEMPORARY AND PERMANENT SEEDING AND PLANTING WILL BE INSPECTED FOR BARE SPOTS, WASHOUTS, AND HEALTHY GROWTH.
7. A MAINTENANCE INSPECTION REPORT WILL BE MADE AFTER EACH INSPECTION. A COPY OF THE REPORT FORM TO BE COMPLETED CAN BE OBTAINED BY THE ENGINEER, STATE OR LOCAL AGENCY APPROVING SEDIMENT AND EROSION CONTROL PLANS OR STORMWATER MANAGEMENT PLANS. THE REPORTS SHALL BE MAINTAINED AS PART OF THE STORMWATER POLLUTION PREVENTION PLAN FOR AT LEAST THREE YEARS FROM THE DATE THAT THE SITE IS FINALLY STABILIZED AND THE NOTICE OF TERMINATION IS SUBMITTED. THE REPORTS SHALL IDENTIFY ANY INCIDENTS OF NON-COMPLIANCE.
8. PERSONNEL SELECTED FOR INSPECTION AND MAINTENANCE RESPONSIBILITIES WILL RECEIVE TRAINING FROM THE SITE SUPERINTENDENT. THEY WILL BE TRAINED IN ALL THE INSPECTION AND MAINTENANCE PRACTICES NECESSARY FOR KEEPING THE EROSION AND SEDIMENT CONTROLS USED ON-SITE IN GOOD WORKING ORDER AND FILLING OUT THE INSPECTION AND MAINTENANCE REPORTS.

ADDITIONAL NOTES

1. NON-STORMWATER DISCHARGES: IT IS EXPECTED THAT THE FOLLOWING NON-STORMWATER DISCHARGES WILL OCCUR FROM THE SITE DURING THE CONSTRUCTION PERIOD:
 - 1.1. PAVEMENT WASH WATERS (WHERE NO SPILLS OR LEAKS OF TOXIC OR HAZARDOUS MATERIALS HAVE OCCURRED).
 - 1.2. UNCONTAMINATED GROUNDWATER (FROM DEWATERING EXCAVATION).
 ALL NON-STORMWATER DISCHARGES WILL BE DIRECTED TO THE PROPOSED DRAINAGE STRUCTURES/WALES.
2. CONTRACTOR IS RESPONSIBLE FOR INSTALLING ANY ADDITIONAL EROSION CONTROL IF IT BECOMES NECESSARY TO MEET THE STATE AND LOCAL STANDARDS.

PERMANENT EROSION CONTROL MEASURES (BMP'S)

1. PERMANENT SODDING: ALL AREAS WHICH HAVE BEEN DISTURBED BY CONSTRUCTION WILL, AT A MINIMUM, BE SODDDED. THE SEEDING MIX MUST PROVIDE BOTH LONG-TERM VEGETATION AND RAPID GROWTH SEASONAL VEGETATION. SLOPES STEEPER THAN 4:1 SHALL BE SEED AND MULCHED OR SODDDED.
2. MAINTENANCE OF STORMWATER MANAGEMENT SYSTEM: THE PERMITTED STORMWATER MANAGEMENT SYSTEM SHALL BE MAINTAINED, CLEANED AND INSPECTED IN ACCORDANCE WITH THE WATER MANAGEMENT DISTRICT PERMIT.

