

W. HOLCOMBE BOULEVARD
(120' R.O.W.)
ASPHALT W/ CONC. GUTTER

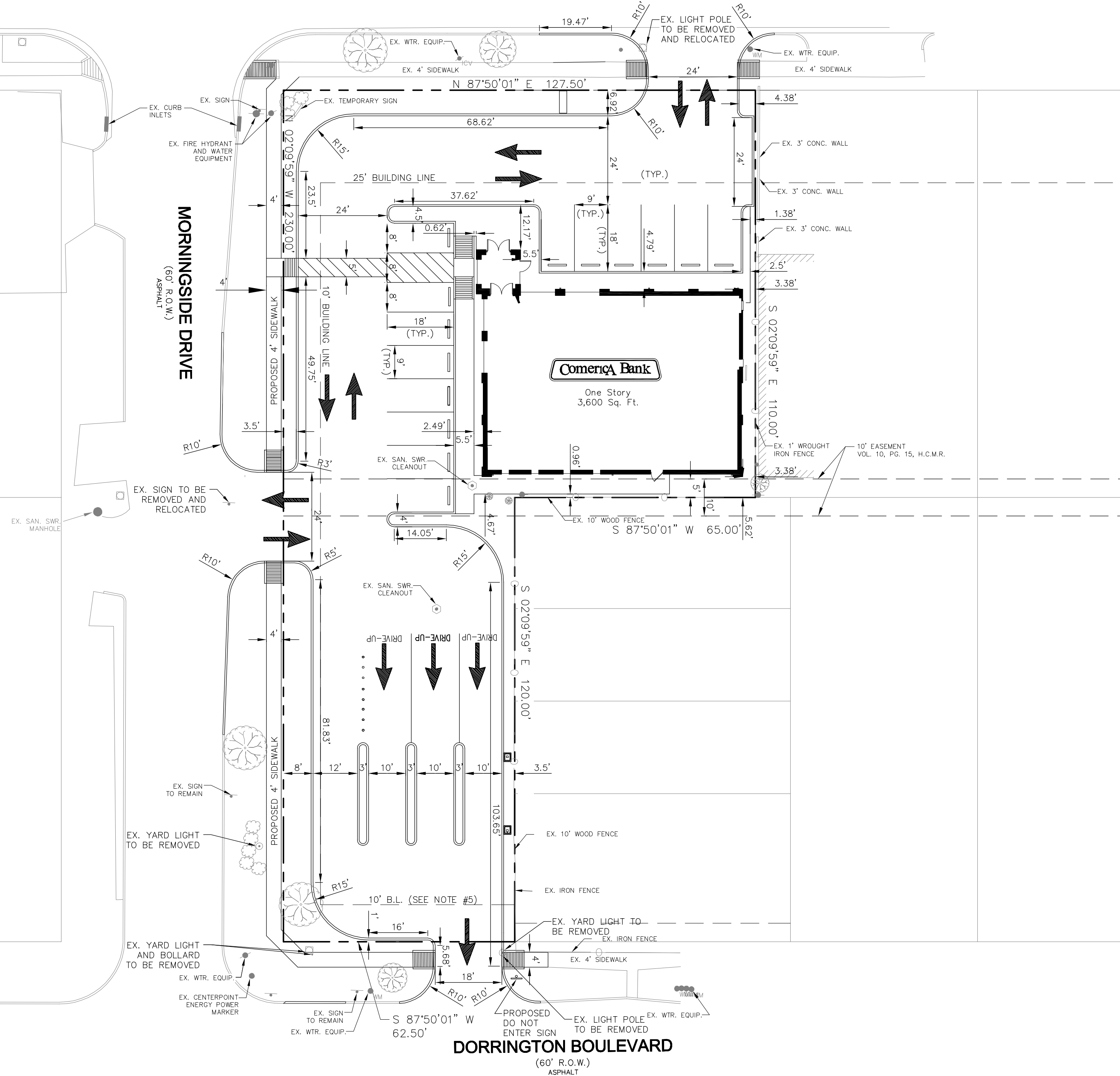
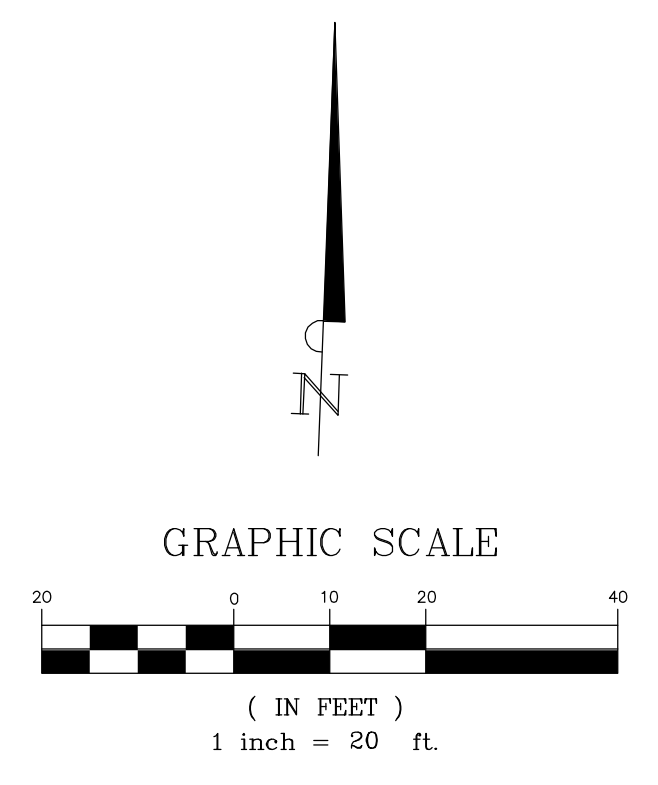

SITE DATA SUMMARY TABLE

BUILDING AREA (gross square footage)	3,500 SQ. FT.
TOTAL PARKING REQUIRED	14 SPACES
TOTAL PARKING PROVIDED	14 SPACES

NOTES

1. DIMENSIONS ARE TO FACE OF CURB UNLESS OTHERWISE NOTED.
2. ALL RADI 2' UNLESS OTHERWISE NOTED.
3. REFER TO ARCHITECTURAL PLANS FOR SITE LIGHTING LOCATIONS AND ELECTRICAL PLAN.
4. REFER TO ARCHITECTURAL PLANS FOR EXACT BUILDING DIMENSIONS.

LEGEND

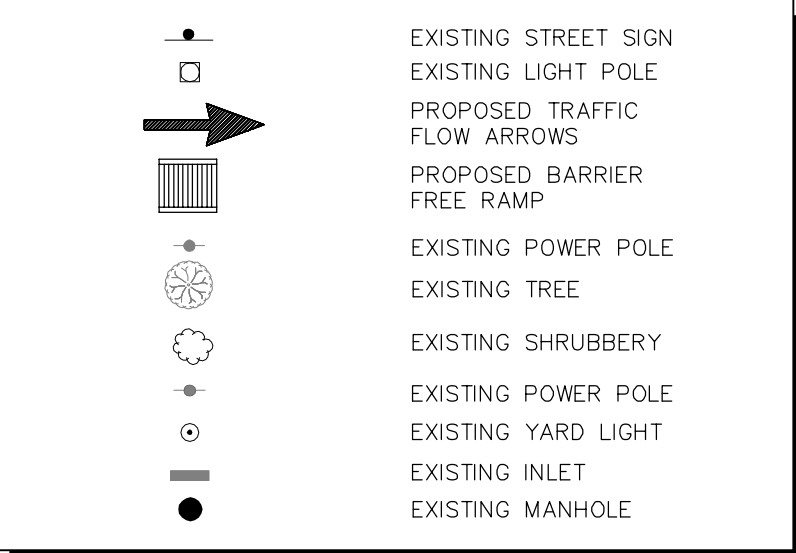

No.	Date	Revisions

Kimley-Horn and Associates, Inc.
12012 Wickchester Dr., Suite 500 Houston, Texas 77079-1221
Tel. No. (281) 597-9300 Fax No. (281) 597-8032

HARRIS COUNTY
Comerica BANK

HOLCOMBE AND MORNINGSIDE HOUSTON, TX

SITE PLAN

SCALE: AS SHOWN	SHEET NO.
DATE: SEPTEMBER 2007	C-0
PROJECT NUMBER: 063486462	

REFERENCE BENCHMARK:
RM 040125 - HCFCD BRASS DISK STAMPED "D100 D-94" ON BRIDGE ON MAIN STREET AND BRAYS BAYOU LOCATED ON DOWNSTREAM, EAST SIDEWALK OF BRIDGE. AT STREAM CENTERLINE IN KEY MAP 532L IN THE BRAYS WATERSHED NEAR STREAM D100-00-00. ELEV.=46.525' (NAVD 88, 2001 ADJ.)

TEMPORARY BENCHMARK:
TBM "A" - BOLT ON TOP FLANGE OF FIRE HYDRANT NEXT TO "LL" IN MUELLER LOCATED AT THE SOUTHWEST CORNER OF THE INTERSECTION OF MORNINGSIDE DRIVE AND DORRINGTON BOULEVARD. ELEV.=48.77'

TBM "B" - BOX CUT ON "B" INLET LOCATED AT THE SOUTHEAST CORNER OF THE INTERSECTION OF W. HOLCOMBE BOULEVARD AND MORNINGSIDE DRIVE. ELEV.=45.34'

TBM "C" - BOX CUT ON CONCRETE SIDEWALK LOCATED AT THE SOUTHEAST CORNER OF THE SUBJECT TRACT. ELEV.=46.41'

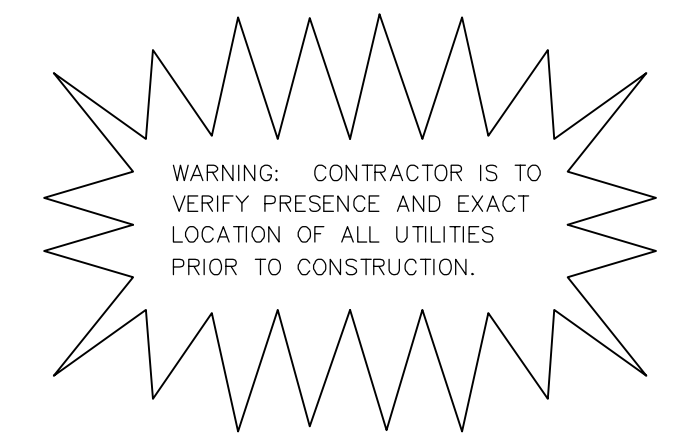

STOP!
CALL BEFORE YOU DIG
TEXAS ONE CALL SYSTEM
1-800-245-4545
(at least 72 hours prior to digging)

File: R:\GIS\063486462-Comerica-Holcombe-Morningside\DWG\063486462.dwg [1/4] 9/22/2007 3:55pm