



CHRIS GHIDORZI  
 m: 715.302.8185  
 chrisg@ghidorzi.com

2100 Stewart Ave., Suite 300  
 Wausau, WI 54401  
 www.ghidorzi.com

## Westwood Drive Business Park

1101 Westwood Drive, Wausau, WI 54401

**Asking Price: \$5.5**

Lot 2: \$876,000

Lot 3: \$1,125,000

**FOR SALE OR DEVELOPMENT**



### Area Map

image by Google maps

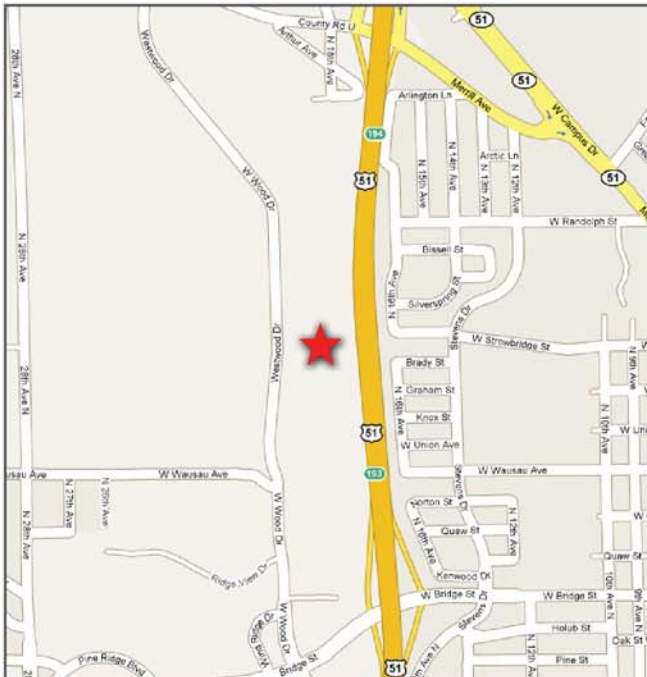

### Demographics

| ROAD       | AVERAGE ANNUAL DAILY TRAFFIC 2004 (vehicles) |
|------------|--|
| US 51/1-39 | 62,500                                       |

| CITY         | POPULATION |
|--------------|------------|
| Wausau       | 38,881     |
| Wausau Metro | 102,511    |

### Features

- High visibility and easy access from US 51/I-39
- Part of a growing business park that includes WPS, West Business services, Westwood Conference Center and Rasmussen College
- Located less than a mile from Wausau's Medical campus
- Buy or develop options

THIS DOCUMENT HAS BEEN PREPARED SOLELY FOR INFORMATION PURPOSES. WHILE THE INFORMATION CONTAINED HEREIN IS FROM SOURCES DEEMED RELIABLE, IT HAS NOT BEEN INDEPENDENTLY VERIFIED. THIS DOCUMENT IS PROVIDED SUBJECT TO ERRORS, OMISSIONS AND CHANGES IN INFORMATION.





## Westwood Drive Business Park

1101 Westwood Drive, Wausau, WI 54401

CHRIS GHIDORZI  
m: 715.302.8185  
chrisg@ghidorzi.com

2100 Stewart Ave., Suite 300  
Wausau, WI 54401  
www.ghidorzi.com





## Westwood Drive Business Park

1101 Westwood Drive, Wausau, WI 54401

CHRIS GHIDORZI  
m: 715.302.8185  
chrisg@ghidorzi.com

2100 Stewart Ave., Suite 300  
Wausau, WI 54401  
www.ghidorzi.com



1101 WESTWOOD DRIVE, WAUSAU, WI 54401